

TRAFFIC CONTROL SIGNING FOR TRAFFIC MOVEMENT THROUGH CONSTRUCTION ON FOUR-LANE HIGHWAY

PLANS	STATE	PROJECT NO.	YEAR	SHEET NO.	TOTAL SHEETS
73	KANSAS	524-97-1-524(18)144	1976	198	204

Construction Phase 3

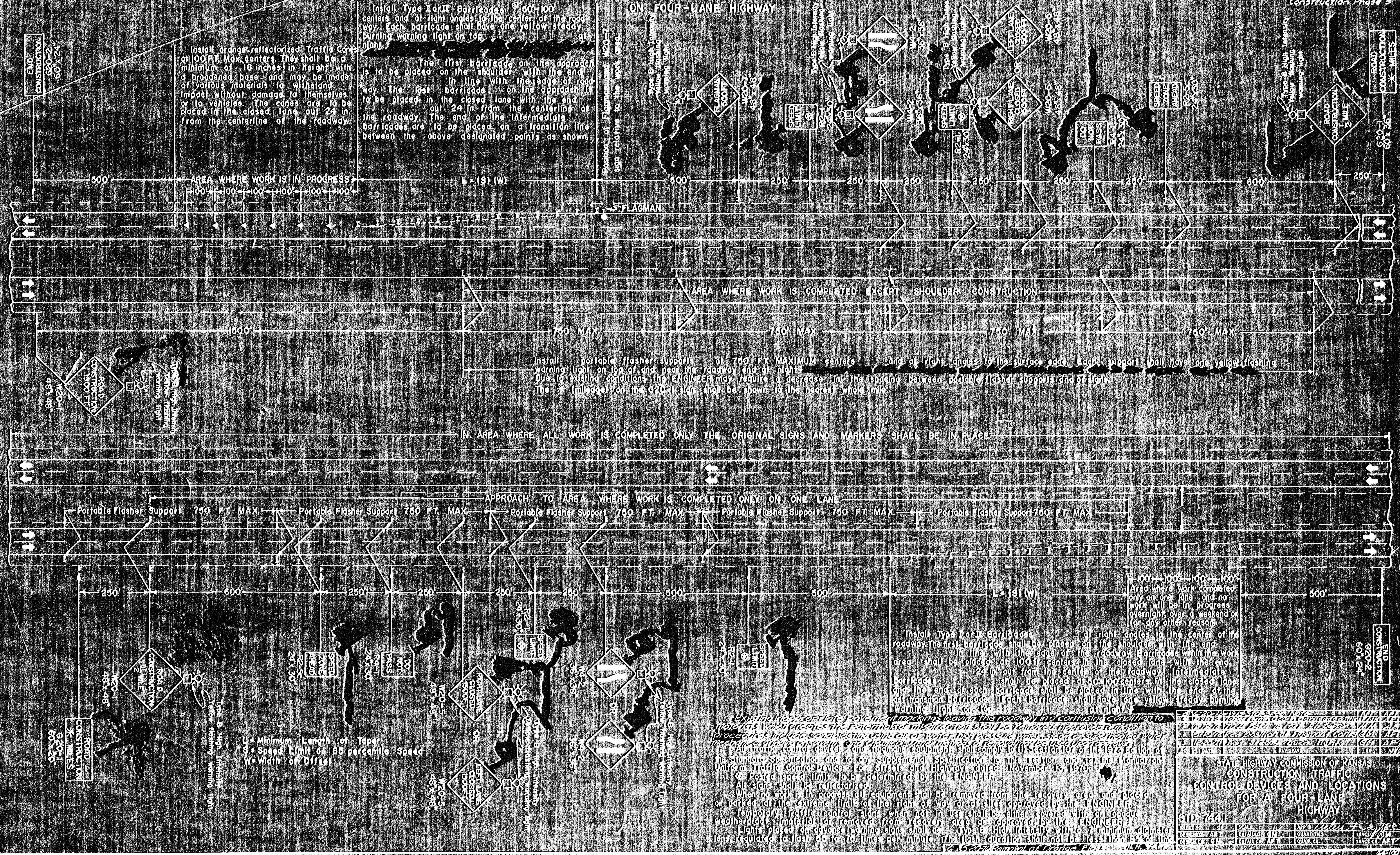

Install orange reflectorized Traffic Cones at 100 FT. Max. centers. They shall be a minimum of 18 inches in height with a broadened base and may be made of various materials to withstand impact without damage to themselves or to vehicles. The cones are to be placed in the closed lane out 24 in. from the centerline of the roadway.

Install Type I or II Barricades @ 50'-100' centers and at right angles to the center of the roadway. Each barricade shall have one yellow steady burning warning light on top.

The first barricade on the approach is to be placed on the shoulder with the end in line with the edge of roadway. The last barricade on the approach is to be placed in the closed lane with the end out 24 in. from the centerline of the roadway. The end of the intermediate barricades are to be placed on a transition line between the above designated points as shown.

Position of Flagman and W20-7 sign relative to the work area.

Install portable flasher supports at 750 FT MAXIMUM centers and at right angles to the surface edge. Each support shall have one yellow flashing warning light on top of and near the roadway end of light. Due to existing conditions the ENGINEER may require a decrease in the spacing between portable flasher supports and of light. The * (mileage) on the 620-2 sign shall be shown to the nearest whole mile.

IN AREA WHERE ALL WORK IS COMPLETED ONLY THE ORIGINAL SIGNS AND MARKERS SHALL BE IN PLACE

APPROACH TO AREA WHERE WORK IS COMPLETED ONLY ON ONE LANE

Install Type I or II Barricades at right angles to the center of the roadway. The first barricade shall be placed on the shoulder with the end in line with the edge of the roadway. Barricades within the work area shall be placed at 100 ft centers in the closed lane with the end 24 in. out from the center of the roadway. Intermediate barricades shall be placed at 50-100 centers in the closed lane. One the end of each barricade shall be placed in line with the end of the last transition barricade. Each barricade shall have one yellow steady burning warning light on top.

Existing road surface markings leading the roadway in a confusing condition to motorists while crews and equipment are in operation shall be removed. Appropriate procedures include sanding and using oil or water. All persons shall be instructed to use proper procedures.

All traffic control devices and equipment shall comply with Section 107 of the 1976 Edition of the Standard Specification and to any Supplemental Specification to this section and any the Metropolitan Uniform Traffic Control Device for Street and Highway dated November 15, 1970.

Posted speed limit to be determined by the ENGINEER.

All signs shall be reflectorized.

When no work is in progress all equipment shall be removed from the recovery area and placed or parked at the extreme limit of the right of way or at site approved by the ENGINEER.

Temporary traffic control signs when not in use shall be either covered with an opaque weatherproof material or removed from the recovery area as approved by the ENGINEER.

Lights placed on devices warning signs shall be Type E high intensity with a minimum diameter of 1 1/2 inches regulated to flash at 10 to 120 times per minute in the flash direction and at 1/2 second intervals.

L = Minimum Length of Tape
S = Speed Limit or 80 percentile Speed
W = Width of Offset

STATE HIGHWAY COMMISSION OF KANSAS
CONSTRUCTION TRAFFIC
CONTROL DEVICES AND LOCATIONS
FOR A FOUR-LANE
HIGHWAY

STD. 7441

DATE	SCALE	BY	TRACER
11/15/76	AS SHOWN	W.P. GIBSON	W.P. GIBSON
DATE	SCALE	BY	TRACER
11/15/76	AS SHOWN	W.P. GIBSON	W.P. GIBSON