

C CURVE DATA						
A=14°52'57" L D=12° 24' 54.4" R=461.50' L=119.87' T=60.28' E=3.92'						
CURVE DATA BASED ON C radius Δ/2= 7° 26' 28.5"						
C STATION	C ARC LENGTH	FACE CURB LENGTH		CHORD LENGTH		C TOTAL DEFLECTION
		LEFT CURB	RIGHT CURB	8' OFF LEFT FACE CURB	8' OFF RIGHT FACE CURB	
10+80.24						0°00'00.0"
11+00.00	19.76'	18.71'	20.81'	18.37'	21.15'	01°13'35.8"
11+25.00	25.00'	23.67'	26.33'	23.24'	26.76'	01°33'06.8"
11+50.00	25.00'	23.67'	26.33'	23.24'	26.76'	01°33'06.8"
11+75.00	25.00'	23.67'	26.33'	23.24'	26.76'	01°33'06.8"
12+00.00	25.00'	23.67'	26.33'	23.24'	26.76'	01°33'06.8"
12+00.11	0.11'	0.11'	0.12'	0.11'	0.12'	00°00'24.6"
TOTAL	119.87'	113.51'	126.24'			

WATER VALVE BOX ELEVATIONS			
STREET	STATION	OFFSET	PROPOSED ELEVATION
CROSSMARK PL.	12+97.61	28.16' Rt.	179.1
CROSSMARK PL.	13+87.90	28.50' Rt.	179.7

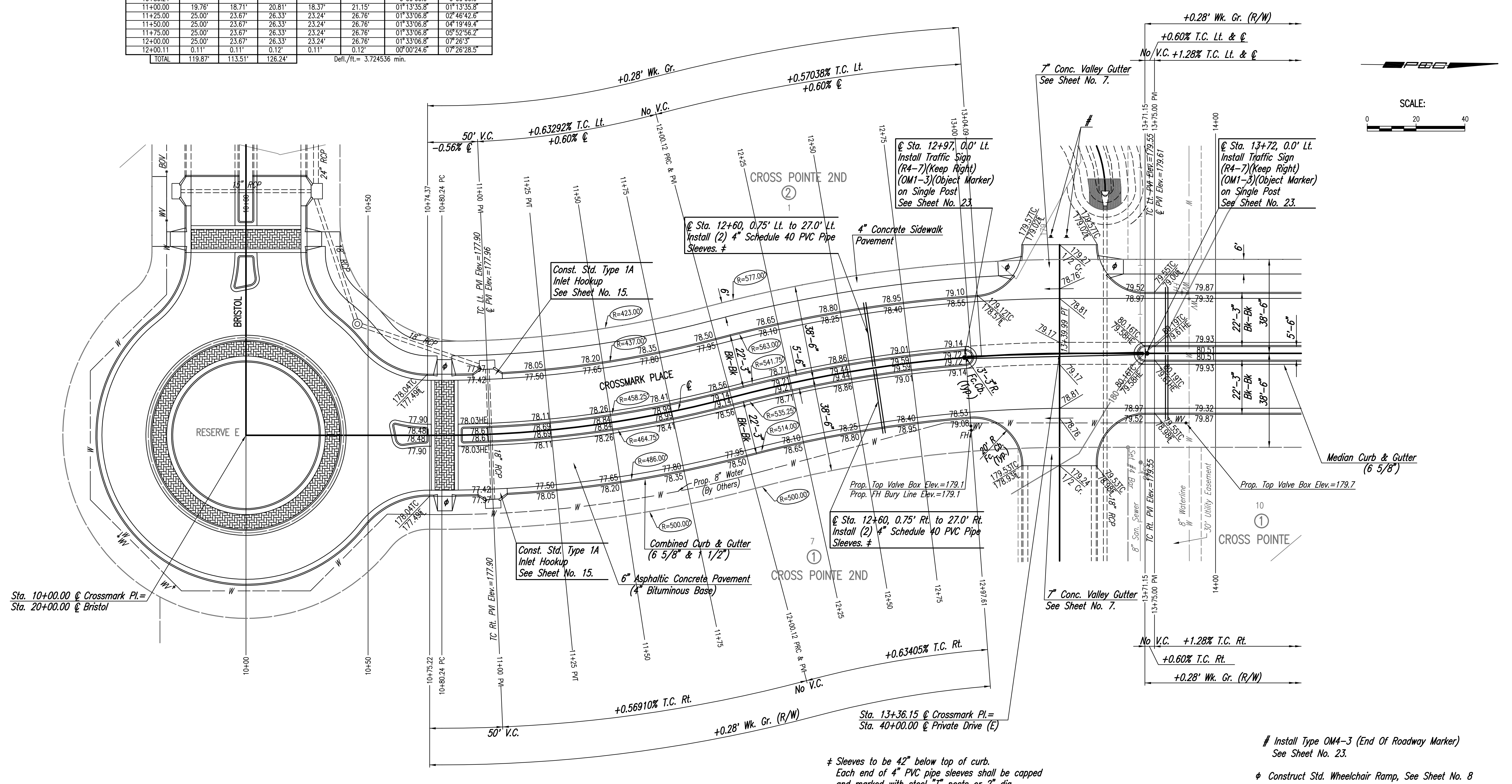

Sta. 10+00.00 @ Crossmark Pl.=
Sta. 20+00.00 @ Bristol

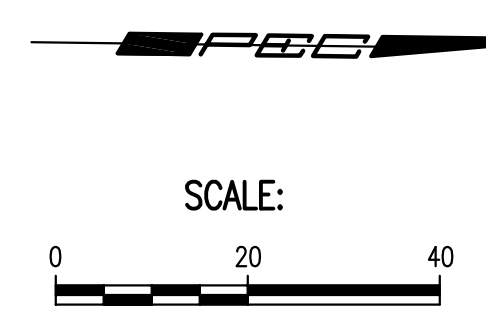

C CURVE DATA						
A=14°52'57" R D=10° 38' 23.6" R=538.50' L=139.87' T=70.33' E=4.57'						
CURVE DATA BASED ON C radius Δ/2= 7° 26' 28.5"						
C STATION	C ARC LENGTH	FACE CURB LENGTH		CHORD LENGTH		C TOTAL DEFLECTION
		LEFT CURB	RIGHT CURB	8' OFF LEFT FACE CURB	8' OFF RIGHT FACE CURB	
12+00.12						0°00'00.0"
12+25.00	24.88'	26.01'	23.75'	26.38'	23.38'	01°19'25.0"
12+50.00	25.00'	26.14'	23.86'	26.51'	23.49'	01°19'48.0"
12+75.00	25.00'	26.14'	23.86'	26.51'	23.49'	01°19'48.0"
13+00.00	25.00'	26.14'	23.86'	26.51'	23.49'	01°19'48.0"
13+25.00	25.00'	26.14'	23.86'	26.51'	23.49'	01°19'48.0"
13+39.99	14.99'	15.68'	14.31'	15.90'	14.09'	00°47'50.9"
TOTAL	139.87'	146.24'	133.51'			

≠ Sleeves to be 42" below top of curb. Each end of 4" PVC pipe sleeves shall be capped and marked with steel "T" posts or 2" dia. steel pipe a maximum of 12" above finished grade. Pipe, caps, markers, and installation thereof shall be Subsidiary to Combined Curb & Gutter (6 5/8").

NOTE: For future reference in locating schedule 40 PVC pipe sleeve, the contractor will be required to place a permanent marking on the curb adjacent to each pipe sleeve. The marking shall consist of a letter at least 4 inches in height stamped into the curb face immediately upon placement of the curb and gutter. The letter "S" shall be used for schedule 40 PVC pipe sleeve. This work shall be Subsidiary to Combined Curb and Gutter (6 5/8").

Install Type OMA-3 (End Of Roadway Marker) See Sheet No. 23.
φ Construct Std. Wheelchair Ramp, See Sheet No. 8

Scaled 12-18-2007 8:55:30 AM by BJS
 Plot Scale 1:20 12-18-2007 10:26:07 AM by BJS
 J:\SENTOUT\2007\07293\2007-12-18 to city\DWG\05-PAVING PLAN-CROSSMARK PL

No.	Revision	By	Date
CROSS POINT 2ND ADDITION-PHASE 1 PAVING AND INCIDENTAL DRAINAGE IMPROVEMENTS CROSSMARK PLACE STA. 10+00 TO STA. 14+00 JAMES L. ARMOUR, P.E. - CITY ENGINEER CITY OF WICHITA PROJECT NO. 472-84640			
Professional Engineering Consultants, P.A. 303 S. TOPKA • WICHITA, KANSAS 67202 316-262-2691 • FAX 316-262-3003			
Designed by	BDB, BMM	Job No.	35-07293-000
Drawn by	BJS, TAT	Date	October 2007
			Sheet 5 of 29