

# 21ST ST. N. DECEL LANE IMPROVEMENTS

84231

TO SERVE

## CROSS POINTE 2ND ADDITION-PHASE 3

THE ENTRANCE BETWEEN LOT 1, BLOCK 2 CROSS POINTE 2ND AND LOT 10, BLOCK 1 CROSS POINTE

OCA NO. 766185

CITY OF WICHITA PROJECT NO. 472-84231

### CITY OF WICHITA, KANSAS

JAMES L. ARMOUR, P.E. - CITY ENGINEER

#### INDEX OF SHEETS

1. TITLE SHEET
2. KEY MAP AND GENERAL NOTES
3. PLAT
4. TYPICAL SECTION
5. PAVING AND EROSION CONTROL PLAN
6. VALLEY GUTTER DETAILS
- 7-10. EROSION CONTROL DETAILS
- 11-12. CROSS SECTIONS

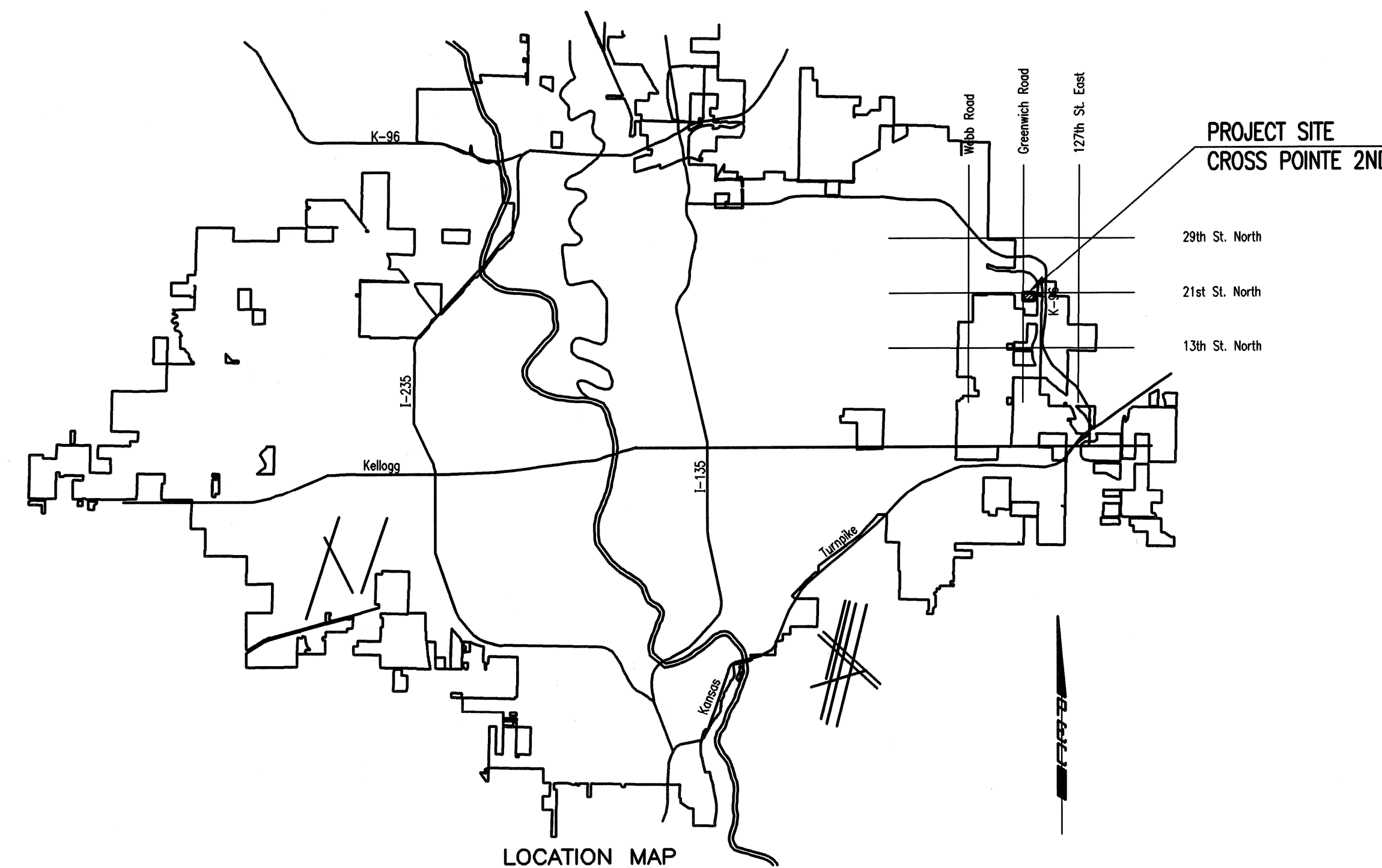

PROJECT LENGTH = 284 LIN. FT.

#### EARTHWORK

EXCAVATION 281 CU. YDS.

EXCESS EXCAVATED MATERIAL SHALL BE DISPOSED OF ON A SITE PROVIDED BY THE CONTRACTOR AND APPROVED BY THE ENGINEER.

## DECEMBER 2007

PLANS PREPARED BY

### PROFESSIONAL ENGINEERING CONSULTANTS, P.A.

ENGINEERS

WICHITA, KANSAS

