

21ST ST. N. LEFT TURN LANE

84234

TO SERVE

CROSS POINTE 2ND ADDITION - PHASE 1

THE EASTERN MOST ENTRANCE, BETWEEN LOT 10, BLOCK 1 CROSS POINTE AND LOT 1, BLOCK 2 CROSS POINTE 2ND

OCA NO. 766186

CITY OF WICHITA PROJECT NO. 472-84234

CITY OF WICHITA, KANSAS

JAMES L. ARMOUR, P.E. - CITY ENGINEER

INDEX OF SHEETS

1. TITLE SHEET
2. KEY MAP AND GENERAL NOTES
3. PLAT
4. TYPICAL SECTION
5. PAVING AND MARKING PLAN
- 6-9. EROSION CONTROL DETAILS

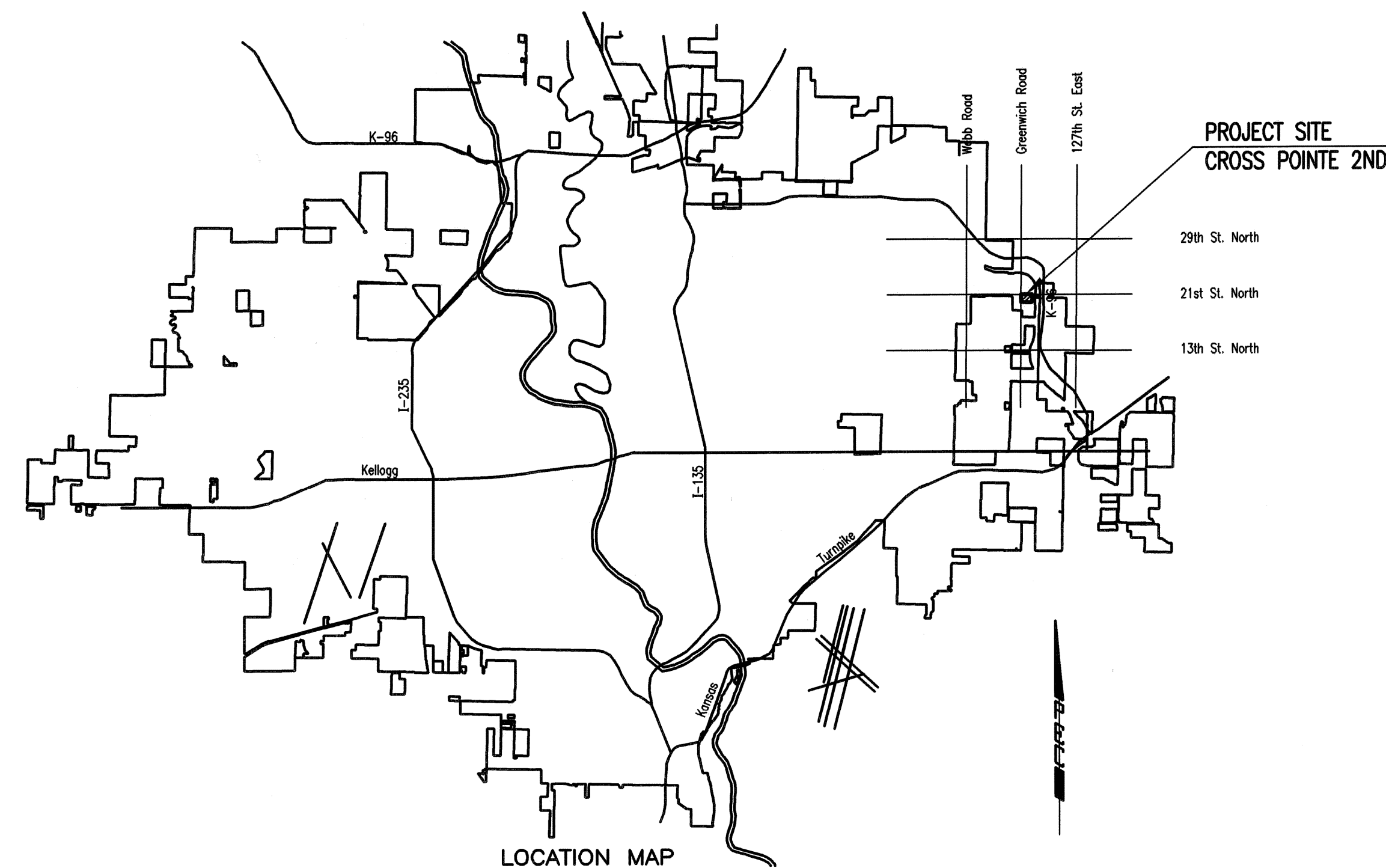

PROJECT LENGTH = 485 LIN. FT.

EARTHWORK

EXCAVATION 57 CU. YDS.

EXCESS EXCAVATED MATERIAL SHALL BE
DISPOSED OF ON A SITE PROVIDED BY THE
CONTRACTOR AND APPROVED BY THE ENGINEER.

DECEMBER 2007

PLANS PREPARED BY

PROFESSIONAL ENGINEERING CONSULTANTS, P.A.

ENGINEERS

WICHITA, KANSAS

