

BENCHMARK:  
 BM #1 City of Wichita Disc located NE Corner of  
 Traffic Signal Light Pole Base at NW Corner  
 of Womer and 37th Street North.  
 Elev. = 1324.06 MSL

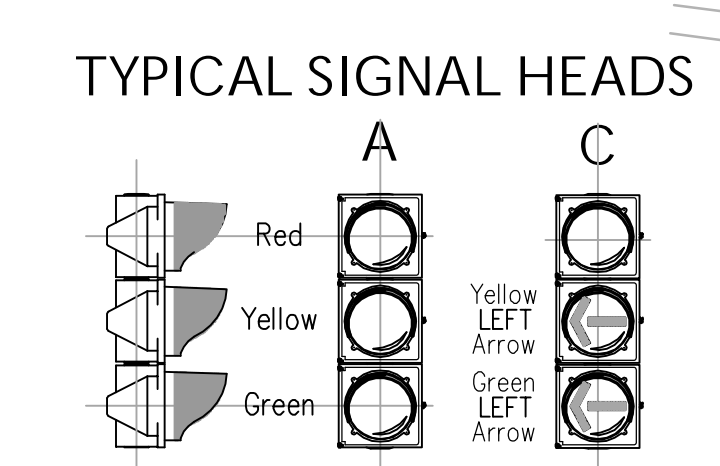
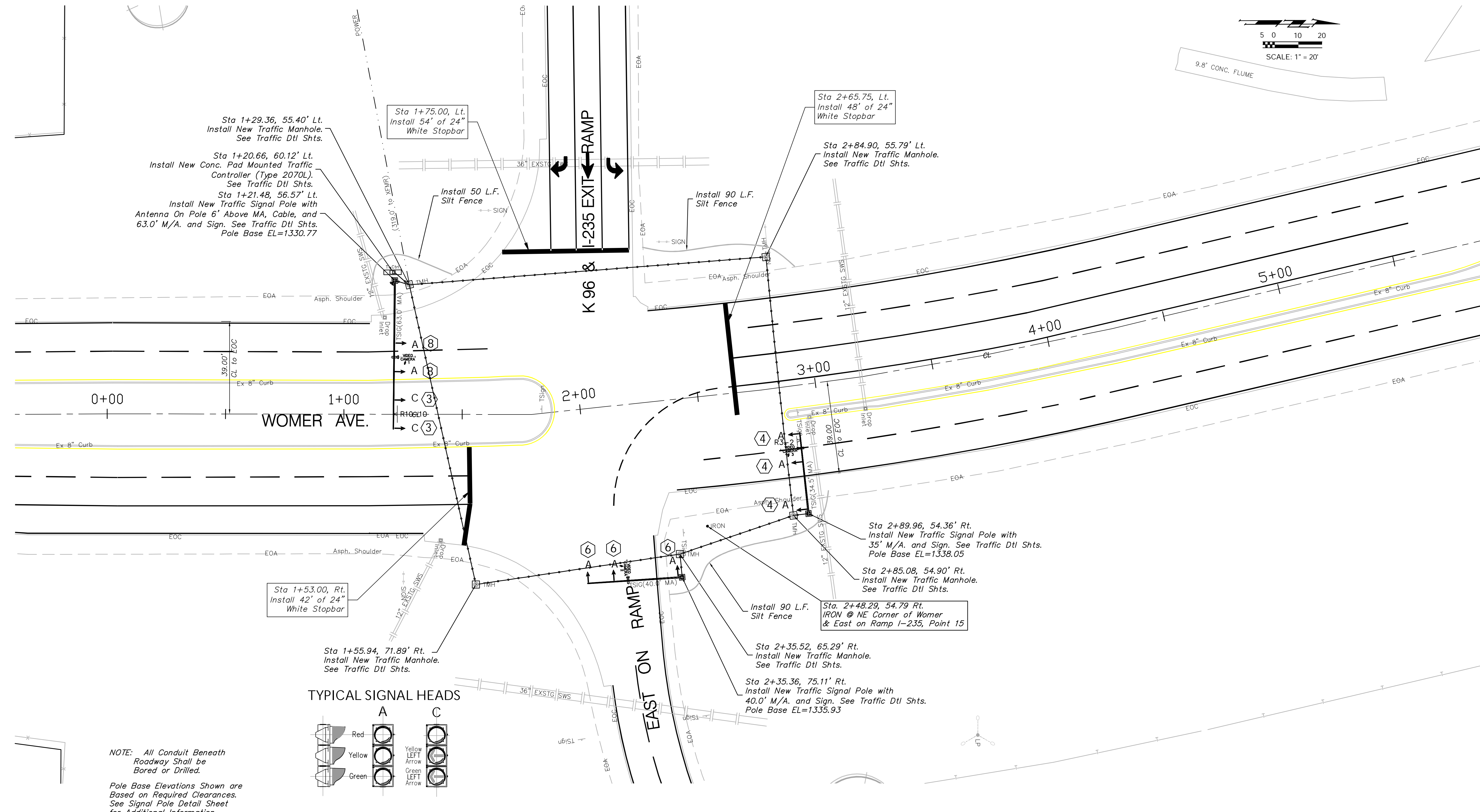
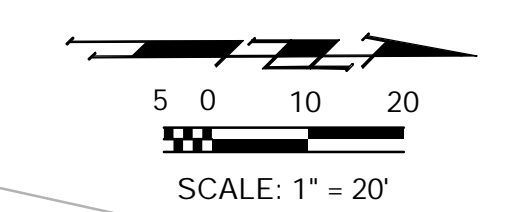

**NOTE:** All Conduit Beneath  
 Roadway Shall be  
 Bored or Drilled.

Pole Base Elevations Shown are  
 Based on Required Clearances.  
 See Signal Pole Detail Sheet  
 for Additional Information.

Contractor to Remove  
 Stop Sign when Signal  
 is Put into Operation.

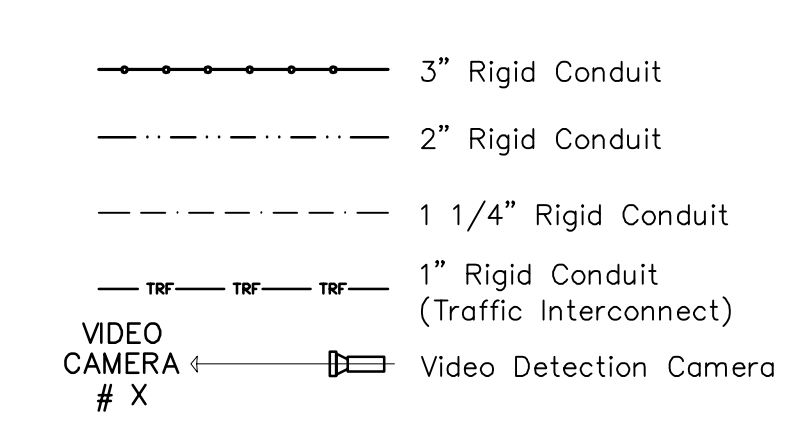
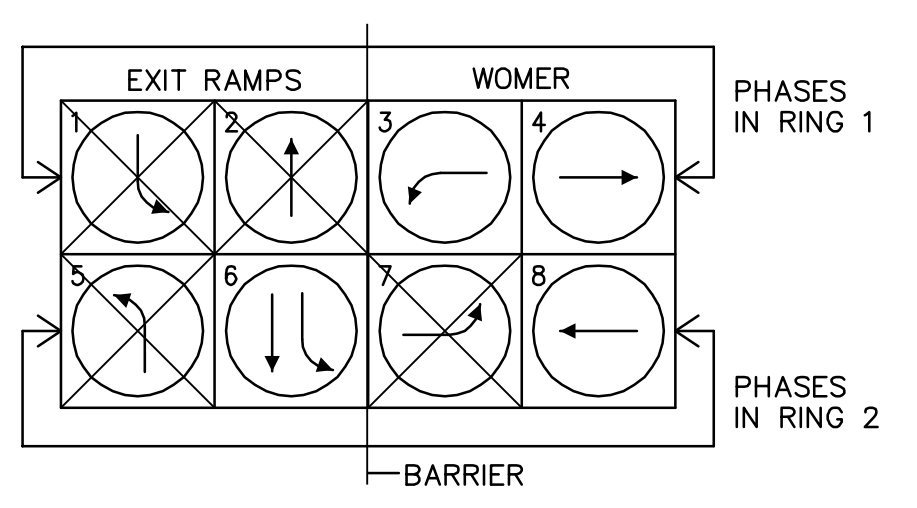

Design: TCA  
 Drawn: TCA  
 Approved: ENGINEER  
 Scale: NOTED

Project No. 0702E758 CAPITAL IMPROVEMENT PROJECT  
**I-235 & MERIDIAN SIGNALIZATION  
 WOMER & EAST ON RAMP**  
 PROJECT DESCRIPTION

**Baughman Company, P.A.**  
 315 Ellis St. Wichita, KS 67211 P 316-262-7171 F 316-262-0149  
 ENGINEERING | SURVEYING | PLANNING | LANDSCAPE ARCHITECTURE