

**NEW WATER METER SUMMARY**

No.	BL Station	Lt./Rt.	Service (Long or Short)	Meter Size	Address	AS BUILT
1	11+95.27	Rt.	Long	0.63	1416 N. POPLAR ST.	
2	12+66.37	Rt.	Long	XX	1424 N. POPLAR ST.	
3	13+48.23	Rt.	Long	0.63	1430 N. POPLAR ST.	
4	13+86.66	Rt.	Long	0.63	1436 N. POPLAR ST.	
5	14+19.06	Lt.	Short	XX	1429 N. POPLAR ST.	
6	14+38.88	Rt.	Long	XX	1440 N. POPLAR ST.	
7	14+71.69	Lt.	Short	XX	1443 N. POPLAR ST.	
8	15+25.14	Rt.	Long	0.63	1448 N. POPLAR ST.	
9	15+37.16	Lt.	Short	0.63	1449 N. POPLAR ST.	
10	15+45.54	Rt.	Long	0.63	1450 N. POPLAR ST.	
11	15+98.66	Lt.	Short	0.63	1453 N. POPLAR ST.	
12	16+04.80	Rt.	Long	0.63	1456 N. POPLAR ST.	

CUT AND KILL 2 - 6" MJ CAPS AT 4' SSCL & 10' WWCL 14TH & GREEN. CUT AND KILL 2 - 6" MJ CAPS AT 4' SSCL & 1' WWCL 14TH & GREEN.

BL STA 16+59.88 POPLAR = BL STA 26+28.48 14TH ST. N. 15.13 S. OF N. CURB LINE & 14.96 E. OF THE W. CURB LINE.

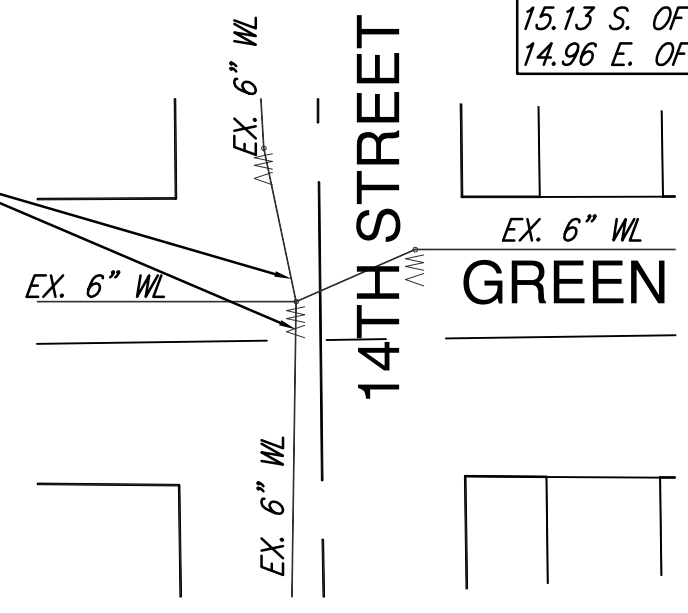

**NEW WATER METER SUMMARY**

No.	BL Station	Lt./Rt.	Service (Long or Short)	Meter Size	Address	AS BUILT
13	17+07.50	Rt.	Long	0.63	1502 N. POPLAR ST.	
14	17+08.29	Lt.	Short	0.63	1501 N. POPLAR ST.	
15	17+58.12	Lt.	Short	0.63	1507 N. POPLAR ST.	
16	17+91.78	Rt.	Long	0.63	1506 N. POPLAR ST.	
17	18+34.81	Lt.	Short	XX	1511 N. POPLAR ST.	
18	18+59.87	Rt.	Long	XX	1512 N. POPLAR ST.	
19	19+04.56	Rt.	Long	0.63	1518 N. POPLAR ST.	
20	19+08.57	Lt.	Short	XX	1515 N. POPLAR ST.	
21	19+55.72	Rt.	Long	0.63	1522 N. POPLAR ST.	
22	19+60.47	Lt.	Short	0.63	1521 N. POPLAR ST.	
23	20+07.43	Lt.	Short	0.63	1527 N. POPLAR ST.	
24	20+12.45	Rt.	Long	0.63	1526 N. POPLAR ST.	
25	21+07.26	Rt.	Long	0.63	1523 N. POPLAR ST.	
26	21+11.10	Lt.	Short	0.63	1531 N. POPLAR ST.	
27	21+55.93	Rt.	Long	0.63	1536 N. POPLAR ST.	
28	21+86.91	Lt.	Short	0.63	1541 N. POPLAR ST.	

BENCHMARK #9: CUT ON TOP OF CURB NORTH SIDE OF INLET @ NW COR. 13TH AND POPLAR ELEV. = 1308.39 NGVD  
 BENCHMARK #10: CUT ON TOP OF CURB SOUTH SIDE OF THE SE CURB RETURN @ 14TH AND POPLAR ELEV. = 1309.60 NGVD

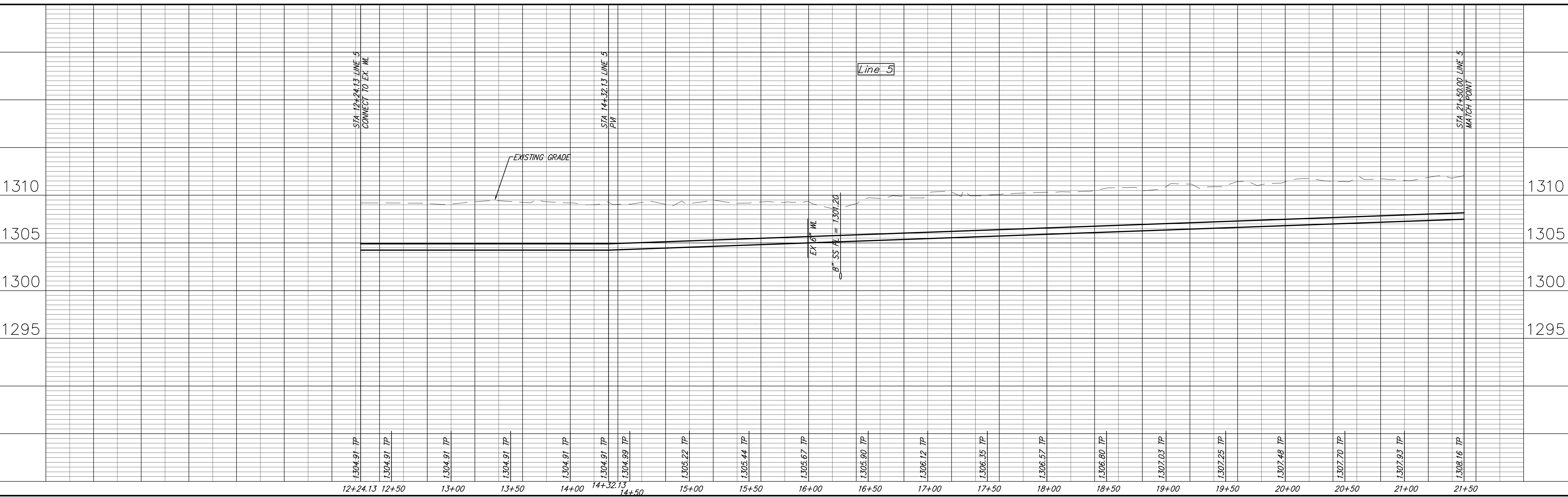
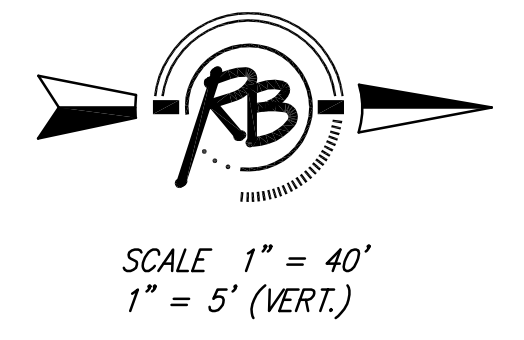

RB  
 Ruggles & Bohm P.A.  
 Engineering, Surveying, Land Planning  
 9000 W. 14th St., Suite 100  
 Overland Park, Kansas 66209  
 (913) 241-4477  
 www.rugglesandbohm.com

PROJECT NUMBER: 448-90210  
 DRAWING FILE: ENG. BASE LINE 5A  
 DESIGN: PC  
 UTILITY  
 DRAWN: MLP  
 DATE: Dec. 19, 2006  
 REVIEW: REVIEW

LOGAN WATER DISTRIBUTION  
 POPLAR STREET (LINE 5)  
 WICHITA, KANSAS

RB JOB: 2969W  
 SHEET: 13 OF 30