

NEW WATER METER SUMMARY

No.	BL Station	Lt./Rt.	Service (Long or Short)	Meter Size	Address	AS BUILT
62	33+88.98	Lt.	Short	0.63	1737 N. POPLAR ST.	
63	33+94.20	Rt.	Long	0.63	1732 N. POPLAR ST.	
64	34+45.82	Rt.	Long	0.63	1738 N. POPLAR ST.	
65	35+01.50	Lt.	Short	0.63	1741-1747 N. POPLAR ST.	
66	35+03.37	Lt.	Short	0.63	1741-1747 N. POPLAR ST.	
67	35+20.83	Lt.	Short	0.63	1741-1747 N. POPLAR ST.	
68	35+23.61	Lt.	Short	XX	1741-1747 N. POPLAR ST.	
69	35+28.06	Rt.	Long	0.63	1742 N. POPLAR ST.	
70	35+30.57	Rt.	Long	0.63	1748 N. POPLAR ST.	
71	35+48.33	Lt.	Short	XX	1741-1747 N. POPLAR ST.	
72	35+50.85	Lt.	Short	XX	1741-1747 N. POPLAR ST.	
73	35+52.80	Lt.	Short	XX	1741-1747 N. POPLAR ST.	
74	35+54.91	Lt.	Short	XX	1741-1747 N. POPLAR ST.	
75	35+56.70	Lt.	Short	0.63	1741-1747 N. POPLAR ST.	

INSTALL 2" IPT PLUG IN EX. VALVE AND 2" CAP (E)

CUT AND KILL 2 - 1" CORPS AT 11' S & 9' E NWPC.

BL STA 10+00.00 ESTELLE = BL STA 32+91.83 13TH ST. N. 23.88 S. OF N. CURB LINE & 15.89 E. OF THE W. CURB LINE.

BENCHMARK #13:
1" PIPE IN THIMBLE @ CL 17TH AND POPLAR
ELEV. = 1312.31 NGVD

BENCHMARK #14:
"+" CUT ON STEEL PLATE IN THIMBLE CL ESTELLE AND THE NORTH R/W OF 13TH
ELEV. = 1317.38 NGVD

BENCHMARK #15:
"|" CUT ON TOP OF CURB SOUTH SIDE OF THE SE CURB RETURN @ 14TH AND ESTELLE
ELEV. = 1321.16 NGVD

NEW WATER METER SUMMARY

No.	BL Station	Lt./Rt.	Service (Long or Short)	Meter Size	Address	AS BUILT
1	10+85.65	Rt.	Long	0.63	2702 E. 13th ST. N.	
2	11+65.52	Lt.	Short	XX	1405 N. ESTELLE AVE.	
3	11+94.03	Lt.	Short	0.63	1407 N. ESTELLE AVE.	
4	12+12.99	Rt.	Long	0.63	1416 N. ESTELLE AVE.	
5	12+75.06	Lt.	Short	0.63	1421 N. ESTELLE AVE.	
6	13+27.68	Rt.	Long	0.63	1422 N. ESTELLE AVE.	
7	13+61.12	Lt.	Short	XX	1427 N. ESTELLE AVE.	
8	13+93.07	Lt.	Short	XX	1433 N. ESTELLE AVE.	
9	14+76.08	Lt.	Short	XX	1441 N. ESTELLE AVE.	
10	15+14.98	Rt.	Long	XX	1446 N. ESTELLE AVE.	
11	15+23.04	Lt.	Short	XX	1445 N. ESTELLE AVE.	
12	15+65.12	Lt.	Short	0.63	1455 N. ESTELLE AVE.	
13	15+93.14	Lt.	Short	XX	1457 N. ESTELLE AVE.	
14	16+14.69	Rt.	Long	XX	1458 N. ESTELLE AVE.	

BL STA 16+58.91 ESTELLE = BL STA 32+86.53 14TH ST. N. 15.26 S. OF N. CURB LINE & 14.63 E. OF THE W. CURB LINE.

CAUTION: EXISTING 6" WL

REMOVE & REPLACE PVMT. AS NECESSARY FOR CONST.

SCALE 1" = 40'
1" = 5' (VERT.)

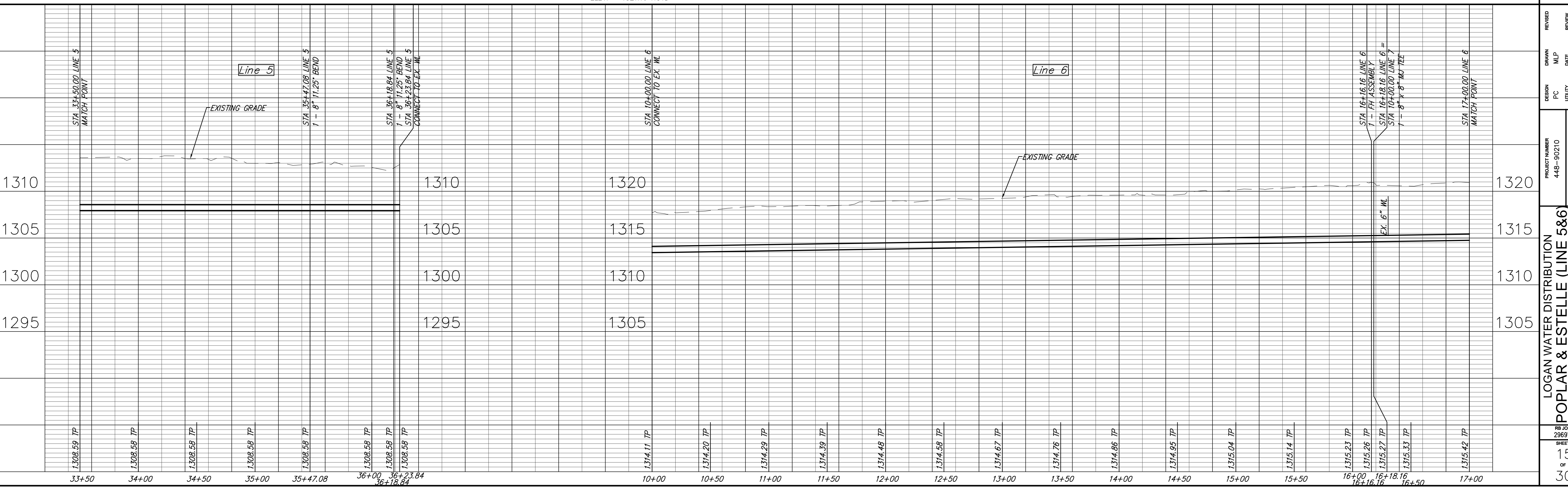
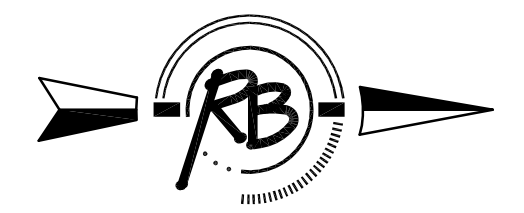

Ruggles & Pohn, P.A.
Engineering, Surveying, Land Planning
600 N. Main, Suite 8700
Wichita, Kansas 67202
www.ruggles.com

**LOGAN WATER DISTRIBUTION
POPLAR & ESTELLE (LINE 5&6)
WICHITA, KANSAS**

PROJECT NUMBER: 448-90210
DRAWING FILE: ENG. BASE \LINE 5C-6A

DESIGN: PC
MLP
UTILITY

DRAWN: MLP
DATE: Dec. 19, 2006
REVIEW: REVIEW

RB JOB 2969W
SHEET 15 OF 30