

STORM WATER DRAIN PLANS
MONARCH LANDING SECOND ADDITION
PHASE 1

**EROSION CONTROL/
SEEDING
PLAN**

468-84434

MLP

MLP

GJA

ISSUED
February 2008





REVISED

SHEET NO.

20 of 27

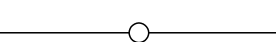
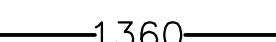
1. EROSION CONTROL IS TO MEET ALL FEDERAL, STATE, COUNTY & LOCAL CODE STANDARDS.
2. CONTRACTOR SHALL PROVIDE AND PRESERVE EROSION PROTECTION THROUGHOUT PROJECT CONSTRUCTION. THE PLAN PROVIDED HERE IS FOR FINAL PROTECTION, VARIOUS PHASES OF THIS PLAN SHALL BE IMPLEMENTED OR MODIFIED TO CONTROL EROSION. MODIFICATIONS OF THE PLAN SHALL BE APPROVED BY THE OWNER'S REPRESENTATIVE.
3. SEEDING AREAS SHALL BE PREPARED FOR PLANTING WITH COMMON AGRICULTURAL TECHNIQUES. ALL RESERVE AREAS SHALL BE FINE GRADED USING SMALL EQUIPMENT. REMOVE EXISTING GRASS, VEGETATION AND TURF. DO NOT MIX INTO SURFACE SOIL. LOOSEN SOIL TO A DEPTH OF AT LEAST 6 INCHES. GRADE AREAS TO A SMOOTH UNIFORM SURFACE PLANE. ROLL, RAKE, AND REMOVE RIDGES AND FILL DEPRESSIONS. THE SURFACE SHALL BE FREE FROM STICKS, SMALL STONES, AND OTHER EXTRANEIOUS MATERIALS. APPROVE WITH OWNER'S REPRESENTATIVE BEFORE PLANTING.
4. CONTRACTOR IS RESPONSIBLE FOR MAINTAINING AND IMPLEMENTING ALL EROSION CONTROL. COST IS SUBSIDIARY TO CHECK DAMS AND STABILIZED CONSTRUCTION ENTRANCE.
5. ALL SEED SHALL BE DISTRIBUTED WITH AN ACCEPTABLE DRILL INTENDED FOR SUCH OPERATIONS, OR OTHER EQUIPMENT APPROVED BY THE OWNER'S REPRESENTATIVE. SEEDING DEPTH SHALL BE 1/4".
6. SEED AND FERTILIZE AS FOLLOWS:
PERENNIAL RYE @ 200 LBS./ACRE
10-20-10 @ 350 LBS./ACRE
7. ALL SEEDED AREAS SHALL BE IMMEDIATELY MULCHED W/ PRAIRIE HAY AT 2 TONS/ACRE. ANCHOR MULCH BY CRIMPING INTO TOPSOIL WITH SUITABLE MECHANICAL EQUIPMENT.
8. TREE PROTECTION FENCE: SEE INDIVIDUAL GRADING SHEETS FOR TREE PROTECTION FENCE LOCATION. TOTAL QUANTITY OF TREE PROTECTION FENCE TO BE INSTALLED = 1,030 L.F.
9. ALL DISTURBED AREAS SHALL BE SEEDED.

EROSION CONTROL LEGEND

-  - ESTIMATED SEEDING LIMIT (19.3 AC.) (OMIT SEEDING FROM PONDS AND STREETS) (AREA QUANTITY FOR INFORMATION PURPOSES ONLY)
-  - PROPOSED STORM SEWER LINE
-  - PROPOSED CONTOURS
-  - SILT FENCE PROTECTION
-  - LOCATION FOR SEDIMENT CONTROL, HAY BALE
-  - LOCATION OF INLET SEDIMENT CONTROL
-  - CURB INLET FILTER

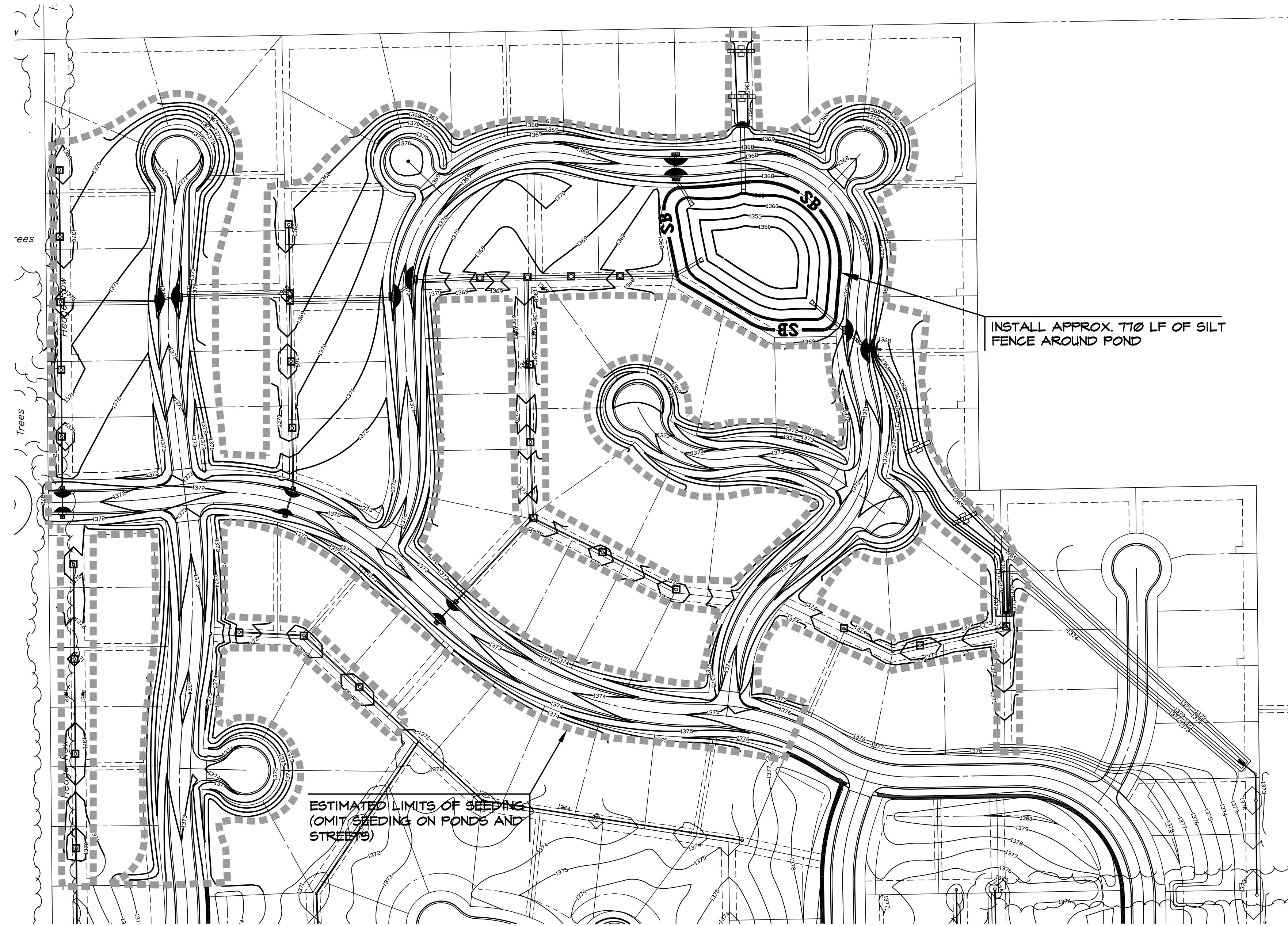
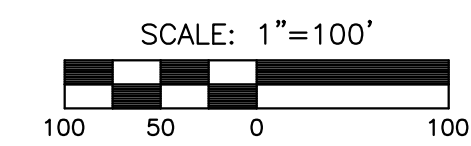
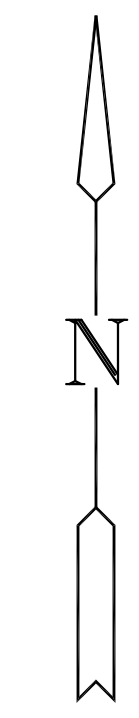

SEEDING / TREE PROTECTION PLAN
SCALE: 1"=100'