

Scale: 1"=20'
 Scale: 1"=20'
 Scale: 1"=20'
 Scale: 1"=20'

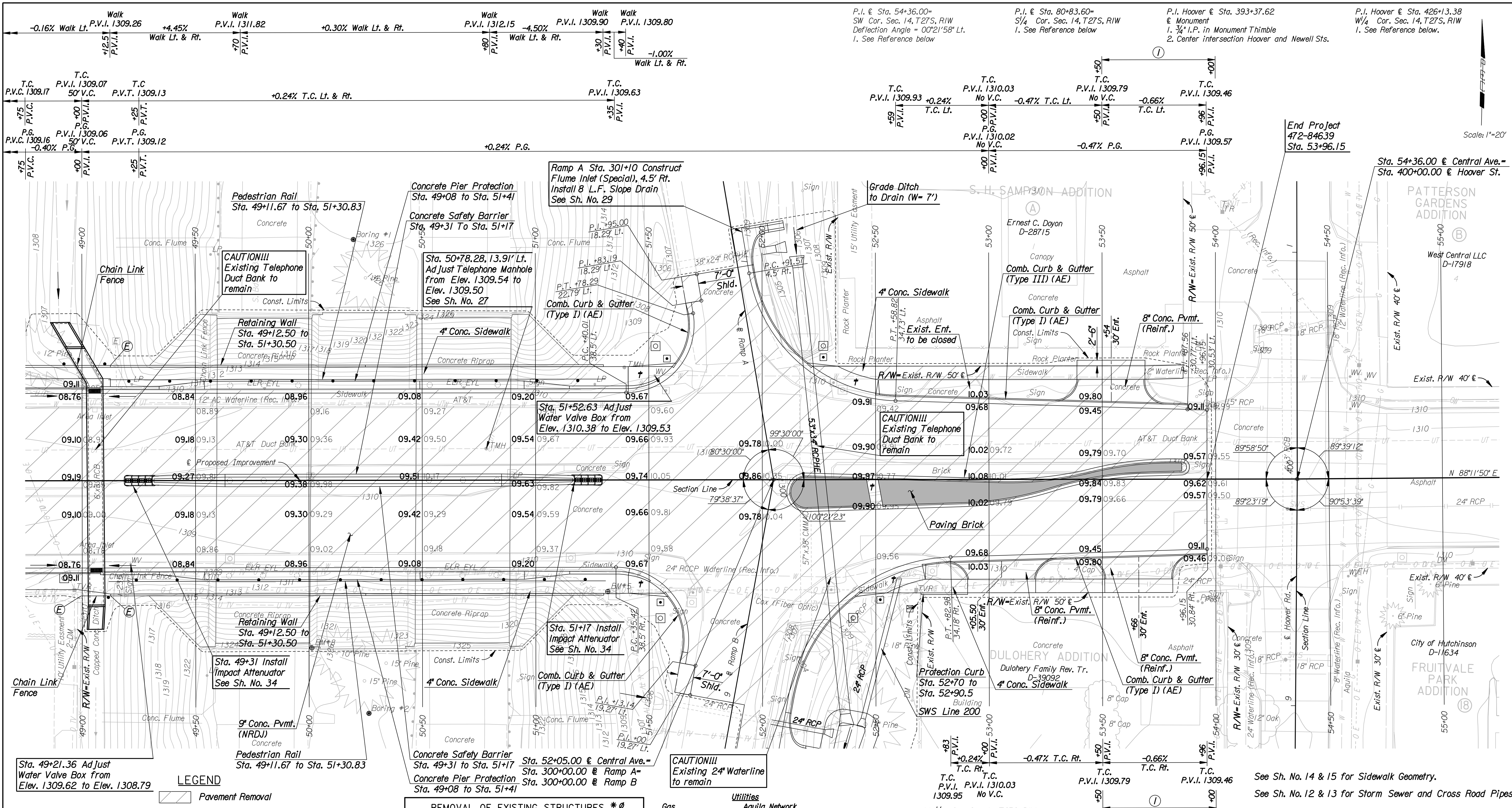

Sta. 49+21.36 Adjust Water Valve Box from Elev. 1309.62 to Elev. 1308.79

- LEGEND**
- Pavement Removal
 - Paving Brick
 - End Post
 - Wheelchair Ramp
 - Transition Cross Slope from 3/16"/ft. to 1/4"/ft.

Note:
 Elevations Shown along Curb & Gutter are to High Edge & Top of Curb for Comb. Curb & Gutter (Type I). Portions of this Sheet to be Constructed with Comb. Curb & Gutter (Type II). Adjustment are required for modified curb type.

STATION	SIDE	ITEM
48+73	Lt.	Chain Link Fence
49+00	Rt.	Chain Link Fence
49+06	£	6'x3'x83" RCB
50+20	Lt.	Concrete Riprap (Bridge Abutment)
50+20	Rt.	Concrete Riprap (Bridge Abutment)
52+19	£	10 Sq. Ft. x125.4' CMMAC with End Sections
52+60	Rt.	24"x45' RCP

* For Information Only
 See Sh. No. 81 for Sign Removal.

- Utilities**
- Gas
 - Power
 - Sanitary Sewer
 - Storm Water Sewer
 - Telephone
 - Television
 - Water

- Aquila Network
- KDOT
- Westar Energy
- Wichita Water and Sanitary Sewer
- City of Wichita
- AT&T
- Cox Communication
- Wichita Water and Sanitary Sewer

BM#8 Disc in SE corner of abutment on S. Bd. I-235 bridge over Central Ave. 73.87' Rt. £ Sta. 50+01.23 Elev. = 1326.25

BM#5 Chis. in NW corner of concrete pad to traffic signal control box, on S. side of Central Ave., between I-235 and I-235 N. Bd. exist ramp to Central Ave. 49.20' Rt. £ Sta. 51+31.80 Elev. = 1310.61

P.I. £ Sta. 54+36.00 = SW Cor. Sec. 14, T27S, R1W Deflection Angle = 0°21'58" Lt. 1. See Reference below

P.I. Hoover £ Sta. 393+37.62 £ Monument 1. 3/4" I.P. in Monument Thimble 2. Center intersection Hoover and Newell Sts.

P.I. Hoover £ Sta. 426+13.38 W/4 Cor. Sec. 14, T27S, R1W 1. See Reference below.

- W 1/4 Cor. Sec. 14, T27S, R1W
 1. #4 Bar with R&B cap at surface
 2. N 1,691,077.6746 E 1,628,292.3170
 3. £ Sta. 426+13.38
 4. Chis. ** top curb
 5. Chis. ** top curb, mid-point on curve
 6. Chis. ** top curb, mid-point on curve

15.20' W
 32.28' NE
 33.21' SE

- S 1/4 Cor. Sec. 14, T27S, R1W
 1. 1/2" I.P. in Monument Box
 2. N 1,688,548.4345 E 1,631,005.0137
 3. £ Sta. 80+83.60
 4. Chis. ** on center front Storm Drain Curb Inlet
 5. Chis. ** on center front Storm Drain Curb Inlet
 6. Chis. ** top curb, mid-point on curve
 7. Chis. ** NW cor. Traffic Signal MH

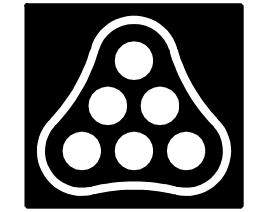

Region: CENTRAL AVENUE
 PLAN
 STA. 49+00 TO STA. 55+00
 JAMES L. ARMOUR, P.E. - CITY ENGINEER
 CITY OF WICHITA PROJECT NO. 472-84639
Professional Engineering Consultants, P.A.
 303 S. TOPKA • WICHITA, KANSAS 67202
 316-262-2691 • FAX 316-262-3003

Designed by: PMJ Job No.: 06655
 Drawn by: DRP Date: Jan. 2008 Sht. 7 of 142