

DSNR: RAS OPER: DRP SCALE: I:/2006/06655/BRIDGE/RCB/06655-000-C-INLETTYPE2SPEC.DGN LAST REV: 12-11-2007 BY: DRP

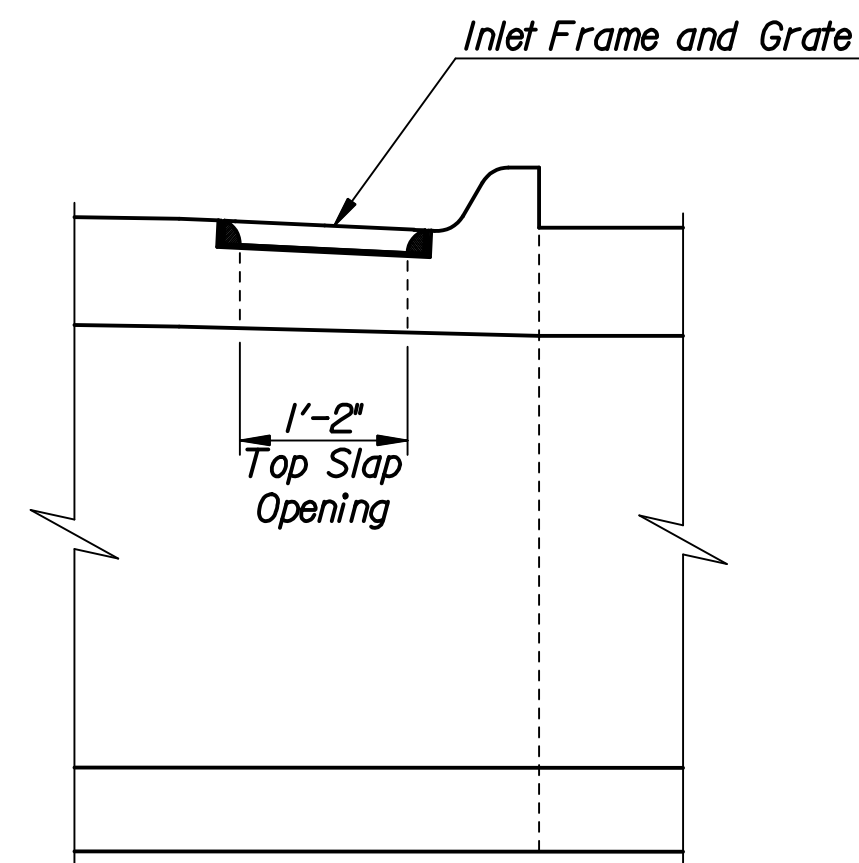

SECTION A-A

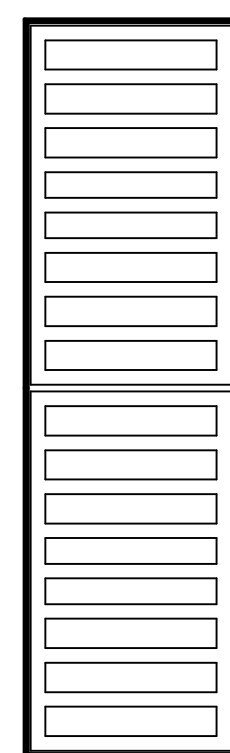

GRATE DETAIL

Grate shall be 2 Neenah R-4853-A Grates or approved equal.
(Wt. = 520 lbs.)

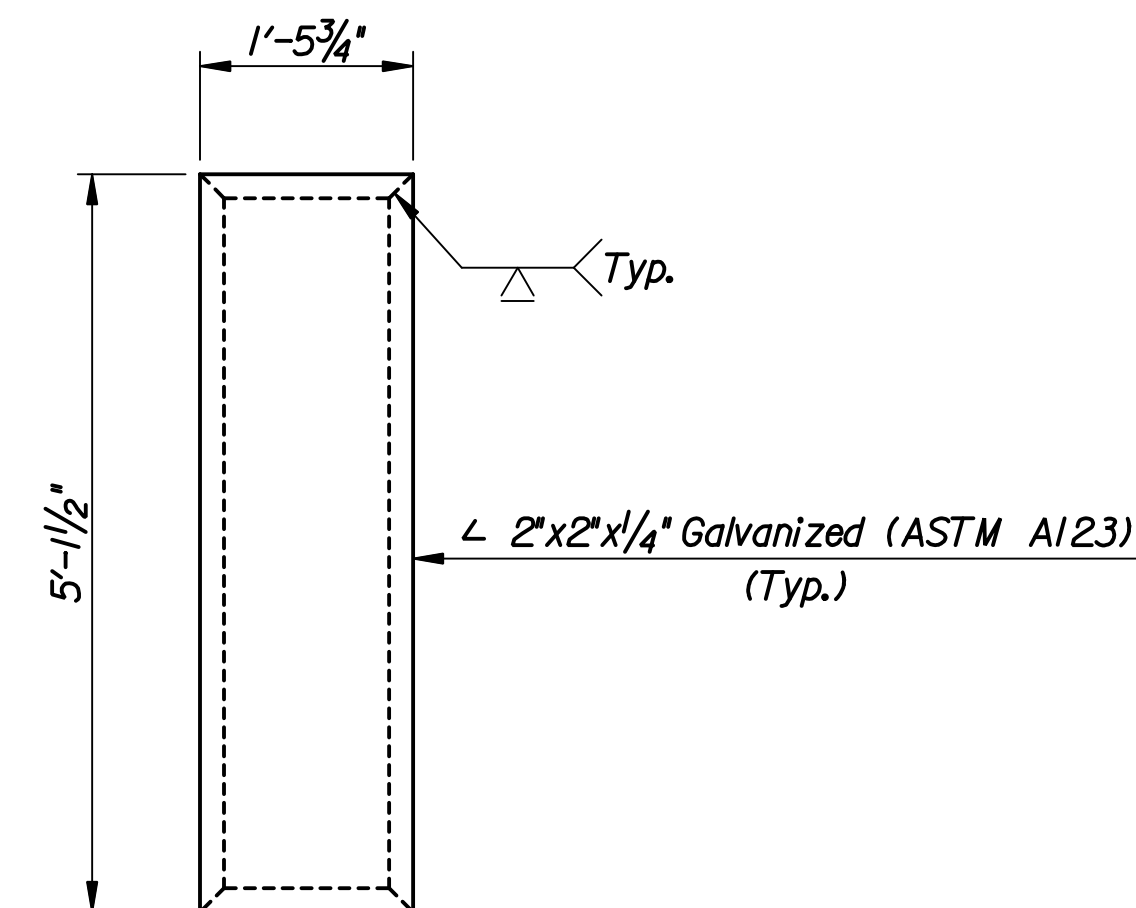

FRAME DETAIL

Frame to mate with 2 Neenah R-4853-A Grates or approved equal

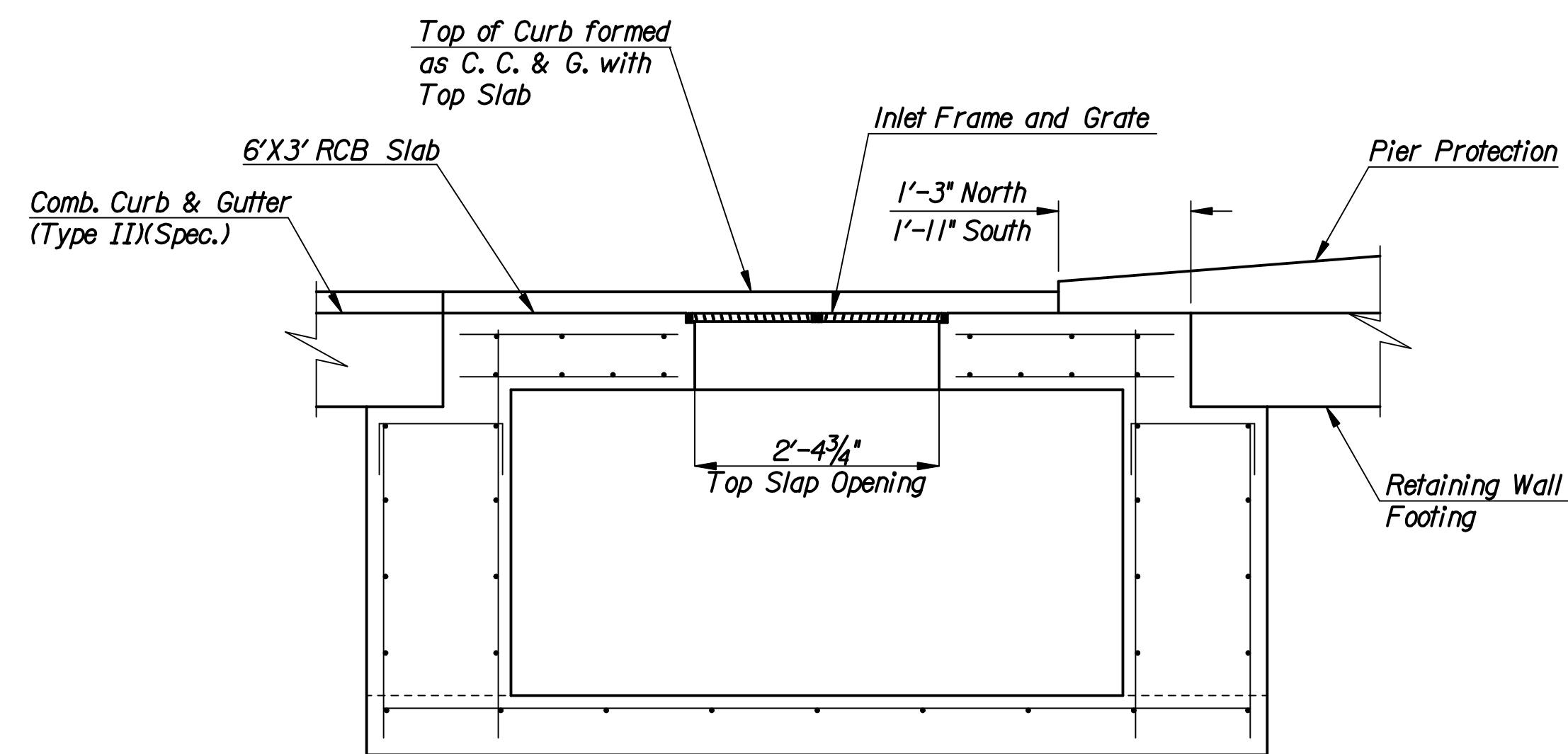

SECTION B-B

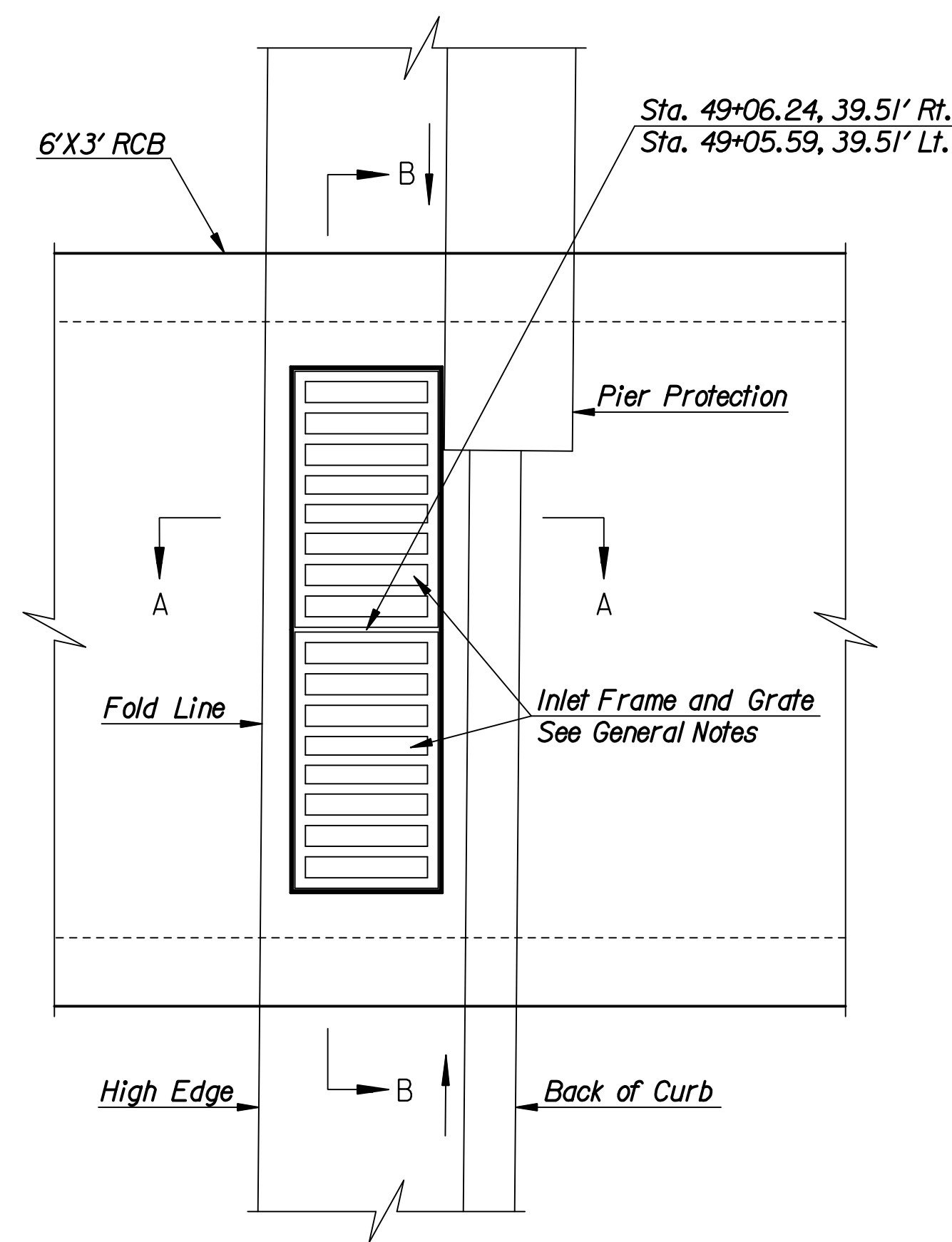

PLAN

Rt. Inlet Shown

GENERAL NOTES

1. Use Neenah R-4853-A Inlet Grates or approved equal. Inlet frame to be proof load tested to 40,000 lbs. on unsupported side.
2. The vanes of the grate shall be oriented with respect to the flow arrows shown on the plans.
3. DEETER FOUNDARY, Inc. casting No. 2442/43 with style H grate is an approved equal to NEENAH castings specified. Inlet drawing is based on NEENAH castings and some field modifications will be required to accommodate DEETER castings.

No.	Revision	By	Date
CENTRAL AVENUE			
INLET (TYPE II) (SPECIAL)			
JAMES L. ARMOUR, P.E. - CITY ENGINEER CITY OF WICHITA PROJECT NO. 472-84639			
Professional Engineering Consultants, P.A. 303 S. TOPEKA • WICHITA, KANSAS 67202 316-262-2691 • FAX 316-262-3003			
Designed by	RAS	Job No.	06655
Drawn by	DRP	Date	Jan. 2008
			Sht. 25 of 142

