

Benchmarks:

BM #1: Small RR spike in 2nd PP north of K-42 Highway, west side of Maize
Elev. = 143.61 (City Datum)

BM #2: Small RR spike in PP east of East 1/4 Corner (G)
Elev. = 147.00 (City Datum)

BM #3: "□" Top Headwall southeast corner K-42 Highway and Maize (County BM with City Datum)
Elev. = 144.04 (City Datum)

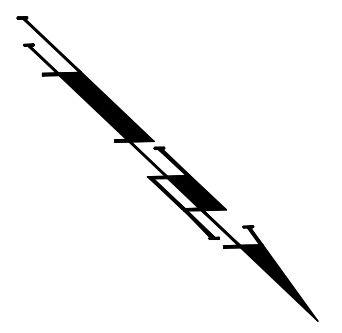

Scale: 1" = 20'
• = Iron

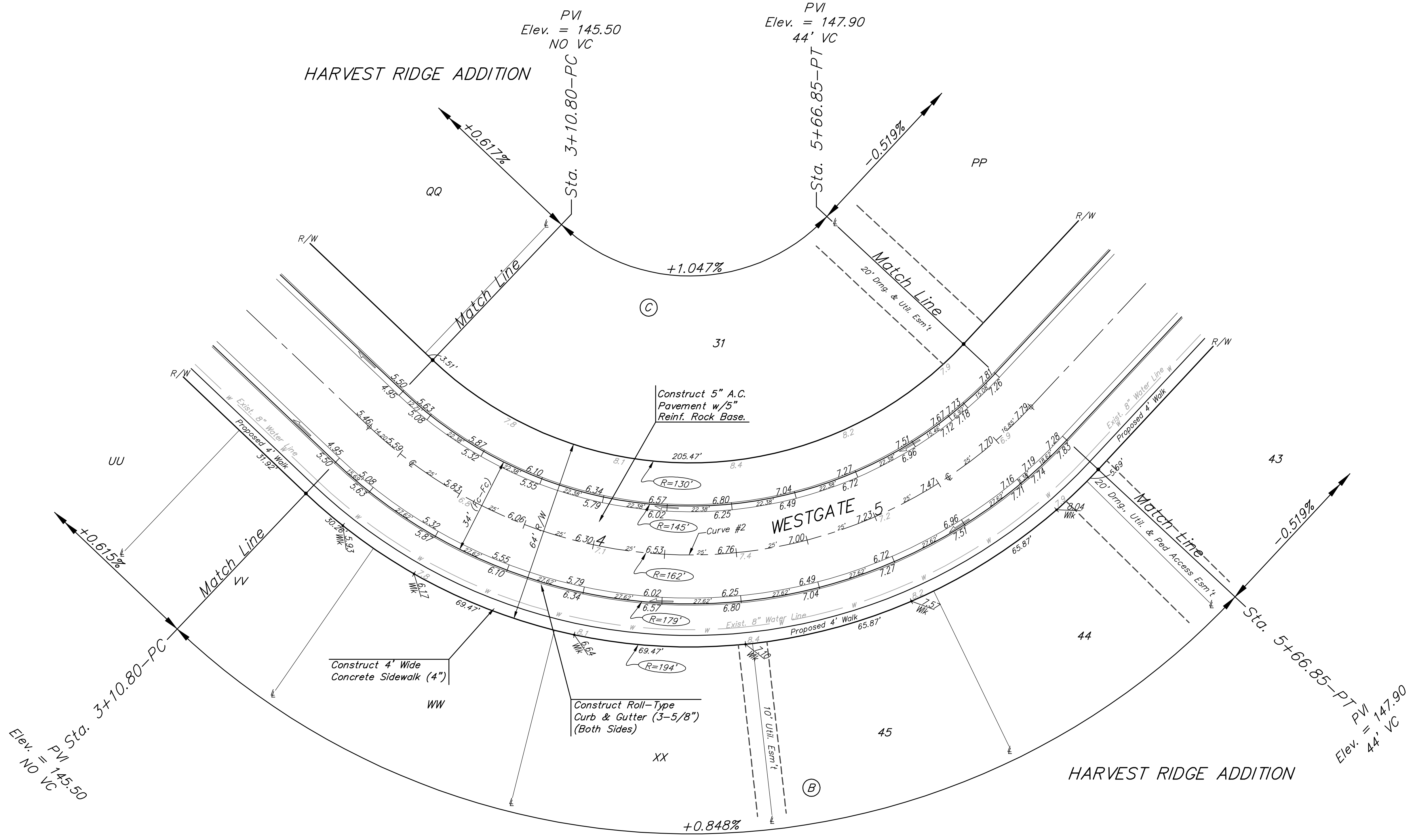

Curve #2
Curve Data Based on Centerline
Rad. = 162' Delta = 90° 33' 32" Tangent = 163.59'
Arc = 256.05' L.C. = 230.22' Def/ft. = 10.61030 Min.

Station	Arc	FACE CHORD LENGTHS		Defl.	T. Defl.
		8' Lt.	8' Rt.		
3+10.80	-	-	-	0°00'00"	0°00'00"
3+25.00	14.20'	12.00'	16.39'	2°30'40"	2°30'40"
3+50.00	25.00'	21.12'	28.83'	4°25'15"	6°55'55"
3+75.00	25.00'	21.12'	28.83'	4°25'16"	11°21'11"
4+00.00	25.00'	21.12'	28.83'	4°25'15"	15°46'26"
4+25.00	25.00'	21.12'	28.83'	4°25'16"	20°11'42"
4+50.00	25.00'	21.12'	28.83'	4°25'15"	24°36'57"
4+75.00	25.00'	21.12'	28.83'	4°25'16"	29°02'13"
5+00.00	25.00'	21.12'	28.83'	4°25'15"	33°27'28"
5+25.00	25.00'	21.12'	28.83'	4°25'16"	37°52'44"
5+50.00	25.00'	21.12'	28.83'	4°25'15"	42°17'59"
5+66.85	16.85'	14.24'	19.44'	2°58'47"	45°16'46"

Roll type curb & gutter to be constructed on the pavement on this sheet.
Top of curb elevation are given for full height curb.

	WESTGATE STA. 3+10.80 STA. 5+66.85	
	Harvest Ridge Addition - Phase II	
Baughman Company, P.A. 315 Ellis St. Wichita, KS 67211 P 3162627271 F 3162620149 ENGINEERING SURVEYING PLANNING LANDSCAPE ARCHITECTURE		
PROJECT NUMBER 472-83805	DESIGN MWS/JAK	DRAWN JAK
REVISIONS:	APPROVED MWS	DATE 4/12/06
SCALE Noted		SHEET 6 OF 34