

NOTE: Kansas Gas Service will relocate a portion of their existing lines prior to construction. Contractor shall be responsible for confirming that the relocation work has been completed prior to beginning work.

SCALE: 1" = 20'

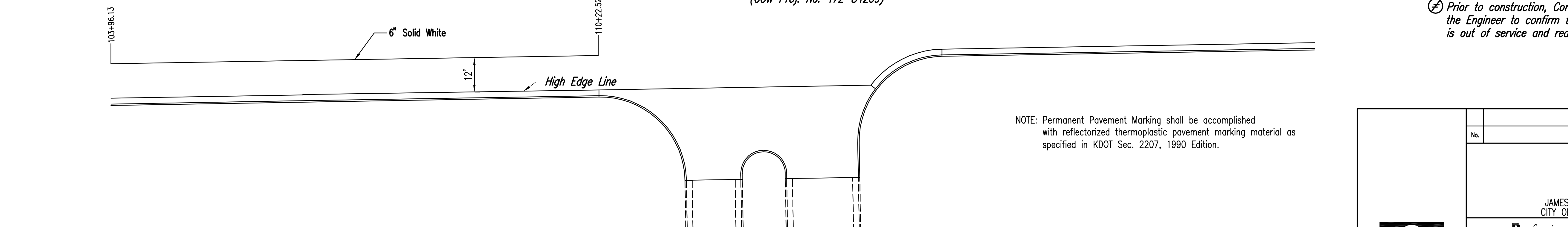
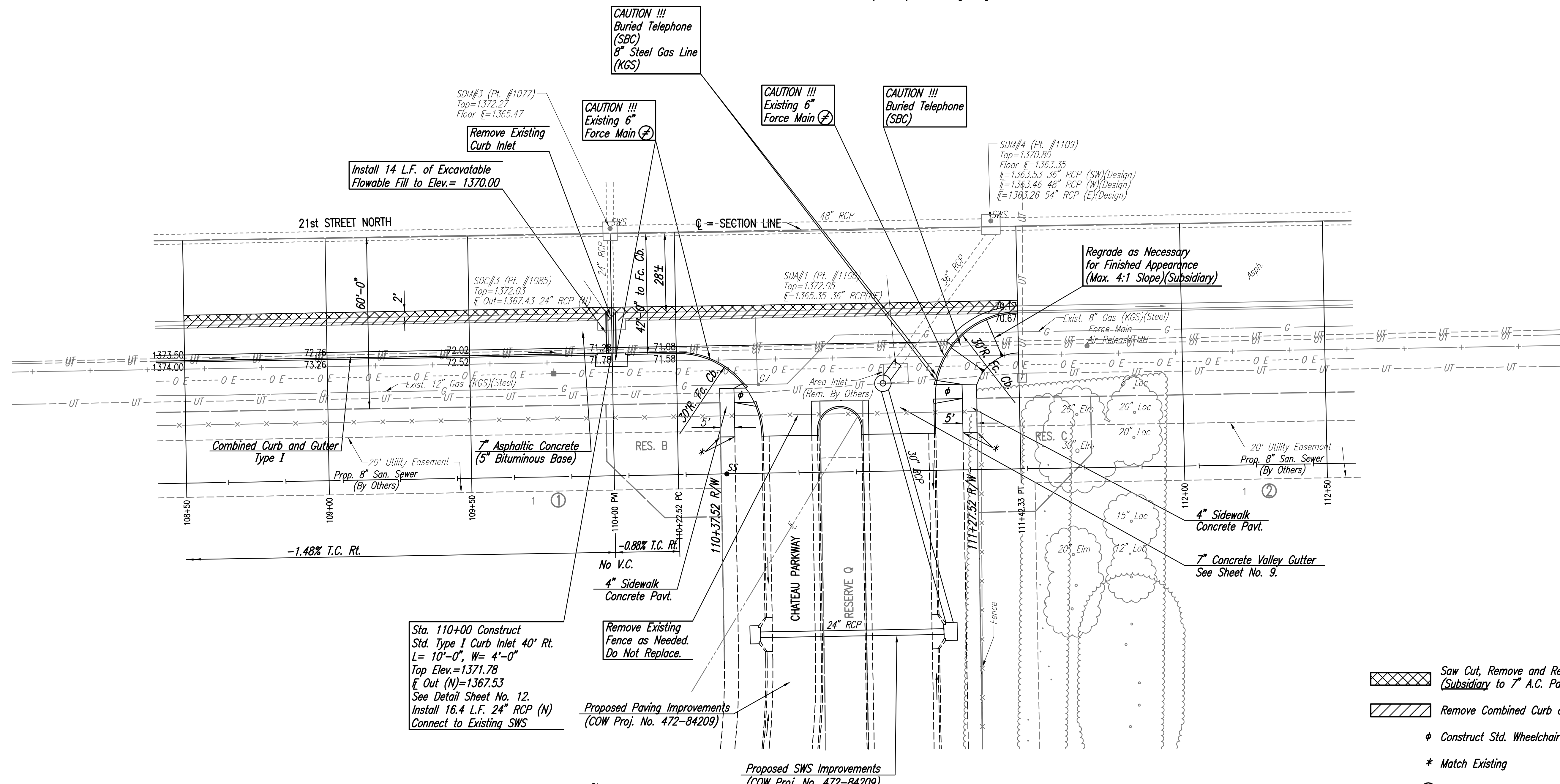

MARKING PLAN

- Saw Cut, Remove and Replace Asphalt Surface (Subsidiary to 7" A.C. Pavt.)
- Remove Combined Curb and Gutter
- ϕ Construct Std. Wheelchair Ramp
- * Match Existing
- \otimes Prior to construction, Contractor shall contact the Engineer to confirm that the force main is out of service and ready to be abandoned.

NOTE: Permanent Pavement Marking shall be accomplished with reflectorized thermoplastic pavement marking material as specified in KDOT Sec. 2207, 1990 Edition.

Served 06-05-2006 9:16:12 AM by BFC
 Plot Scale 1:20 06-05-2006 5:13:22 PM by BFC
 J:\SENTOU\2004\04688\003\2006-06-05 to City of Wichita.DWG 06-PAVING PLAN STA108+50-112+50

No.	Revision	By	Date
OAK CREEK - PHASE 1 21ST ST. N. DECEL LANE PAVING PLAN 108+60 TO 112+50 JAMES L. ARMOUR, P.E. - CITY ENGINEER CITY OF WICHITA PROJECT NO. 472-84206 Professional Engineering Consultants, P.A. 303 S. TOPEKA • WICHITA, KANSAS 67202 316-262-2691 • FAX 316-262-3003			
Designed by	BDB, BLB	Job No.	35-04688-003
Drawn by	BJS, JMU	Date	October 2004
			Sheet 6 of 28