

NOTES:

1. Two-lane, two-way access to Oak Creek Parkway shall be maintained at all times by constructing entrance half at a time, or other method approved by the Engineer.
2. Adjust Traffic Signal Video Detectors as Necessary to Provide Detection for North Bound Traffic.

SCALE: 1" = 20'

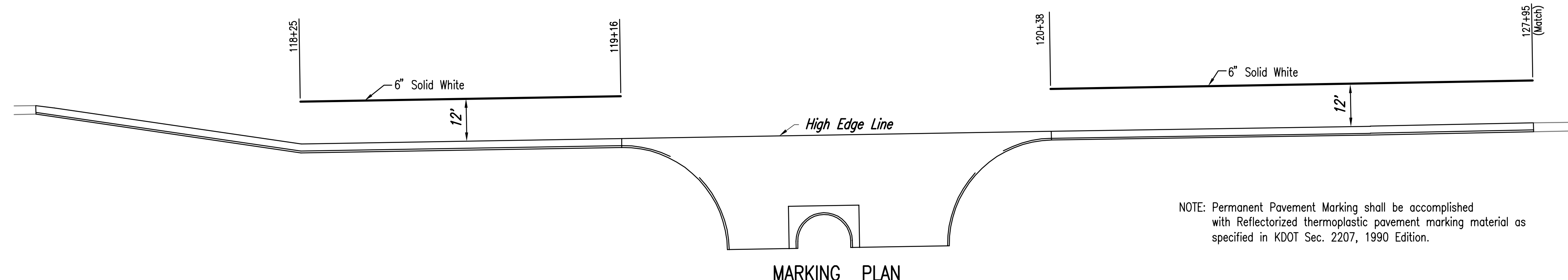
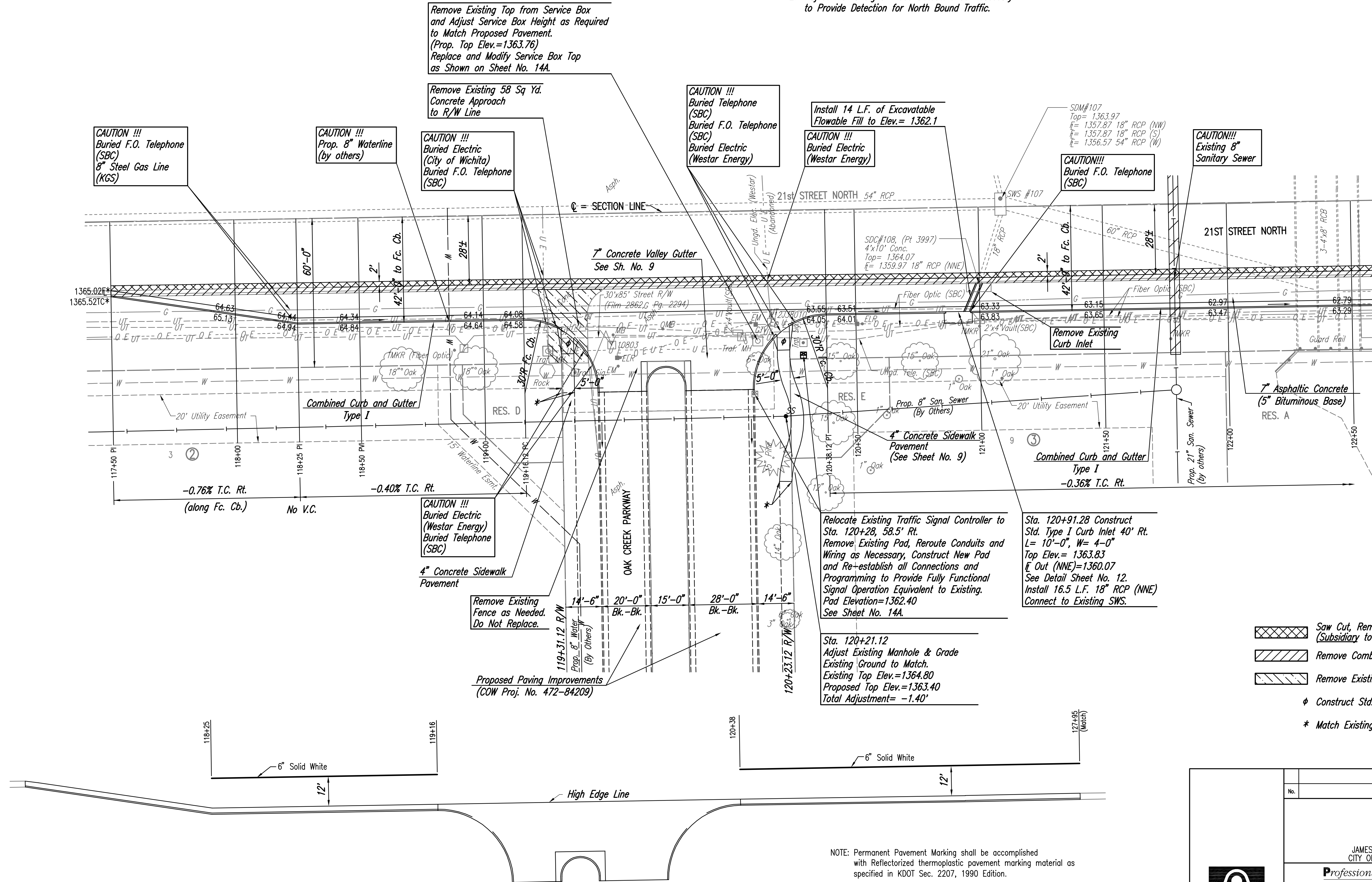

- Saw Cut, Remove and Replace Asphalt Surface (Subsidiary to 7\"/>
- Remove Combined Curb and Gutter
- Remove Existing Concrete Pavt.
- Construct Std. Wheelchair Ramp
- Match Existing

NOTE: Permanent Pavement Marking shall be accomplished with ReflectORIZED thermoplastic pavement marking material as specified in KDOT Sec. 2207, 1990 Edition.

Sowed: 06-05-2006 9:21:38 AM by BCL
 Plot Scale: 1:20 06-05-2006 5:12:58 PM by BCL
 J:\SENTOUT\2004\04688\003\206-06-05 to City of Wichita.DWG\07-PAVING PLAN STA117+50-122+50

No.	Revision	By	Date
OAK CREEK - PHASE 1 21ST ST. N. DECEL LANE PAVING PLAN 117+50 TO 122+50 JAMES L. ARMOUR, P.E. - CITY ENGINEER CITY OF WICHITA PROJECT NO. 472-84206			
Professional Engineering Consultants, P.A. 303 S. TOPKA • WICHITA, KANSAS 67202 316-262-2691 • FAX 316-262-3003			
Designed by	BDB, BLB	Job No.	35-04688-003
Drawn by	BJS, JMU	Date	October 2004
			Sheet 7 of 28