

TRAFFIC SIGNALIZATION FOR GATEWAY CENTER ADDITION

CITY OF WICHITA
SEDGWICK COUNTY, KANSAS
PROJECT NO. 472-83095

JIM ARMOUR, P.E. - ACTING CITY ENGINEER

OCA # 765850

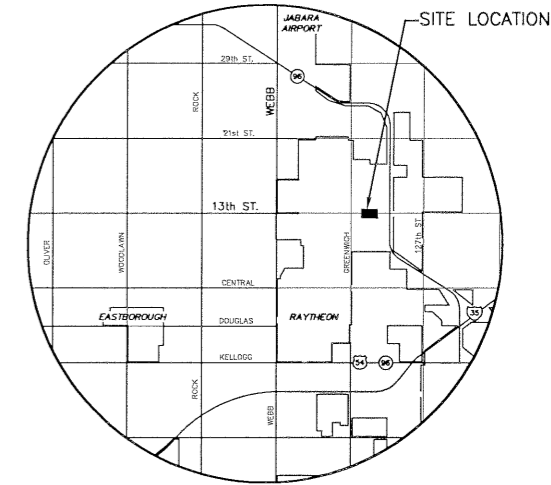
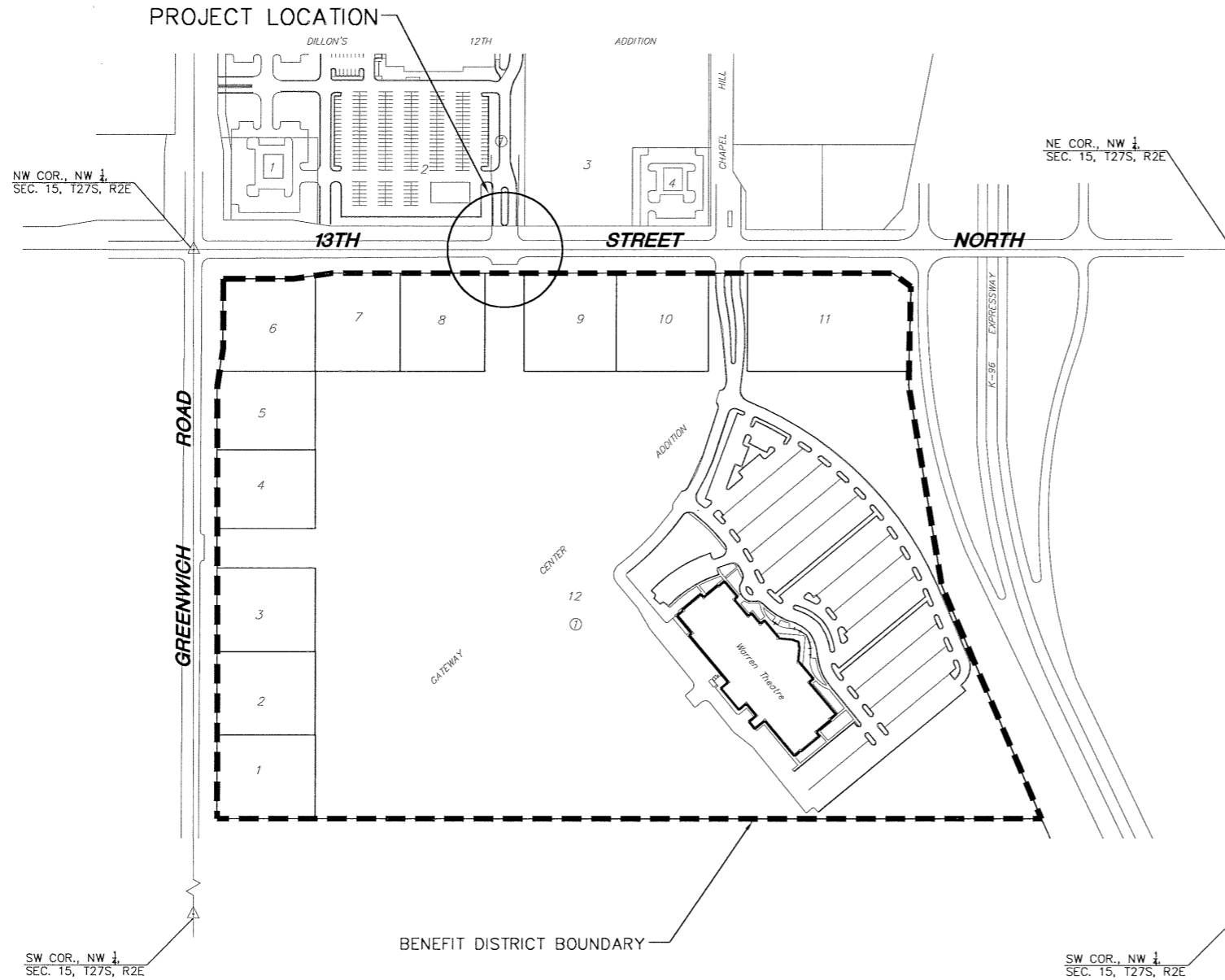

LOCATION MAP

INDEX TO DRAWINGS

| SHEET NO. | DESCRIPTION |
|-----------|---------------------|
| 1 | TITLE SHEET |
| 2 | SIGNAL PLAN |
| 3 | WIRING PLAN |
| 4 | PAVEMENT MARKING |
| 5 | JUNCTION BOX |
| 6 | SIGNAL POLE DETAILS |
| 7 | POWER POLE DETAILS |
| 8 | PLAT |



SCALE: 1" = 200'

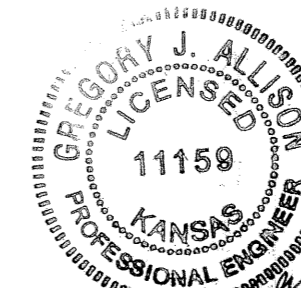

Gregory J. Allison
4/7/04

| | | | |
|---|--------------------------------|-------------|--|
| MKEC ENGINEERING CONSULTANTS 411 N. WEBB ROAD WICHITA, KS. 67206 316 - 684 - 9600 | GATEWAY CENTER ADDITION | | |
| | PROJECT NAME | | |
| SIGNALIZATION PLANS | | | |
| SHEET TITLE | | | |
| DFL | KKL | GJA | |
| DESIGN BY: | DRAWN BY: | CHECKED BY: | |
| APRIL 2004 | 98158SGT | 1 / 8 | |
| DATE | JOB NO. | SHEET/OF | |