

# Intersection of Oliver and Douglas STREET IMPROVEMENTS

Project #472-84609 OCA # 706970

CITY OF WICHITA, KANSAS  
Jim Armour, P.E., City Engineer

## GENERAL NOTES:

- Contractor will be required to provide notice to utility companies a minimum of twenty-four (24) hours prior to any excavation, as follows:

Kansas One-Call (316)687-2470

The Contractor must notify the following in case of an emergency:

Cox Communications (316)262-4270  
or (316)263-2061

Westar Energy/  
Kansas Gas & Electric Company (800)482-4950  
AT&T 1-555-1212  
City of Wichita Water Department (316)268-4908  
City of Wichita Sewer Department (316)268-4071  
Aquila Natural Gas (316)941-1608  
or (800)303-0357

- Exist. utilities and their locations, as shown on the plans, represent the best information attainable for design. Location information has been obtained from the various utility companies and is either from company record drawings or company-provided field locations. The Contractor will be required to work around existing utilities which do not conflict with proposed constructions.

- The Contractor to verify utility locations prior to construction of this project.

- Utility service and installation shall be coordinated with the respective utility owner.  
Contacts are:

Kansas Gas Service Jim Coe (316)832-3126  
Westar Energy Miles Capps (316)261-6251  
Aquila Networks Calvin Briggs (316)942-8811  
Wichita Water & Sewer Kerry Gibson (316)268-4555  
AT&T Jim Toben (316)268-2759  
Cox Communications Mark Anaya (316)262-4270

- Traffic affected by the construction of this project shall be handled in accordance with the latest edition of the Manual on Uniform Traffic Control Devices.

- It is the contractor's responsibility to visit this site to better understand the extent of site clearing and restoration to be performed. Site Clearing and Restoration shall include all costs for removal of items which a pay item is not provided.

- The contractor shall be responsible for preserving property irons. The contractor will be required to re-establish any property irons which are damaged or destroyed by the construction operations. Such irons shall be re-established by a licensed land surveyor in accordance with state laws.

- Properties within the project limits may have underground sprinkler systems in public right-of-way which conflict with new construction. Contractor will be required to remove such improvements should they not be removed by their owner at the time of construction of the project. The contractor will be required to salvage all sprinkler heads and/or valves and give such material to owner. Portions of underground sprinkler systems not in conflict with new construction shall be protected from damage and shall remain in place. All work in connection with underground sprinkler systems shall be considered as subsidiary to the contract pay items for work.

- It is contractor's responsibility to sod all the disturbed areas.

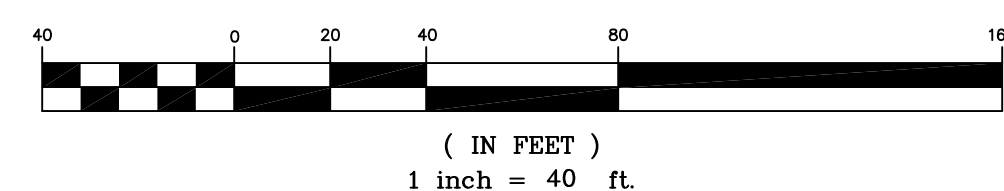
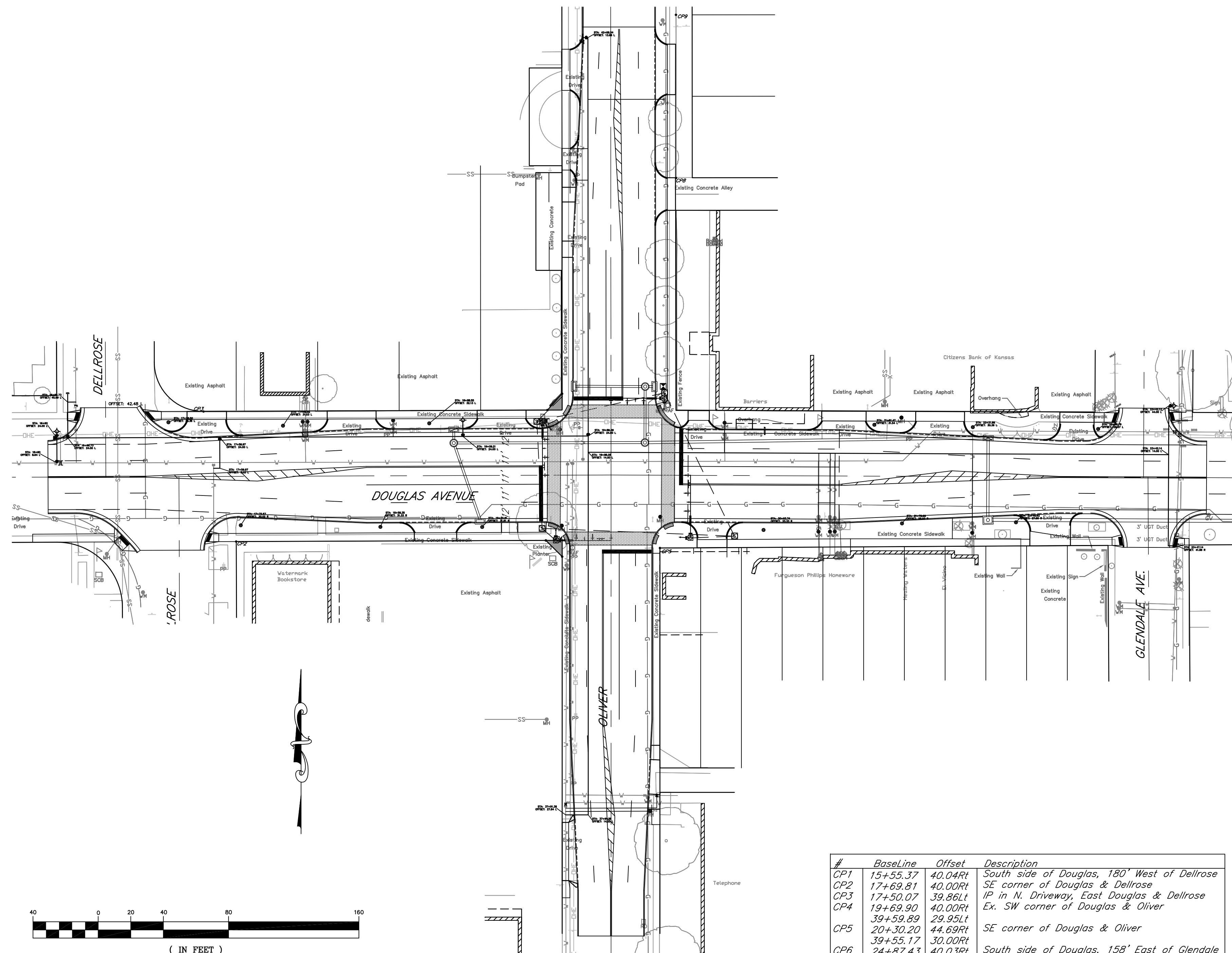

February 2008

| #    | BaseLine | Offset  | Description                                  |
|------|----------|---------|--|
| CP1  | 15+55.37 | 40.04Rt | South side of Douglas, 180' West of Dellrose |
| CP2  | 17+69.81 | 40.00Rt | SE corner of Douglas & Dellrose              |
| CP3  | 17+50.07 | 39.86Lt | IP in N. Driveway, East Douglas & Dellrose   |
| CP4  | 19+69.90 | 40.00Rt | Ex. SW corner of Douglas & Oliver            |
| CP5  | 39+59.89 | 29.95Lt |  |
|      | 20+30.20 | 44.69Rt | SE corner of Douglas & Oliver                |
| CP6  | 39+55.17 | 30.00Rt |  |
| CP7  | 24+87.43 | 40.03Rt | South side of Douglas, 158' East of Glendale |
| CP8  | 36+54.71 | 29.96Lt | NW corner of Oakland & Oliver                |
| CP9  | 41+52.29 | 40.07Rt | North corner of Alley on Oliver              |
| CP10 | 42+82.44 | 40.07Rt | IP east side of Oliver, 282' N of Douglas    |
|      | 44+17.92 | 29.93Lt | IP west side of Oliver, 418' N of Douglas    |

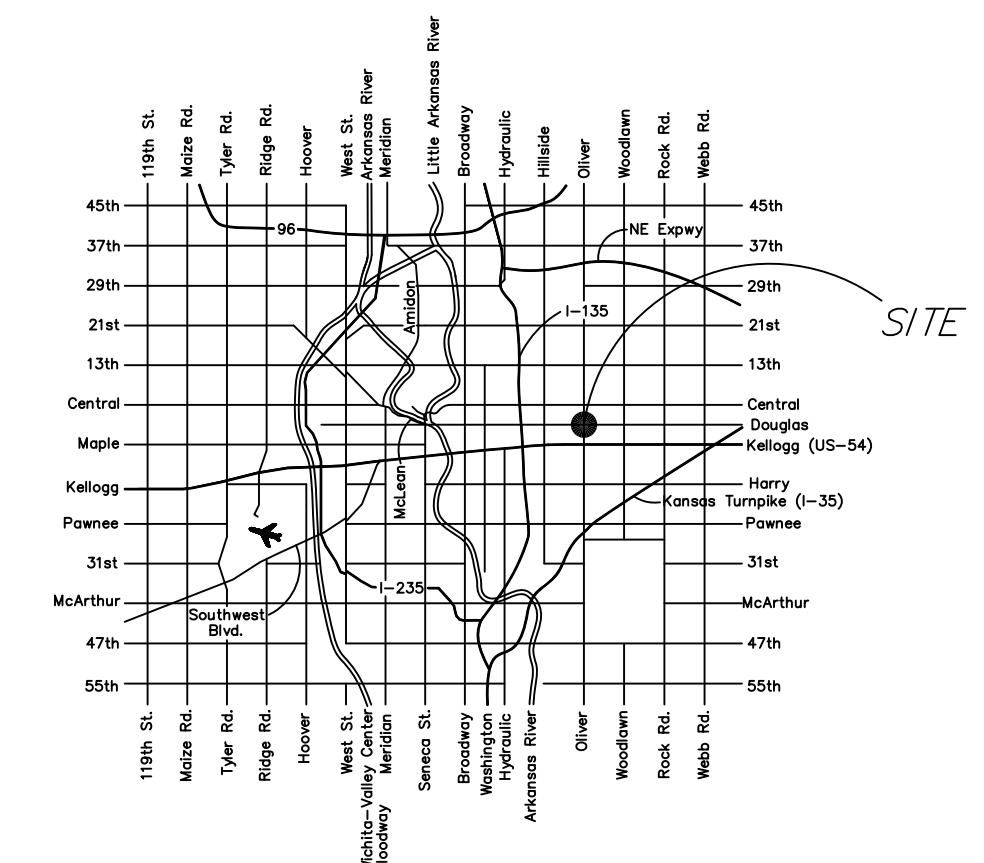

## LOCATION MAP

### Index of Sheets:

- Title Sheet
- Typical Pavement Sections
- Paving Details
- Quantities Sheet
- Wheelchair Ramp Detail
- Conc. Pavement Detail
- Dowel joint Detail
- Driveway & Paver Details
- Paving Plan Sta 16+25 to 20+00
- Paving Plan Sta 20+00 to 23+65
- Paving Plan Sta 37+17 to 42+85
- Site Clearing & Restoration
- Intersection Details
- Joint Plan
- Water Plans
- Water Details
- Erosion Control Plan
- Erosion BMP's
- Pavement Marking Plan
- Signalization Plan
- Wiring Diagram
- Signalization Details
- SWS 1
- SWS 2
- Type 2 Inlet
- Type 1 Inlet
- Shallow Type P MH
- Traffic Control Plan
- General Traffic Control
- Channelizing Devices
- Traffic Control Signs
- Traffic Control Details
- Cross Sections
- Control & Coordinate Map
- Electrical Plans

### Benchmark:

City Disk, NE C.O.W. Traffic Base @  
intersection of Oliver & Douglas  
Elev. = 168.34 (City Datum)

City Disk, NW corner of Douglas & Oliver  
Elev. = 169.07 (City Datum)



516 S. Market,  
Wichita, KS 67202

316/264-0242