

**NOTES:**

1. Contractor shall remove and deliver to GME, 1801 S. McLean for City of Wichita existing signals, signal poles, controller, cabinet, and manhole covers. Contractor shall notify Traffic Engineering Department two weeks prior to start of construction. Delivery of salvageable items is non-participating.
2. Traffic to be carried through construction. See Construction Traffic Control Plan.
3. Contractor shall contact all utility companies which may be affected by this construction prior to beginning of construction.
4. Service Box, Junction Box and conduit runs are typical only and should be adjusted during installation to clear obstructions and facilitate wiring.
5. The traffic signal system shall be complete and the Contractor shall furnish and install all equipment necessary for the satisfactory operation of electrical apparatus and for the complete operation of traffic signal system whether specifically mentioned or not.
6. All the equipments for traffic signalization are block.

**LEGEND:**

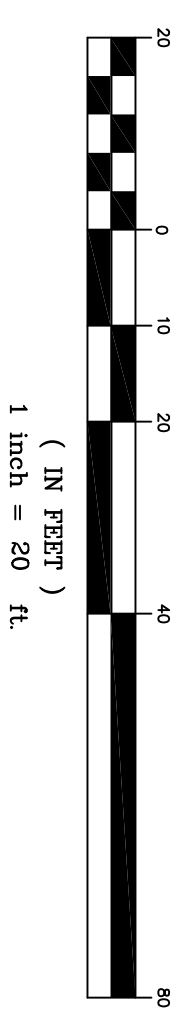
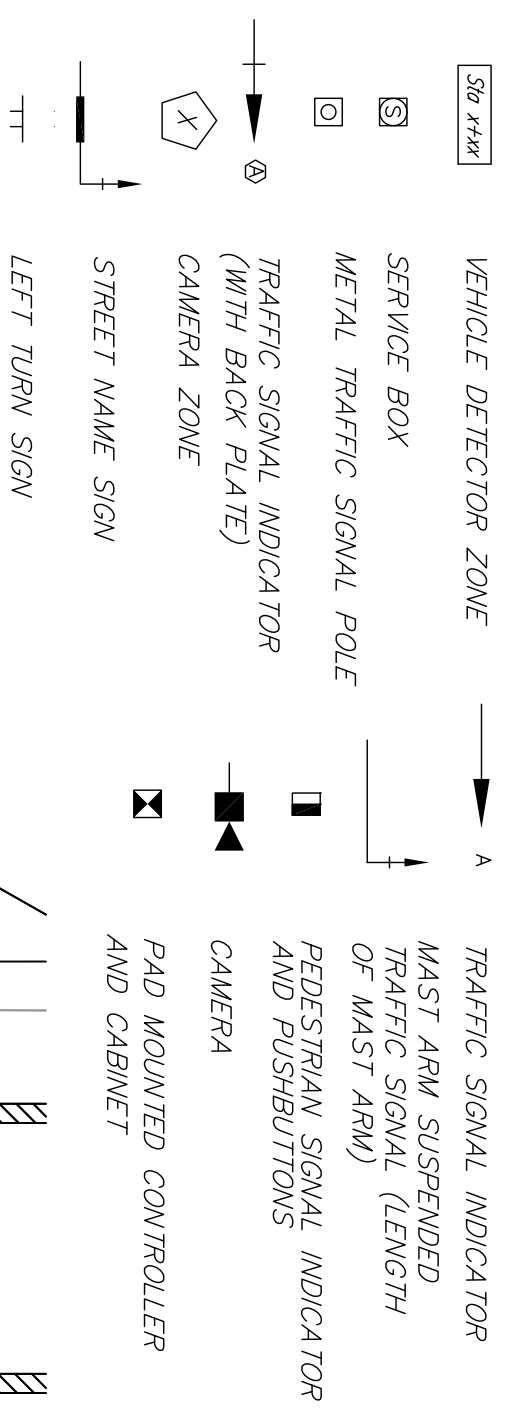

Contractor to install 2" conduit to new traffic signal pole at station 19+58.75. Install riser of pole and OH splice kit.

STA 19+58.33 RT TRAFFIC SIGNAL POLE W/ 33.4' MAST ARM, & 2 PED SIGNALS

STA 19+58.33 LT SERVICE BOX

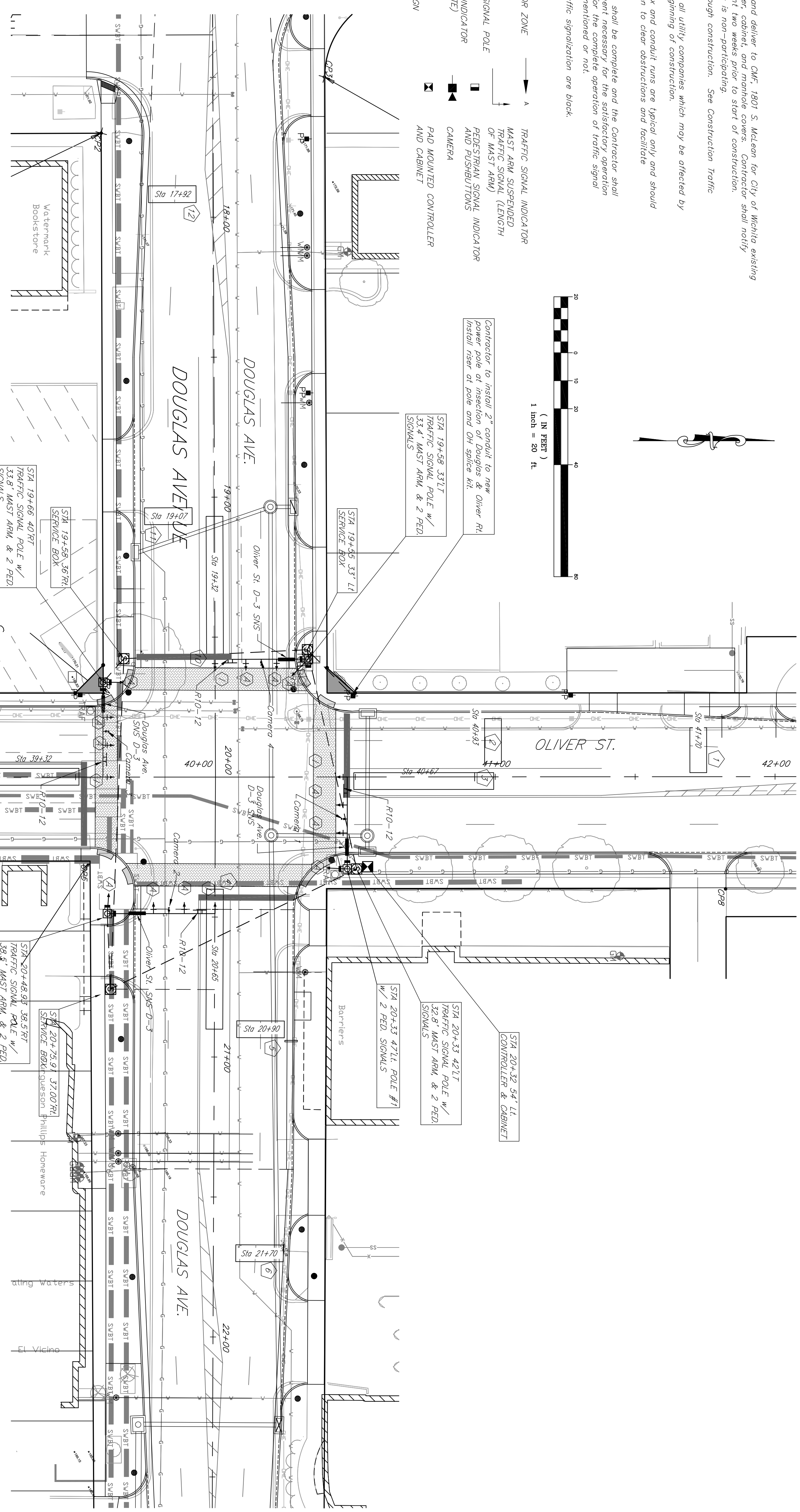

"WASHI PROGRAM"		PHASE								TIME CLOCK								NORMAL DISPLAY									
INTERVAL		1	2	3	4	5	6	7	8	C									F								
MAX 0	30	80	30	80	30	80	30	80	0	NEAR									VEH. RECALL								
MAX 2	30	80	30	80	30	80	30	80	1	MONTH									PED. RECALL								
MAX 2	30	80	30	80	30	80	30	80	2	DAY / MONTH									PED. LOCK								
FL. DK	3	20	20	20	20	20	20	20	3	DAY / WEEK								YELLOW LOCK									
MAX INTL	4	6.0	10.0	6.0	10.0	6.0	10.0	6.0	10.0	4 HOUR									FL. PERMIT								
MAX GREEN	5	5.0	8.0	5.0	8.0	5.0	8.0	5.0	8.0	5 MINUTE									PED. PHASES								
TRM	6	1.0	15.0	1.0	15.0	1.0	15.0	1.0	15.0	6 SECOND									LEAD PHASES								
TRM	7	1.0	25.0	1.0	25.0	1.0	25.0	1.0	25.0	7									DEB. EMPTY								
TRM	8	-	-	-	-	-	-	-	-	8									SEQUENTIAL								
PASSAGE	9	1.0	2.0	1.0	2.0	1.0	2.0	1.0	2.0	9									STARTUP								
MIN. GAP	A	1.0	2.0	1.0	2.0	1.0	2.0	1.0	2.0	A									OVERLAP A								
ADD. ACT	B	1.0	2.0	1.0	2.0	1.0	2.0	1.0	2.0	B									OVERLAP B								
YELLOW	C	3.0	4.0	3.0	4.0	3.0	4.0	3.0	4.0	C									OVERLAP C								
RED CLR.	D	1.0	1.5	1.0	1.5	1.0	1.5	1.0	1.5	D									OVERLAP D								
RED REV.	E	-	-	-	-	-	-	-	-	E									EXCLUSIVE								
MAX. II	F	-	-	-	-	-	-	-	-	F									SIM. GAP								

ZONE	SIZE	CAMERA	MONITOR CALLED
1	6 H x 16 H	3	6
2	6 H x 16 H	3	6
3	6 H x 20 H	3	1
4	6 H x 50 H	4	3
5	6 H x 17 H	4	8
6	6 H x 17 H	4	8
7	6 H x 50 H	1	5
8	6 H x 16 H	1	2
9	6 H x 16 H	1	2
10	6 H x 50 H	2	7
11	6 H x 17 H	2	4
12	6 H x 17 H	2	4

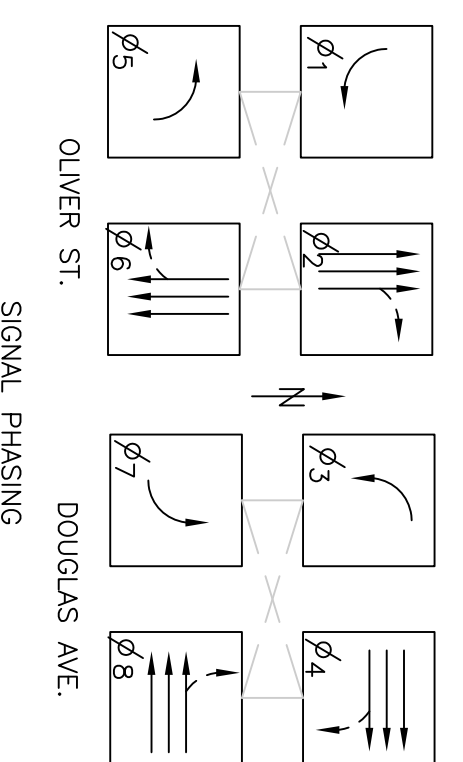

**Kemiller**  
engineering

516 S. Warren  
Wichita, KS 67202

316/284-0242

PROJECT NUMBER  
472-83755

Intersection Improvement for Douglas & Oliver  
Signalization Plan  
City of Wichita

KEY NO. 03033	FILE SIGNAL 1	DATE 7/5/05	SHEET 26
DESIGN PB	DRAWN PB	REVISION 2/15/08	OF 49