

PROJECT BENCHMARKS

- BM #1- Chiseled "+" Located in sidewalk @ the NE Property Corner of the Intersection of Wabash Ave. and 1st Street North. Elev. = 1295.76 (MSL)
- BM #2- Chiseled "+" Located in sidewalk @ the NW Property Corner of the Intersection of Wabash Ave. and 2nd Street North. Elev. = 1297.15 (MSL)
- BM #3 - Small RR spike Located in South Face of Guy-Pole at the NW Corner of the Intersection of Wabash and 3rd Street North. Elev. = 1297.94 (MSL)
- BM #4 - Small RR spike Located in South Face of Pwr-Pole at the NE Corner of the Intersection of Mosley and 3rd Street North. Elev. = 1297.92 (MSL)
- BM #5- Chiseled "+" Located top of curb in the Northwest Corner of the Intersection of Mead Ave. and 3rd Street North. Elev. = 1298.90 (MSL)

CONTROL POINTS

Number	Northing	Easting	Description
22	3141.54	2689.57	PK Nail in Wabash Approx. 165' South of 2nd Cross at NW Property Corner of Wabash & 2nd
23	3340.28	2649.72	Thimble in Intersection of Wabash & 3rd
24	3979.32	2680.67	Thimble in Intersection of Wabash & 3rd
25	3975.51	2380.07	Thimble in Intersection of Washington & 3rd
26	3985.43	2029.06	Hill Nail in Intersection of Mosley & 3rd
28	4003.39	1841.02	Cross in NW Corner of Intersection of Rock Island & 3rd
29	3593.33	2691.15	PK Nail in Wabash Approx. 290' North of 2nd
30	3971.10	2293.66	PK Nail in 3rd Street Just West of Washington
31	3997.45	1618.04	Cross on Back of Curb NW of Mead & 3rd
63	2670.50	2678.87	Thimble in Wabash North of 1st
3648	3305.34	2378.62	Thimble in 2nd East of Washington
3837	3269.38	2649.55	PK Nail at SW Property Corner of Wabash & 2nd
5024	3950.28	1818.02	Rebar SW of Rock Island & 3rd

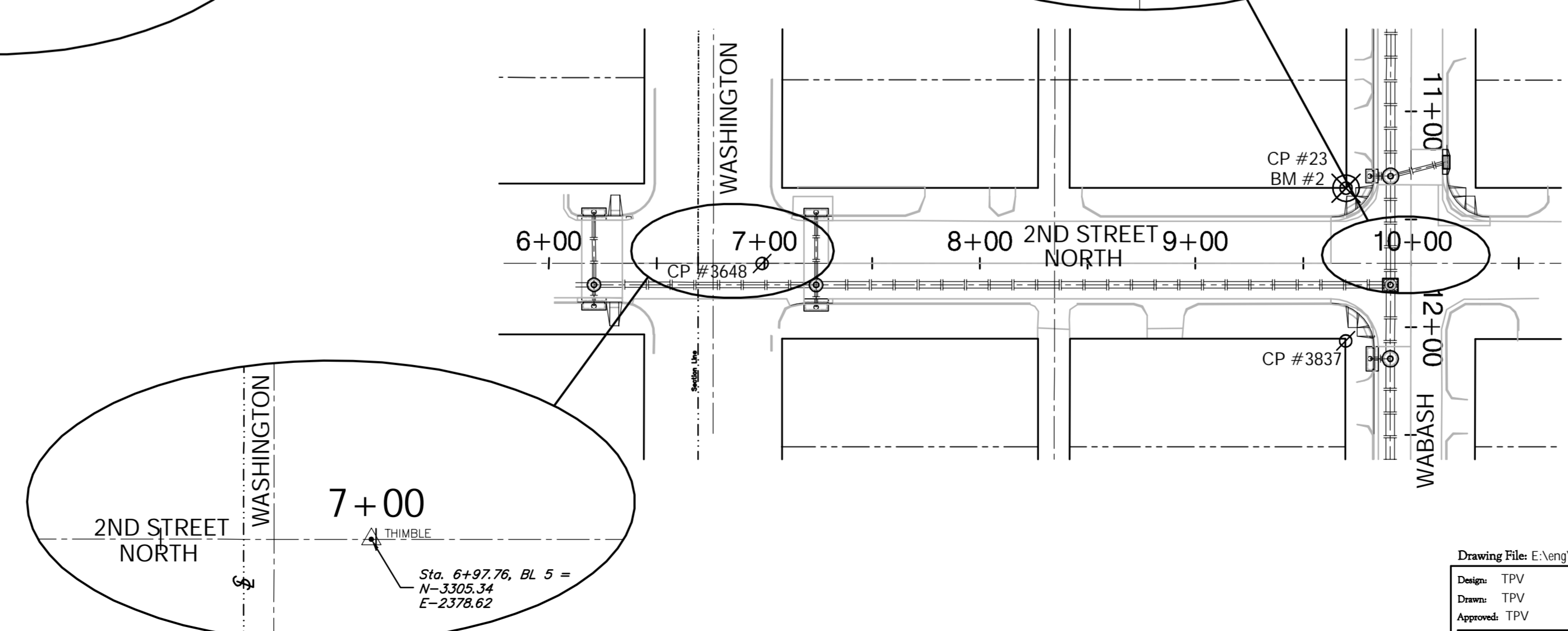

Drawing File: E:\eng\Old Town Drainage Ph 2\Keysheet.dwg
 Design: TPV
 Drawn: TPV
 Approved: TPV
 Scale: 1" = 50'

Project No. 0610E682 CITY OF WICHITA, KANSAS
PROJECT KEYSHEET
 DOUGLAS AVENUE DRAINAGE OUTFALL PROJECT - PHASE 2

Baughman Company, P.A.
 315 Ellis St., Wichita, KS 67211 P 316-262-0149 F 316-262-0149
 ENGINEERING | SURVEYING | PLANNING | LANDSCAPE ARCHITECTURE