

Benchmarks  
 BM #3 - Small RR spike Located in South Face of Guy-Pole at the NW Corner of the Intersection of Wabash and 3rd Street North.  
 Elev. = 1297.94 (MSL)

N-3991.86 E-2637.18  
 Sta. 0+00.00, Begin SWS Line 4g  
 Construct Double Type 1 Inlet  
 (11' 4" X 4' 4")  
 Top Elev = 1296.65

N-3975.35 E-2637.18  
 Sta. 0+16.51, End SWS Line 4g =  
 Sta. 13+08.07, SWS Line 4  
 Connect to Prop. Manhole,  
 Grout, & Seal Tight.

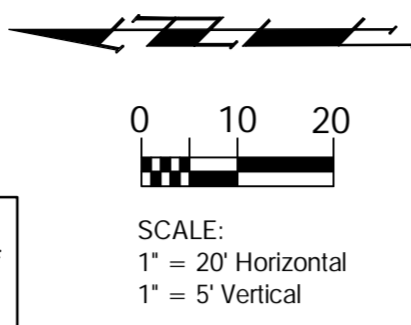
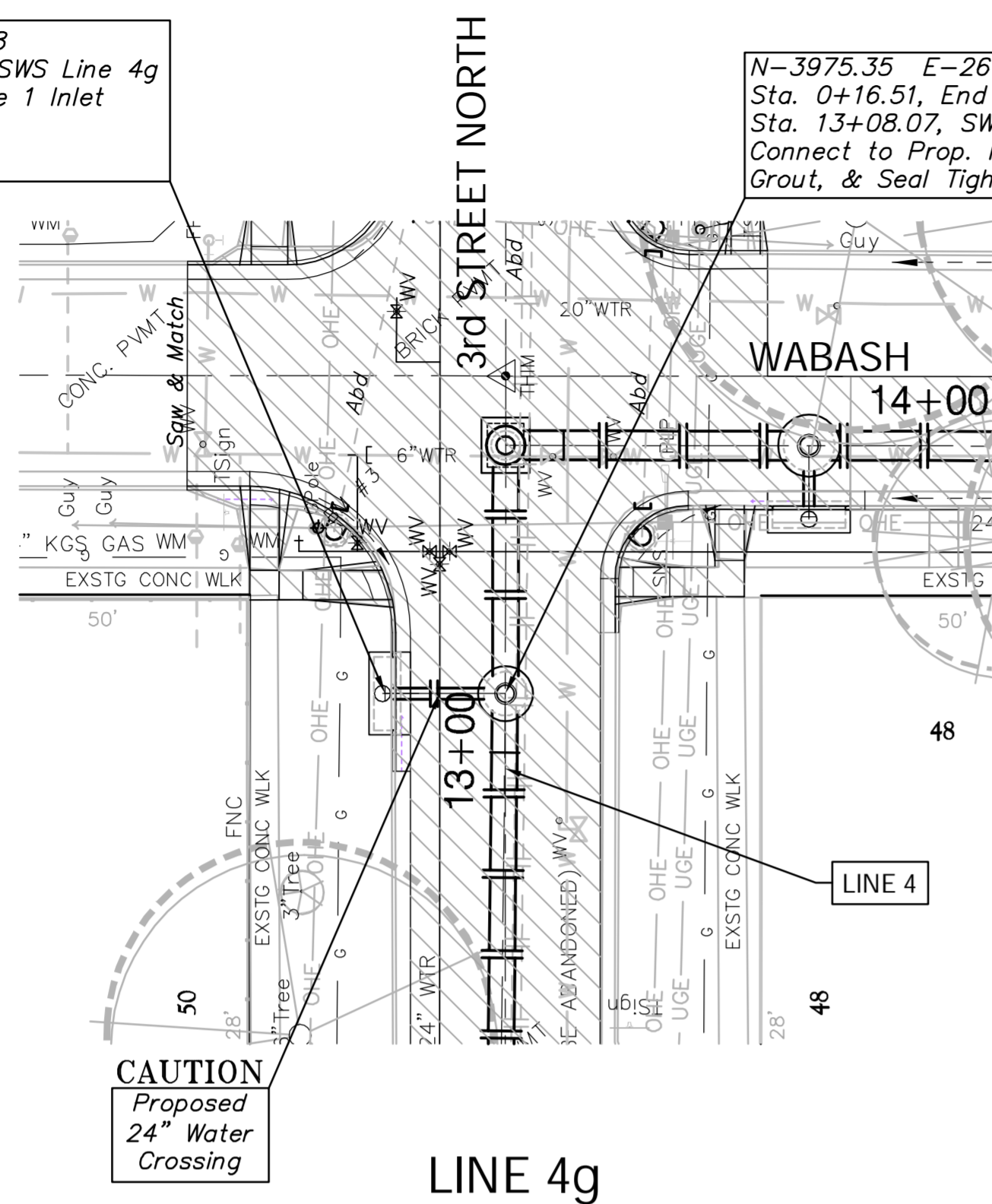

Benchmarks  
 BM #3 - Small RR spike Located in South Face of Guy-Pole at the NW Corner of the Intersection of Wabash and 3rd Street North.  
 Elev. = 1297.94 (MSL)

N-3933.78 E-2661.38  
 Sta. 0+00.00, Begin SWS Line 4h  
 Construct Double Type 1 Inlet  
 (11' 4" X 4' 4")  
 Top Elev = 1296.40

N-3933.76 E-2671.12  
 Sta. 0+9.75, End SWS Line 4h =  
 Sta. 13+83.62, SWS Line 4  
 Connect to Prop. Manhole, Grout,  
 & Seal Tight.

