

Benchmarks
 BM #3 - Small RR spike Located in South Face of Guy-Pole at the NW Corner of the Intersection of Wabash and 3rd Street North.
 Elev. = 1297.94 (MSL)

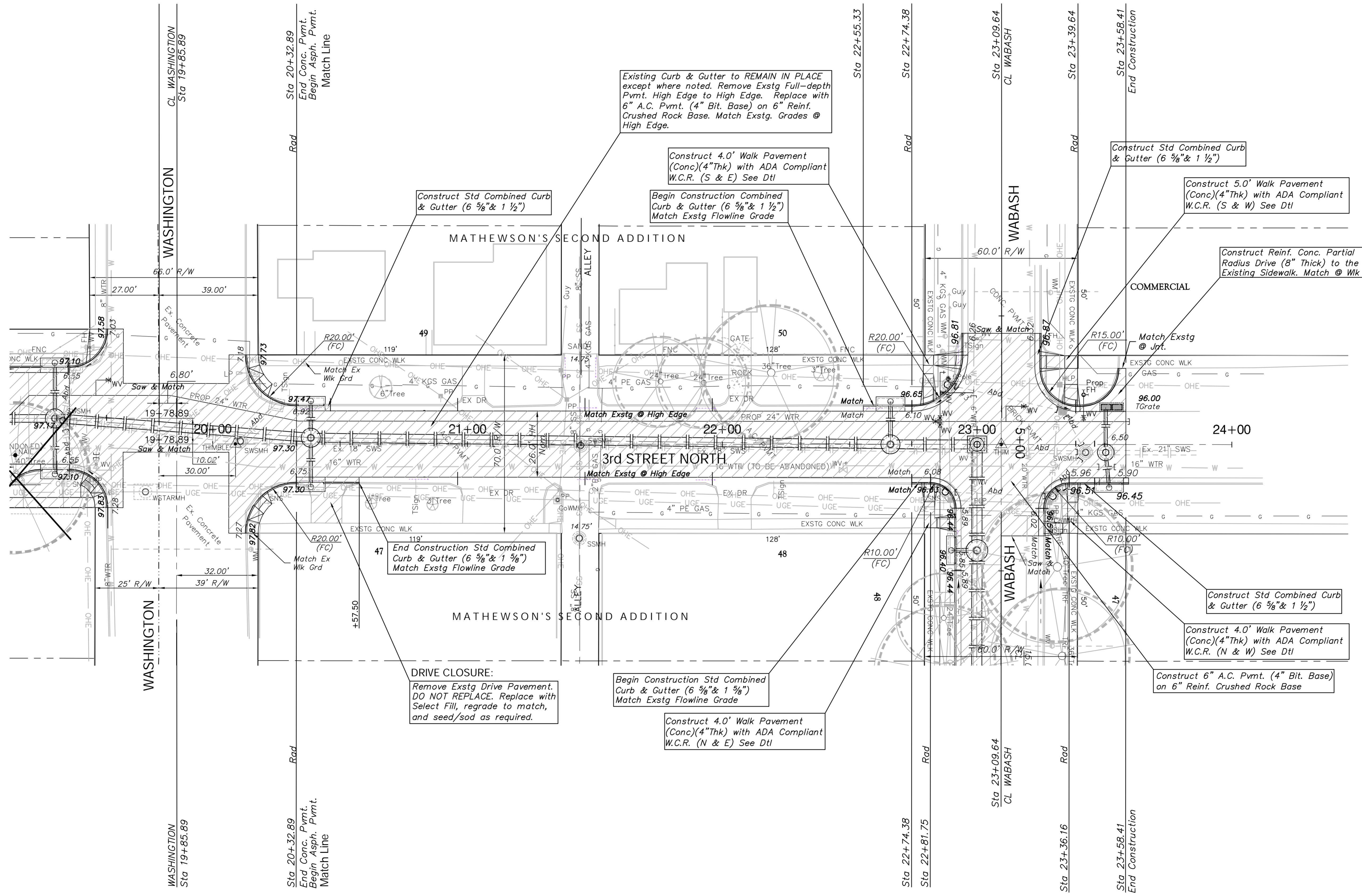
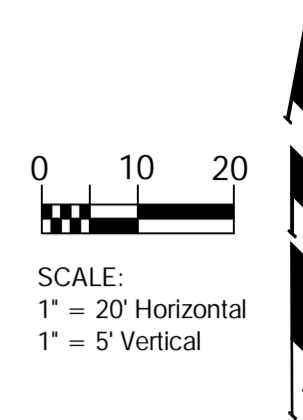

Note:
 Trees/Shrubs to be removed are marked thus:

Note:
 Pavement, Sidewalks, and Etc. To Be Removed Are Indicated By:

Drawing File: E:\eng\Old Town Drainage Ph 2\Land\drgr\oldtown base.dwg (Pav 03)
 Project No. 0610E682 CITY OF WICHITA, KANSAS
 Design: KK
 Drawn: TCA
 Approved: JFB
 Scale: NOTED

3RD STREET NORTH PAVING
 DOUGLAS AVENUE DRAINAGE OUTFALL PROJECT - PHASE 2

Baughman Company, P.A.
 315 Ellis St. Wichita, KS 67211 P 316-262-7271 F 316-262-0149
 Baughman ENGINEERING | SURVEYING | PLANNING | LANDSCAPE ARCHITECTURE