

**Benchmarks**

BM #3 - Small RR spike Located in South Face of Guy-Pole at the NW Corner of the Intersection of Wabash and 3rd Street North. Elev. = 1297.94 (MSL)

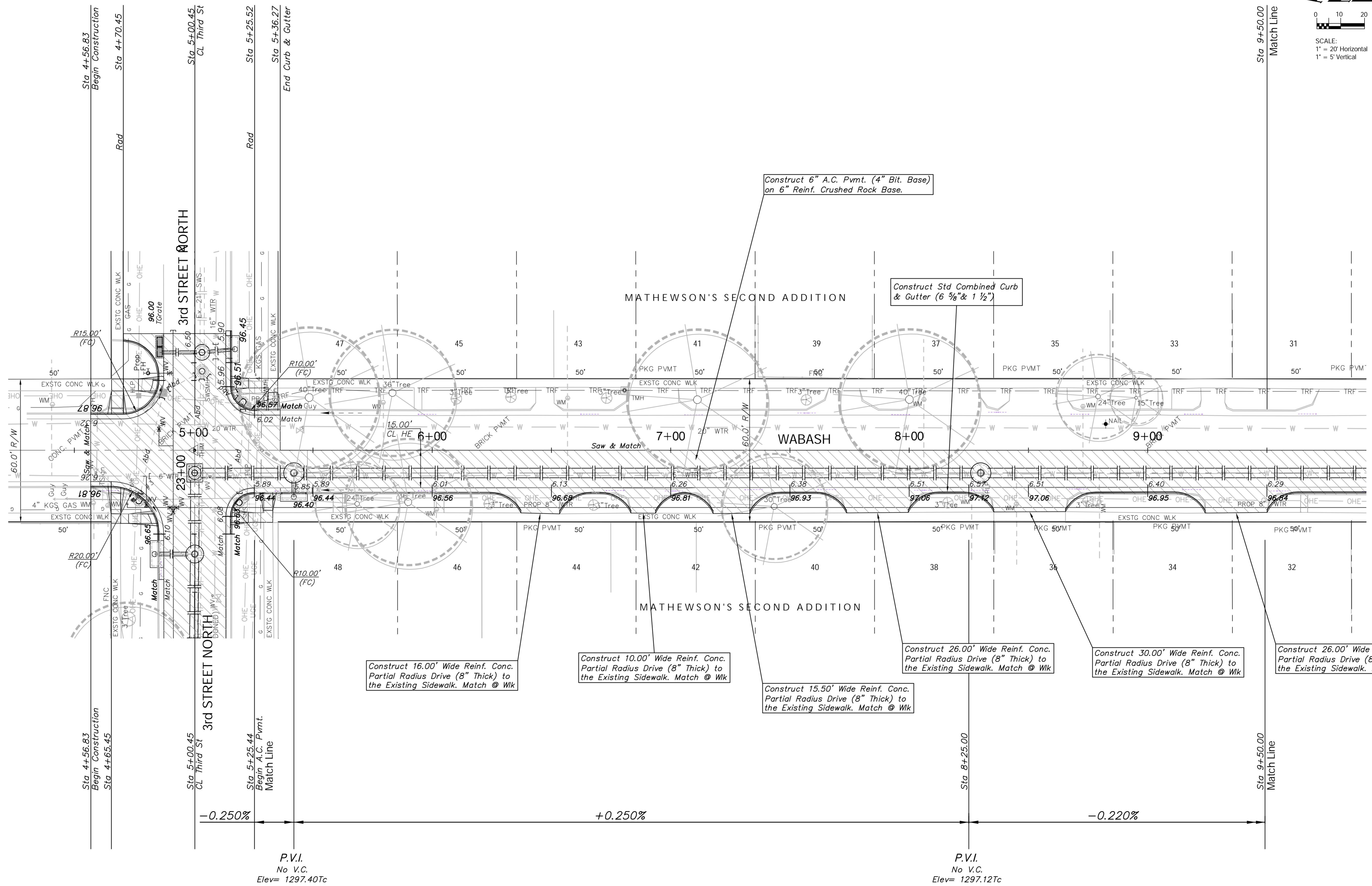
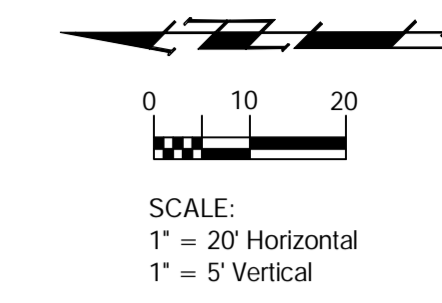

P.V.I.  
No V.C.  
Elev= 1297.40Tc

P.V.I.  
No V.C.  
Elev= 1297.12Tc

Drawing File: E:\eng\Old Town Drainage Ph 2\Land\dwg\oldtowne base.dwg (Rev 04)  
Project No. 0610E682 CITY OF WICHITA, KANSAS  
Design: KK  
Drawn: TCA  
Approved: JFB  
Scale: NOTED  
**WABASH PAVING**  
DOUGLAS AVENUE DRAINAGE OUTFALL PROJECT, PHASE 2

**Baughman Company, P.A.**  
315 Ellis St. Wichita, KS 67211 P 316-262-7271 F 316-262-0149  
ENGINEERING | SURVEYING | PLANNING | LANDSCAPE ARCHITECTURE

February 2008  
SHEET  
OF 42  
42  
OF 54