

GENERAL NOTES

- ALL CONSTRUCTION AND MATERIALS TO COMPLY WITH CITY OF WICHITA SPECIFICATIONS AND STANDARDS.
- ALL ELEVATIONS SHOWN ARE BASED ON CITY OF WICHITA DATUM. (USGS - 1187.4 = CITY DATUM)
- THE CONTRACTOR SHALL LIMIT THE EXTENT OF TRENCH TO REMAIN OPEN OVERNIGHT AND WEEKENDS TO LESS THAN 50 FEET.
- AT LEAST 72 HOURS PRIOR TO BEGINNING EXCAVATION (EXCLUDING WEEKENDS AND HOLIDAYS), THE CONTRACTOR SHALL CONTACT THE KANSAS ONE-CALL SYSTEM, A UTILITY LOCATION SERVICE, AT (316) 687-2470 TO REQUEST THE LOCAL UTILITY COMPANIES MARK ANY EXISTING LINES WITHIN THE PROJECT AREA.
- UNDERGROUND UTILITY SERVICE LINES AND OVERHEAD UTILITY POLE LINES ARE TO BE ADJUSTED AS NECESSARY BY OTHERS PRIOR TO CONSTRUCTION UNLESS THE PLANS SPECIFICALLY CALL FOR THEIR ADJUSTMENT BY THE CONTRACTOR OR UNLESS THE PLANS SPECIFICALLY IDENTIFY A UTILITY TO BE ADJUSTED BY ITS OWNER DURING CONSTRUCTION. EXISTING UTILITIES AND THEIR LOCATIONS, AS SHOWN ON THE PLANS, REPRESENT THE BEST INFORMATION OBTAINABLE FOR THE DESIGN. THE CONTRACTOR WILL BE REQUIRED TO WORK AROUND EXISTING UTILITIES WITHIN THE RIGHT-OF-WAY WHICH DO NOT CONFLICT WITH PROPOSED CONSTRUCTION.
- THE CONTRACTOR SHALL BE RESPONSIBLE FOR PRESERVING PROPERTY IRONS. THE CONTRACTOR WILL BE REQUIRED TO RE-ESTABLISH ANY PROPERTY IRONS WHICH ARE DAMAGED OR DESTROYED BY HIS CONSTRUCTION OPERATIONS. SUCH IRONS SHALL BE RE-ESTABLISHED BY A LICENSED LAND SURVEYOR IN ACCORDANCE WITH STATE LAWS.
- CONTRACTOR SHALL PROVIDE POSITIVE DRAINAGE AWAY FROM ALL MANHOLE COVERS.
- MANHOLES SHALL BE TYPE "P" MANHOLES. MANHOLES SHALL BE CONSTRUCTED IN ACCORDANCE WITH THE STANDARD SPECIFICATIONS AND THE STANDARD DETAIL DRAWINGS.
- ALL LAWN/TURF AREAS DISTURBED BY CONSTRUCTION OF THE PROPOSED IMPROVEMENTS SHALL BE RESTORED WITH THE SAME GRASS/SOD AS EXISTING. RESTORATION OF DISTURBED AREAS SHALL INCLUDE, BUT NOT BE LIMITED TO, TOP SOIL PREPARATION, SEEDING, MULCH AND/OR RESEEDING. ALL SEEDING/SODDING WORK SHALL BE IN ACCORDANCE WITH THE CITY OF WICHITA STANDARD SPECIFICATIONS AND THE CITY OF WICHITA ADMINISTRATIVE REGULATION NO. AR78 WHICH GOVERNS CLEANUP AND RESTORATION OR REPLACEMENT FOLLOWING CONSTRUCTION.
- RUBBLE FROM THE REMOVAL OF MISCELLANEOUS STRUCTURES INCLUDING ANY TREES REMOVED, TREE TRIMMINGS, AND EXCESS EXCAVATION WHICH IS TO BE WASTED SHALL BE DISPOSED OF ON SITES PROVIDED BY THE CONTRACTOR. THESE SITES SHALL ALSO BE APPROVED BY THE ENGINEER AS TO SUITABILITY, APPEARANCE, AND SITE LOCATION. LOCATIONS THAT, IN THE OPINION OF THE ENGINEER, WILL LEAVE AN UNSIGHTLY APPEARANCE WILL NOT BE APPROVED. ALL DISPOSAL SITES MUST BE APPROVED BY THE KANSAS DEPARTMENT OF HEALTH AND ENVIRONMENT. MATERIAL EITHER STOCKPILED OR DISPOSED OF IN A FLOOD PLAIN WILL REQUIRE A KANSAS STATE BOARD OF AGRICULTURE PERMIT. ANY MATERIAL DUMPED IN WATERS OF THE UNITED STATES OR WETLANDS IS SUBJECT TO U.S. CORPS OF ENGINEERS PERMITTING REGULATIONS. ANY MATERIAL BURIED OR STOCKPILED BEYOND APPROVED CONSTRUCTION LIMITS MAY REQUIRE ARCHAEOLOGICAL INVESTIGATIONS UNLESS BURIED IN A PREVIOUSLY APPROVED DISPOSAL LOCATION.
- THE CONTRACTOR SHALL AVOID REMOVAL OR TRIMMING OF ANY TREES OR SHRUBS WHERE POSSIBLE. WHERE THE CONTRACTOR BELIEVES THE REMOVAL OR TRIMMING IS UNAVOIDABLE, HE SHALL COORDINATE SUCH WORK WITH THE ENGINEER.
- THE CONTRACTOR SHALL PREVENT ANY CONSTRUCTION DEBRIS FROM ENTERING THE EXISTING SANITARY SEWER DURING CONSTRUCTION.
- CONTRACTOR IS REQUIRED TO MAINTAIN CONTINUOUS FLOW OF SEWAGE IN EXISTING MAINS AT ALL TIMES.
- THE BURIED UTILITIES AS LOCATED ON THE PLANS ARE APPROXIMATE LOCATIONS ONLY. IT SHOULD BE NOTED THAT OTHER BURIED LINES AND CABLES MAY EXIST WHICH ARE NOT SHOWN ON THESE PLANS. THE CONTRACTOR SHALL HAVE ALL BURIED LINES LOCATED AND FLAGGED IN THE FIELD PRIOR TO COMMENCING WORK. THE CONTRACTOR SHALL CONTACT THE ENGINEER AND REVIEW ALL BURIED LINES LOCATED TO DETERMINE IF CONFLICTS EXIST. THE CONTRACTOR SHALL EXERCISE EXTREME CAUTION DURING TRENCHING OPERATIONS TO AVOID DAMAGING THESE LINES. ANY LINES DAMAGED SHALL BE REPLACED OR REPAIRED IMMEDIATELY AS DIRECTED BY THE ENGINEER AT THE CONTRACTOR'S EXPENSE.
- WHERE INDICATED IN THE PLANS, THE SANITARY SEWER EXCAVATIONS SHALL BE SAND FILLED AND FLUSHED (JETTED AND VIBRATED) WITH WATER PER THE REQUIREMENTS LISTED IN THE STANDARD SPECIFICATIONS FOR THE CITY OF WICHITA, UNLESS FLOWABLE FILL OR OTHER IMPROVED BACKFILL MATERIAL IS OTHERWISE SPECIFIED. COST FOR SAND FILLING AND FLUSHING SHALL BE CONSIDERED SUBSIDIARY TO THE UNIT PRICE BID FOR "PIPE (JETTED SAND BACKFILL)".
- EROSION CONTROL (BMP'S)
THE CONTRACTOR SHALL INSTALL AND/OR MAINTAIN EROSION CONTROL METHODS AS SPECIFIED ON SHEETS C5.0-C5.2. THE FOLLOWING QUANTITIES ARE ESTIMATED, AND SHOULD BE CONSIDERED THE MINIMUM EFFORT REQUIRED. THE GENERAL LOCATION OF THE REQUIRED EROSION CONTROL IS ILLUSTRATED ON THE PROJECT KEY MAP. THE FIRE SERVICE LINE CONTRACTOR SHALL BE RESPONSIBLE FOR MAINTAINING THE EROSION CONTROL SHOWN THROUGH THE COMPLETION OF THIS PROJECT. INSTALLATION OF THESE BMP'S DOES NOT RELIEVE THE CONTRACTOR OF THE RESPONSIBILITY OF ABATING SOIL EROSION.
SILT BARRIER 37 L.F.

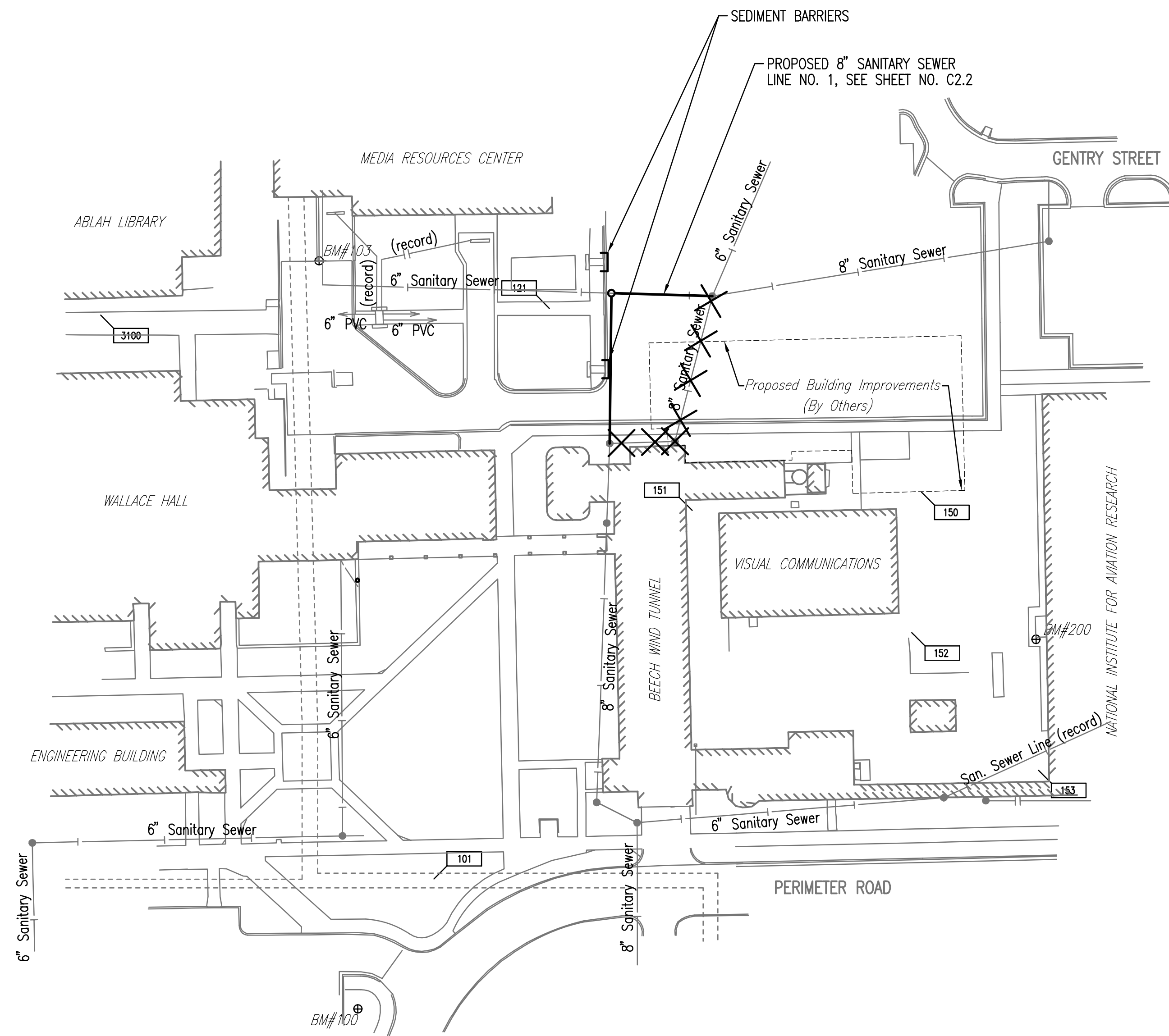

LEGEND

- EXISTING SANITARY SEWER
- PROPOSED SANITARY SEWER
- EXISTING SANITARY SEWER w/MANHOLE
- PROPOSED SANITARY SEWER w/MANHOLE
- EXISTING SANITARY SEWER w/CLEANOUT
- PROPOSED SANITARY SEWER w/CLEANOUT
- EXISTING STORM WATER SEWER
- PROPOSED STORM WATER SEWER

- BENCH MARKS
- BM # 9 - Chiseled "d" at NW corner curb inlet, S side of Perimeter Road E of E entrance to parking lot 6 SE of Ahlberg Hall (not shown) Elev.= 206.32
 - BM #100 - Chiseled "d" on concrete base light pole at NE corner parking lot #6. W side of Perimeter Road, S of parking lot entrance Elev.= 212.83
 - BM #103 - Chiseled "d" on the S end of W concrete retaining wall for ramp on S side Media Resources Center, N of Wallace Hall Elev.= 216.39
 - BM #200 - Chiseled "d" on SW corner concrete pad at vault on W side of National Institute for Aviation Research Elev.= 219.36

CONTROL POINTS

- CP #8 (Not shown)
N-1,696,749.8200, E-1,661,844.9800
#4 Bar Set in @ concrete road N-S, W of St. Paul Newman Center
Conc. joint N-E-S-W
200± N - N curb line of 17th Street North
29± S - N entrance to St. Paul Newman Center
- CP #101, Elev.= 213.92
N-1,697,217.4159, E-1,661,899.0154
1/2" Bar on grassy knoll NE of NE corner parking lot 6
41.10' W - E corner conc. base of art sculpture
25.10' N - Center of light pole
45.10' NE - SE corner of brick sign (Wallace Hall)
- CP #121, Elev.= 216.97
N-1,697,547.1769, E-1,661,965.7681
Chiseled "+" in center of 8' sidewalk, S side of Media Resources Center
22.23' ESE - Center top nut of fire hydrant
5.95' N - Center of light pole
4.17' S - S edge of conc. sidewalk
NW to Media Resources Center Building
- CP #150 - PK Nail in asphalt pavement
N-1,697,441.0015, E-1,662,180.6688
39.25' NW - Chiseled "X" on sidewalk
16.54' N - Chiseled "X" on concrete pad
26.27' NE - Center of chain link fence post
17.63' SW - NE corner of building
- CP #151 - Chiseled "+" on concrete W of NW corner
N-1,697,430.4013, E-1,662,048.3107
3.70' W - E face of brick wall
6.16' N - S face of brick wall
7.15' NW - Corner of brick wall
- CP #152 - PK Nail in asphalt pavement
N-1,697,359.7030, E-1,662,175.1249
6.88' SW - NE corner of steel base plate for I-beam
13.52' NW - SE corner of metal building
30.31' SE - NW corner of concrete pad for electric box
- CP #153 - PK Nail in asphalt pavement
N-1,697,280.3521, E-1,662,248.2629
6.17' E - W face of brick building, National Institute for Aviation Research
9.21' SE - Inside face of brick walls
6.84' S - N face of brick wall
- CP #3100
N-1,697,543.2100, E-1,661,706.5300
Chiseled "+" in E-W conc. sidewalk on N side College of Engineering Bldg.
1.93' N - N edge of sidewalk
48.70' SW - NW corner brick retaining wall
66.27' ESE - SW corner brick wall
IN-LINE - @ sidewalk to S

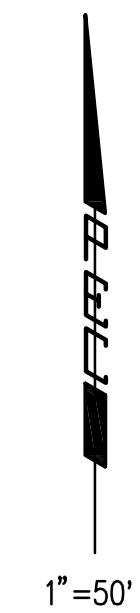

East line of the NW 1/4 Sec. 11, T27S, R1E

Served 10-03-2006 11:40:48 AM by RFL
 Plot Scale 1:50 10-03-2006 12:46:30 PM by BEJ
 J:\SENTOUT\2003\03069\003\2006-10-03 to City\1705 PPS\DWG\C201-SS Key Map

No.	Revision	By	Date
WICHITA STATE UNIVERSITY - ENGINEERING COMPLEX PHASE 2 KEY MAP AND GENERAL NOTES JAMES L. ARMOUR, P.E. - CITY ENGINEER CITY OF WICHITA PRIVATE PROJECT NO. 1705 PPS (607861) Professional Engineering Consultants, P.A. 303 S. TOPEKA • WICHITA, KANSAS 67202 316-262-2691 • FAX 316-262-3003			
Designed by	RRY/ALA	Job No.	35-03085-1-2474
Drawn by	JGA	Date	9/26/06
			Sht. C2.1 of 9

PLAN	CHECKED	BY	DATE
	CHECKED		

PROFILE	CHECKED	BY	DATE
	CHECKED		

Saved: 10-03-2006 11:40:38 AM by: RFI
 Plot Scale: 1"=20'-0" 10-03-2006 12:48:03 PM by: RFI
 J:\SEN\001\2003\03085\003\206-10-03 to City\1705 PPS\DWG\C202-SS PlanProfile

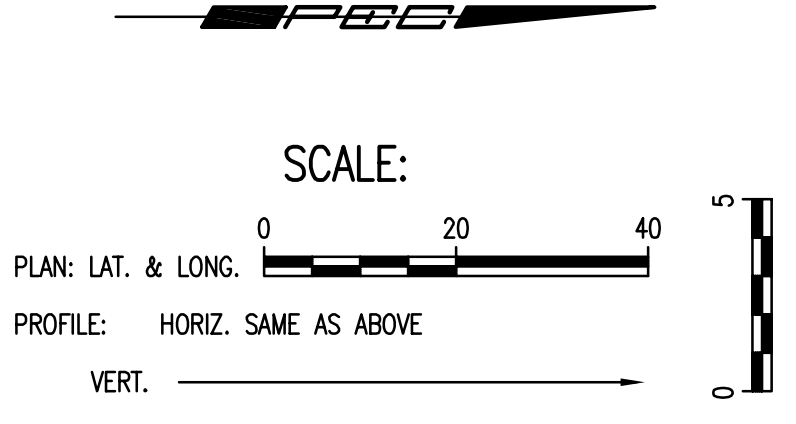
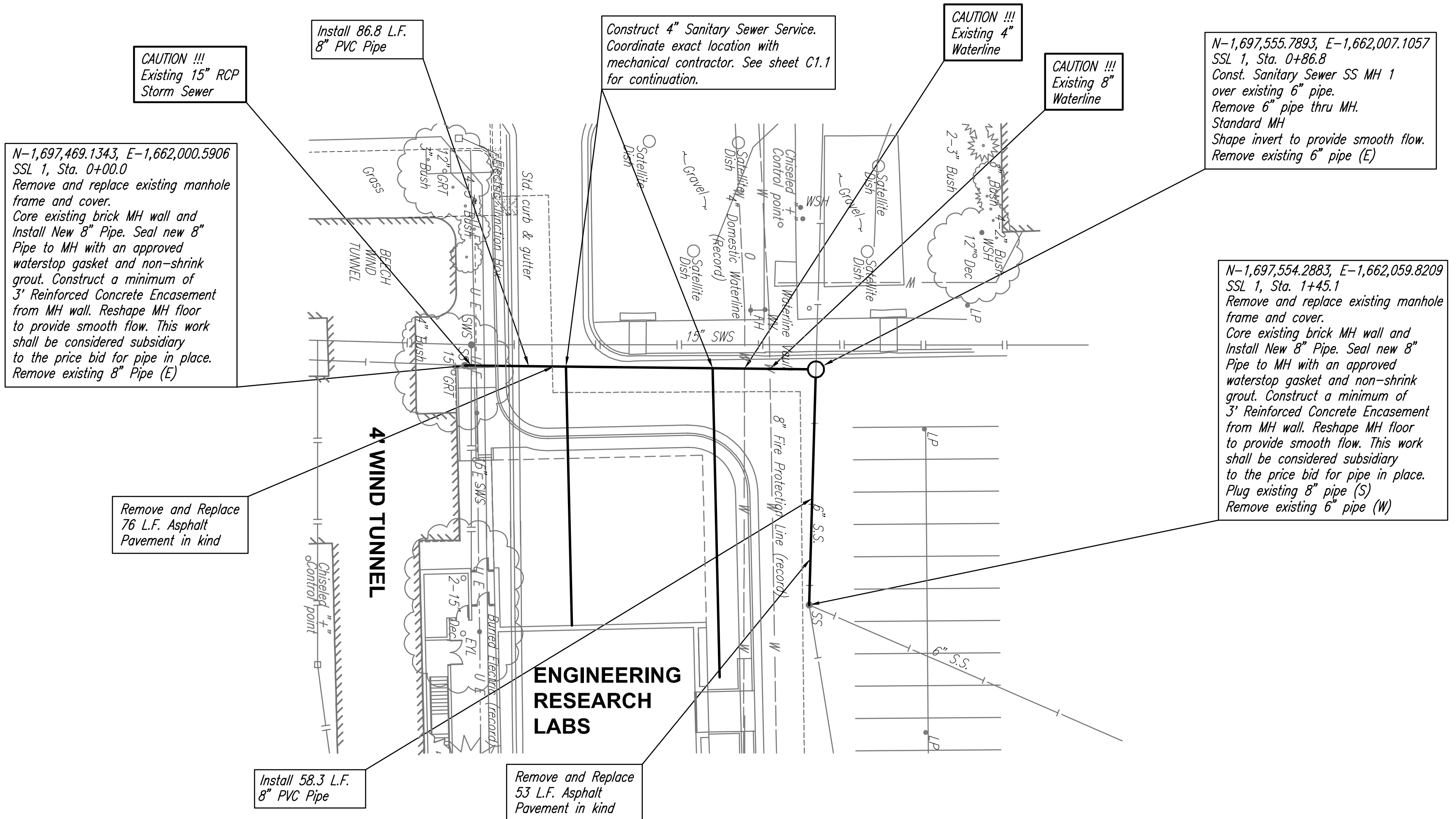
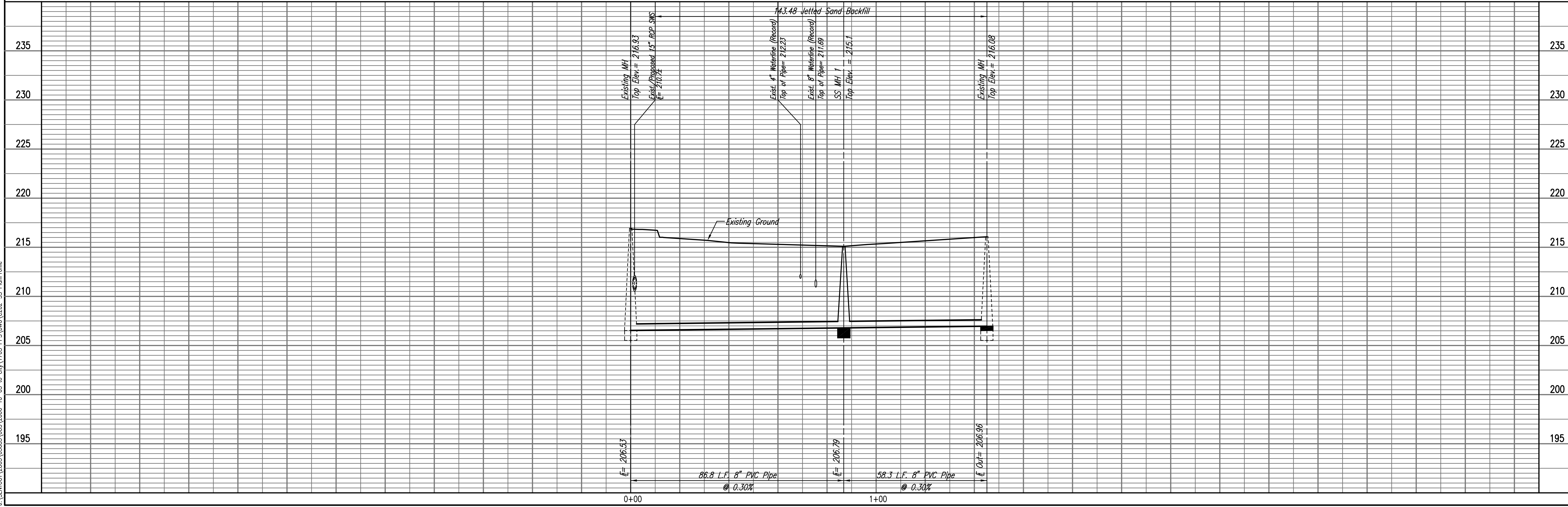

Professional Engineering Consultants, P.A.
 803 S. TOPICKA AVENUE, WICHITA, KANSAS 67202
 316-262-2691 • FAX 316-262-3008

WICHITA STATE UNIVERSITY - ENGINEERING COMPLEX
 PHASE 2
SANITARY SEWER LINE NO. 1
 JAMES L. ARMOUR, P.E. - CITY ENGINEER
 CITY OF WICHITA PRIVATE PROJECT NO. 1705 PPS (607861)

Designed By: RRY/MLA
 Drawn By: JCA
 Job No.: 35-03085-001-2474
 Date: 9/26/06

Sheet C2.2 of 9