

**BENCHMARK:**  
 BM #7 - Small RR Spike in the South Face of the 1st Power Pole East of Keith on the North Side of 29th Street North.  
 Sta. 2+063.40, 14.84m Lt.  
 Elev. 411.437 SI Units (1349.86 MSL)

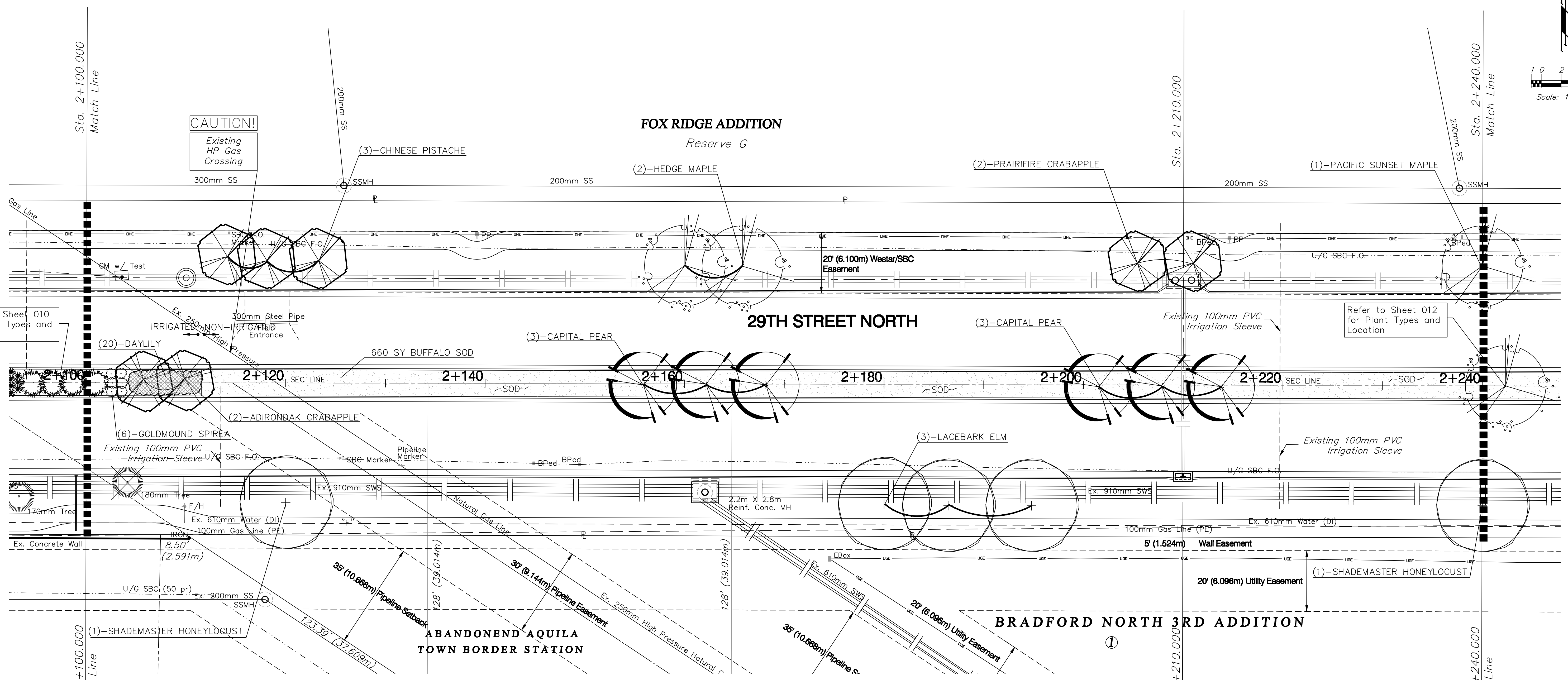
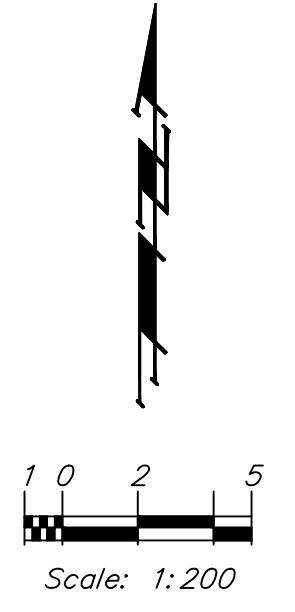

Refer to Sheet 010 for Plant Types and Location

Refer to Sheet 012 for Plant Types and Location

**PLANT SCHEDULE**

QTY	BOTANICAL NAME	COMMON NAME	SIZE	CONDITION	REMARKS
2	<i>Acer campestre</i>	Hedge Maple	2" Cal.	B&B	Single Stem Only
1	<i>Acer truncatum</i> x <i>A. platanoides</i> 'Warrenred'	Pacific Sunset Maple	2" Cal.	B&B	Single Stem Only
2	<i>Gleditsia triacanthos</i> 'Shademaster'	Shademaster Honeylocust	2" Cal.	B&B	Single Stem Only
2	<i>Malus 'Adirondak'</i>	Adirondak Crabapple	2" Cal.	B&B	Single Stem Only
2	<i>Malus 'Prairifire'</i>	Prairifire Crabapple	2" Cal.	B&B	Single Stem Only
3	<i>Pistacia chinensis</i>	Chinese Pistache	2" Cal.	B&B	Single Stem Only
6	<i>Pyrus calleryana</i> 'Capital'	Capital Pear	2" Cal.	B&B	Single Stem Only
3	<i>Ulmus parvifolia</i>	Lacebark Elm	2" Cal.	B&B	Single Stem Only
6	<i>Spirea japonica</i> 'Goldmound'	Goldmound Spirea	2-Gal.	Container	Full & Healthy
20	<i>Heemerocallis</i> 'Stella de Oro'	Stella De Oro Daylily	1-Gal.	Container	Full & Healthy

PROJECT NUMBER <b>472-83863a</b>		SHEET NAME LS11		ENGINEERING DIRECTORY E:\29th - Tyler to Maize Lscape\		CAPITAL IMPROVEMENT PROJECT 29TH STREET NORTH PAVING Sta. 2+100.000 to Sta. 2+240.000		<b>BAUGHMAN COMPANY, P.A.</b> ENGINEERING, SURVEYING, & PLANNING 316-282-7271 • 315 ELLIS • WICHITA, KANSAS 67211	SHEET <b>11</b> OF <b>18</b>
DESIGN NLS	DRAWN NLS	APPROVED BDT	DATE April 07	SCALE Noted	BAUGHMAN NO 02-02-E232	29TH STREET NORTH - MAIZE ROAD to TYLER ROAD			