

BENCHMARK:
 BM #8 - Small RR Spike in the South Face of the 2nd Power Pole West of Meadow Park on the North Side of 29th Street North.
 Sta. 2+290.26, 14.61m Lt.
 Elev. 412.352 SI Units (1352.86 MSL)

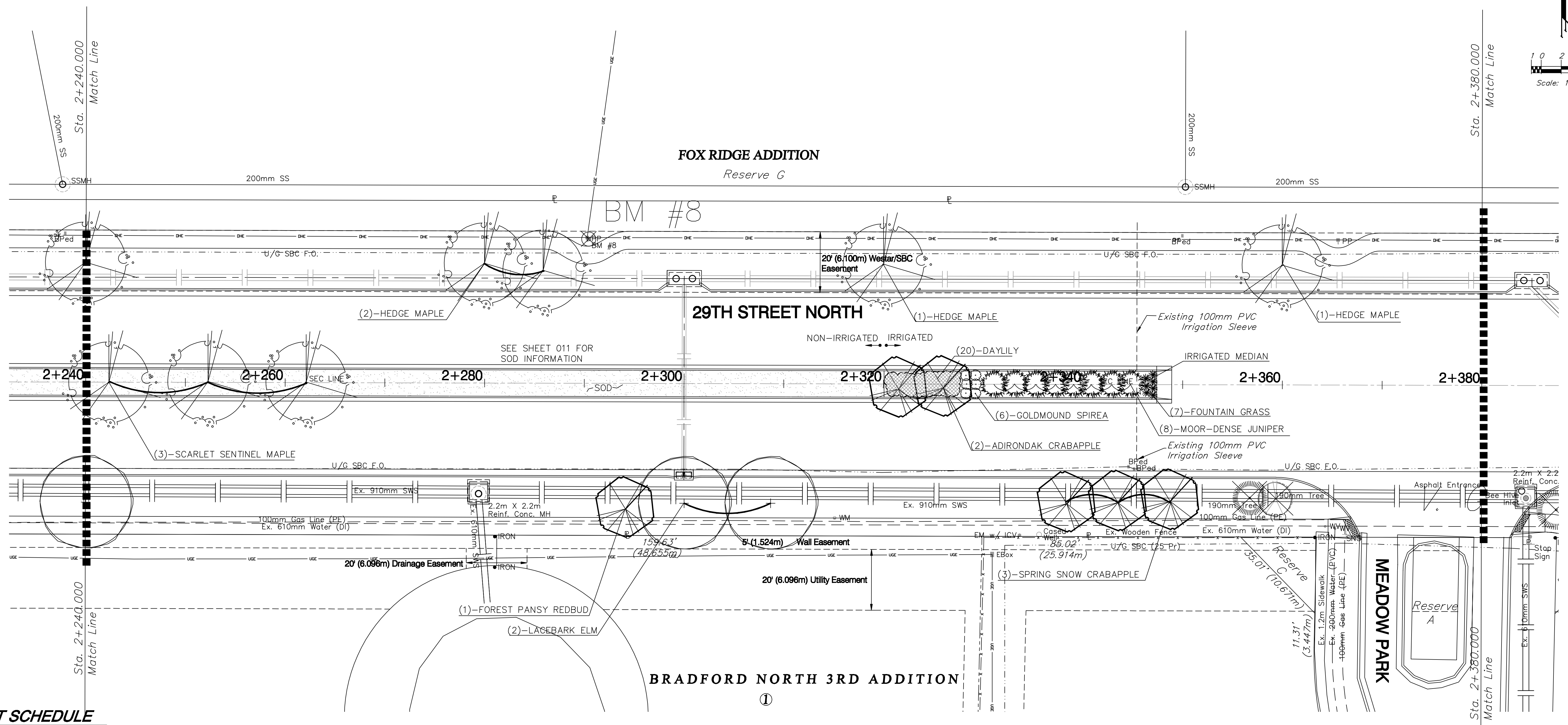
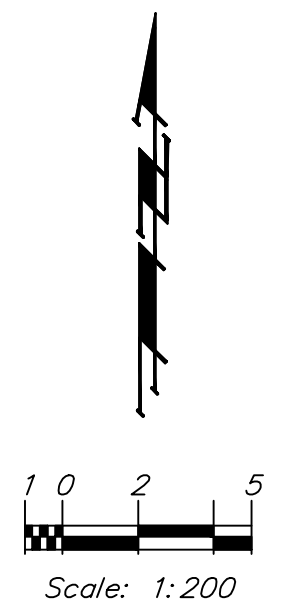

PLANT SCHEDULE

QTY	BOTANICAL NAME	COMMON NAME	SIZE	CONDITION	REMARKS
4	<i>Acer campestre</i>	Hedge Maple	2" Cal.	B&B	Single Stem Only
3	<i>Acer rubrum</i> 'Scarsen'	Scarlet Sentinel Maple	2" Cal.	B&B	Single Stem Only
1	<i>Cercis canadensis</i> 'Forest Pansy'	Forest Pansy Redbud	2" Cal.	B&B	Single Stem Only
2	<i>Malus Adirondak</i>	Adirondak Crabapple	2" Cal.	B&B	Single Stem Only
3	<i>Malus Spring Snow</i>	Spring Snow Crabapple	2" Cal.	B&B	Single Stem Only
2	<i>Ulmus parvifolia</i>	Lacebark Elm	2" Cal.	B&B	Single Stem Only
8	<i>Juniperus sabina</i> 'Monard'	Moor-Dense Juniper	2-Cal.	Container	Full & Healthy
6	<i>Spirea japonica</i> 'Goldmound'	Goldmound Spirea	2-Cal.	Container	Full & Healthy
20	<i>Hemerocallis 'Stella de Oro'</i>	Stella De Oro Daylily	1-Cal.	Container	Full & Healthy
7	<i>Pennisetum alopecuroides</i> 'Hameln'	Dwf. Hameln Fountain Grass	1-Cal.	Container	Full & Healthy

Note:
 Trees/Shrubs to be removed are marked thus:

PROJECT NUMBER 472-83863a		SHEET NAME LS12	ENGINEERING DIRECTORY E: 29th - Tyler to Maize Lscope\	CAPITAL IMPROVEMENT PROJECT 29TH STREET NORTH PAVING Sta. 2+240.000 to Sta. 2+380.		BAUGHMAN COMPANY, P.A. ENGINEERING, SURVEYING, & PLANNING 316-282-7271 • 315 ELLIS • WICHITA, KANSAS 67211	SHEET A.12 OF 18
DESIGN NLS	DRAWN NLS	APPROVED BDT	DATE April 07	SCALE Noted	BAUGHMAN NO 02-02-E232		