

BENCHMARK:
 BM #8 - Small RR Spike in the South Face of the 2nd Power Pole West of Meadow Park on the North Side of 29th Street North.
 Sta. 2+290.26, 14.61m Lt.
 Elev. 412.352 SI Units (1352.86 MSL)

BM #9 - "□" on the Top of Curb at the South End of the Curb Return at the Southeast Corner of Tyler Road and 29th Street North.
 Sta. 2+612.58, 13.78m Rt.
 Elev. 415.765 SI Units (1364.06 MSL)

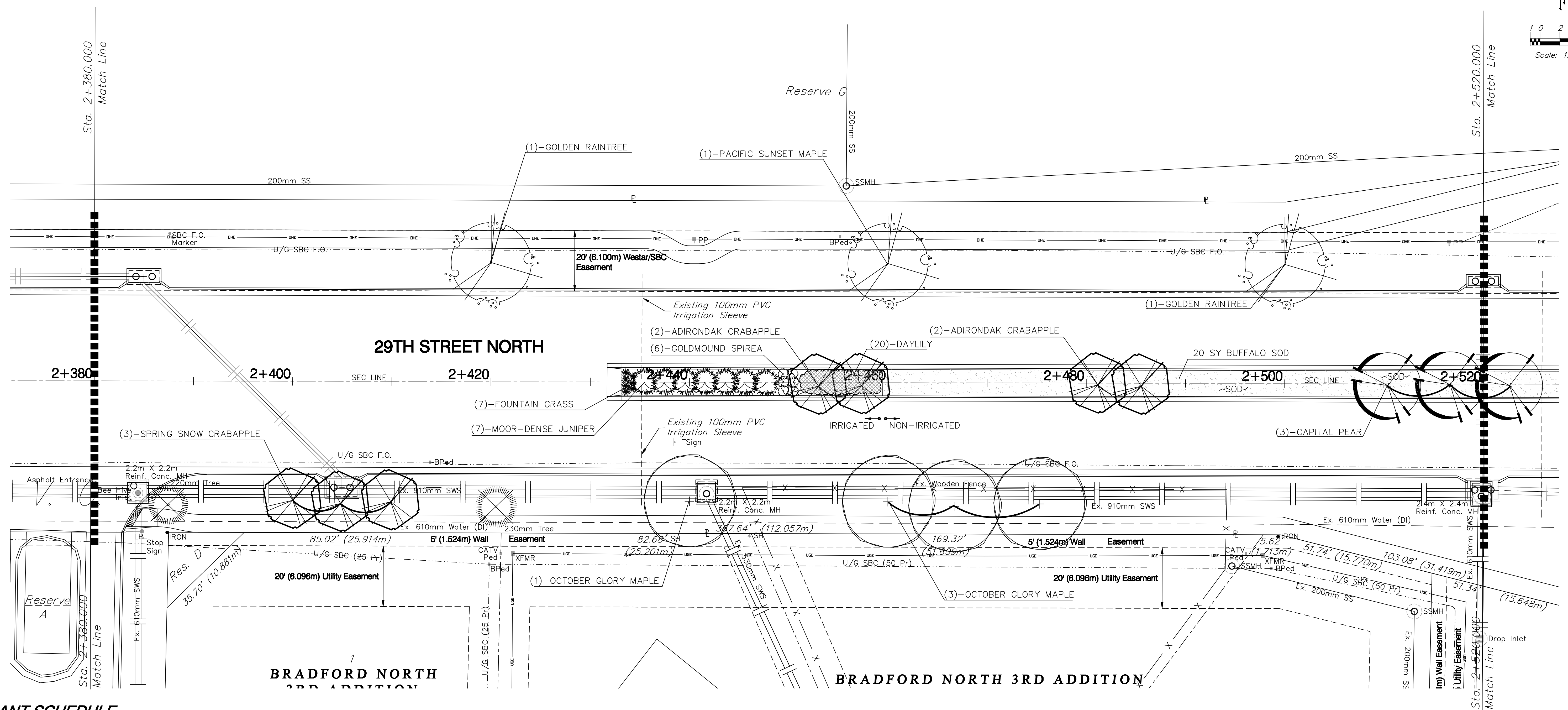
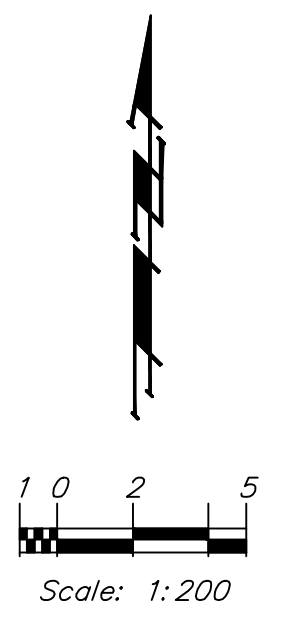

PLANT SCHEDULE

QTY	BOTANICAL NAME	COMMON NAME	SIZE	CONDITION	REMARKS
4	<i>Acer rubrum</i> 'October Glory'	October Glory Maple	2" Cal.	B&B	Single Stem Only
1	<i>Acer truncatum</i> x <i>A. platanoides</i> 'Warrenred'	Pacific Sunset Maple	2" Cal.	B&B	Single Stem Only
2	<i>Koelreuteria paniculata</i>	Golden Raintree	2" Cal.	B&B	Single Stem Only
4	<i>Malus</i> 'Adirondak'	Adirondak Crabapple	2" Cal.	B&B	Single Stem Only
3	<i>Malus</i> 'Spring Snow'	Spring Snow Crabapple	2" Cal.	B&B	Single Stem Only
3	<i>Pyrus calleryana</i> 'Capital'	Capital Pear	2" Cal.	B&B	Single Stem Only
7	<i>Juniperus sabina</i> 'Monard'	Moar-Dense Juniper	2-Cal.	Container	Full & Healthy
6	<i>Spirea japonica</i> 'Goldmound'	Goldmound Spirea	2-Cal.	Container	Full & Healthy
20	<i>Hemerocallis</i> 'Stella de Oro'	Stella De Oro Daylily	1-Cal.	Container	Full & Healthy
7	<i>Pennisetum alopecuroides</i> 'Hameln'	Dwf. Hameln Fountain Grass	1-Cal.	Container	Full & Healthy

Note:
 Trees/Shrubs to be removed are marked thus:

PROJECT NUMBER 472-83863a		SHEET NAME LS13		ENGINEERING DIRECTORY E:\29th - Tyler to Maize\lscope\		CAPITAL IMPROVEMENT PROJECT 29TH STREET NORTH PAVING Sta. 2+380.000 to Sta. 2+520. 29TH STREET NORTH - MAIZE ROAD to TYLER ROAD		BAUGHMAN COMPANY, P.A. ENGINEERING, SURVEYING, & PLANNING 316-282-7271 • 315 ELLIS • WICHITA, KANSAS 67211		SHEET A.13 OF 18
DESIGN NLS	DRAWN NLS	APPROVED BDT	DATE April 07	SCALE Noted	BAUGHMAN NO 02-02-E232					