

1990 SANITARY SEWER RECONSTRUCTION PROGRAM

PHASE I

PROJ. NO. 465-82080

INDEX NO. 630426

CITY OF WICHITA, KANSAS

M.E. LINDEBAK, CITY ENGINEER

GENERAL NOTES

1. ALL CONSTRUCTION AND MATERIALS TO COMPLY WITH CITY OF WICHITA SPECIFICATIONS AND STANDARDS.
2. AT LEAST 48 HOURS PRIOR TO BEGINNING EXCAVATION, IF REQUIRED, (EXCLUDING WEEKENDS AND HOLIDAYS), THE CONTRACTOR SHALL CONTACT THE KANSAS ONE-CALL SYSTEM, A UTILITY LOCATION SERVICE, AT (316) 607-2470 TO REQUEST THE FOLLOWING UTILITY COMPANIES TO LOCATE ANY EXISTING LINES WITHIN THE PROJECT AREA: GAS SERVICE COMPANY, K.G.S. CO., THE WICHITA WATER DEPARTMENT, AND AIR CAPITAL CABLEVISION.
3. THE CONTRACTOR MUST ALSO NOTIFY THE TELEPHONE COMPANY AT (316) 571-2116, 48 HOURS PRIOR TO BEGINNING EXCAVATION, IF REQUIRED, AND REQUEST THAT ANY LINES WITHIN THE PROJECT AREA BE FLAGGED.
4. THE CONTRACTOR SHALL RESTORE ALL DITCHES, SWALES, ROAD SHOULDERS, ENTRANCES, AND BANK LINES TO THEIR ORIGINAL SLOPES AND GRADES EXCEPT AS SHOWN OTHERWISE.
5. THE CONTRACTOR SHALL BE RESPONSIBLE FOR PRESERVING PROPERTY IRONS. THE CONTRACTOR SHALL BE REQUIRED TO RE-ESTABLISH ANY PROPERTY IRONS WHICH ARE DAMAGED OR DESTROYED BY HIS CONSTRUCTION OPERATIONS. SUCH IRONS SHALL BE RE-ESTABLISHED BY A LICENSED LAND SURVEYOR OR A LICENSED PROFESSIONAL ENGINEER IN ACCORDANCE WITH STATE LAWS. ALL COSTS FOR THIS WORK SHALL BE SUBSIDIARY TO THE OTHER ITEMS OF WORK.
6. CONTRACTOR WILL BE REQUIRED TO GIVE ALL PROPERTY OWNERS AND/OR TENANTS DIRECTLY AFFECTED BY THE CONSTRUCTION OF THIS PROJECT A MINIMUM ADVANCE NOTICE OF SEVEN DAYS PRIOR TO STARTING CONSTRUCTION. THE CONTRACTOR SHALL AGAIN NOTIFY RESIDENTS IMMEDIATELY PRIOR TO BEGINNING WORK, THAT SEWER SERVICE WILL BE INTERRUPTED.
7. TREES OR SHRUBS LOCATED WITHIN THE UTILITY EASEMENT SHALL NOT BE REMOVED WITHOUT PRIOR APPROVAL BY THE ENGINEER. TREES OR SHRUBS OUTSIDE OF THE UTILITY EASEMENT SHALL NOT BE REMOVED.
8. NO BUILDING SERVICE CONNECTION SHALL BE WITHIN SANITARY SEWER SERVICE FOR MORE THAN 24 HOURS. ANY SERVICE LINE NOT IN A CONDITION WHICH WOULD PERMIT RECONNECTION SHALL BE REPLACED AT NO EXTRA COST TO THE PROJECT.
9. ONLY ACTIVE BUILDING SEWER LINES WHICH CONNECT ACTUAL BUILDINGS TO THE SEWER SYSTEM ARE TO BE RECONNECTED TO THE NEW SEWER CONSTRUCTION. BUILDING SEWER LINES AND CONNECTIONS WHICH HAVE BEEN ABANDONED ARE NOT TO BE RECONNECTED TO THE NEW SEWER CONSTRUCTION. IT WILL BE THE SOLE RESPONSIBILITY OF THE CONTRACTOR TO ASSESS AT WHICH BUILDING SEWER LINES AND/OR CONNECTIONS ARE ACTIVE AND WHICH SEWERS AND/OR CONNECTIONS HAVE BEEN ABANDONED. ALL WORK INVOLVED WITH BUILDING SEWER LINE CONSTRUCTION AND/OR BUILDING SEWER CONNECTIONS SHALL CONFORM TO THE APPLICABLE SECTION OF THE STANDARD SPECIFICATIONS.
10. THE CONTRACTOR SHALL BE RESPONSIBLE FOR MAINTAINING CONTINUOUS FLOW OF SEWAGE THROUGH CONSTRUCTION. CONTRACTOR'S PROPOSED METHOD FOR MAINTAINING SEWAGE FLOW SHALL BE APPROVED BY THE ENGINEER. COST OF MAINTAINING FLOW OF SEWAGE THROUGH CONSTRUCTION WILL NOT BE PAID FOR DIRECTLY AND THIS COST SHALL BE CONSIDERED AS SUBSIDIARY TO THE OTHER PAY ITEMS OF WORK.
11. ANY FENCE REMOVED FOR CONSTRUCTION SHALL BE REPAIRED IN A CONDITION EQUAL TO, OR BETTER THAN ORIGINAL, AT NO ADDITIONAL COST TO THE OWNER.
12. THE CONTRACTOR SHALL BE RESPONSIBLE FOR THE ACQUISITION OF ANY ADDITIONAL RIGHTS-OF-WAY OR EASEMENTS NECESSARY TO COMPLETE THE WORK.
13. THE CONTRACTOR SHALL PROVIDE PROPER SIGNING AND BARRICADE TO ROUTE TRAFFIC EITHER THROUGH OR AROUND CONSTRUCTION AS OUTLINED IN THE SPECIFICATIONS. TRAFFIC ROUTING SHALL BE APPROVED BY THE ENGINEER.
14. FREQUENTLY PLANS, SPECIFICATIONS, AND/OR SPECIAL PROVISIONS WILL IDENTIFY SPECIFIC ITEMS OF WORK TO BE COMPLETED BY THE CONTRACTOR FOR WHICH THE PROPOSAL DOES NOT INCLUDE A PAY ITEM. IT SHALL BE PERMITTED IN THESE CASES THAT SUCH WORK WILL BE COMPLETED BY THE CONTRACTOR AND ALL COSTS FOR SUCH WORK SHALL BE CONSIDERED AS SUBSIDIARY TO THE OTHER PAY ITEMS OF WORK IN THE PROPOSAL. NO CLAIM FROM THE CONTRACTOR WILL BE ALLOWED FOR PAYMENT OF SUCH WORK AS EXTRA WORK.

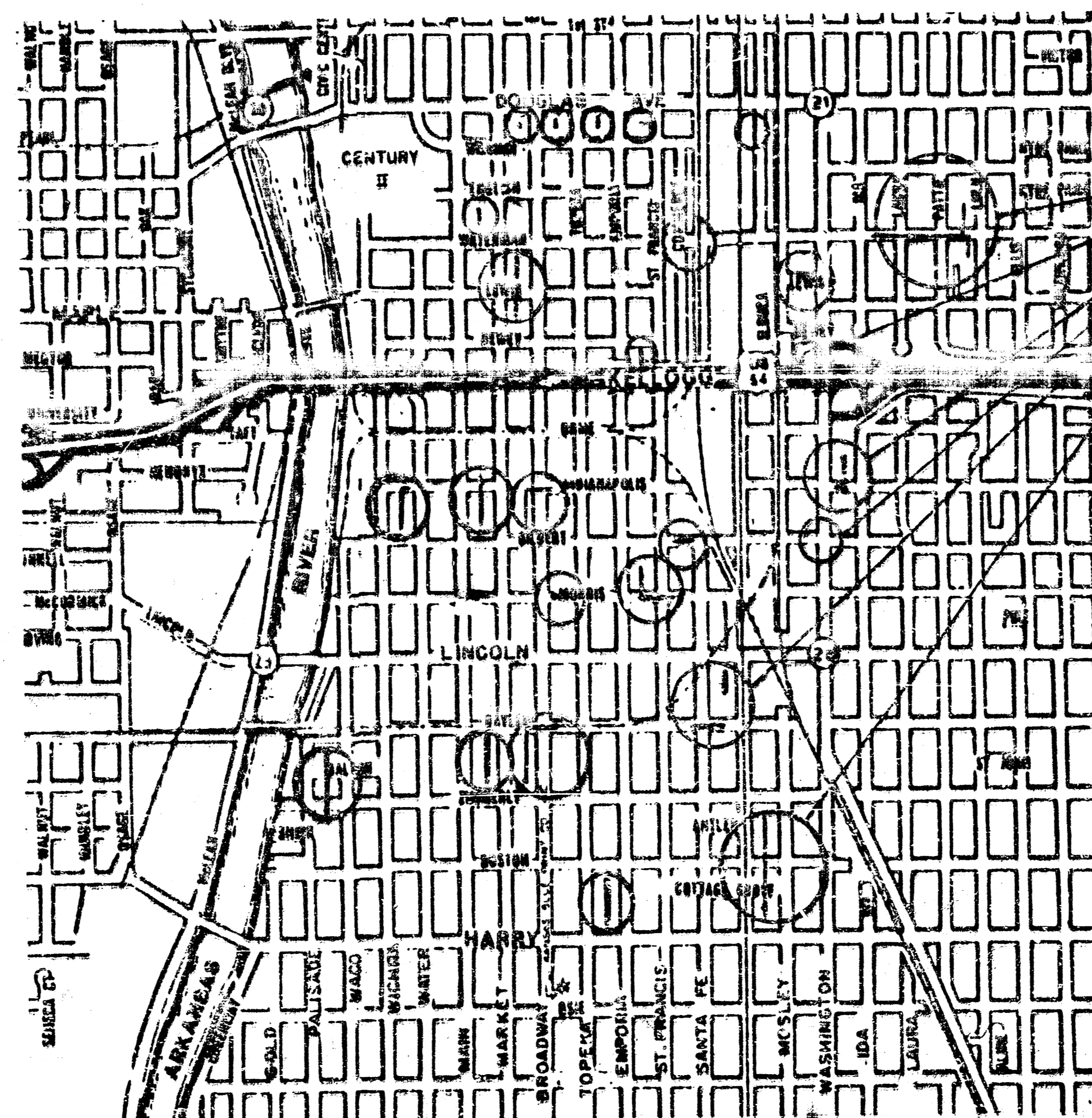

PROJECT LOCATIONS

NOTE: SITES THAT HAVE BEEN X OUT ARE NOT PART OF THIS CONTRACT.

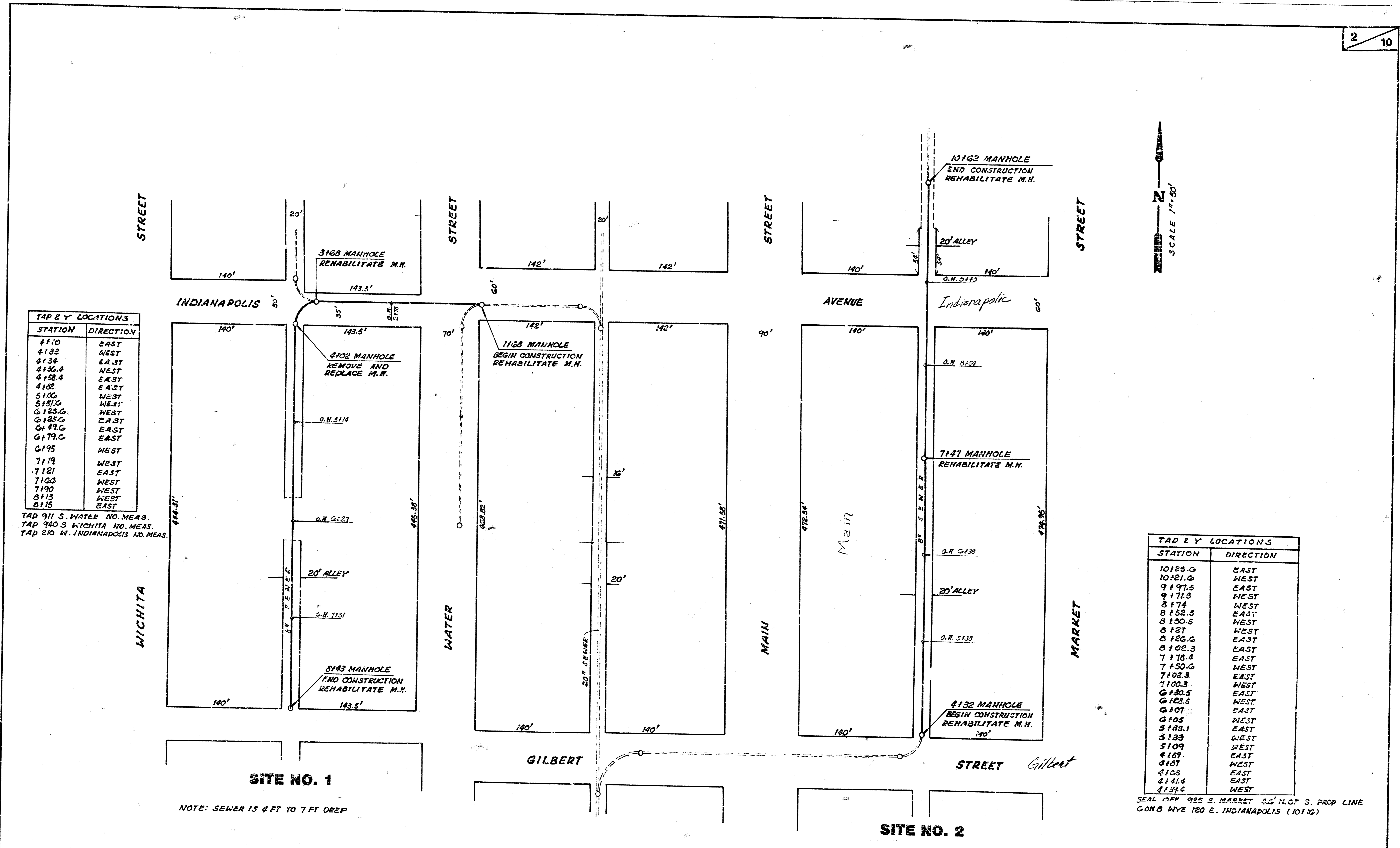

TAP & Y LOCATIONS	
STATION	DIRECTION
4170	EAST
4133	WEST
4134	EAST
4136.4	WEST
4138.4	EAST
4162	EAST
5100	WEST
5137.0	WEST
6123.0	WEST
6125.0	EAST
6149.0	EAST
6179.0	EAST
6195	WEST
7119	WEST
7121	EAST
7102	WEST
7190	WEST
8113	WEST
8115	EAST

TAP 911 S. WATER NO. MEAS.
 TAP 940 S. WICHITA NO. MEAS.
 TAP 210 W. INDIANAPOLIS NO. MEAS.

TAP & Y LOCATIONS	
STATION	DIRECTION
10123.0	EAST
10121.0	WEST
9197.5	EAST
9171.5	WEST
8174	WEST
8152.5	EAST
8150.5	WEST
8127	WEST
8126.0	EAST
8102.3	EAST
7178.4	EAST
7150.0	WEST
7102.3	EAST
7100.3	WEST
6130.5	EAST
6122.5	WEST
6107	EAST
6105	WEST
5183.1	EAST
5133	WEST
5109	WEST
4189	EAST
4187	WEST
4103	EAST
4141.4	EAST
4139.4	WEST

SEAL OFF 925 S. MARKET A.G. N.O.P. S. PROP. LINE
 G.O.N.B. WYE 120 E. INDIANAPOLIS (10 FIG)

SITE NO. 1

NOTE: SEWER IS 4 FT TO 7 FT DEEP

SITE NO. 2

NOTE: ALL OBSERVATION HOLES SHALL BE REMOVED OR ABANDONED.
 NOTE: MANHOLES ARE TO BE REHABILITATED OR RECONSTRUCTED AS NOTED

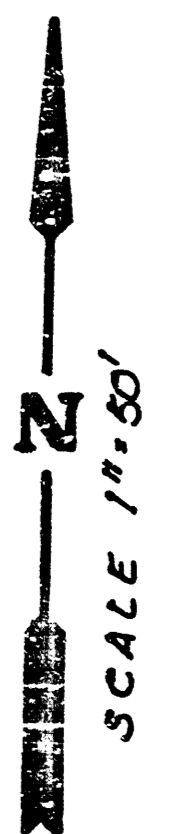

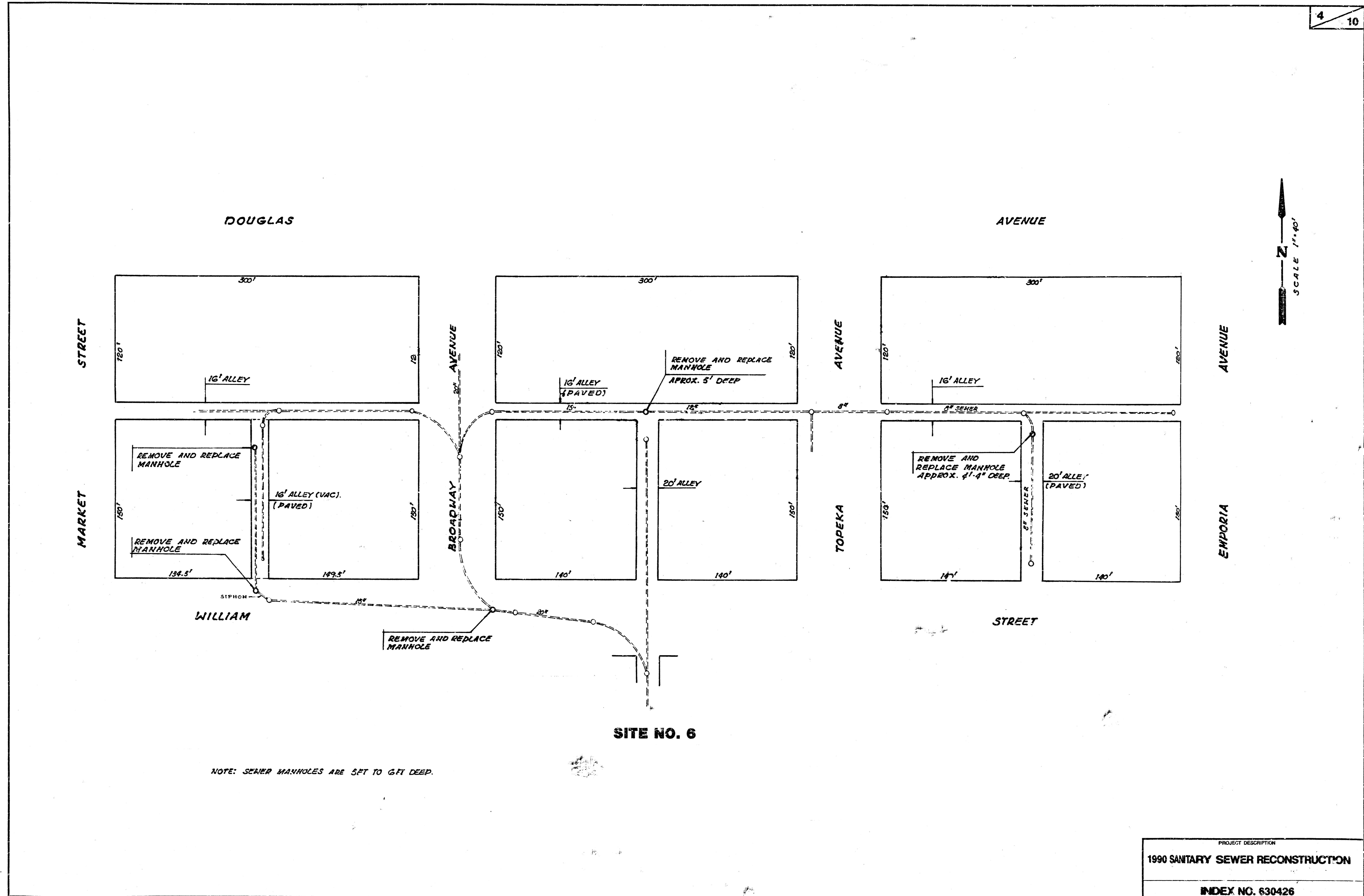

NOTE: SEWER MANHOLES ARE 5FT TO 6FT DEEP.

SITE NO. 6

PROJECT DESCRIPTION
1990 SANITARY SEWER RECONSTRUCTION
INDEX NO. 630426

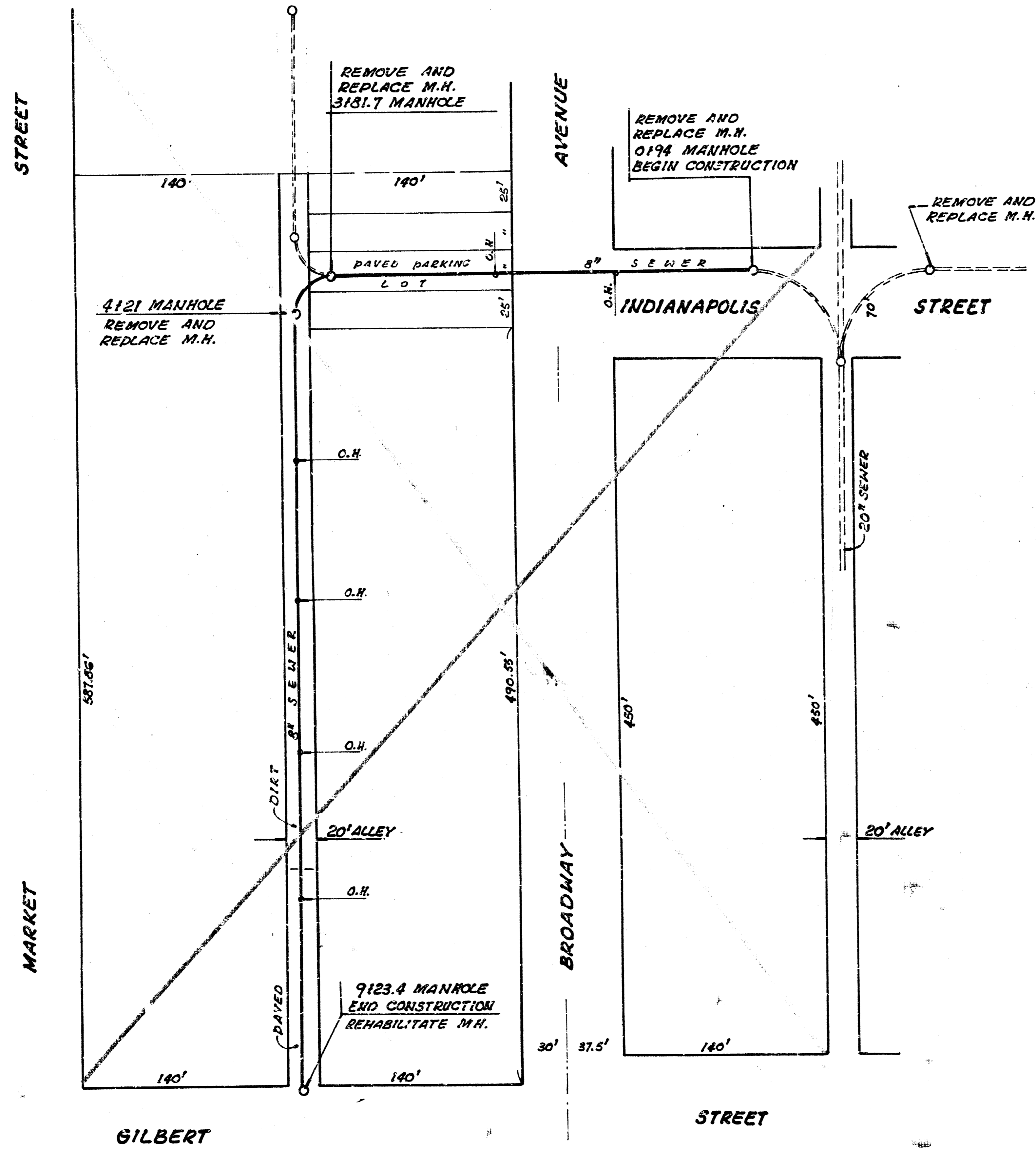

NOTE: SEWER IS 3 FT TO 8 FT DEEP.

SITE NO. 7

Booked 10 90
RDL
A-115

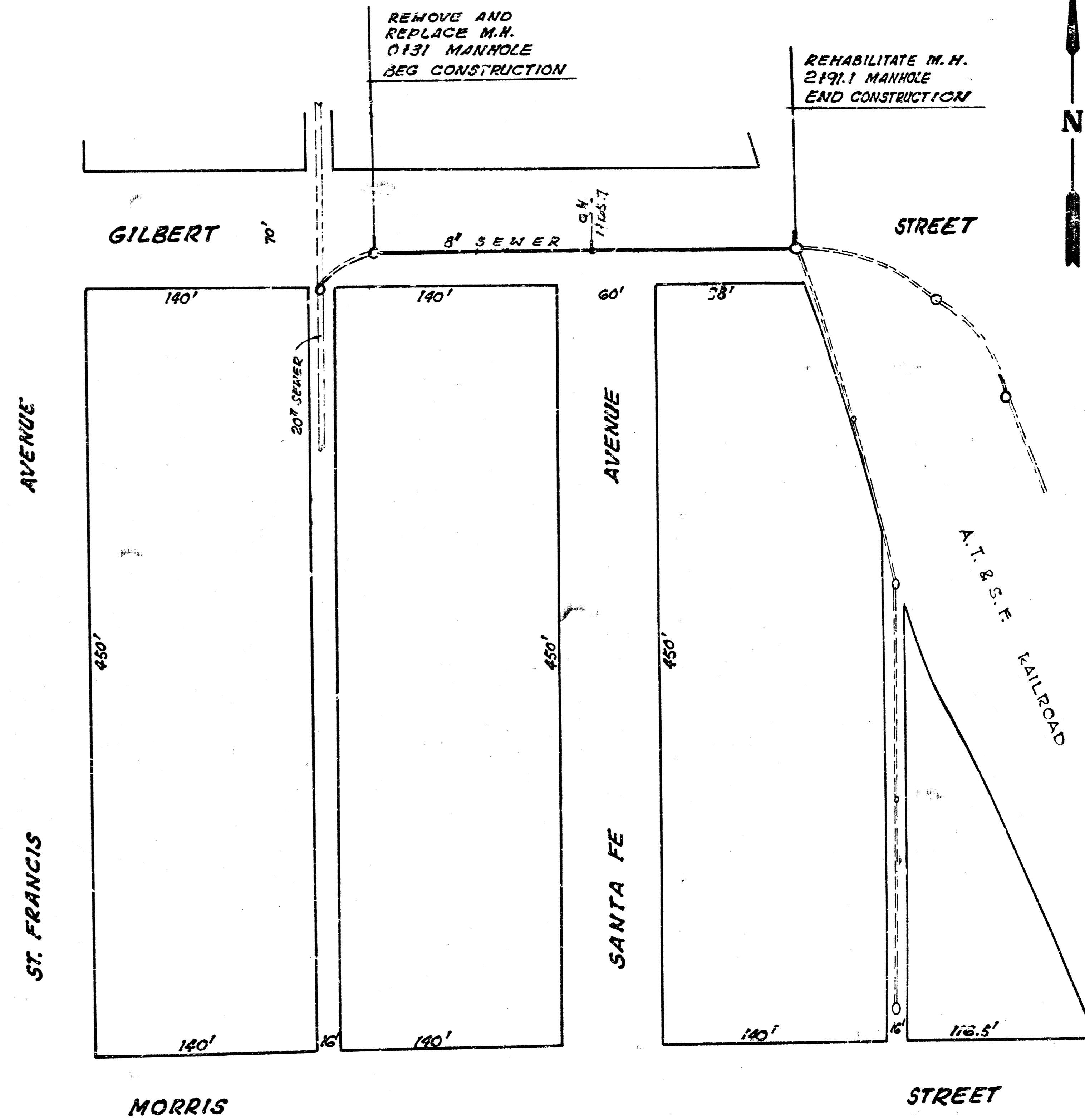
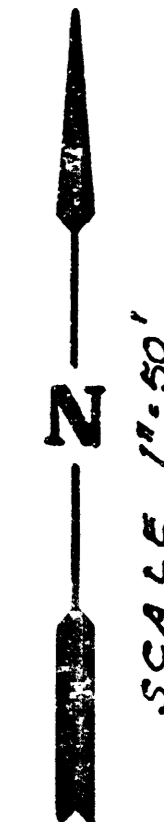

NOTE: SEWER IS 7 FT TO 8 FT DEEP

SITE NO. 8

PROJECT DESCRIPTION
1990 SANITARY SEWER RECONSTRUCTION
INDEX NO. 630426

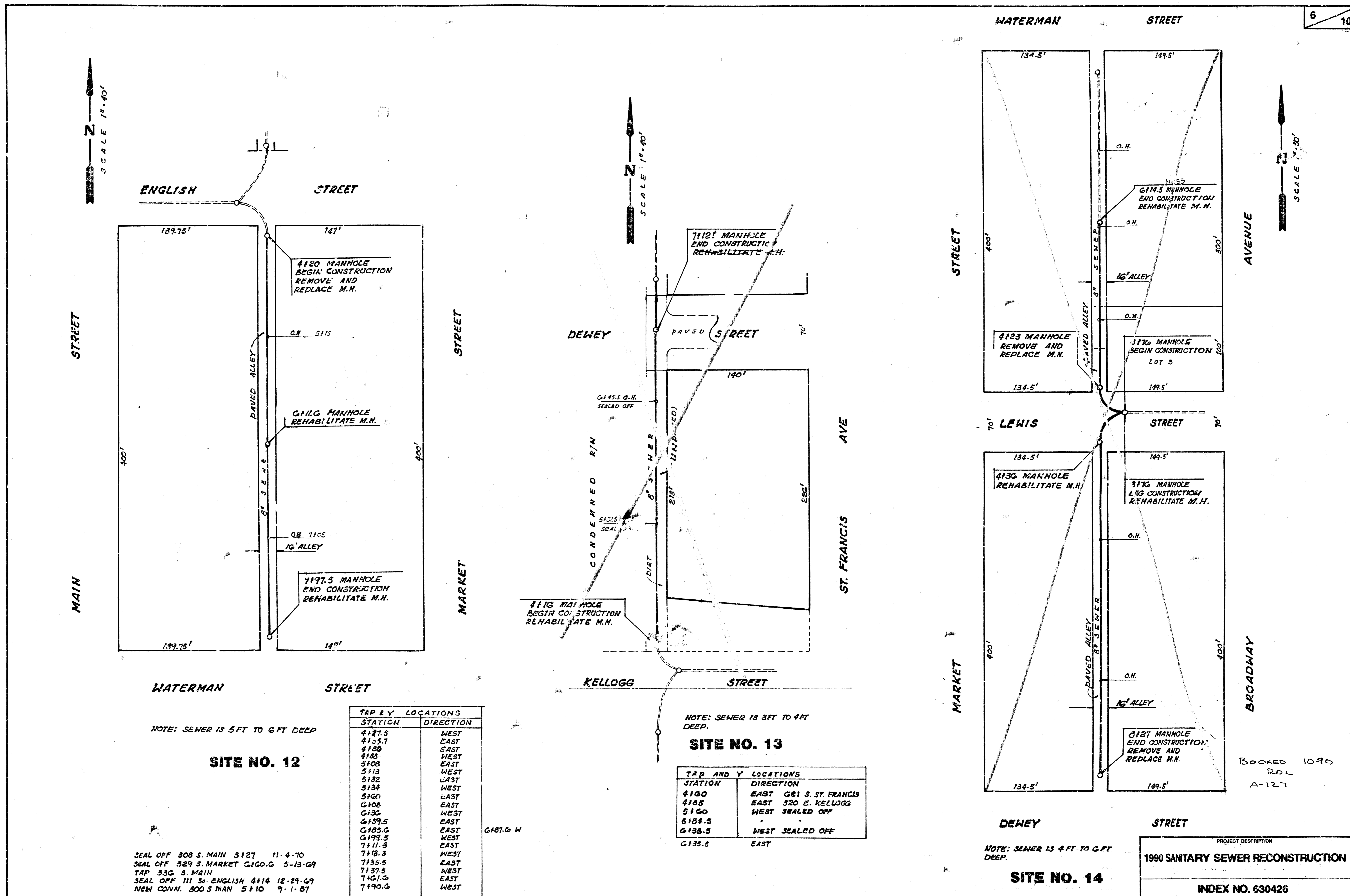

ENGLISH STREET

SCALE 1"=40'

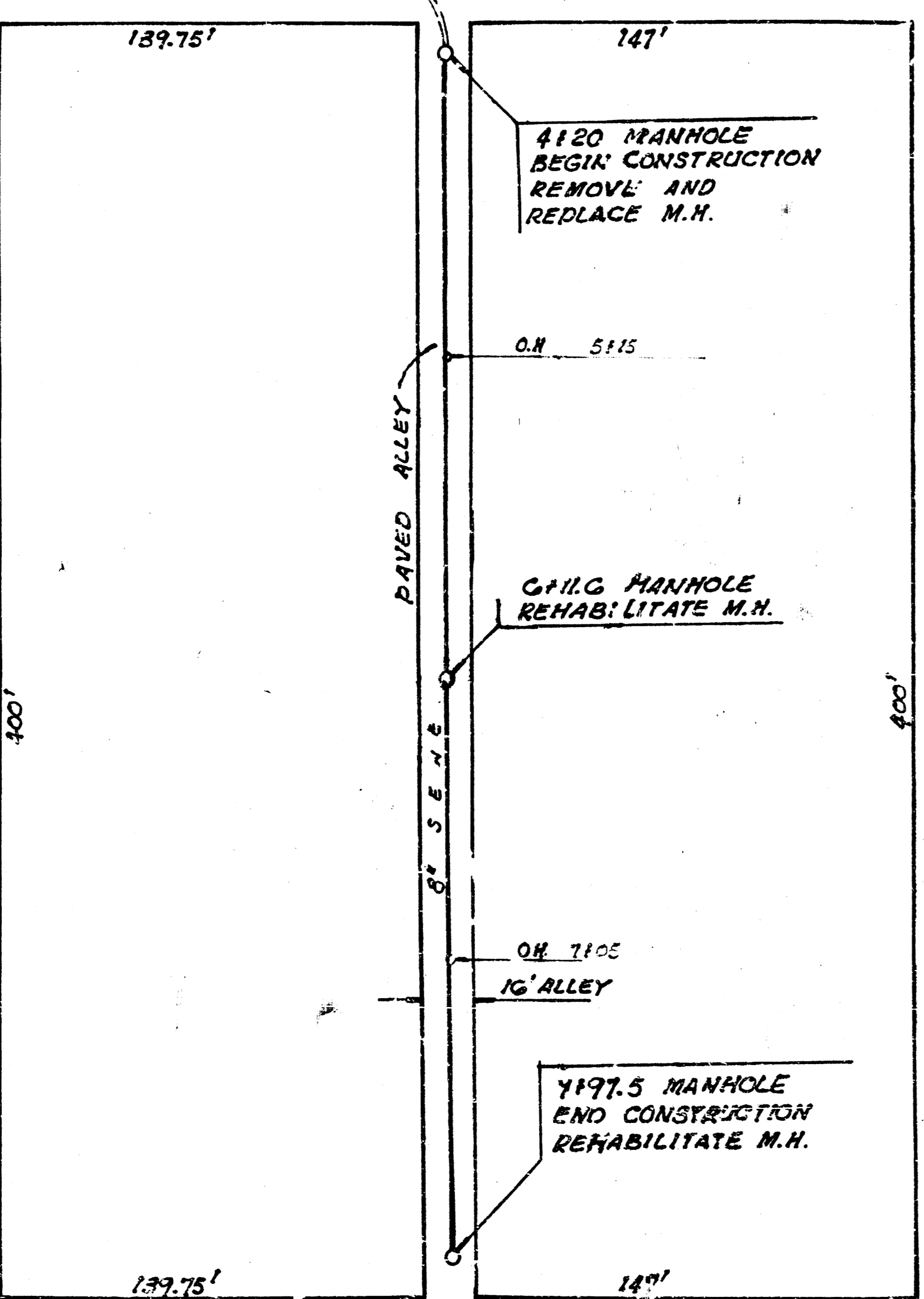

DEWEY STREET

SCALE 1"=40'

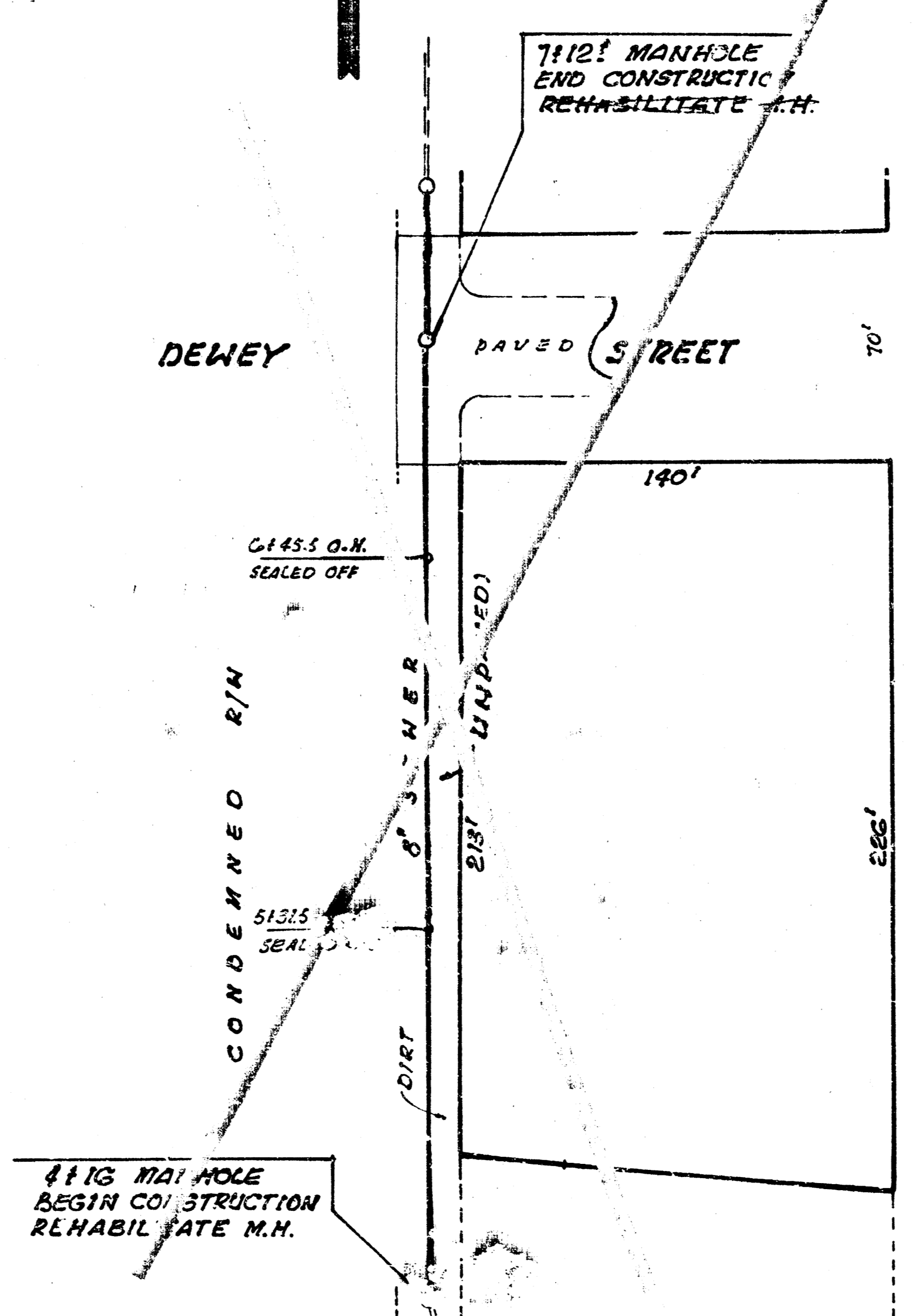

WATERMAN STREET

6 10

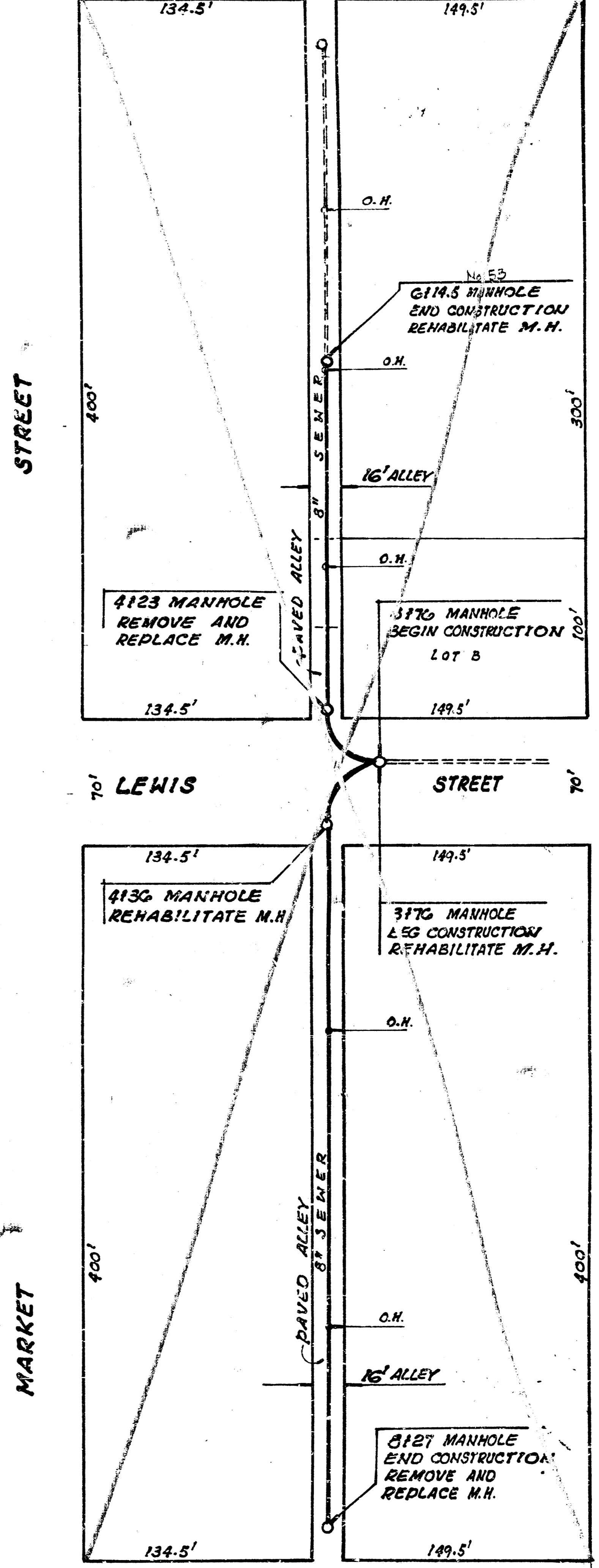

SCALE 1"=30'

TAP & Y LOCATIONS	
STATION	DIRECTION
4127.5	WEST
4135.7	EAST
4180	EAST
4188	EAST
5108	EAST
5113	WEST
5132	EAST
5134	WEST
5160	EAST
G108	EAST
G132	WEST
G159.5	EAST
G185.0	EAST
G199.5	WEST
7111.5	EAST
7113.3	WEST
7135.5	EAST
7137.5	WEST
7161.0	EAST
7190.0	WEST

TAP AND Y LOCATIONS	
STATION	DIRECTION
4160	EAST G81 S. ST. FRANCIS
4185	EAST 520 E. KELLOGG
5160	WEST SEALED OFF
G184.5	WEST SEALED OFF
G188.5	WEST SEALED OFF
G135.5	EAST

SEAL OFF 308 S. MAIN 3+27 11-4-70
 SEAL OFF 529 S. MARKET G160.0 5-13-69
 TAP 330 S. MAIN
 SEAL OFF 111 So. ENGLISH 4+14 12-29-69
 NEW CONN. 300 S. MAIN 5+10 9-1-67

NOTE: SEWER IS 4 FT TO 6 FT DEEP.

PROJECT DESCRIPTION
 1990 SANITARY SEWER RECONSTRUCTION
 INDEX NO. 630426

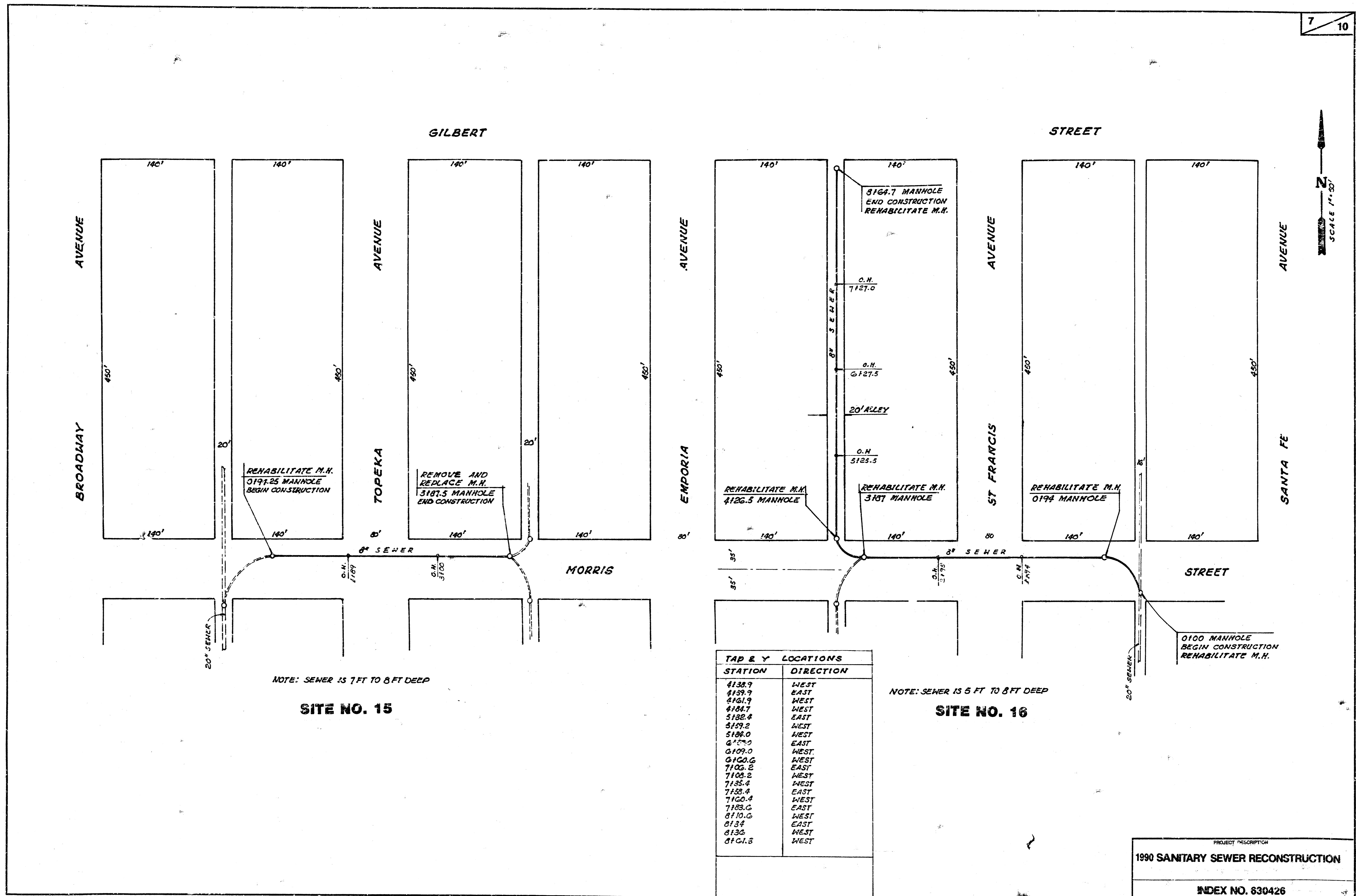

NOTE: SEWER IS 7 FT TO 8 FT DEEP

SITE NO. 15

NOTE: SEWER IS 5 FT TO 8 FT DEEP

SITE NO. 16

TAP & Y LOCATIONS	
STATION	DIRECTION
4138.9	WEST
4139.9	EAST
4161.9	WEST
4164.7	WEST
5132.4	EAST
5139.2	WEST
5186.0	WEST
6127.0	EAST
6109.0	WEST
6100.6	WEST
7100.2	EAST
7108.2	WEST
7135.4	WEST
7138.4	EAST
7160.4	WEST
7183.6	EAST
8110.6	WEST
8134	EAST
8136	WEST
8161.3	WEST

PROJECT DESCRIPTION
1990 SANITARY SEWER RECONSTRUCTION
 INDEX NO. 630426

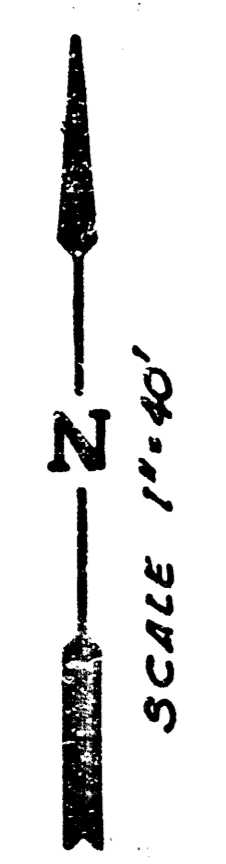

DOUGLAS AVENUE

EMPIRIA AVENUE

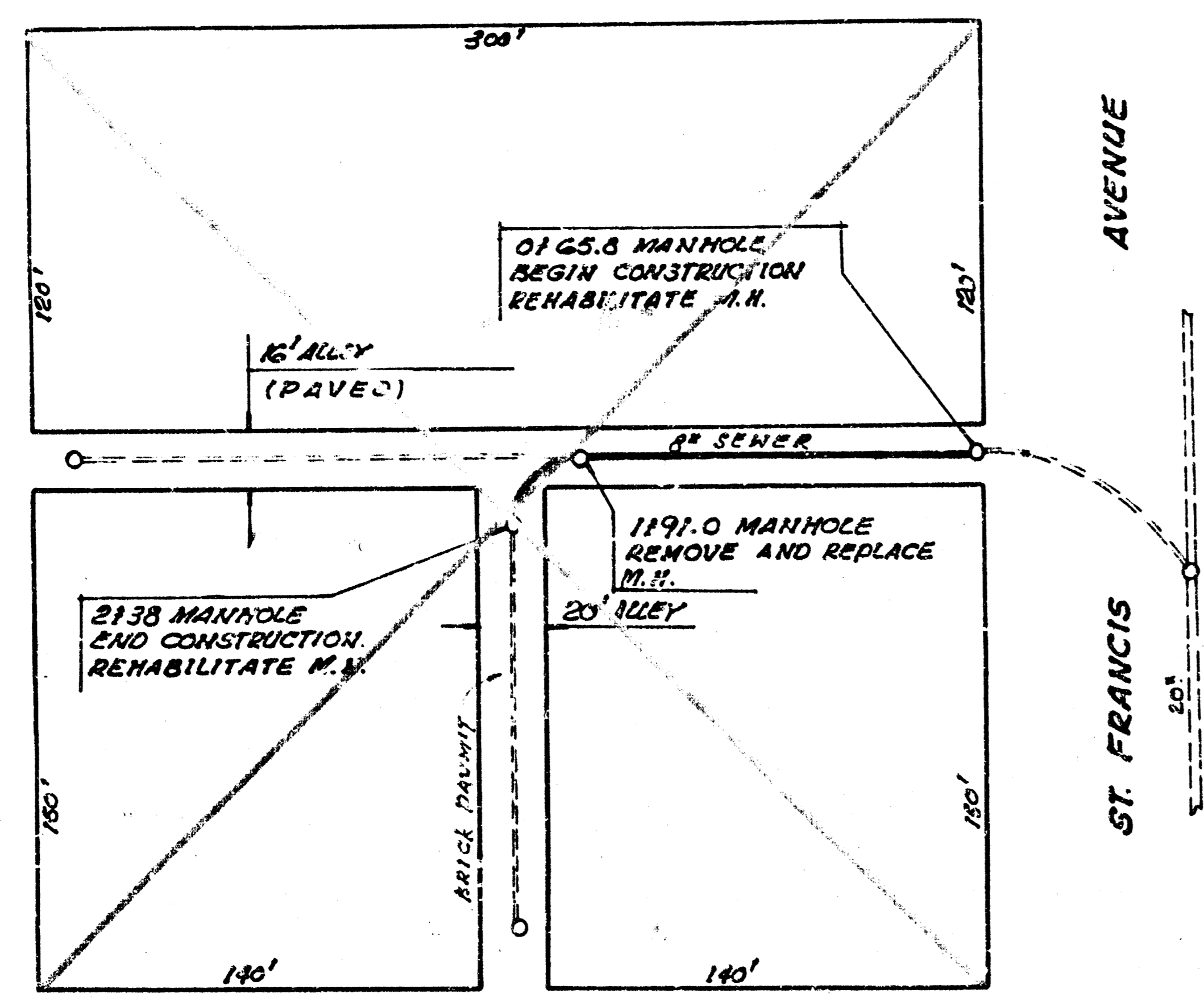

WILLIAM STREET
 NOTE: SEWER IS 3 FT TO 7 FT DEEP
SITE NO. 17

Booked 10-90 RDL
 A-2+3

ST. FRANCIS AVENUE

ST. FRANCIS

ST. FRANCIS AVE

ST. FRANCIS

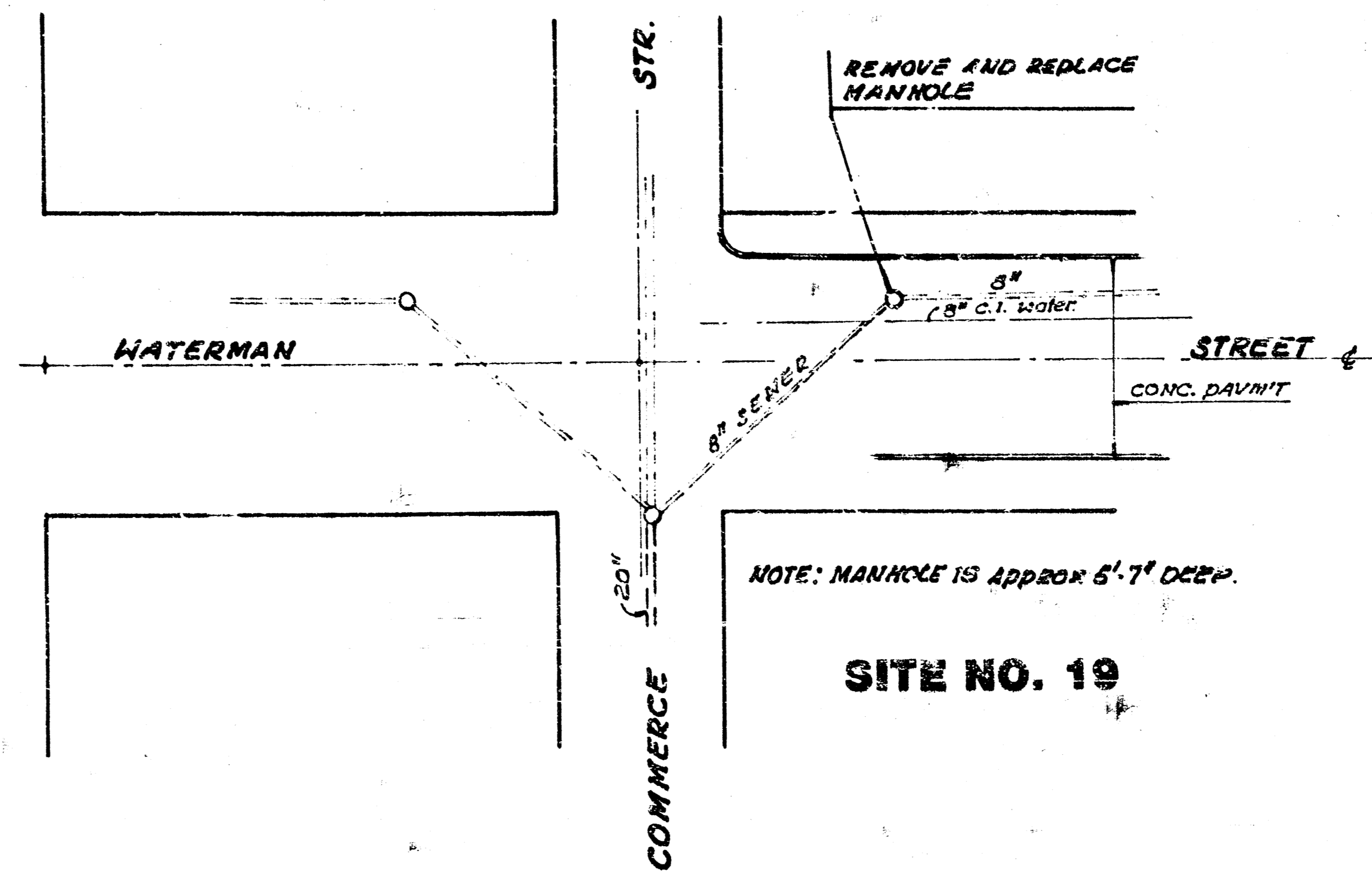

NOTE: MANHOLE IS APPROX 5'-7\"/>
SITE NO. 19



DOUGLAS AVENUE

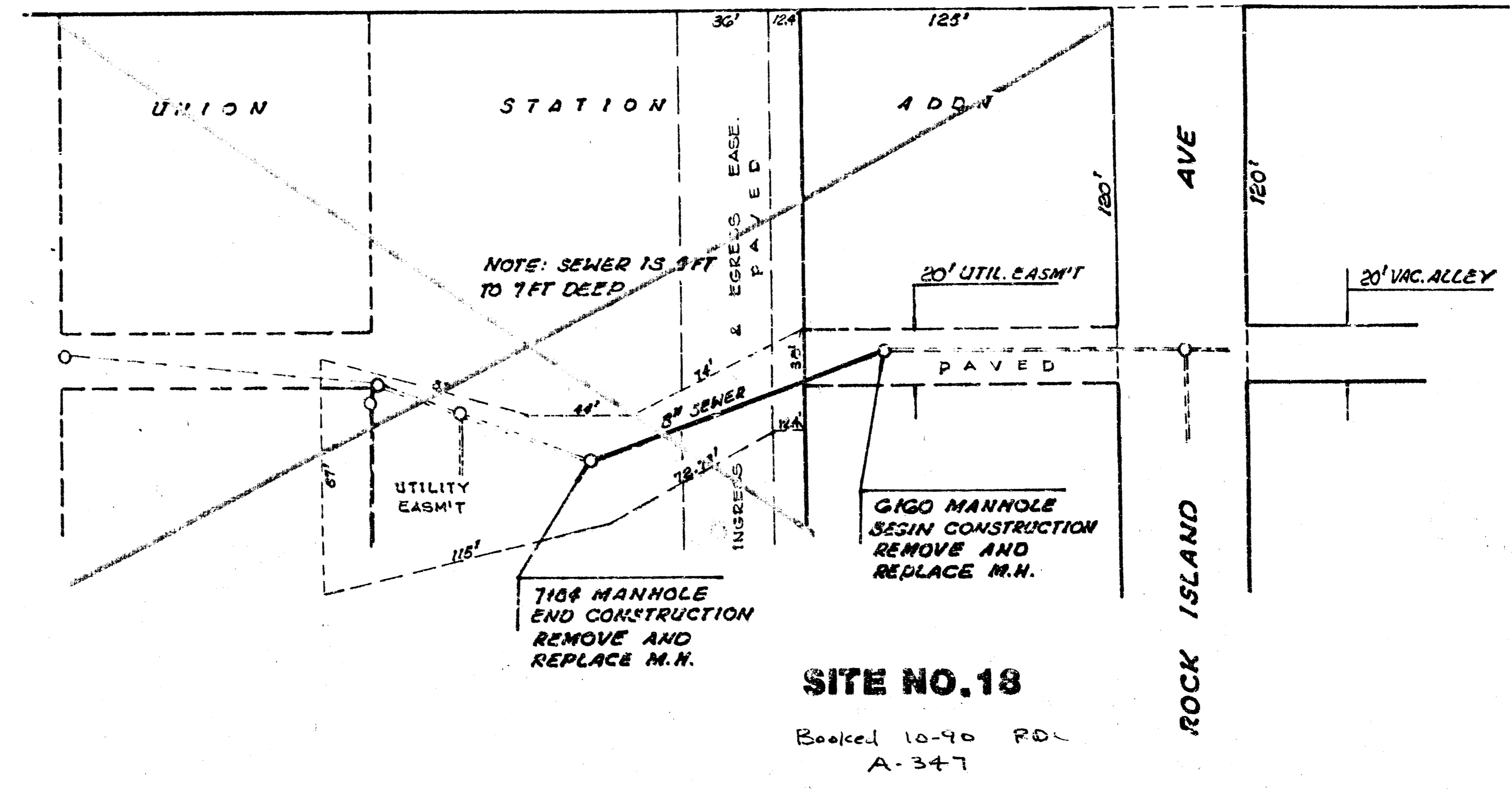
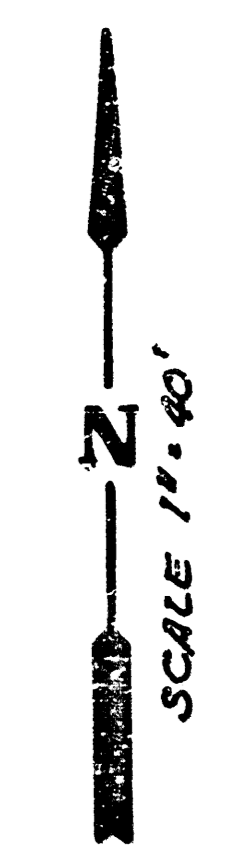

SITE NO. 18
 Booked 10-90 RDL
 A-3+7

ST. FRANCIS AVENUE

ROCK ISLAND AVE

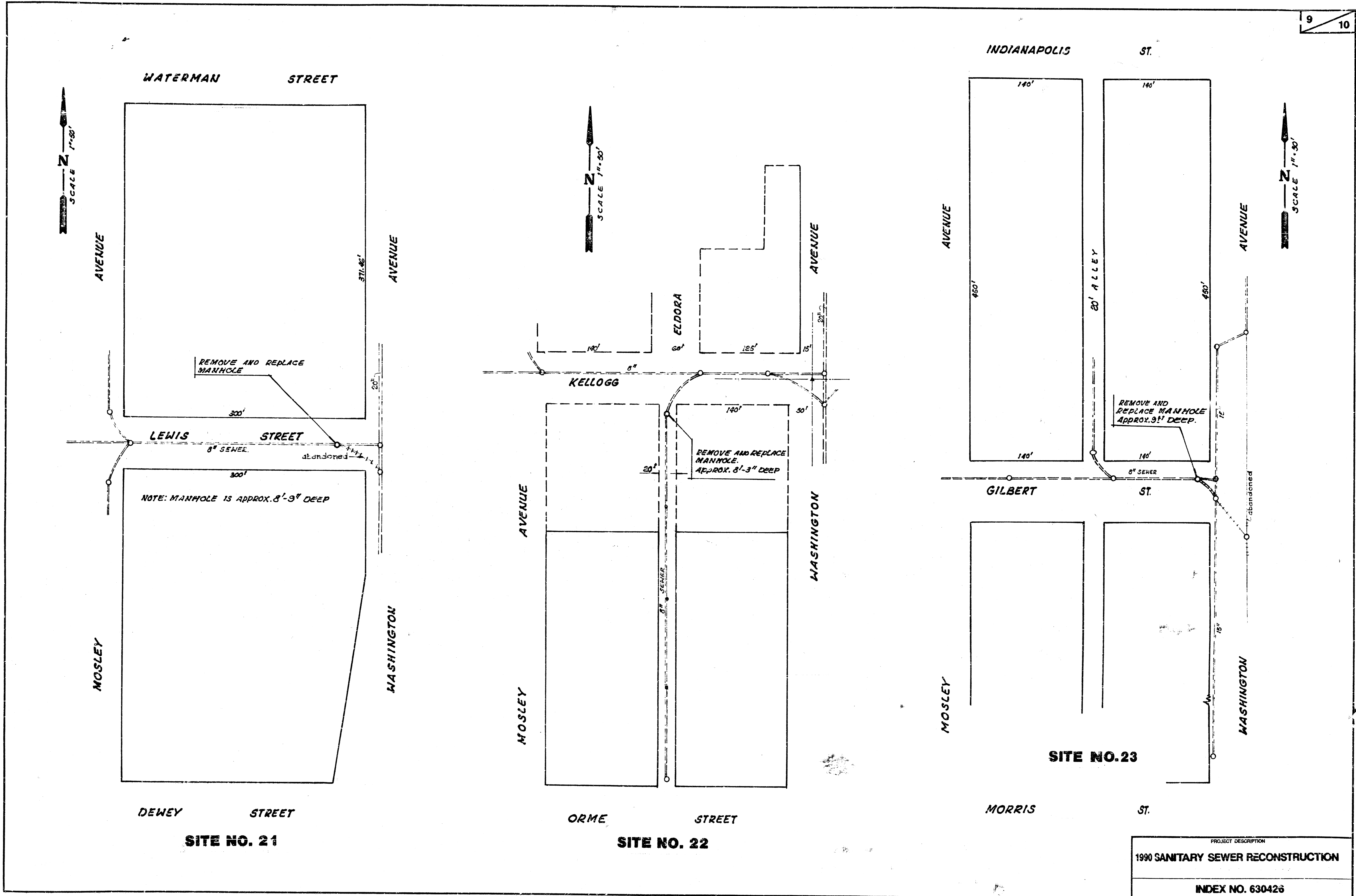

PROJECT DESCRIPTION
 1990 SANITARY SEWER RECONSTRUCTION
 INDEX NO. 630426

