

B.M. 11739 R.R. 50k. N.W. Face Tele. Pole, Approx. 305' 3rd E
 8th St. on W. Side Waco.
 B.M. 11678 'a' Cut Top Curb South End Medial E Waco N.C. Murdock.

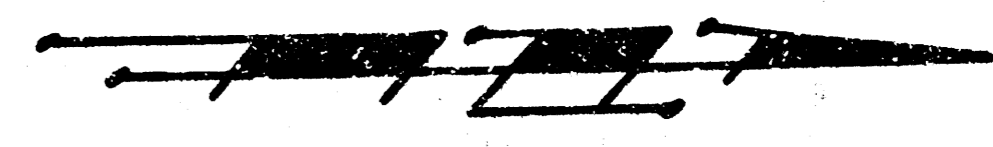

Scale -
 Plan: 1" = 40'
 Profile: 1" = 20' - Hor.
 1" = 5' - Vert.

Sewer & M.H.'s to be
 Abandoned See Note.

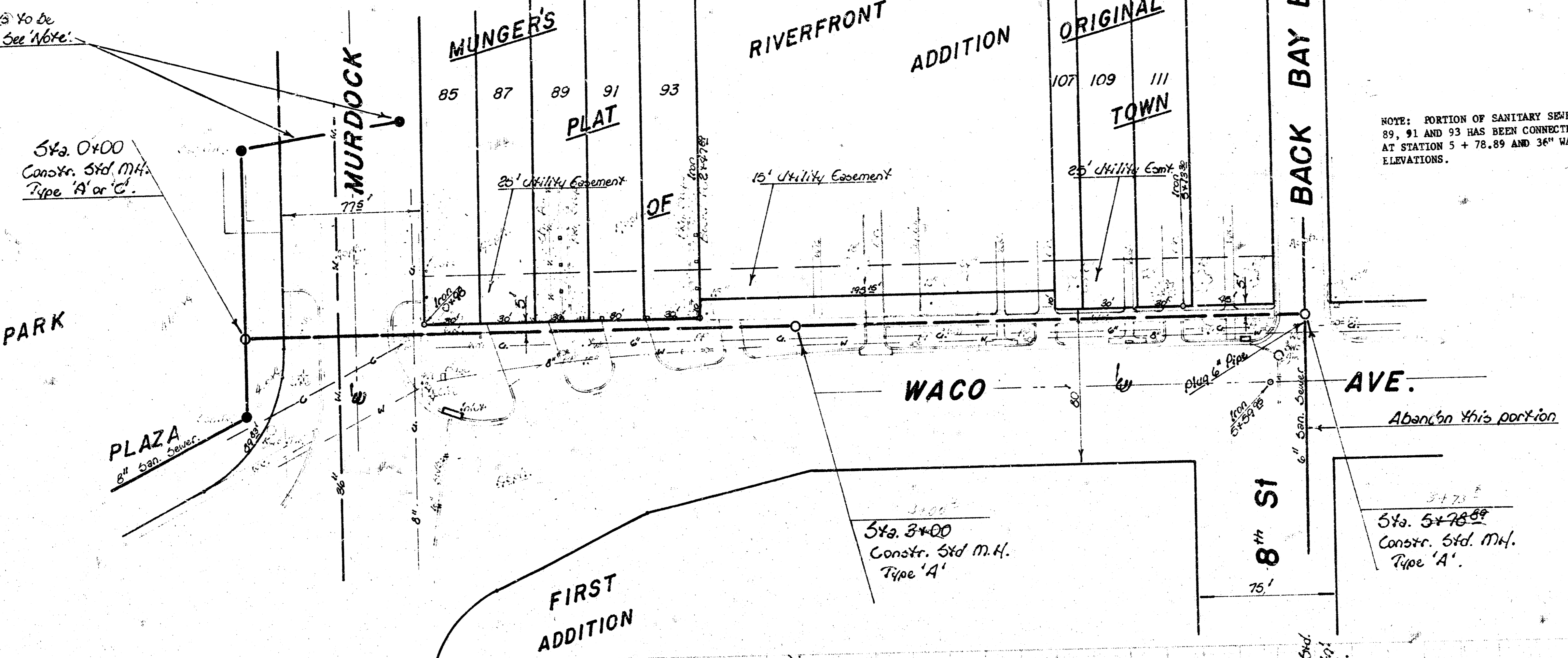

NOTE: PORTION OF SANITARY SEWER CROSSING MURDOCK SHALL BE ABANDONED AS INDICATED BY PLANS AFTER THE BUILDING ON LOTS 89, 91 AND 93 HAS BEEN CONNECTED TO THE NEW SEWER ON THE WEST SIDE OF WACO. CONTRACTOR SHALL EXPOSE 6" SANITARY SEWER AT STATION 5 + 78.89 AND 36" WATER MAIN AT STATION 0 + 48 PRIOR TO INSTALLING ANY PIPE SO FIELD ENGINEER CAN VERIFY ELEVATIONS.

Note -

Contractor to contact Bell Telephone Co. & KGE for location of underground lines at construction time in the field. 6" San. Sewer Pipe to be plugged at the Manhole located approx. 213' East of E Waco & 15' S. of N.C. 8th St.

Note -
 W - Indicates Water Line
 C - Indicates Gas Line
 - - - - - Indicates Cable TV Line

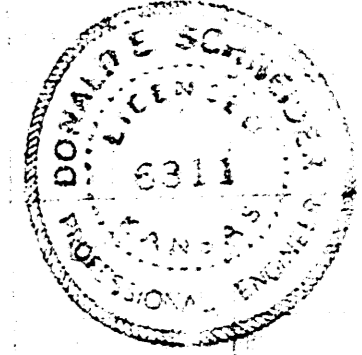
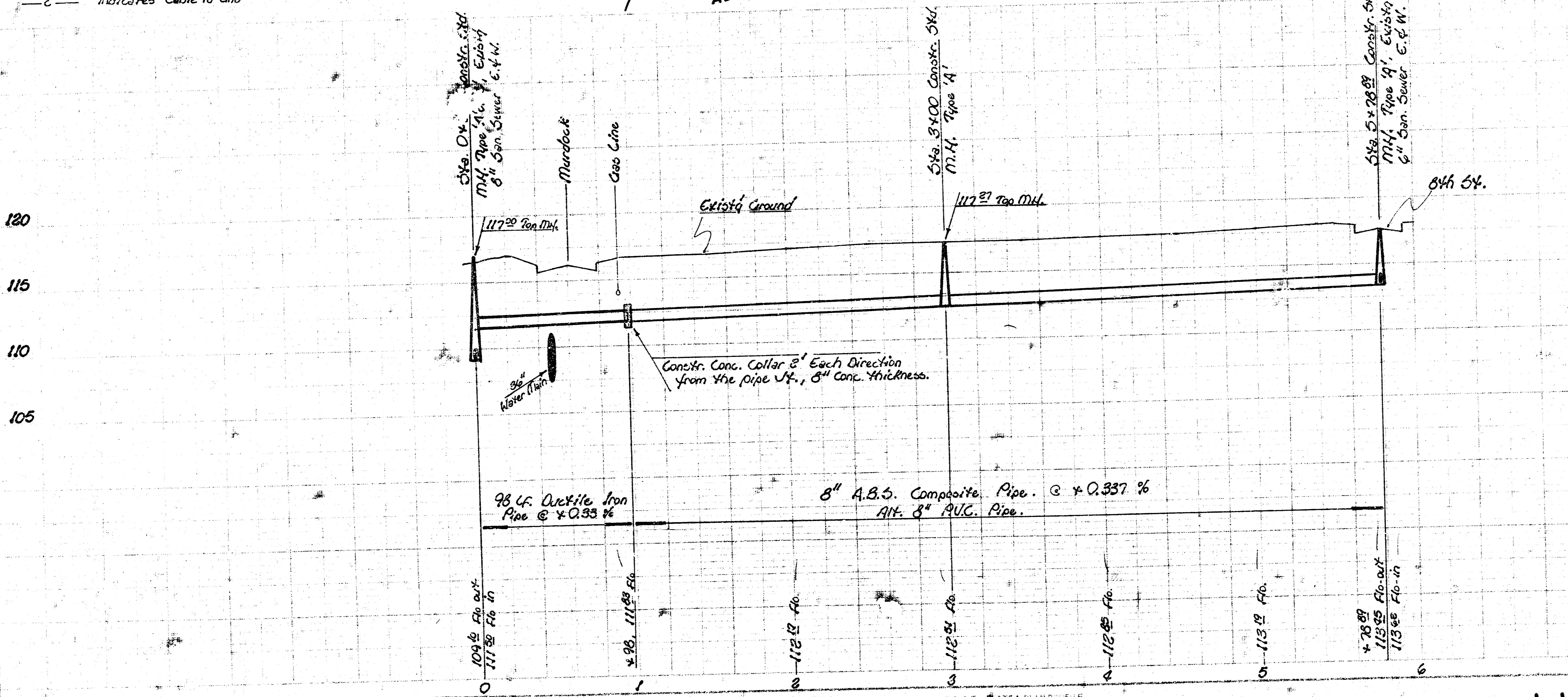

As Built 6/2/80
LAT. 1, WEST MAIN A, S.S. 1
CITY OF WICHITA, KS.
 R. W. Linn City Engineer
 Project No. 468-76-245-80712-000-000-001
 Date

14 10 3 2