

3. M. 10229 S.E. 20th St. Slop
 JUNIT APT'S 212 & Dewey.

4. M. 10333 1/2 in Branch & W. E.
 177 E of E. of Alley N. of Lewis
 bet Emporia & Topeka.

Sta. 3+00.0 Exist. M.H.
 Exist. 8" - 20' STD. No.

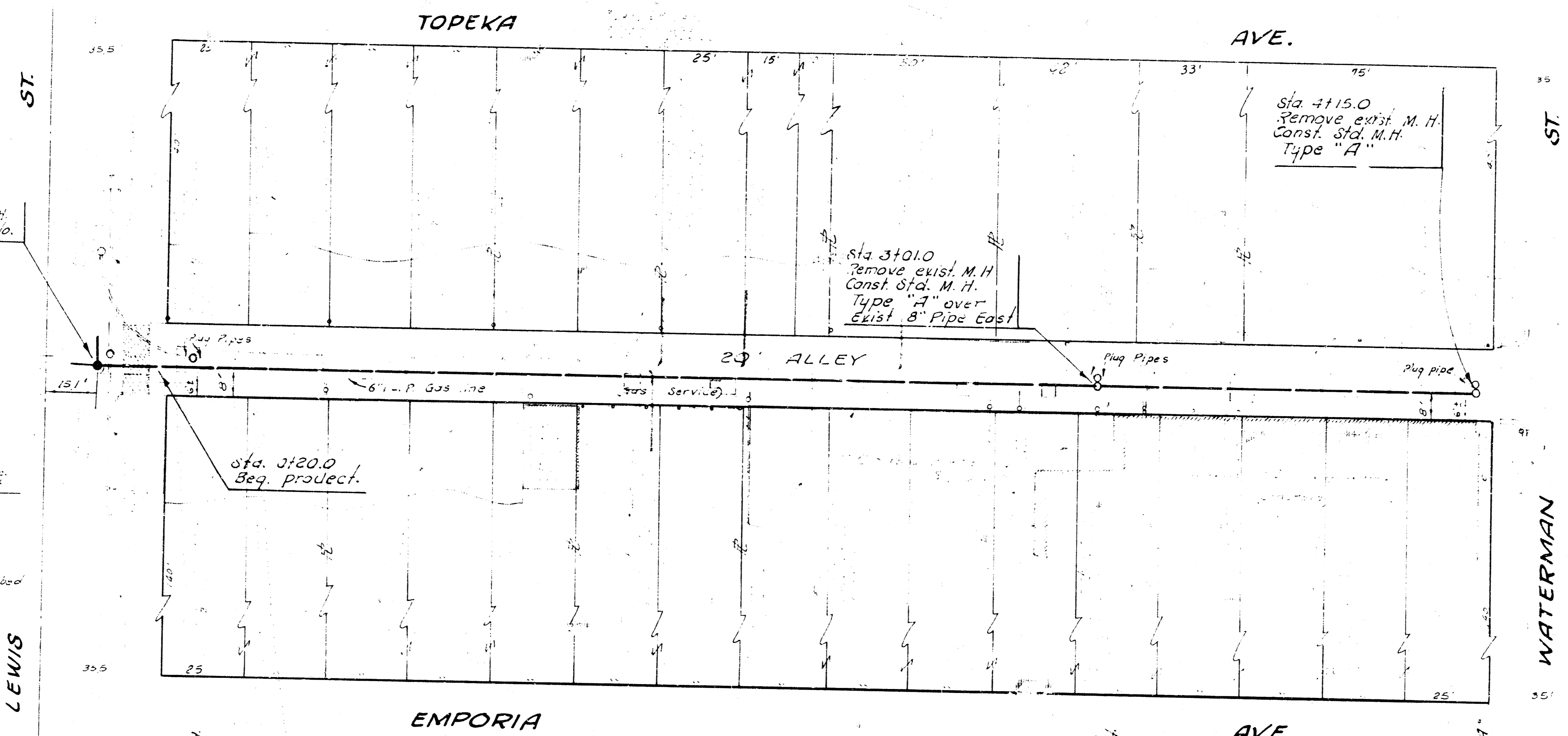
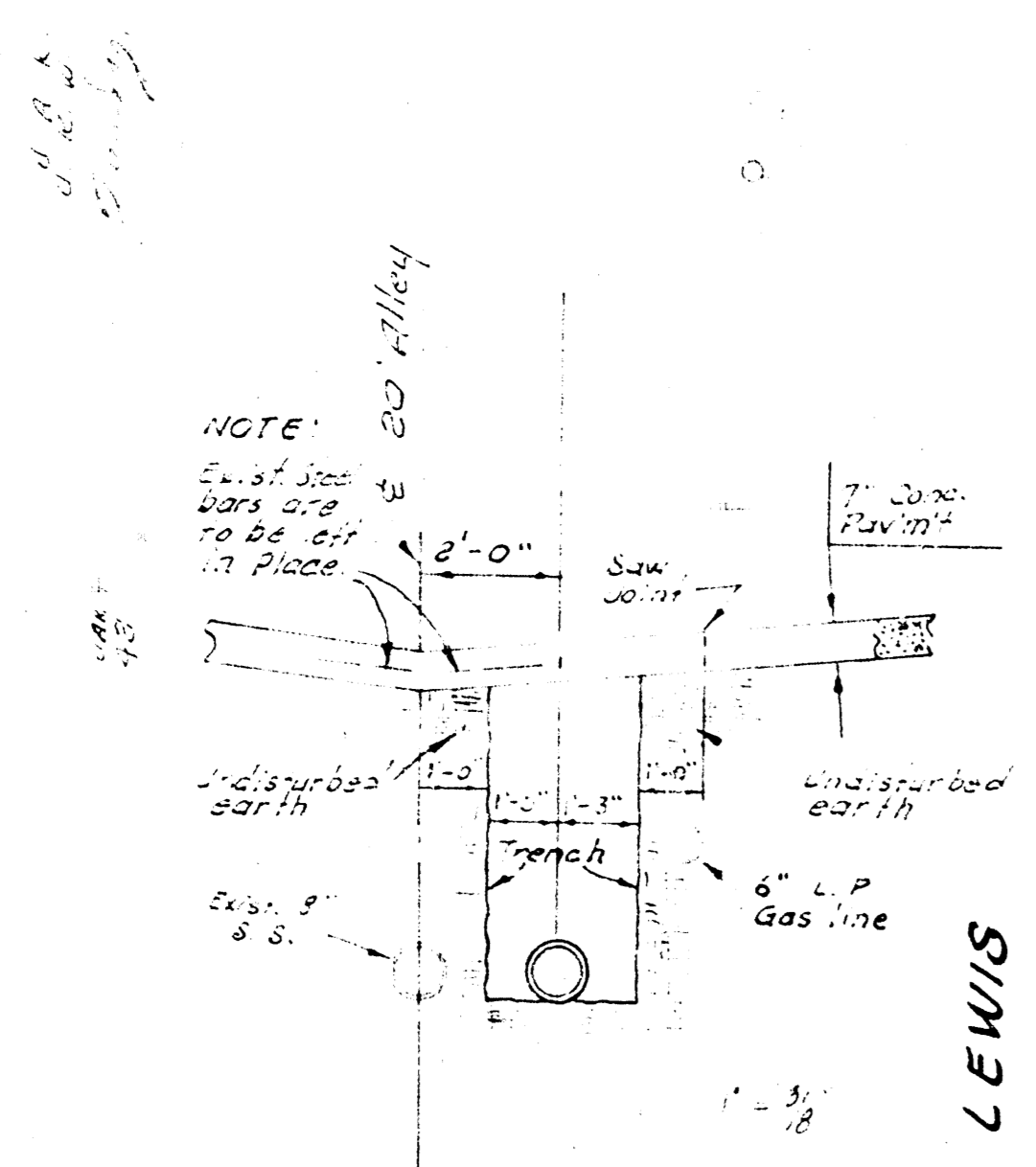

Sta. 3+10.0
 Exist. M.H.
 Const. Std. M.H.
 Type 'A' over
 8" Pipe Cast

Sta. 3+10.0
 Beg. Project
 Remove of Exist. M.H.

Sta. 3+10.0
 Const. Std. M.H.
 Type 'A' over
 8" Pipe Cast

Sta. 4+15.0
 Exist. M.H.
 Const. Std. M.H.
 Type 'A'

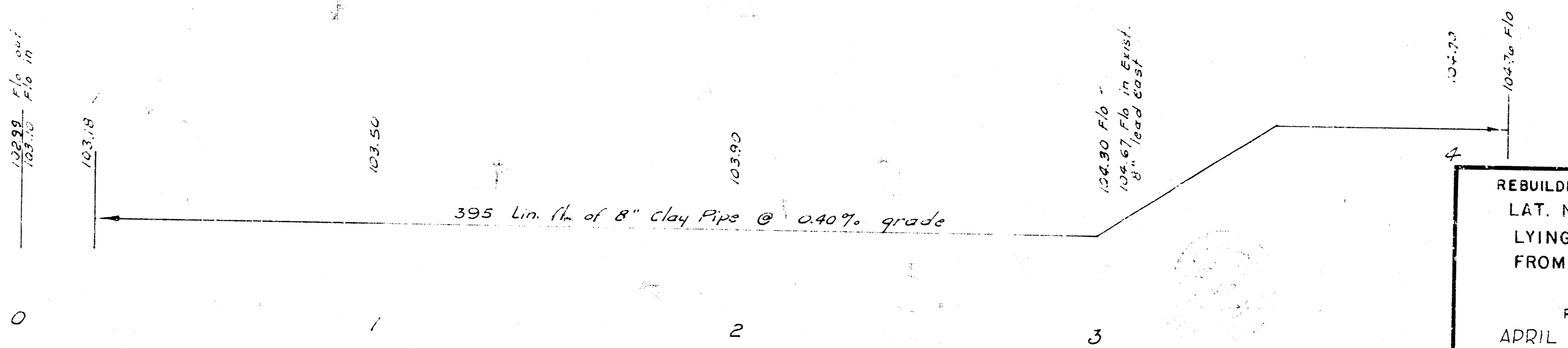
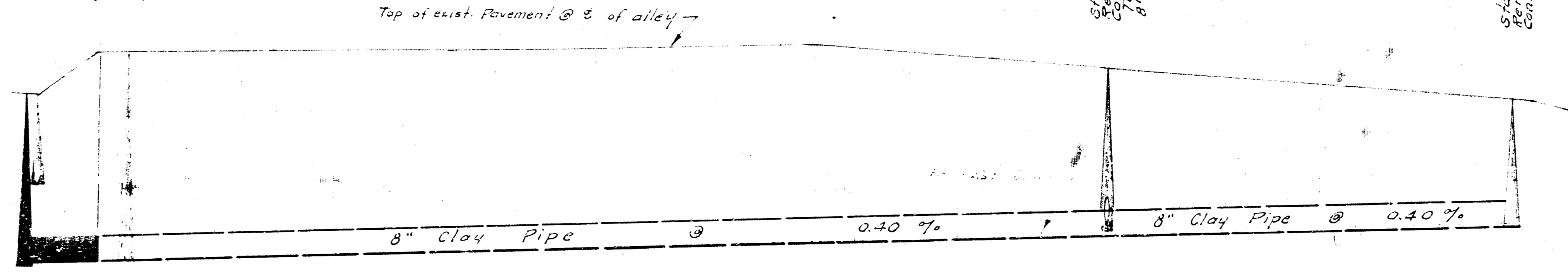

3. M. 10241 1/2 in W. E. branch
 W. E. branch bet. Dewey and
 Emporia S. Side Waterman
3. M. 10401 1/2 in S. E. branch
 S. E. branch bet. Emporia &
 S. W. Waterman & Emporia
3. M. 10259 1/2 in W. E. branch
 bet. Topeka & Emporia S. Side Waterman.

- NOTE TO CONTRACTOR
 AND FIELD ENGR:**
1. Reconnect all existing service leads which are in use.
 2. Plug all service leads east of Sta. 3+10.0 and west of Sta. 4+15.0.
 3. Contractor to coordinate timing of service connections with City maintenance work.
 4. Pipe plugs used on 8" pipe shall be identical to old pipe of M.H. removed.
 5. Contractor will be required to obtain permits for all service connections. Permits will be waived by Dept. of Public Works.

REBUILDING AND RECONSTRUCTION OF A PORTION OF
 LAT. N OF EAST SUBMAIN B, S. S. NO. 1
 LYING IN ALLEY BETW. TOPEKA & EMPORIA
 FROM LEWIS ST. TO WATERMAN ST.
 CITY OF WICHITA, KANSAS
 R. W. LINN — CITY ENGINEER
 APRIL 1972 PROJECT NO. DSKL 572020