

**BENCH MARKS:**

HEADBOLT BETWEEN "MUELLEE" AND "CHATTANOOGA" ON FIRE HYDRANT @ N.W. COR. WATERMAN AND WICHITA, ELEV. 111.56  
 7" IN CONC. PVTMT ON WICHITA, STA. 3+50, ELEV. 110.23

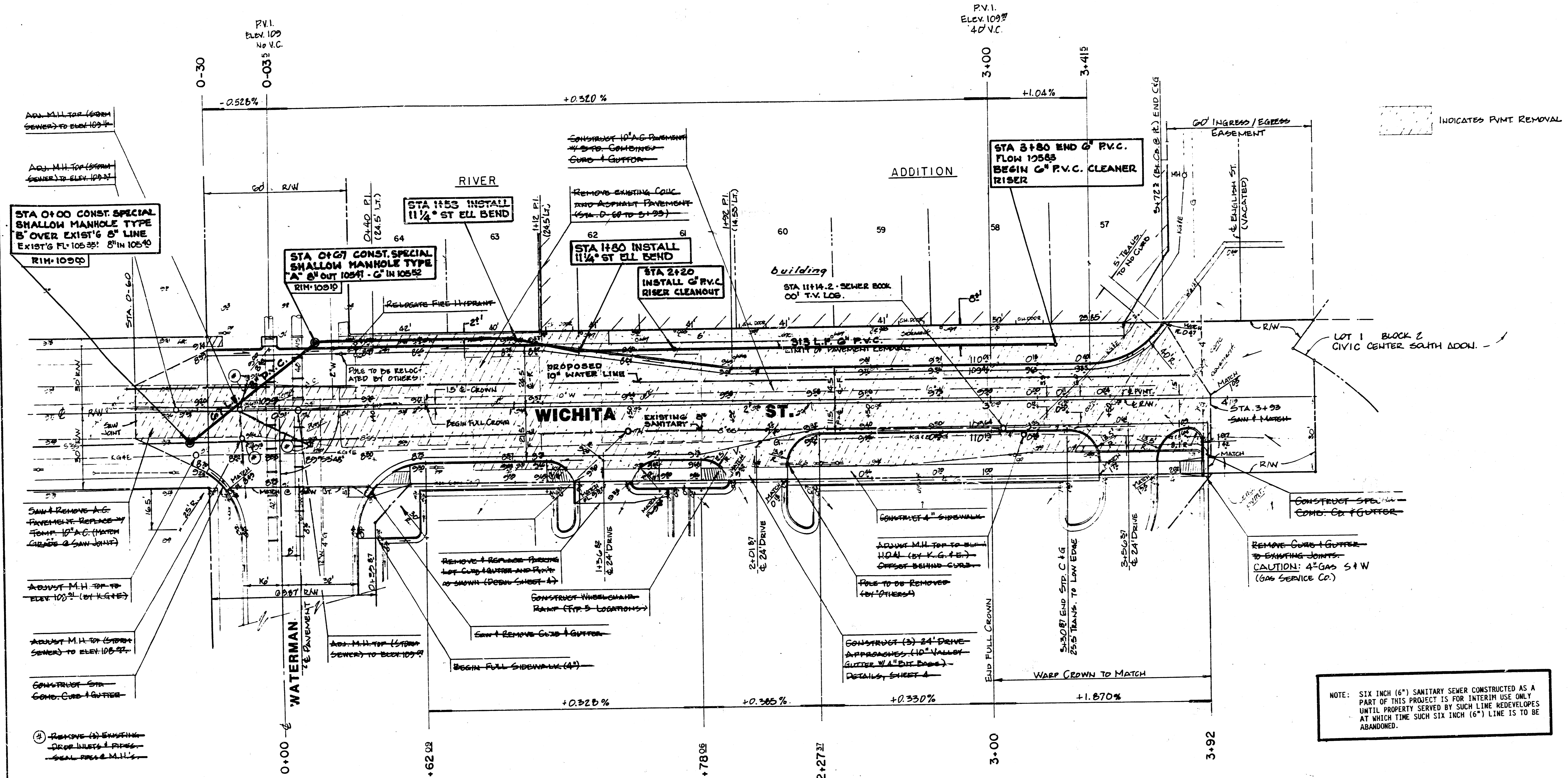
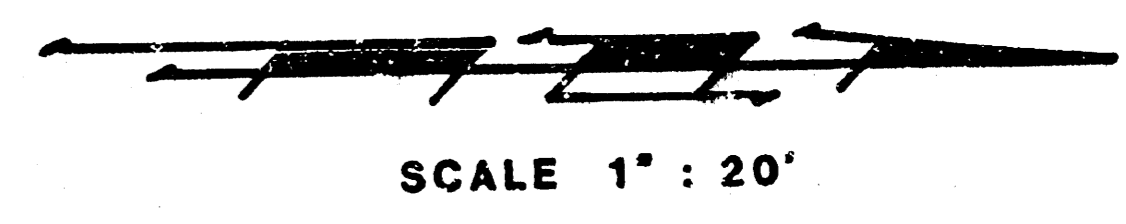

- GENERAL NOTES**
1. PRICE BID PER LINEAL FOOT OF 8" OR 6" R.V.C. SHALL INCLUDE THE COST OF ALL MATERIAL, LABOR, EQUIPMENT, EXCAVATION, BACKFILLING AND OTHER INCIDENTALS NECESSARY TO COMPLETE THE WORK.
  2. CLEANOUTS SHALL BE MEASURED AND PAID FOR AS LINEAL FEET OF 6" R.V.C.
  3. ONLY ACTIVE BUILDING SEWER LINES WHICH CONNECT ACTUAL BUILDINGS TO THE SEWER SYSTEM ARE TO BE RECONNECTED TO THE NEW SEWER CONSTRUCTION. IT WILL BE THE SOLE RESPONSIBILITY OF THE CONTRACTOR TO ASCERTAIN WHICH SUCH BUILDING SEWER LINES AND/OR CONNECTIONS ARE ACTIVE AND WHICH SEWERS AND/OR CONNECTIONS HAVE BEEN ABANDONED.
  4. CONTRACTOR TO CONTACT JERRY BLAINE 206-4210 FOR T.V. LOG OF EXISTING SEWER.

NOTE: SIX INCH (6") SANITARY SEWER CONSTRUCTED AS A PART OF THIS PROJECT IS FOR INTERIM USE ONLY UNTIL PROPERTY SERVED BY SUCH LINE REDEVELOPS AT WHICH TIME SUCH SIX INCH (6") LINE IS TO BE ABANDONED.

**RECONSTRUCT A PORTION OF LATERAL N, WEST SUBMAIN A, ON LEWIS, SANITARY SEWER NO. 1**

PROJECT NO.  
 468-76-245-81558-000-000-001

1/2 8/1

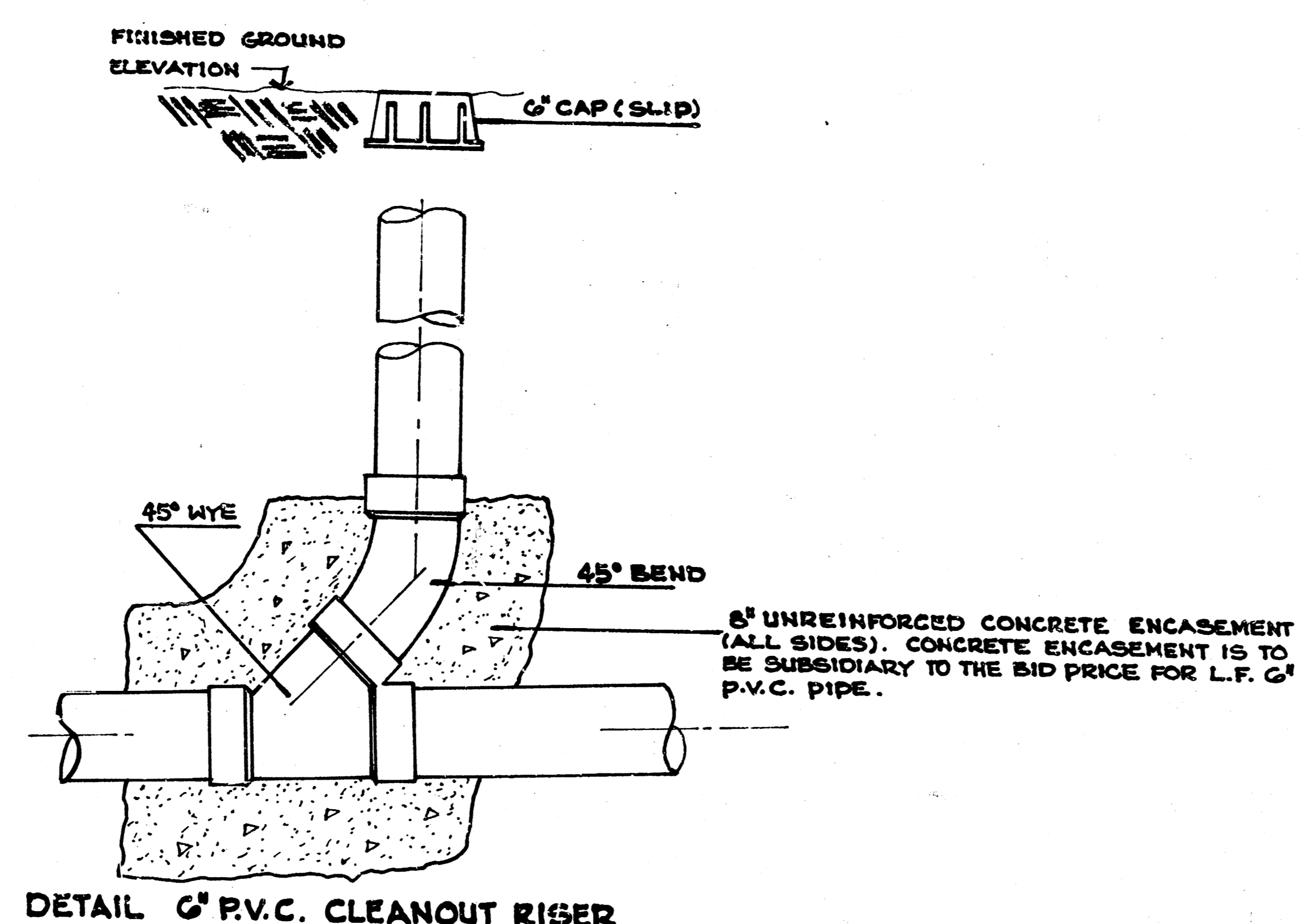

DETAIL 6" P.V.C. CLEANOUT RISER

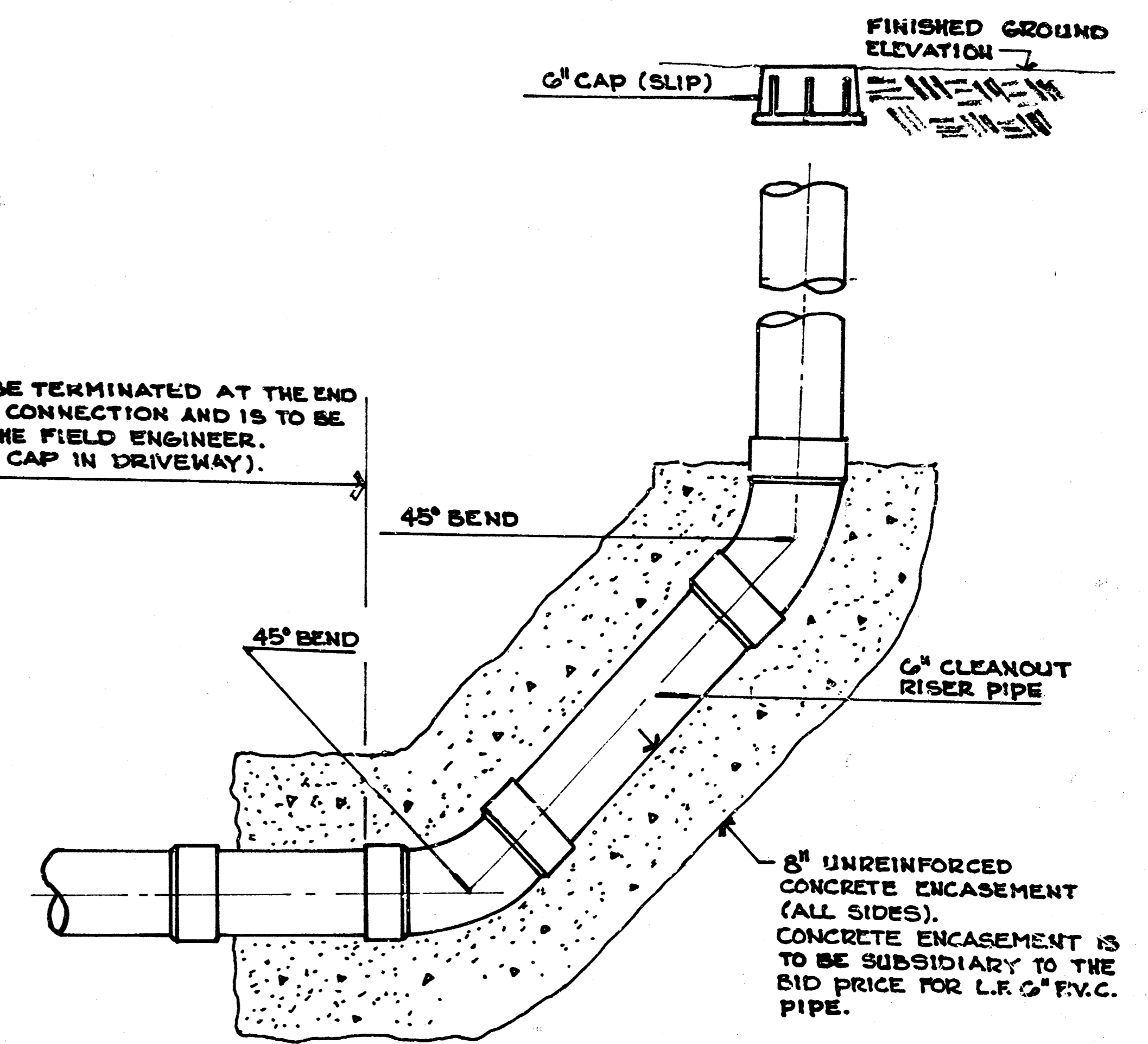

DETAIL 6" P.V.C. CLEANOUT RISER - END OF LINE-

END OF PIPE TO BE TERMINATED AT THE END OF LAST SERVICE CONNECTION AND IS TO BE DETERMINED BY THE FIELD ENGINEER. (DO NOT INSTALL CAP IN DRIVEWAY).

PROFILE SCALE  
1" = 1' VERT.  
1" = 20' HORIZ.

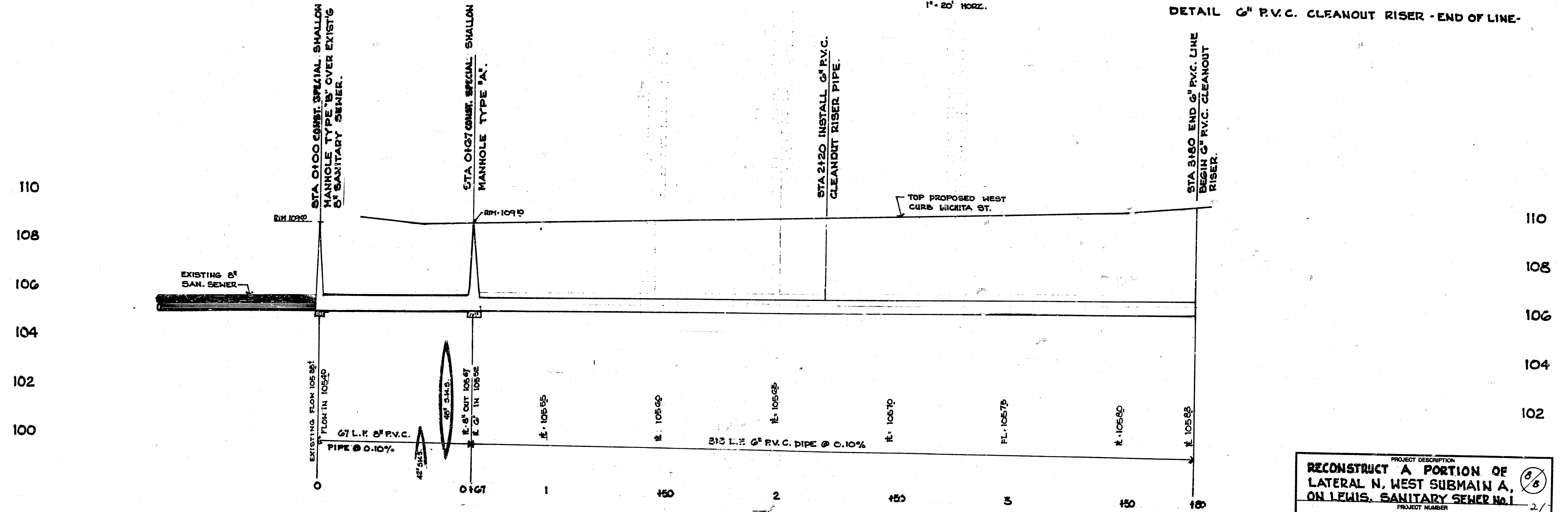

PROJECT DESCRIPTION  
**RECONSTRUCT A PORTION OF LATERAL N. WEST SUBMAIN A, ON LEWIS, SANITARY SEWER No. 1**  
PROJECT NUMBER  
468-76-245-81555-000-000-001

17 3 3 3