

B.M. 172.64 "□" On NW Wing Concrete Bridge Dellrose & 25th
 B.M. 175.23 Standard SW Oliver & 25th St.
 Plan Scale 1"=50'
 Profile Scale 1"=40' Hor., 1"=4' Vert.

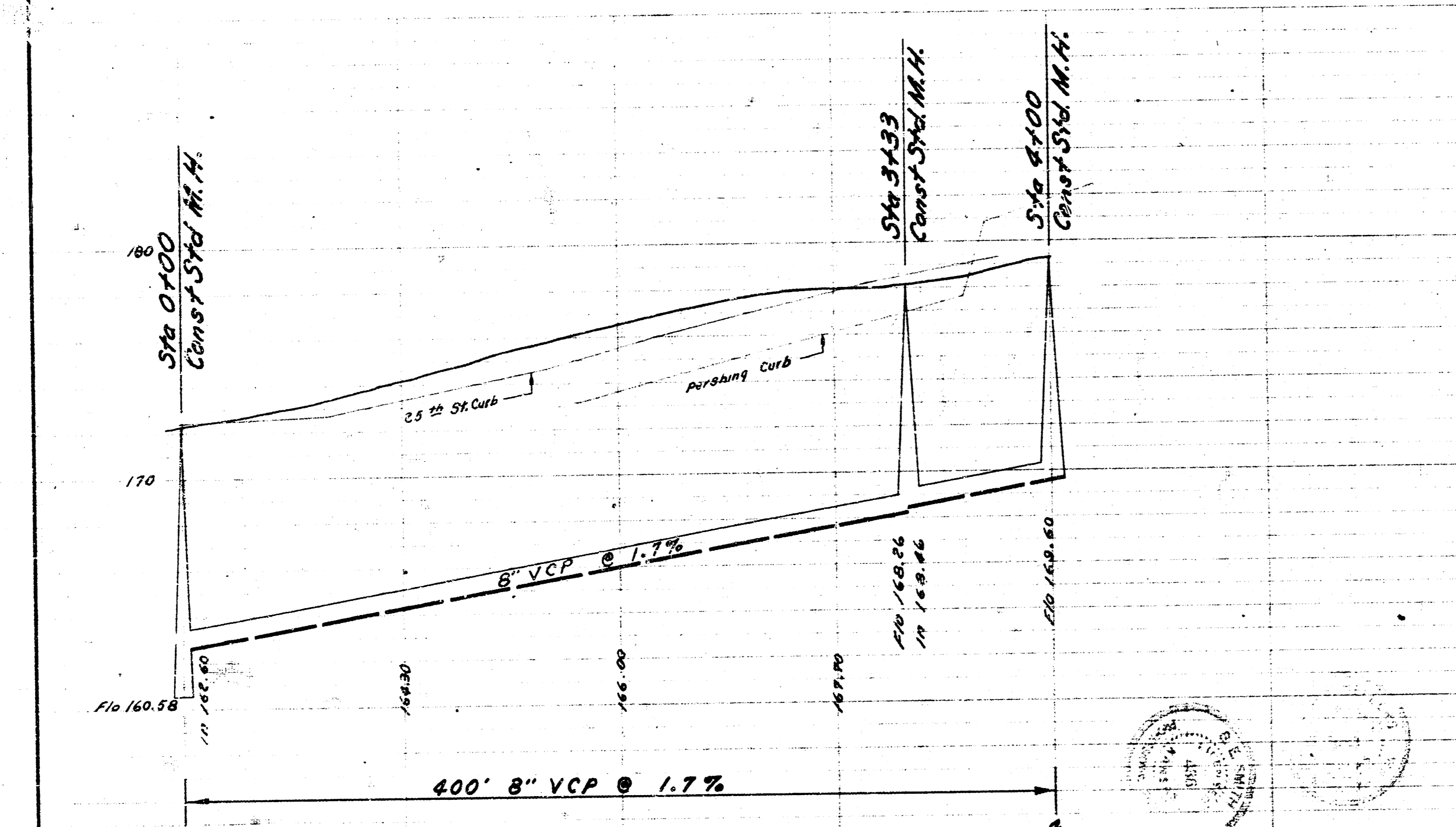

LAT 12 SUB 2 S.S. NO. 23
 CITY OF WICHITA KANSAS
 B.E. SMITH CITY ENGINEER
 PROJ. NO. C20-21 DATE APRIL 1962

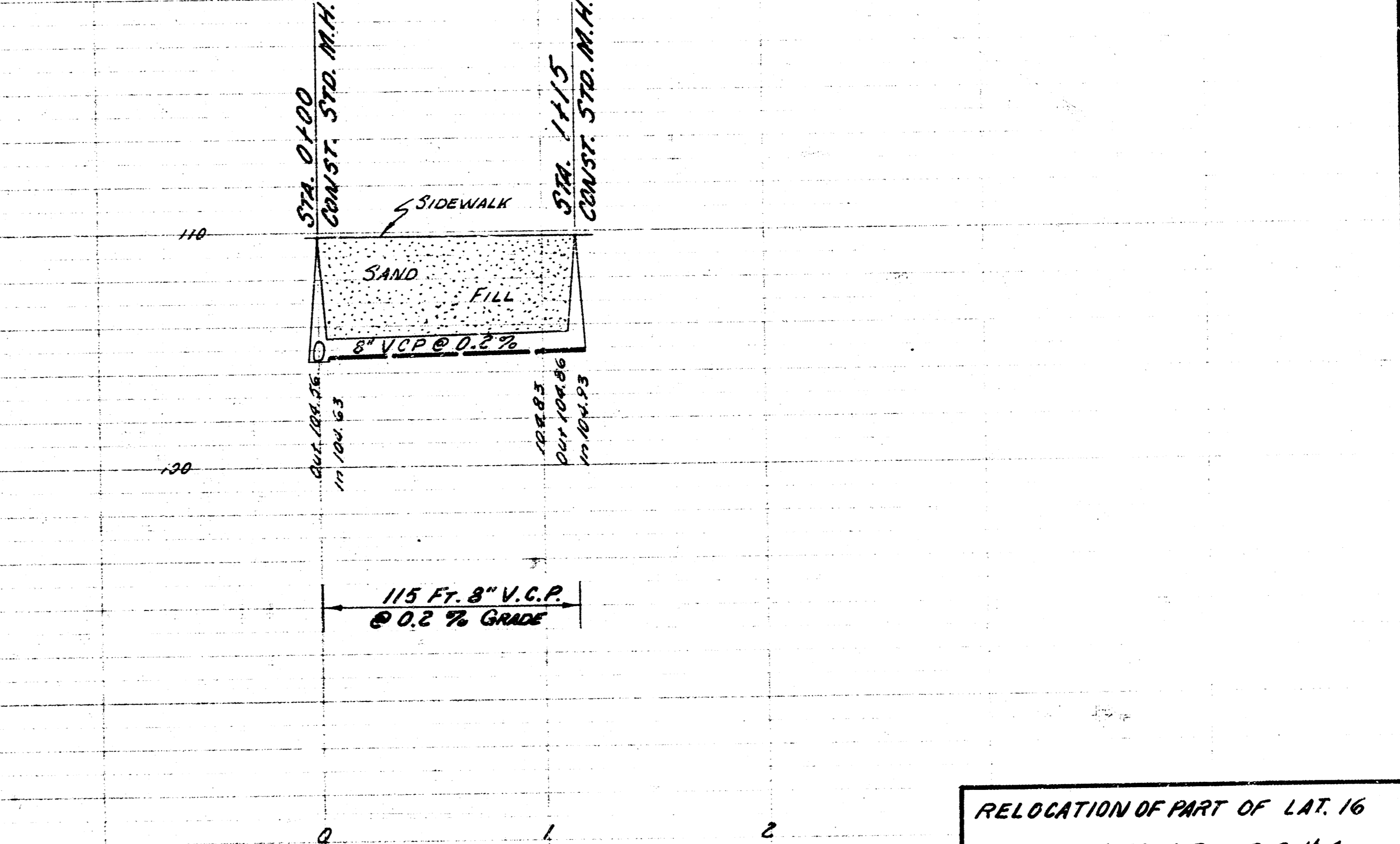
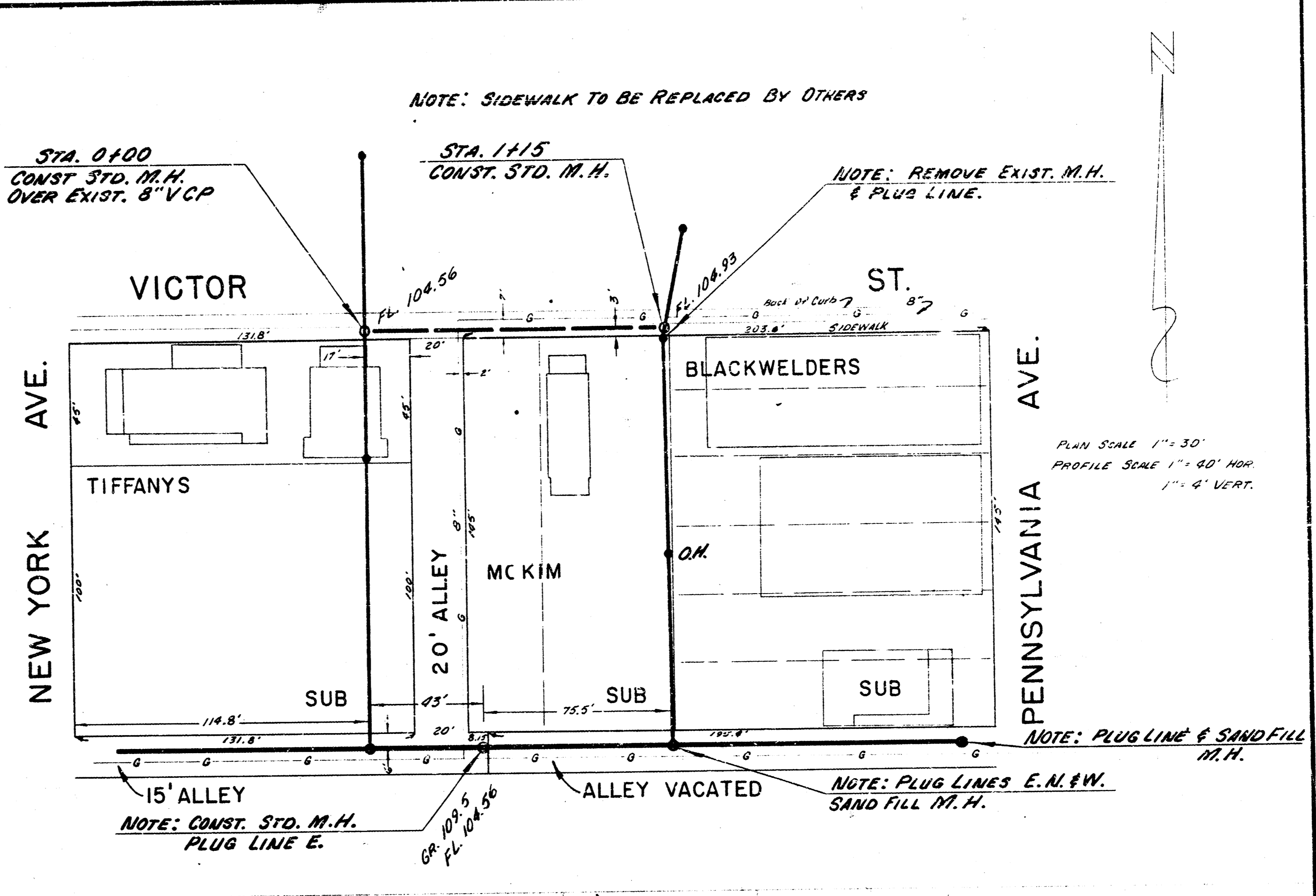

RELOCATION OF PART OF LAT. 16
 & 17 - SUBMAIN B - S.S. #4
 CITY OF WICHITA, KANSAS
 B.E. SMITH, CITY ENGINEER
 PRIVATE PROJ. DATE JULY 1962