

B.M. 194.12 Top bolt N.E. cor. Conoco sign S.W. Hillside & Central
 B.M. 137.24 S.W. cor. N.W. Interwall R.C.B.C. W. side Hillside & 900' S. of S.L. Central

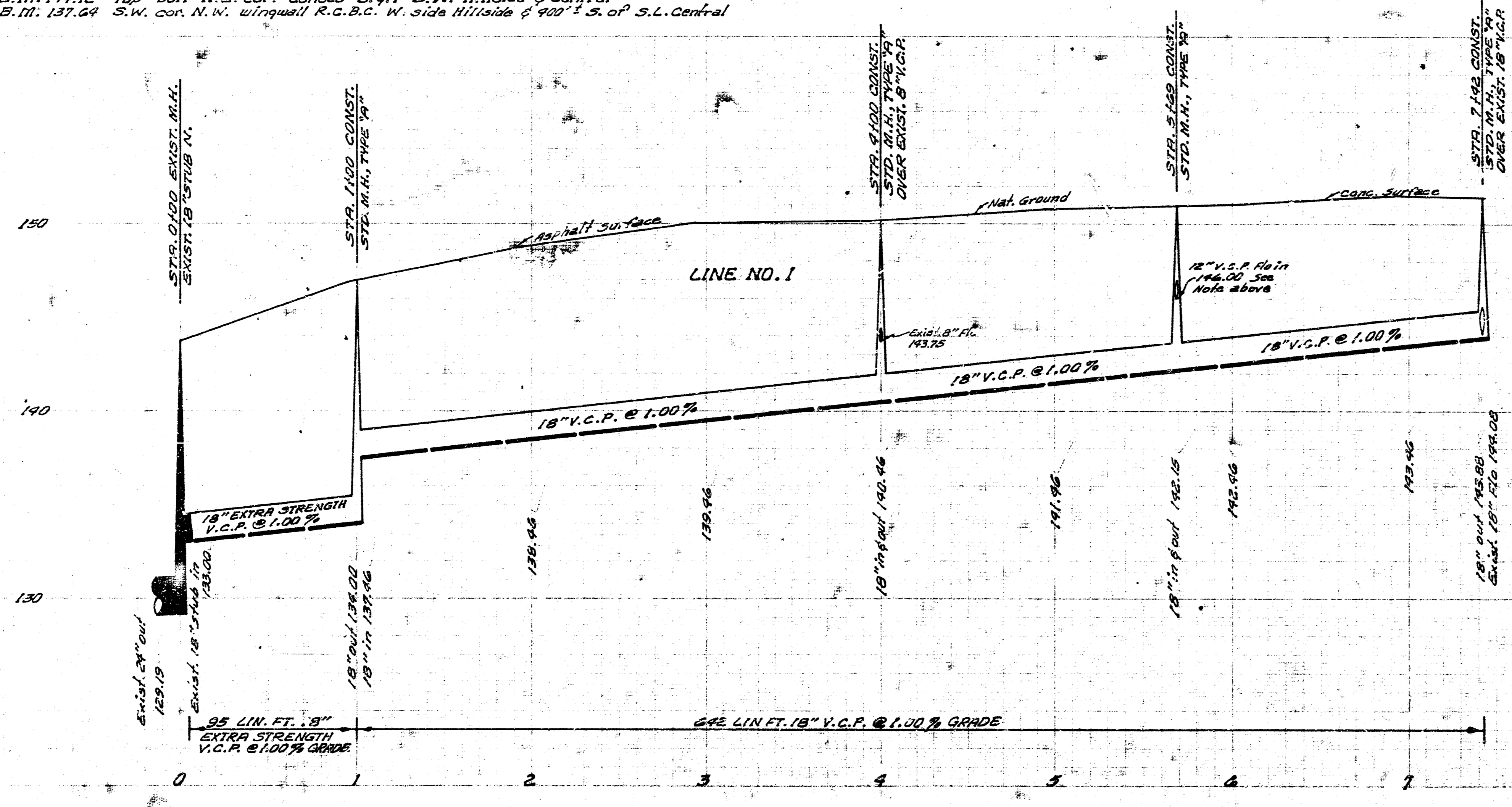

GENERAL NOTES:

- #1 Contractor will be required to maintain one lane West bound traffic on Central during working hours, Line #2.
- #2 Contractor shall notify all utility Co.'s for location of their respective lines prior to construction.
- #3 Contractor shall provide pedestrian access to main entrance to Wesley Hosp. at all times.
- #4 Contractor will be required to keep one entrance to Wesley Hosp. parking lot or Emergency Entrance open during construction, Line #1.
- #5 Contractor will be required to keep one entrance to Wesley Hosp. parking lot open during construction, Line #2.
- #6 All saw joint to be included in bid price of removal.
- #7 Remove & replace wheel stops in parking lot to be incidental to the project.
- #8 Asphalt parking & drives to be repaired with 4" of crushed rock & 4" of asphaltic conc.
- #9 Holyoke St. to be repaired with 1" Asphaltic conc.
- #10 Remove & replace drainage gr. & grate @ Sta. 5123 Line #1 to be incidental to the proj.

LAT. 1, WESLEY INTERCEPTOR S.
 CITY OF WICHITA, KANSAS
 B.E. SMITH, CITY ENGINEER
 PROJECT NO. C28-89
 DATE: Oct. 1968 SHEET 1 OF 2

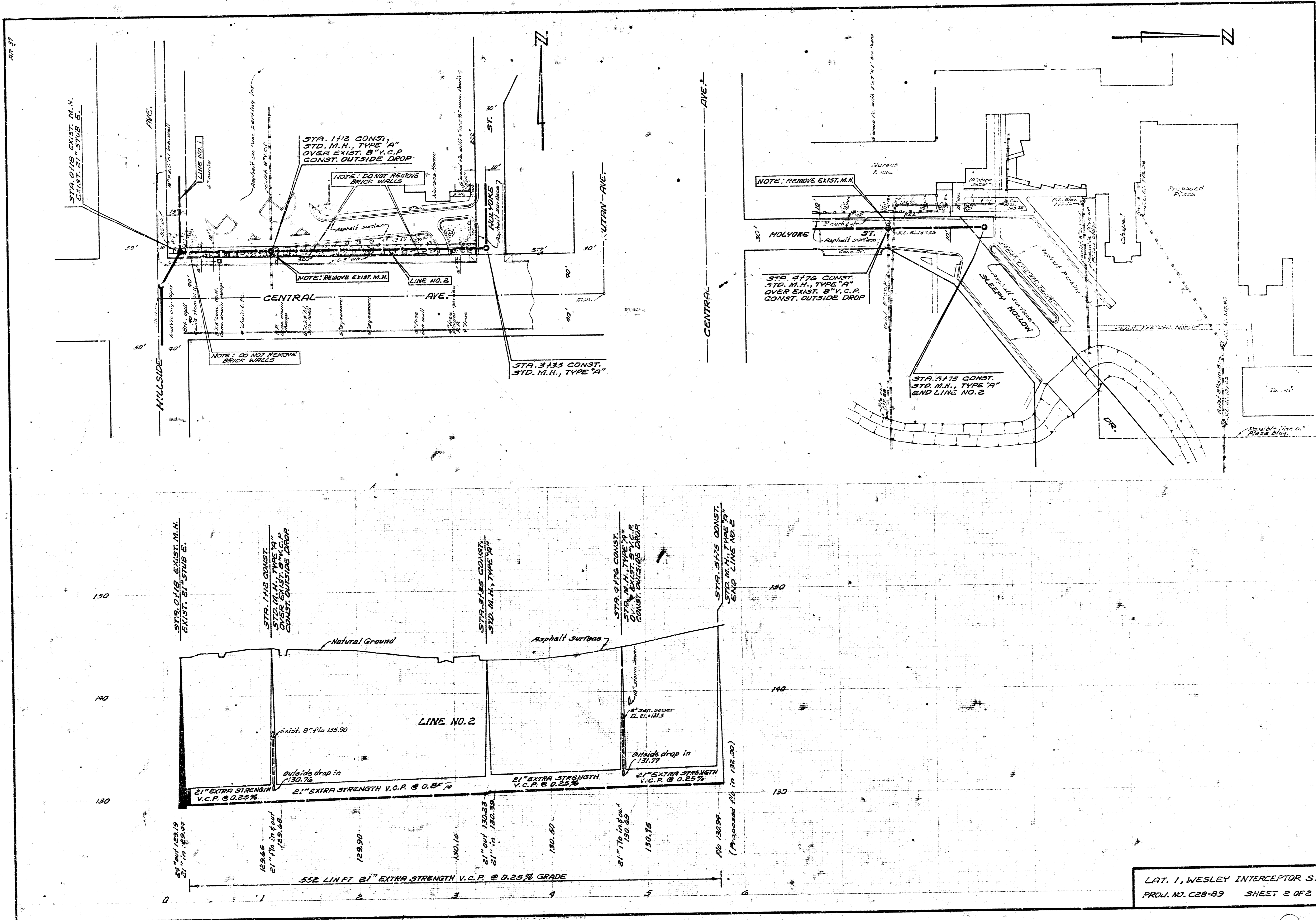

LAT. 1, WESLEY INTERCEPTOR S.
 PROJ. NO. C28-89 SHEET 2 OF 2