

TRAILER

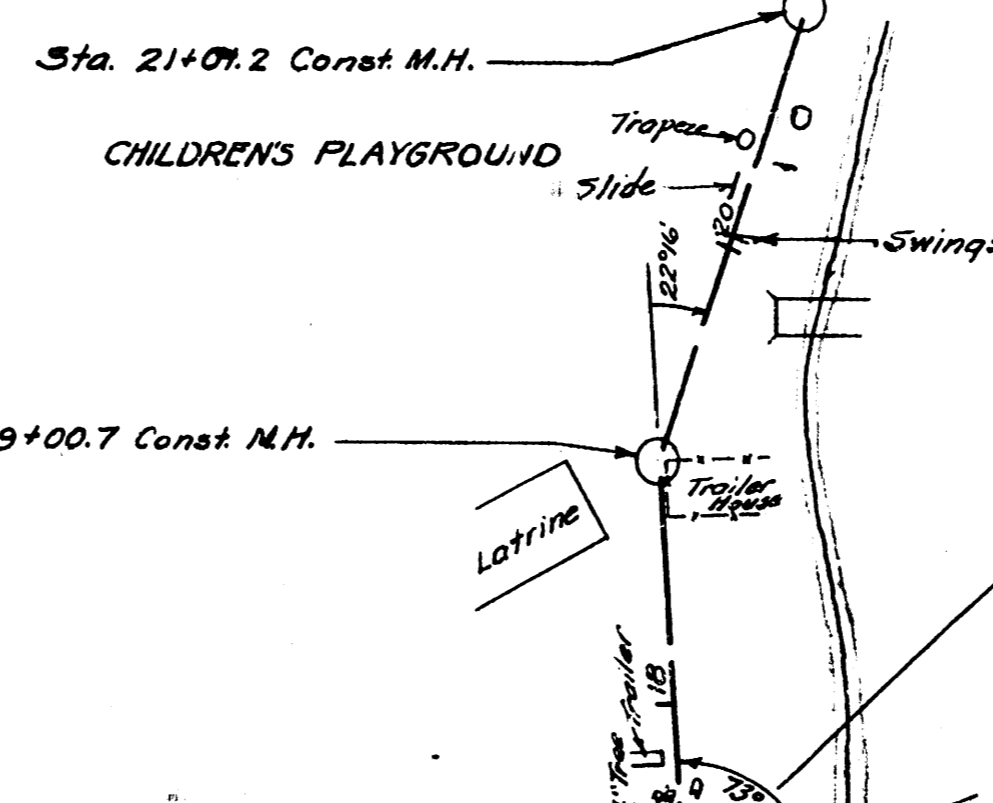

HOUSE'S

NOTE: Sand backfill trench
Sta. 0+23 to Sta. 3+45

Note: Lateral 10 is to be constructed
prior to lateral 11.

Construct concrete encasement
as designated by Field Engineer.
See detail below.

NOTE Construct concrete cradle
in locations designated by Field Engineer.
See detail below.

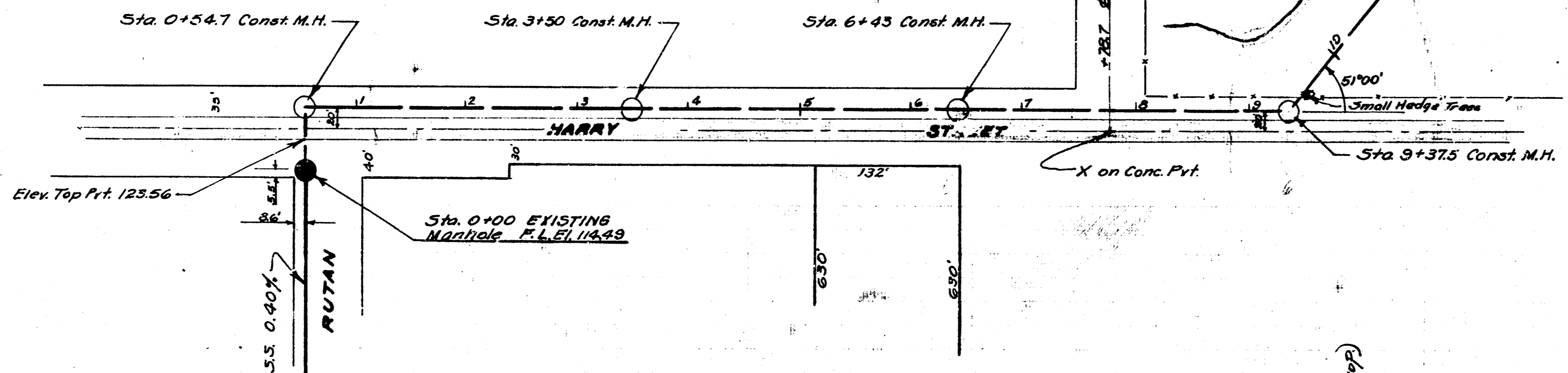

E.M. S.E. Cor. N. Hub Guard Conc. Box
Culv't. 500' E. Hillside & Harry Ct. 123.89

E.M. S. Rim Existing M.H.
Sta. 0+00 Etl. 120.14

Scale: 1" = 80' Horiz.
1" = 8' Vert.

Date 6-2-51
Drawn by J.L.A.
Checked by M.E. Bann Mc.
M.E.

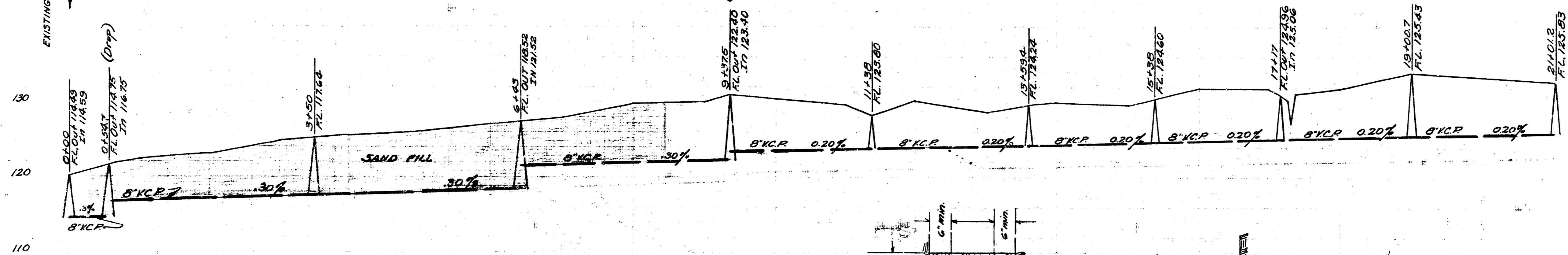

STA. 0+00 TO STA. 9+37.5
LAT. 10 SUB-MAIN "W" S.S.#12
CITY OF WICHITA, KANSAS
L.K. WHITE CITY ENGINEER
Proj. No. C21-30

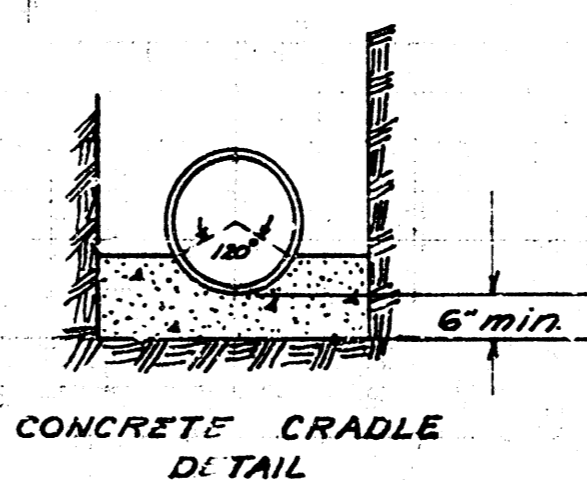
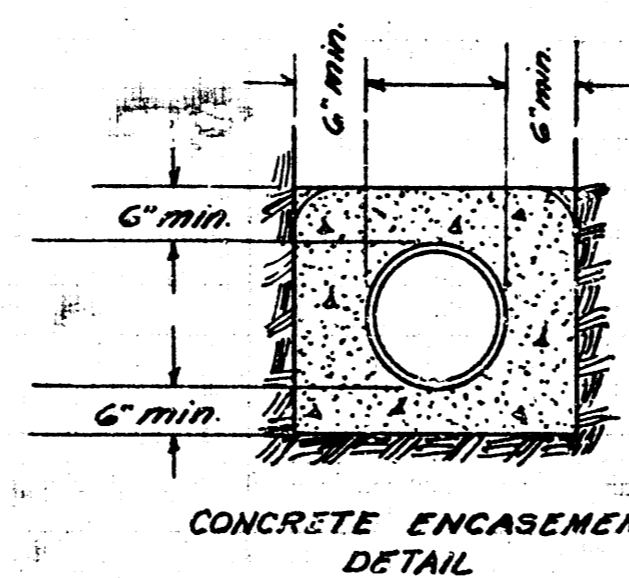

STA. 9+37.5 TO STA. 21+01.2
LAT. 11 SUB-MAIN "W" S.S.#12
CITY OF WICHITA, KANSAS
L.K. WHITE CITY ENGINEER
Proj. No. C21-43

