

STORM WATER DRAIN NO. 337

TO SERVE

WEBB BUSINESS PARK

OCA NO. 751469

CITY OF WICHITA PROJECT NO. 468-84431

CITY OF WICHITA, KANSAS

JAMES L. ARMOUR, P.E. - CITY ENGINEER

INDEX OF SHEETS

1. TITLE SHEET
2. KEY MAP AND GENERAL NOTES
3. PLAT
4. DEMOLITION PLAN—LOTS 2, 3, AND 4
5. DEMOLITION PLAN—WEBB ROAD
6. FOUR CORNER PLAN
7. SITE GRADING PLAN
8. POND GRADING PLAN
9. POND TYPICAL SECTIONS
10. POND OUTFALL
11. PLAN/PROFILE—CHANNEL NO. 1
12. PLAN/PROFILE—CHANNEL NO. 2
13. R.C. WEIR DETAILS
14. R.C. WEIR LAYOUT
15. ABUTMENT DETAILS
16. RIPRAP AND MISCELLANEOUS DRAINAGE DETAILS
17. MANHOLE ADJUSTMENT DETAILS
18. EROSION CONTROL PLAN
- 19-22. EROSION CONTROL DETAILS
- 23-29. CROSS SECTIONS

EARTHWORK

EXCAVATION	70,684 CU. YDS.
COMPACTED FILL	44,933 CU. YDS.
LOOSE FILL	25,567 CU. YDS.

EXCESS EXCAVATION MATERIAL FROM THE PROJECT SHALL BE STOCKPILED ON-SITE AT THE LOCATION SHOWN IN THE PLANS. STOCKPILES SHALL BE BLADED SMOOTH AND SLOPE TO DRAIN.

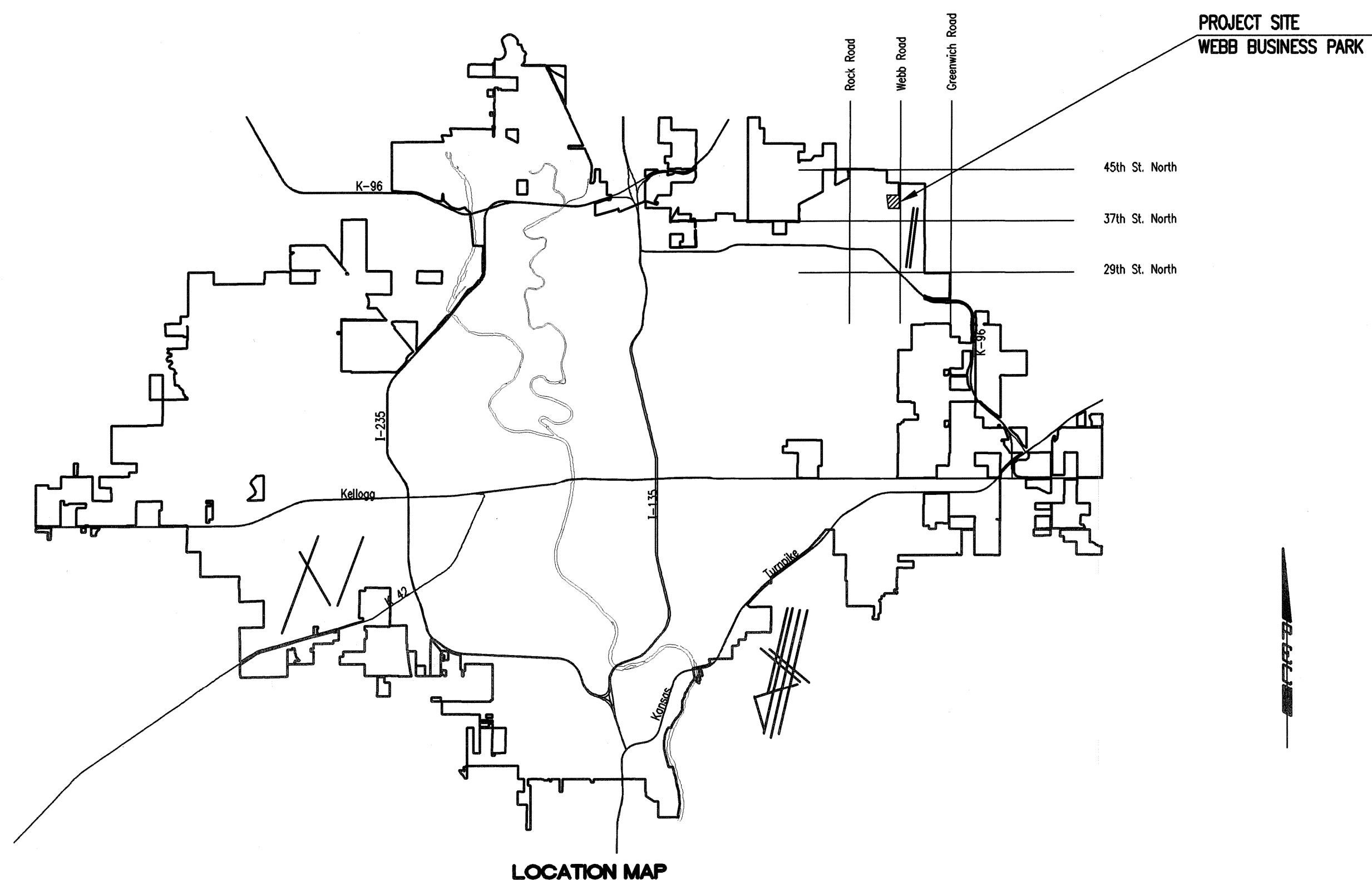

LOCATION MAP

CONSTRUCTION SCHEDULE/SEQUENCE

THE CONTRACTOR FOR EACH OF THE FOLLOWING WEBB BUSINESS PARK PROJECTS SHALL COORDINATE THEIR EFFORTS WITH OTHER CONTRACTORS PERFORMING WORK IN THIS AREA SUCH THAT ANY NECESSARY SIMULTANEOUS CONSTRUCTION CAN PROCEED CONCURRENTLY WITHOUT CAUSING UNDUE DELAYS SO THAT CONSTRUCTION CAN BE COMPLETED WITHIN THE TIME FRAMES AS NOTED.

SANITARY SEWER (468-84430)
THE CONTRACTOR SHALL SEQUENCE HIS WORK TO COMPLETE, INCLUDING TESTING AND ACCEPTANCE, BY APRIL 30, 2008.

WATER DISTRIBUTION SYSTEM (448-90333)
THE CONTRACTOR SHALL COMPLETE WEBB BUSINESS PARK WATERLINE CONSTRUCTION BY MAY 16, 2008. THE CONTRACTOR SHALL COORDINATE INSTALLATION OF WATERLINES WITH THE STORM WATER DRAIN AND PAVING CONTRACTOR SO THAT STORM SEWERS CROSSING BELOW PROPOSED WATERLINES WILL BE INSTALLED PRIOR TO WATERLINE CONSTRUCTION.

STREETS/DRAINAGE (472-84611)
THE CONTRACTOR SHALL COMPLETE WEBB BUSINESS PARK STREETS CONSTRUCTION BY JULY 18, 2008.

STORM WATER DRAINAGE (468-84431)
THE CONTRACTOR SHALL COMPLETE WEBB BUSINESS PARK MASS GRADING CONSTRUCTION BY JUNE 4, 2008.

MARCH 2008

PLANS PREPARED BY
PROFESSIONAL ENGINEERING CONSULTANTS, P.A.
 ENGINEERS
 WICHITA, KANSAS

