

$\Delta = 21'31.06''$ $L = 187.03'$ $R = 497.98'$ $T = 94.63'$

STATION	CL ARC	CHORD LENGTH		8' RT. DEFLECTION	TOTAL DEFLECTION
		8' LT.	8' RT.		
9+29.92 P.R.C.					
9+50.00	20.08'	19.07'	20.08'	21.09'	1'09'19"
9+75.00	25.00'	23.74'	25.00'	26.25'	1'26'18"
10+00.00	25.00'	23.74'	25.00'	26.25'	1'26'18"
10+25.00	25.00'	23.74'	25.00'	26.25'	1'26'18"
10+50.00	25.00'	23.74'	25.00'	26.25'	1'26'18"
10+75.00	25.00'	23.74'	25.00'	26.25'	1'26'18"
11+00.00	25.00'	23.74'	25.00'	26.25'	1'26'18"
11+16.95 P.T.	16.95'	16.09'	16.94'	17.90'	0'58'29"
DEFLECTION/FOOT = .057528193 DEGREES					3.451691605 MINUTES

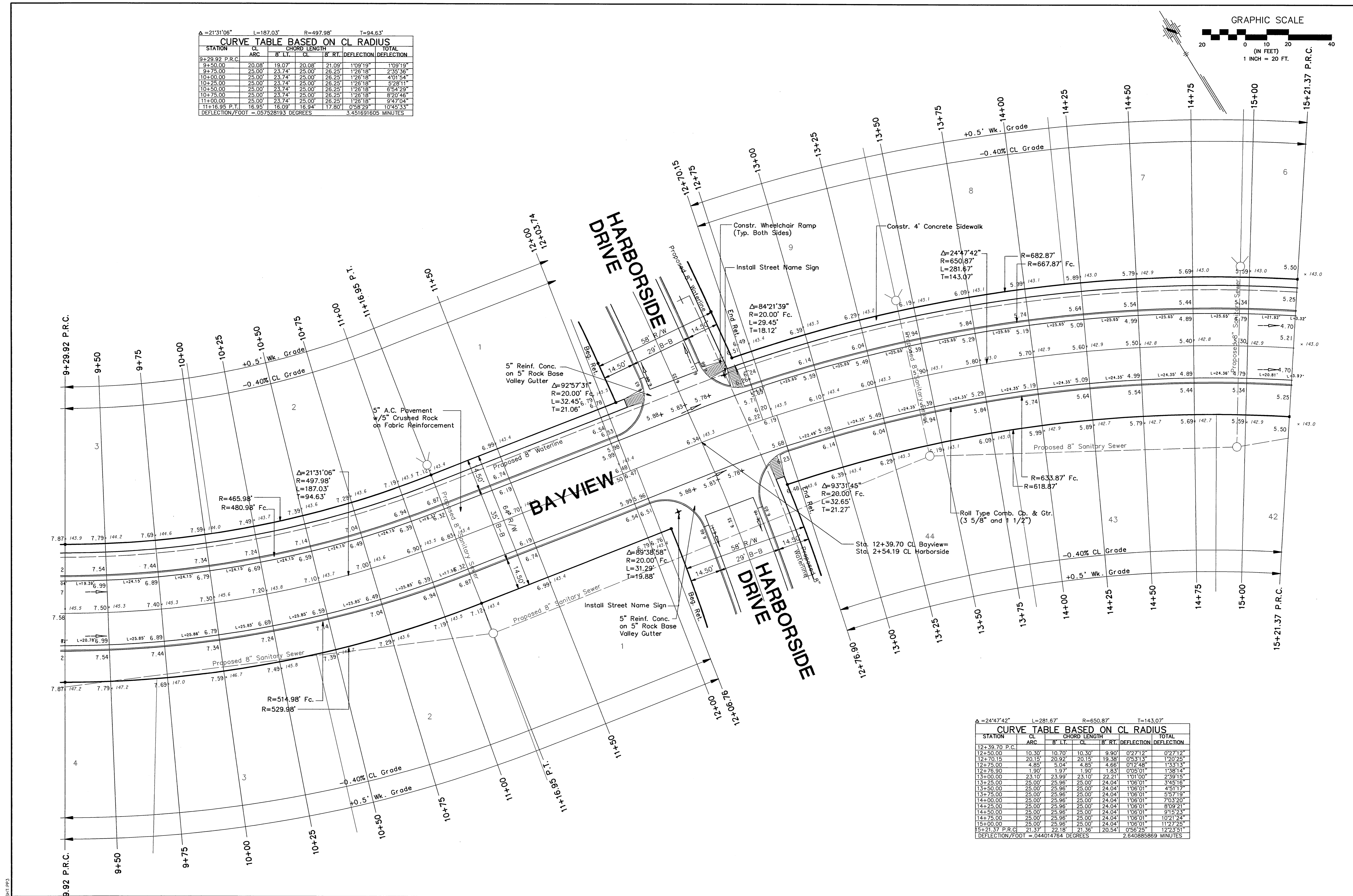
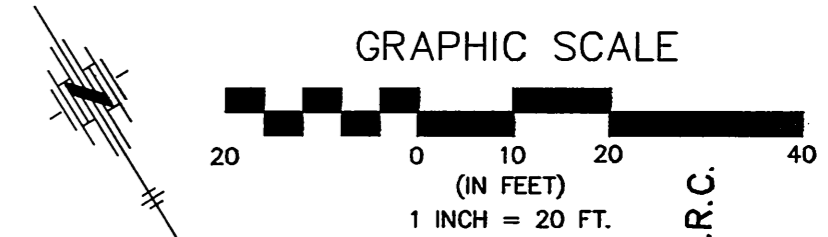

$\Delta = 24'47.42''$ $L = 281.67'$ $R = 650.87'$ $T = 143.07'$

STATION	CL ARC	CHORD LENGTH		8' RT. DEFLECTION	TOTAL DEFLECTION
		8' LT.	8' RT.		
12+39.70 P.C.					
12+50.00	10.30'	10.70'	10.30'	9.90'	0'27'12"
12+70.15	20.15'	20.92'	20.15'	19.38'	0'53'13"
12+75.00	4.85'	5.04'	4.85'	4.66'	0'12'48"
12+76.90	1.90'	1.97'	1.90'	1.83'	0'05'01"
13+00.00	23.10'	23.99'	23.10'	22.21'	1'01'00"
13+25.00	25.00'	25.96'	25.00'	24.04'	1'06'01"
13+50.00	25.00'	25.96'	25.00'	24.04'	1'06'01"
13+75.00	25.00'	25.96'	25.00'	24.04'	1'06'01"
14+00.00	25.00'	25.96'	25.00'	24.04'	1'06'01"
14+25.00	25.00'	25.96'	25.00'	24.04'	1'06'01"
14+50.00	25.00'	25.96'	25.00'	24.04'	1'06'01"
14+75.00	25.00'	25.96'	25.00'	24.04'	1'06'01"
15+00.00	25.00'	25.96'	25.00'	24.04'	1'06'01"
15+21.37 P.R.C.	21.37'	22.18'	21.36'	20.54'	0'56'25"
DEFLECTION/FOOT = .044014764 DEGREES					2.640885869 MINUTES

F:\APPS\DCAP\6656\6656.dwg Wed Jul 01 07:23:36 1998 Steve Schmidt

FINAL

Designed By: G. Miles
 Drawn By: S. Schmidt
 P.O. Box No.: 1665B
 Date: June 1998

POE & ASSOCIATES OF KANSAS, INC.
 CONSULTING ENGINEERS
 590 E. Central, Suite 200 • Wichita, KS 67208 • 316/685-4114 • Fax 316/685-4444

STREET IMPROVEMENTS
 MORRINGS NORTH ADDITION
CITY OF WICHITA, KANSAS
 MICHAEL E. LINDEBAK, P.E. - CITY ENGINEER
 Project No. 468-52879 Index Code 764654

6 of 48