

F:\MPS\UCA\1565B\base.dwg Wed Jul 01 07:25:57 1998 Steve Schmitz

SHT:PB8

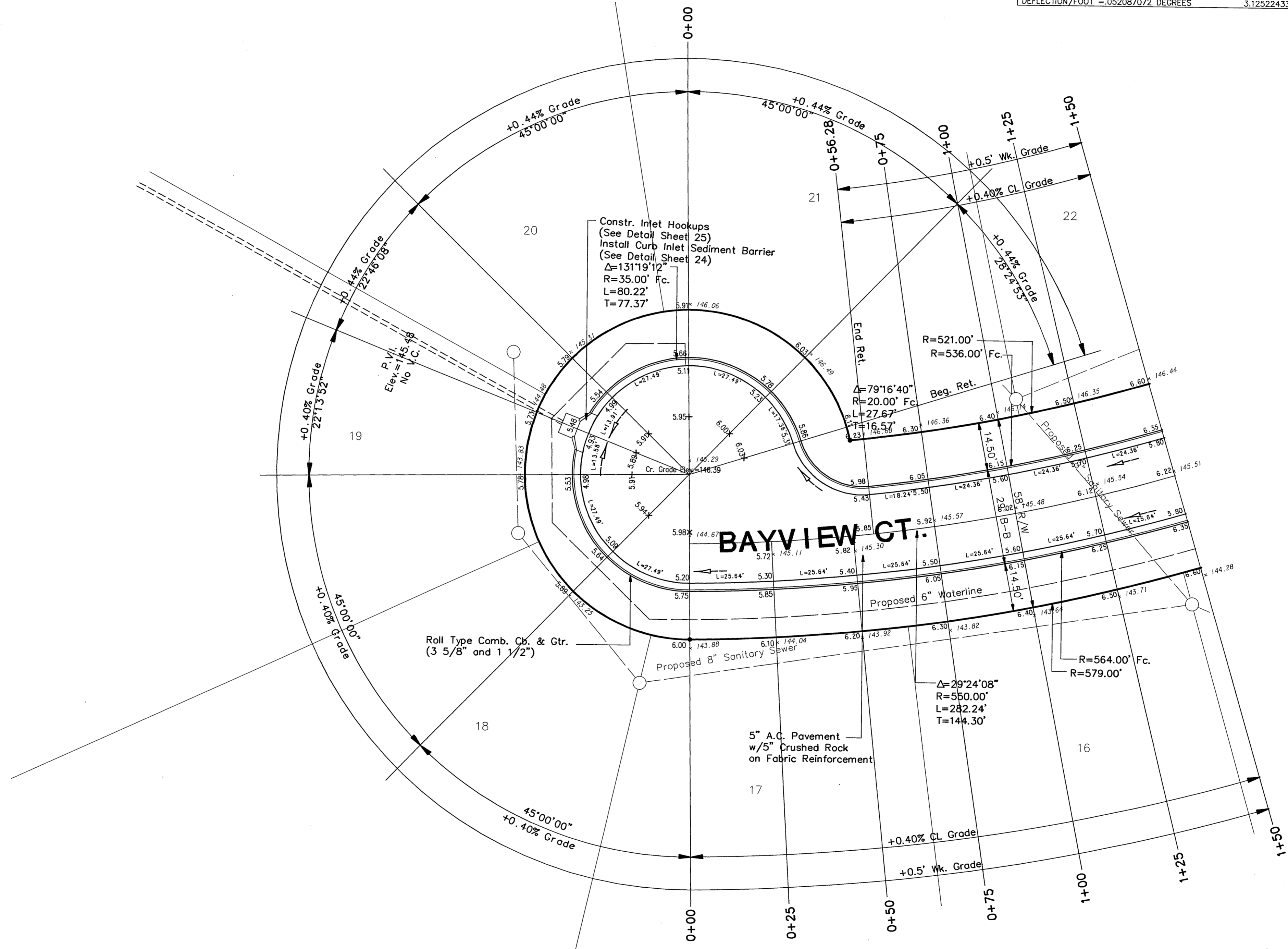

$\Delta = 29'24.08"$ $L = 282.24'$ $R = 550.00'$ $T = 144.30'$

CURVE TABLE BASED ON CL RADIUS

STATION	CL		CHORD LENGTH		DEFLECTION		TOTAL DEFLECTION
	ARC	8' LT.	8' RT.	8' RT.	DEFLECTION	DEFLECTION	
0+00.00 P.C.							
0+25.00	25.00'	24.00'	25.00'	26.00'	1'18"08"	26.00'	1'18"08"
0+50.00	25.00'	24.00'	25.00'	26.00'	1'18"08"	26.00'	2'36'16"
0+56.28	6.28'	6.03'	6.28'	6.53'	0'19"38"	19.47'	2'55'53"
0+75.00	18.72'	18.72'	18.72'	19.47'	0'38"30"	38.30'	3'54'24"
1+00.00	25.00'	24.00'	25.00'	26.00'	1'18"08"	26.00'	5'12'31"
1+25.00	25.00'	24.00'	25.00'	26.00'	1'18"08"	26.00'	6'30'39"
1+50.00	25.00'	24.00'	25.00'	26.00'	1'18"08"	26.00'	7'48'47"
1+75.00	25.00'	24.00'	25.00'	26.00'	1'18"08"	26.00'	9'06'55"
2+00.00	25.00'	24.00'	25.00'	26.00'	1'18"08"	26.00'	10'25'03"
2+25.00	25.00'	24.00'	25.00'	26.00'	1'18"08"	26.00'	11'43'11"
2+50.00	25.00'	24.00'	25.00'	26.00'	1'18"08"	26.00'	13'01'18"
2+75.00	25.00'	24.00'	25.00'	26.00'	1'18"08"	26.00'	14'19'26"
2+82.24 P.T.	7.24'	6.95'	7.24'	7.53'	0'22"38"	22.38'	14'42'04"
DEFLECTION/FOOT = 0.52087072 DEGREES							3.125224337 MINUTES

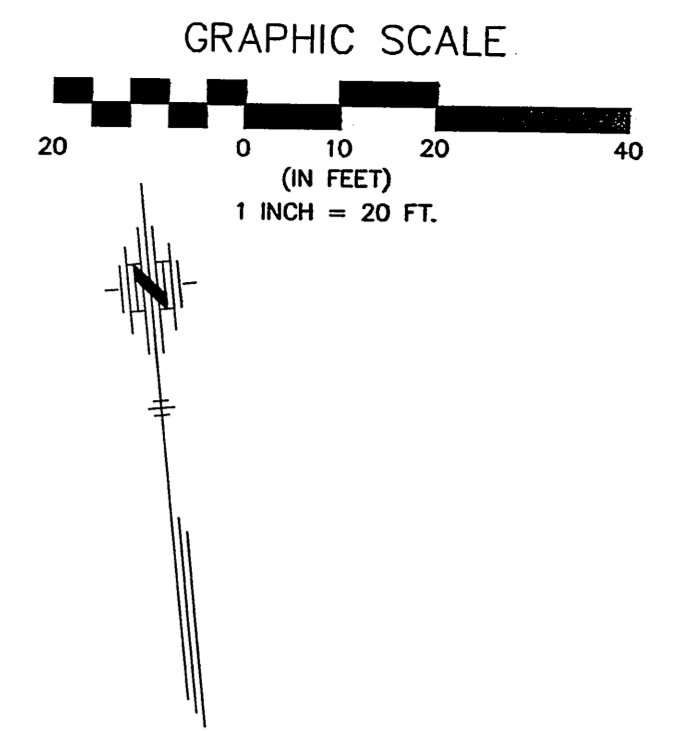

<p>FINAL</p> <p>Designed By: G. Miles Drawn By: S. Schmitz Pce. Job No.: 1665B Date: June 1998</p>	<p>POE & ASSOCIATES OF KANSAS, INC. CONSULTING ENGINEERS 3940 E. Central, Suite 200 Wichita, KS 67208 316/685-1114 Fax 316/685-4444</p>	<p>CITY OF WICHITA, KANSAS MOORINGS NORTH ADDITION STREET IMPROVEMENTS MICHAEL E. LINDEBAK, P.E. - CITY ENGINEER Project No. 468-82879 Index Code 764654</p>	<table border="1"> <tr> <th>No.</th> <th>Date</th> <th>By</th> <th>Approved</th> <th>Revision</th> </tr> <tr> <td> </td> <td> </td> <td> </td> <td> </td> <td> </td> </tr> <tr> <td> </td> <td> </td> <td> </td> <td> </td> <td> </td> </tr> <tr> <td> </td> <td> </td> <td> </td> <td> </td> <td> </td> </tr> </table>	No.	Date	By	Approved	Revision															
No.	Date	By	Approved	Revision																			

NOTE:
 All top of curb grades are to top of combined curb and gutter. 0.25' must be subtracted from top of curb elevations for top of roll curb.