

$\Delta = 49^{\circ}00'10''$ $L = 266.63'$ $R = 311.75'$ $T = 142.08'$

STATION	CL ARC	CHORD LENGTH		DEFLECTION	TOTAL DEFLECTION
		8' RT.	8' LT.		
2+60.80 P.C.	14.20'	13.20'	14.20'	1'18"18"	1'18"18"
2+75.00	25.00'	23.23'	24.99'	26.76'	2'17"50"
3+00.00	25.00'	23.23'	24.99'	26.76'	3'36"08"
3+25.00	25.00'	23.23'	24.99'	26.76'	4'53"58"
3+50.00	25.00'	23.23'	24.99'	26.76'	6'11"49"
3+75.00	25.00'	23.23'	24.99'	26.76'	7'29"39"
4+00.00	25.00'	23.23'	24.99'	26.76'	8'47"30"
4+25.00	25.00'	23.23'	24.99'	26.76'	10'05"20"
4+50.00	25.00'	23.23'	24.99'	26.76'	11'23"11"
4+75.00	25.00'	23.23'	24.99'	26.76'	12'41"01"
5+00.00	25.00'	23.23'	24.99'	26.76'	13'58"52"
5+07.59	7.59'	7.05'	7.59'	8.13'	22'40"42"
5+10.86	3.37'	3.13'	3.37'	3.61'	22'59"17"
5+25.00	14.04'	13.05'	14.04'	15.03'	24'18"42"
5+27.43 P.T.	2.43'	2.26'	2.43'	2.60'	24'30"05"

DEFLECTION/FOOT = .091893792 DEGREES 5.513627539 MINUTES

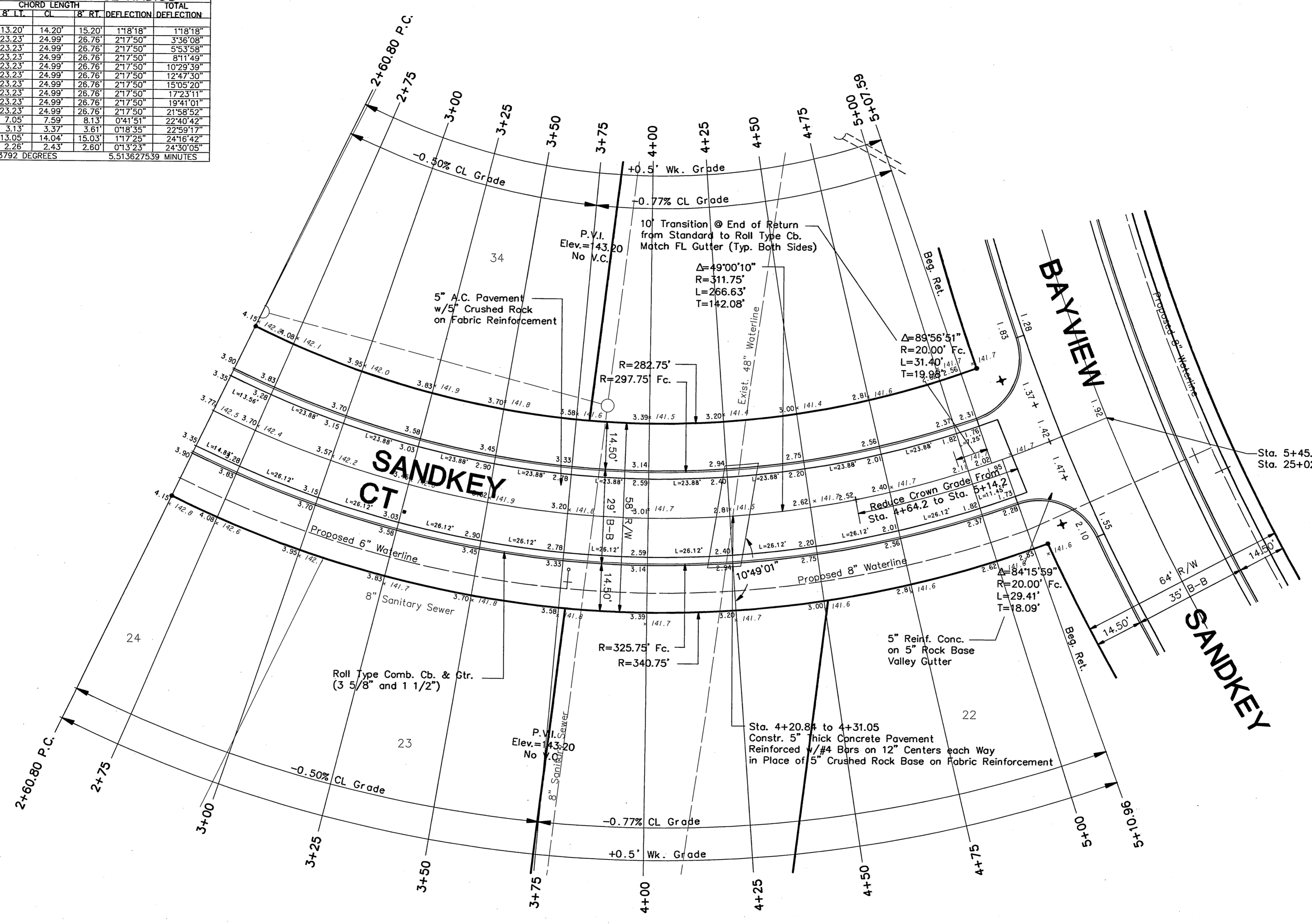

FINAL

Designed By: G. Miles
 Drawn By: S. Schmidt
 P.O. Job No.: 1665B
 Date: June 1998

POE & ASSOCIATES OF KANSAS, INC.
 CONSULTING ENGINEERS
 5940 E. Central, Suite 200 Wichita, KS 67208 316/852-4114 Fax 316/852-4444

CITY OF WICHITA, KANSAS
 MICHAEL E. LINDEBAK, P.E. - CITY ENGINEER
 Project No. 468-82879 Index Code 764654

STREET IMPROVEMENTS
 MOORINGS NORTH ADDITION
 CITY OF WICHITA, KANSAS

NOTE:
 All top of curb grades are to top of combined curb and gutter. 0.25' must be subtracted from top of curb elevations for top of roll curb.