

CURVE TABLE BASED ON CL RADIUS

STATION	CL ARC	CHORD LENGTH		H. RT.	DEFLECTION	TOTAL DEFLECTION
		R. L.T.	CL			
0+96.92 P.C.						
1+00.00	3.08'	3.11'	3.08'	3.05'	0°02'39"	0°02'39"
1+25.00	25.00'	25.27'	25.00'	24.72'	0°21'29"	0°24'08"
1+50.00	25.00'	25.27'	25.00'	24.72'	0°21'29"	0°45'37"
1+75.00	25.00'	25.27'	25.00'	24.72'	0°21'29"	1°07'06"
2+00.00	25.00'	25.27'	25.00'	24.72'	0°21'29"	1°28'35"
2+25.00	25.00'	25.27'	25.00'	24.72'	0°21'29"	1°50'05"
2+47.37 P.C.C.	22.36'	22.61'	22.36'	22.12'	0°19'13"	2°09'18"

DEFLECTION/FOOT = .014323945 DEGREES .859436693 MINUTES

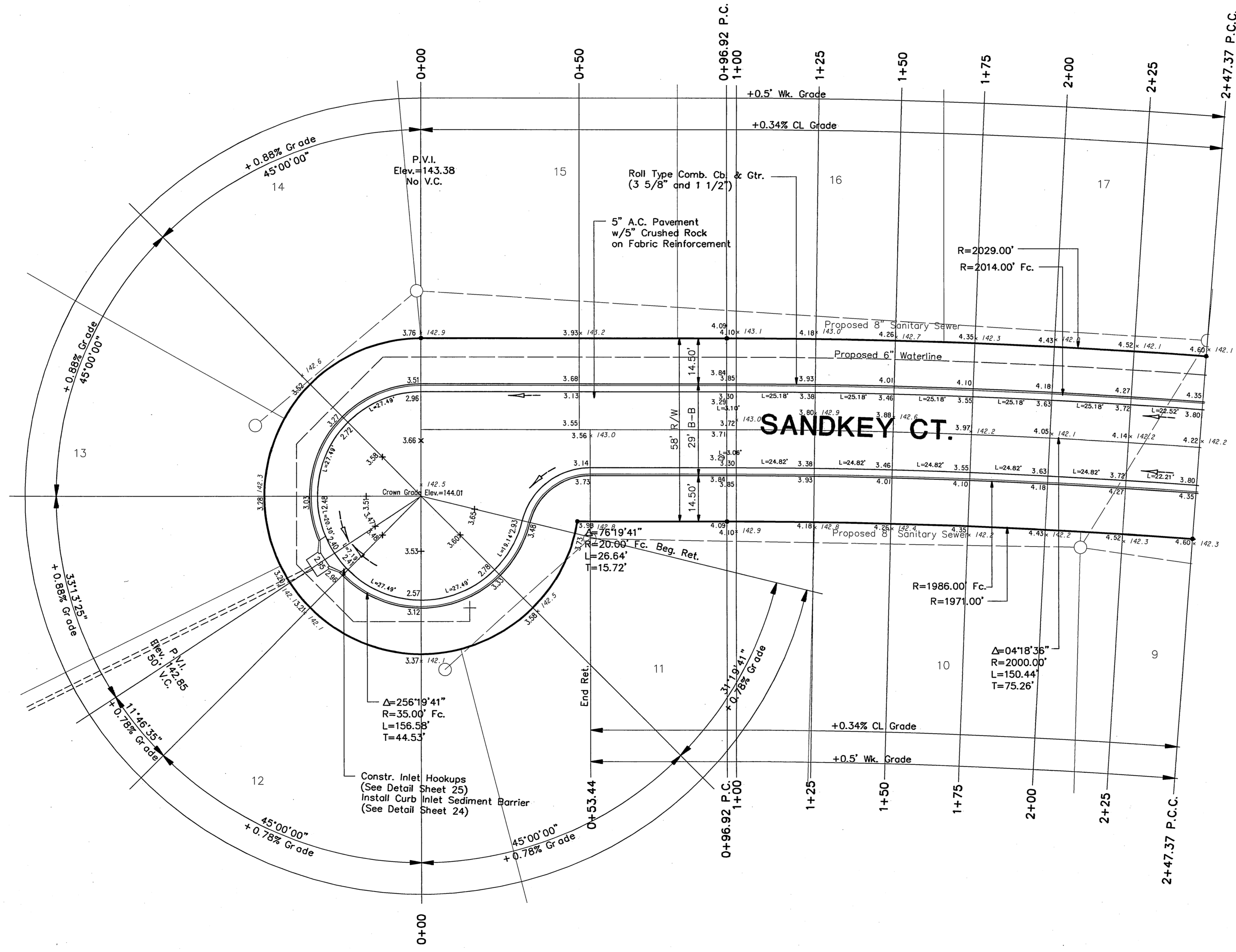
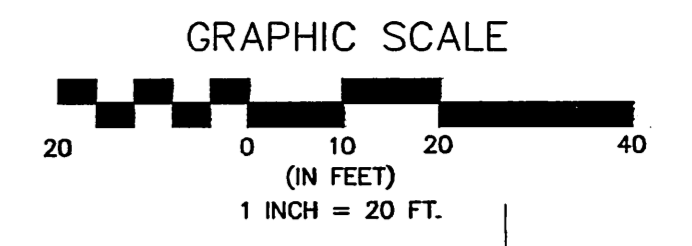

FINAL

Designed By: G. Miles
 Drawn By: S. Schmidt
 Plo Job No.: 1665B
 Date: June 1998

POE & ASSOCIATES OF KANSAS, INC.
 CONSULTING ENGINEERS
 590 E. Central, Suite 200 Wichita, KS 67208 Tel: 316/655-4111 Fax: 316/655-4444

STREET IMPROVEMENTS
 MOORINGS NORTH ADDITION
 CITY OF WICHITA, KANSAS
 MICHAEL E. LINDEBAK, P.E. - CITY ENGINEER
 Project No. 468-82879 Index Code 764654

No.	Date	By	Approved	Revision

Sheet 16 of 48

NOTE:
 All top of curb grades are to top of combined curb and gutter. 0.25' must be subtracted from top of curb elevations for top of roll curb.