

70 65 60 55 50 45 40 35 30 25 20 15 10 5 5 10 15 20 25 30 35 40 45 50 55 60 65 70 75 80

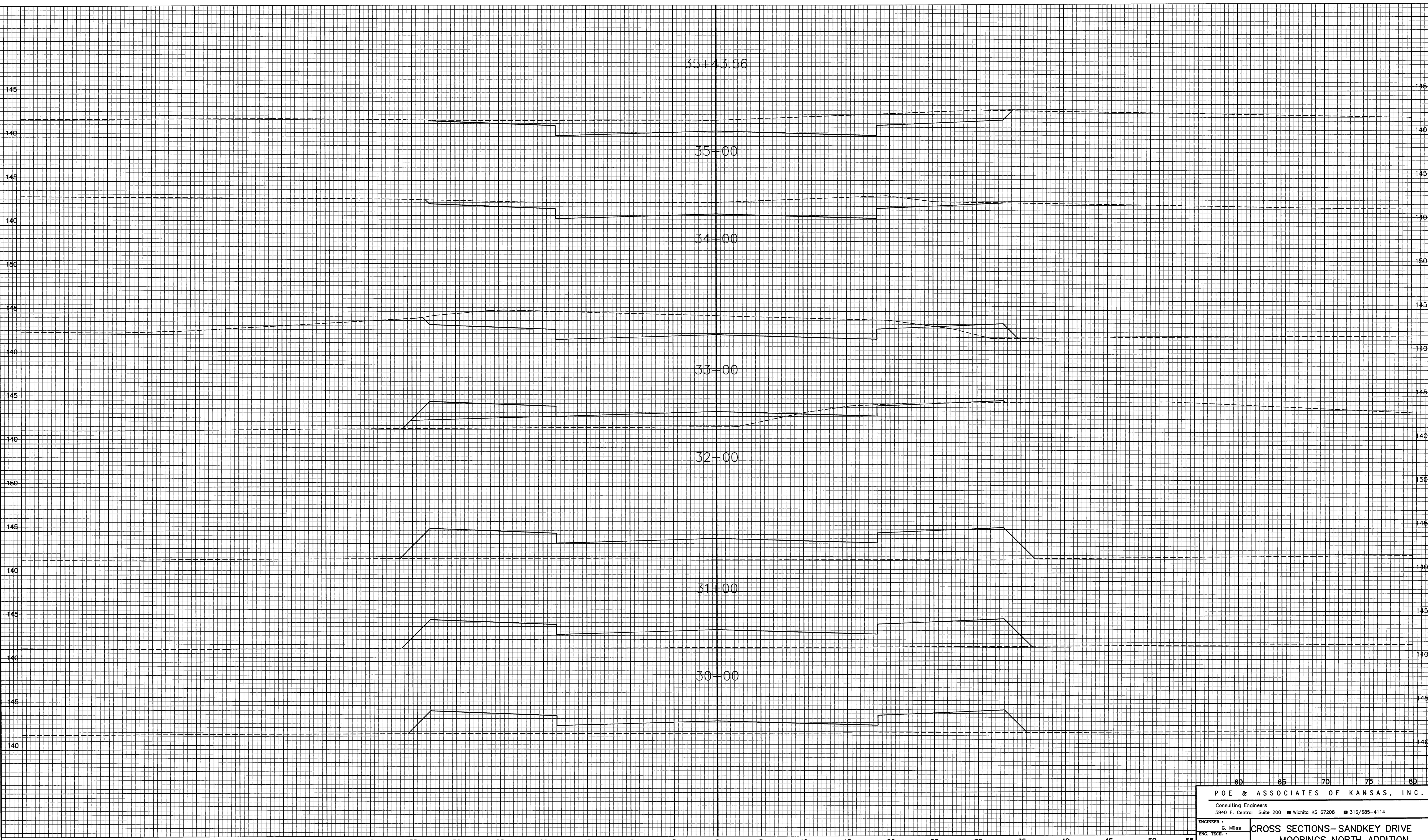

POE & ASSOCIATES OF KANSAS, INC.	
Consulting Engineers 5940 E. Central Suite 200 ■ Wichita KS 67208 ■ 316/685-4114	
ENGINEER :	G. Miles
ENG. TECH. :	
CAD TECH. :	S. Schmidt
DATE :	June 1998
SHEET :	32 of 48
CROSS SECTIONS—SANDKEY DRIVE MOORINGS NORTH ADDITION CITY OF WICHITA, KANSAS	
PROJECT NO. 468-82879	
INDEX CODE 764654	

F:\APPS\DCAP\5658\Case.dwg Tue Jun 30 14:47:48 1998 Steve Schmidt