

70 65 60 55 50 45 40 35 30 25 20 15 10 5 0 5 10 15 20 25 30 35 40 45 50 55 60 65 70 75 80

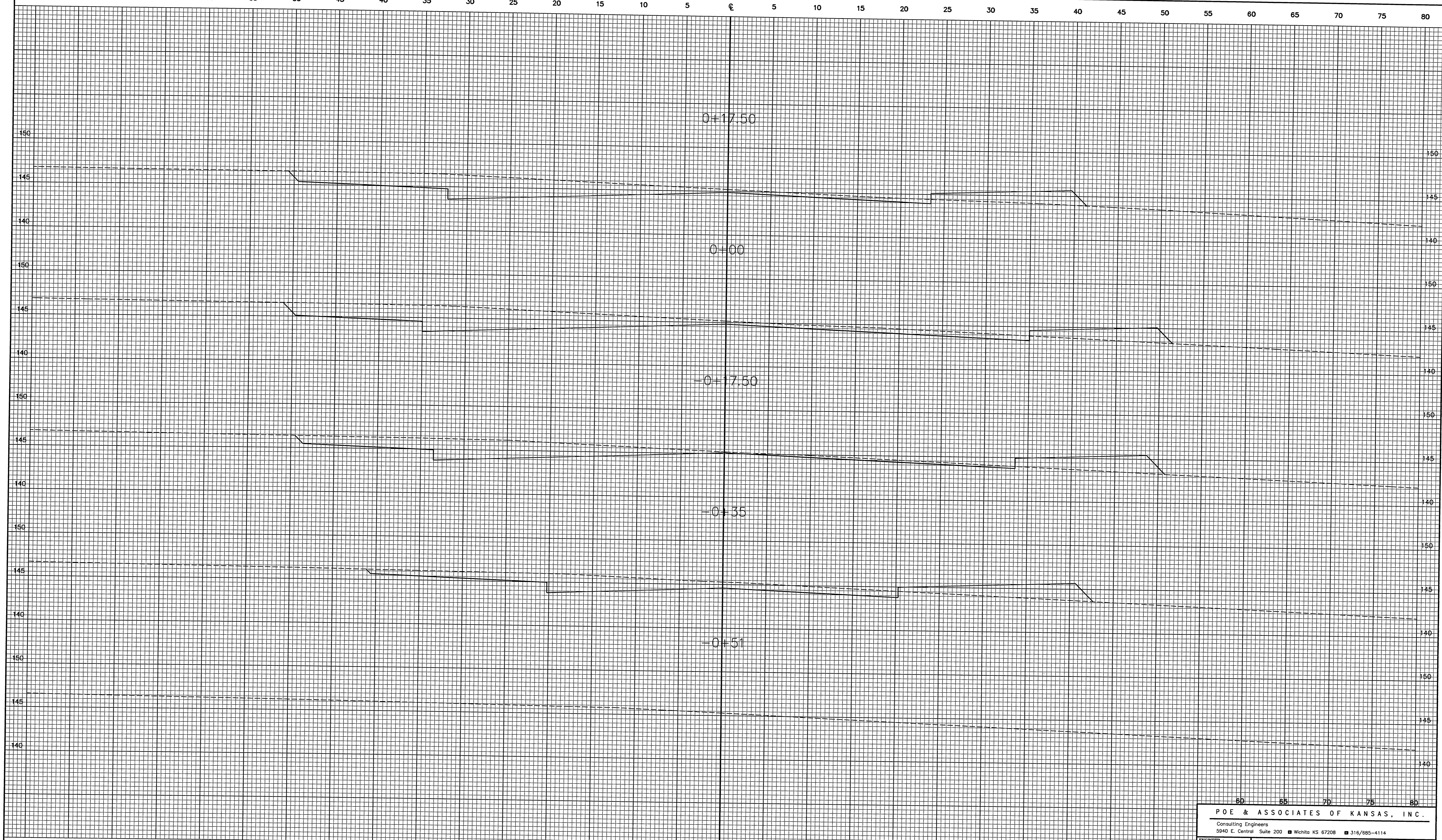

POE & ASSOCIATES OF KANSAS, INC. Consulting Engineers 5940 E. Central Suite 200 ■ Wichita KS 67208 ■ 316/685-4114	
ENGINEER : G. Miles	CROSS SECTIONS—BAYVIEW COURT MOORINGS NORTH ADDITION CITY OF WICHITA, KANSAS PROJECT NO. 468-82879 INDEX CODE 764654
ENG. TECH. : S. Schmidt	
CAD TECH. : S. Schmidt	
DATE : June 1998	
SHEET 33 of 48	