

F:\MPS\DATA\16688\base.dwg Tue Jun 30 14:47:54 1998 Steve Schmidt

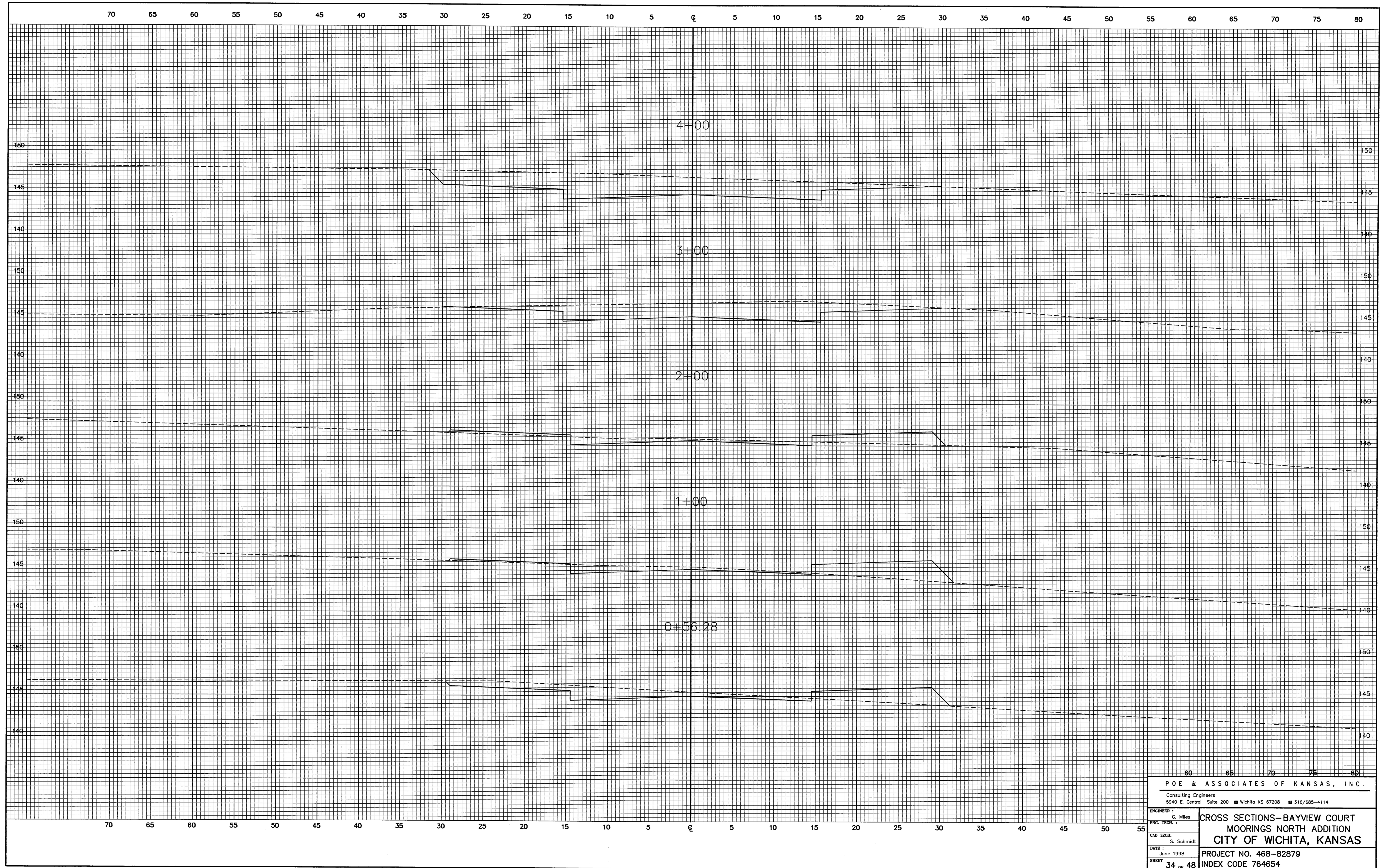

POE & ASSOCIATES OF KANSAS, INC.	
Consulting Engineers 5940 E. Central Suite 200 ■ Wichita KS 67208 ■ 316/685-4114	
ENGINEER:	G. Miles
ENG. TECH.:	S. Schmidt
CAD TECH.:	S. Schmidt
DATE:	June 1998
SHEET	34 of 48
CROSS SECTIONS—BAYVIEW COURT MOORINGS NORTH ADDITION CITY OF WICHITA, KANSAS	
PROJECT NO. 468-82879 INDEX CODE 764654	