

STATE	PROJECT NO.	YEAR	SHEET NO.	SHEETS
KANSAS	87 N-0190-01	2005	52	96

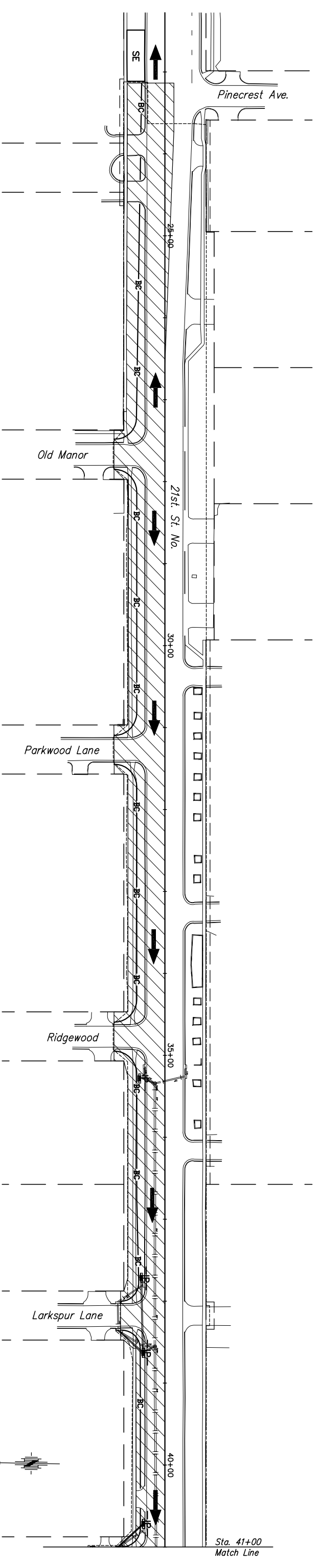

Sta. 41+00
Match Line

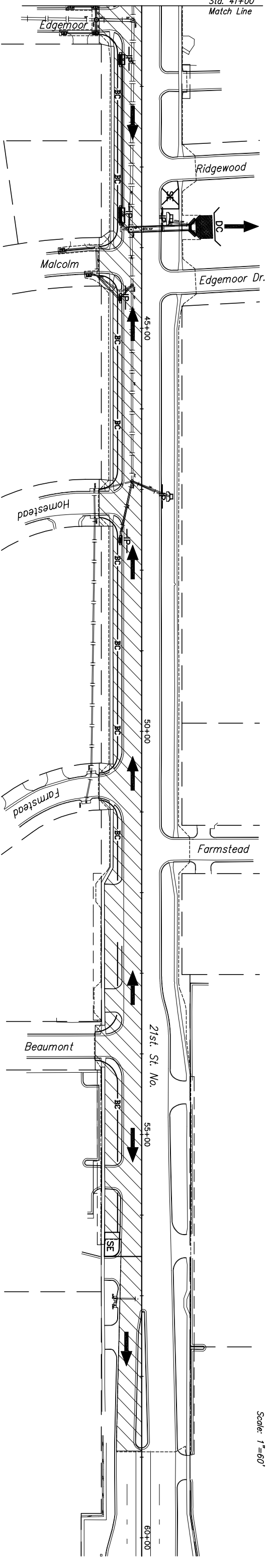

Scale: 1"=60'

LEGEND

- | | | | |
|--|-------------------------------|--|---------------------------------|
| | STABILIZED ENTRANCE | | SLOPE BARRIER |
| | STABILIZED ENTRANCE REMOVED | | SLOPE BARRIER REMOVED |
| | AREA INLET PROTECTION | | BACK OF CURB PROTECTION |
| | AREA INLET PROTECTION REMOVED | | BACK OF CURB PROTECTION REMOVED |
| | CURB INLET PROTECTION | | DITCH CHECK PROTECTION |
| | CURB INLET PROTECTION REMOVED | | DITCH CHECK PROTECTION REMOVED |
| | DIRECTION OF DRAINAGE | | CONSTRUCTION LIMITS |
| | WORK ZONE | | RIGHT OF WAY LINE |

NOTES:

THIS PROJECT WILL DISTURB 7.29 ACRES.
REFER TO CITY OF WICHITA STANDARDS FOR BMP INSTALLATION, INSPECTION AND MAINTENANCE DETAILS AND SPECIFICATIONS.
COST FOR EACH EROSION AND SEDIMENT CONTROL ITEM SHALL INCLUDE MAINTENANCE, INSPECTION AND EVENTUAL REMOVAL. BESIDES KEEPING EACH DEVICE IN WORKING ORDER, MAINTENANCE SHALL INCLUDE, AT A MINIMUM, SEDIMENT REMOVAL BEFORE 50% OF THE DEVICE'S CAPACITY IS REACHED.
CONTRACTOR SHALL ADJUST EROSION AND SEDIMENT CONTROL PLANS TO CONFORM TO ACTUAL CONSTRUCTION OPERATIONS. ALL CHANGES TO PLAN SHALL BE APPROVED BY THE CITY.

KANSAS DEPARTMENT OF TRANSPORTATION			
21ST STREET NORTH IMPROVEMENTS			
EROSION & SEDIMENT CONTROL PLAN			
PHASE 2			
PROJECT NO. 87 N-0190-01		SEDCWICK CO.	
M K E C ENGINEERING CONSULTANTS, INC.			
WICHITA, KANSAS			
DESIGNED BY: LAC	CHECKED BY: JFA		
DRAWN BY: WJU	DATE: 2/21/05	SHEET 52 OF 96	