

STATE	PROJECT NO.	YEAR	SHEET NO.	SHEETS
KANSAS	87 N-0190-01	2005	53	96

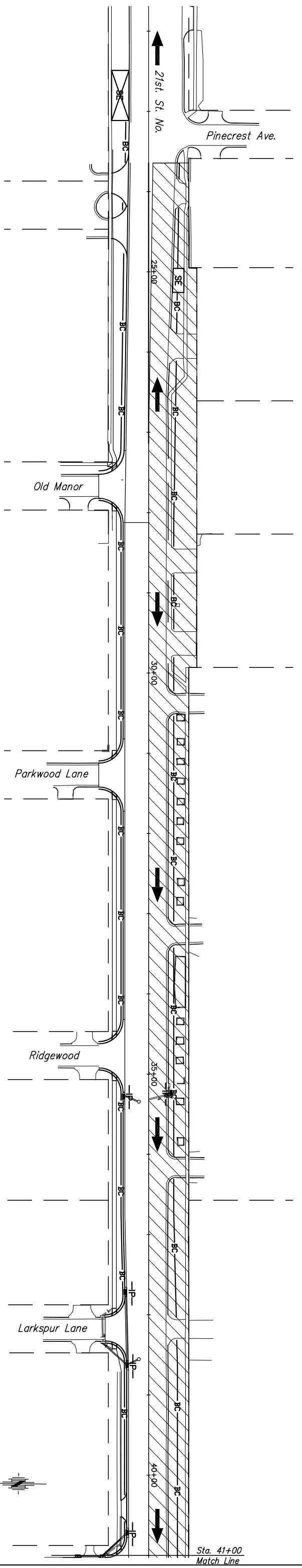

Scale: 1"=60'

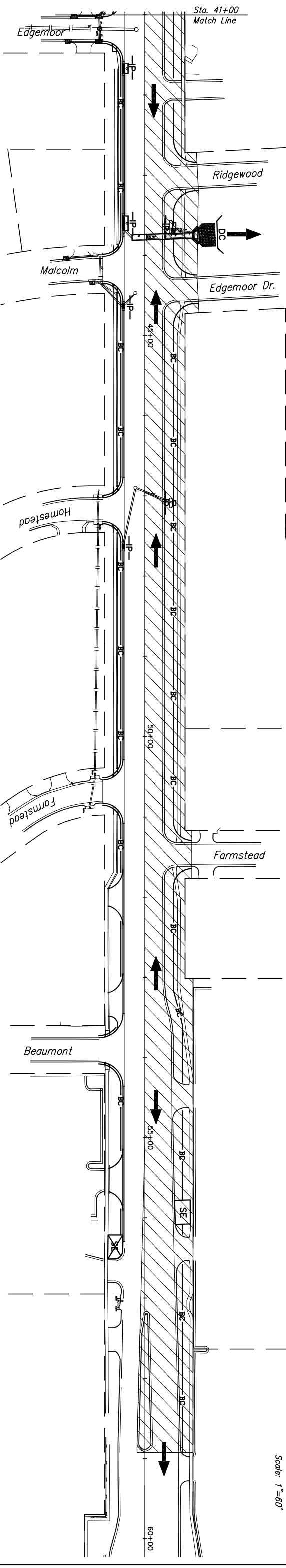

- SE STABILIZED ENTRANCE
- Area Inlet Protection
- Area Inlet Protection Removed
- Curb Inlet Protection
- Curb Inlet Protection Removed

- SB Slope Barrier
- SB Slope Barrier Removed
- BC Back of Curb Protection
- BC Back of Curb Protection Removed
- DC Ditch Check Protection
- DC Ditch Check Protection Removed

- Direction of Drainage
- Construction Limits
- Work Zone
- Right of Way Line

LEGEND

NOTES:
THIS PROJECT WILL DISTURB 7.29 ACRES.

REFER TO CITY OF WICHITA STANDARDS FOR BMP INSTALLATION, INSPECTION AND MAINTENANCE DETAILS AND SPECIFICATIONS.

COST FOR EACH EROSION AND SEDIMENT CONTROL ITEM SHALL INCLUDE MAINTENANCE, INSPECTION AND EVENTUAL REMOVAL. BESIDES KEEPING EACH DEVICE IN WORKING ORDER, MAINTENANCE SHALL INCLUDE, AT A MINIMUM, SEDIMENT REMOVAL BEFORE 50% OF THE DEVICE'S CAPACITY IS REACHED.

CONTRACTOR SHALL ADJUST EROSION AND SEDIMENT CONTROL PLANS TO CONFORM TO ACTUAL CONSTRUCTION OPERATIONS. ALL CHANGES TO PLAN SHALL BE APPROVED BY THE CITY.

KANSAS DEPARTMENT OF TRANSPORTATION
21ST STREET NORTH IMPROVEMENTS
EROSION & SEDIMENT CONTROL PLAN
PHASE 3

PROJECT NO. 87 N-0190-01
M K E C ENGINEERING CONSULTANTS, INC.
WICHITA, KANSAS
SEDCWICK CO.

J:\NCIVIL\04178\dwg\EROSION\04178ER-phase3.dwg 8/8/2005 11:25:27 AM CST

DESIGNED BY: LAC	CHECKED BY: JFA
DRAWN BY: WJU	DATE: 2/21/05
	SHEET 53 OF 96