

PILGRIM CONGREGATIONAL CHURCH SANITARY SEWER  
PROJECT NO. 468-76-245-80001-000-000-074

MICHAEL E. LINDEBAK, CITY ENGINEER

JULY, 1986

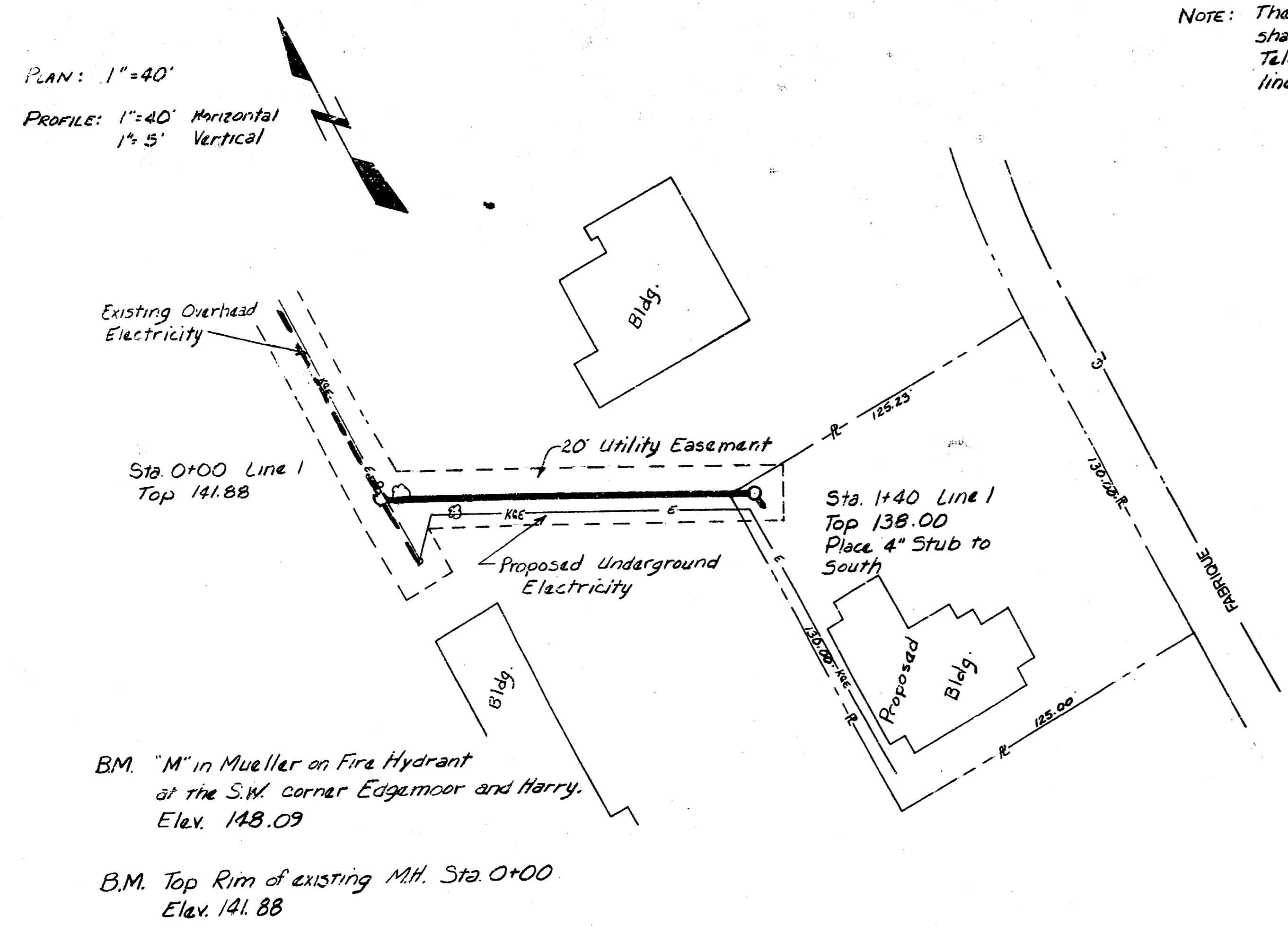

Note: The City of Wichita shall Air Test and Televis the raw line prior to acceptance.

QUANTITIES	
140 L.F.	8" PIPE
1 Ea.	MANHOLE
1 Ea.	CONNECT TO EXISTING MH
1 Ea.	4" STUB OUT
2 Ea.	TREE REMOVAL

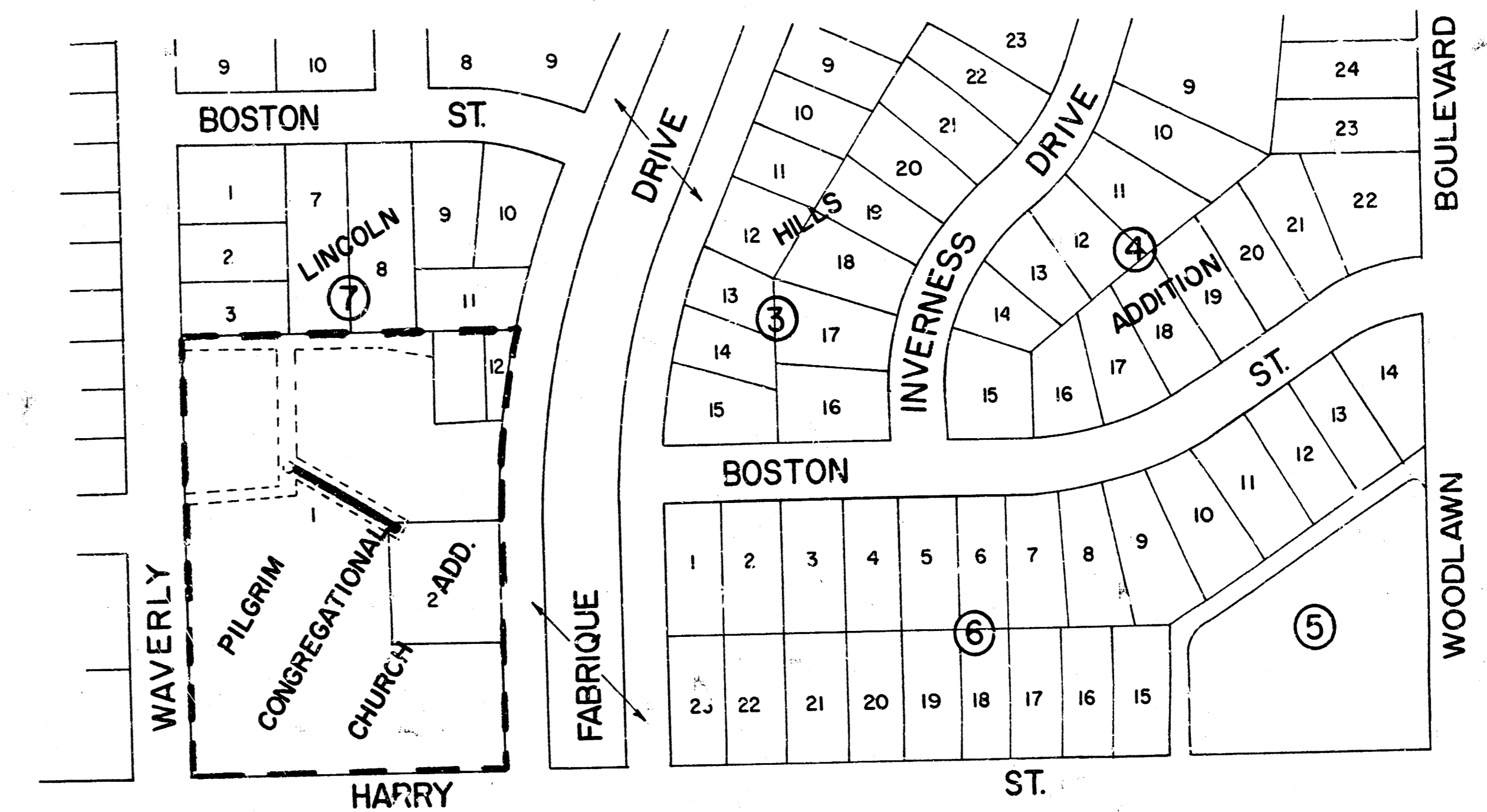

APPROVED AS NOTED  
By CITY ENGINEER OF WICHITA  
Sanitary Sewers MLL 7/28/86  
Storm Sewers \_\_\_\_\_  
Driveway Approaches \_\_\_\_\_  
Water Mains \_\_\_\_\_  
Paving \_\_\_\_\_

**NOTE TO CONTRACTOR**  
This project will be constructed under the supervision of the CITY ENGINEER and conforming to the SPECIFICATIONS of the CITY OF WICHITA. The CONTRACTOR will pay the City of Wichita for all costs of plan review, inspection and booking per contract.

THE CONTRACTOR SHALL BE RESPONSIBLE FOR PRESERVING PROPERTY IRONS. THE CONTRACTOR SHALL BE REQUIRED TO RE-ESTABLISH ANY PROPERTY IRONS WHICH ARE DAMAGED OR DESTROYED BY HIS OPERATIONS. SUCH IRONS SHALL BE RE-ESTABLISHED BY A LICENSED LAND SURVEYOR OR A LICENSED PROFESSIONAL ENGINEER IN ACCORDANCE WITH STATE LAWS.

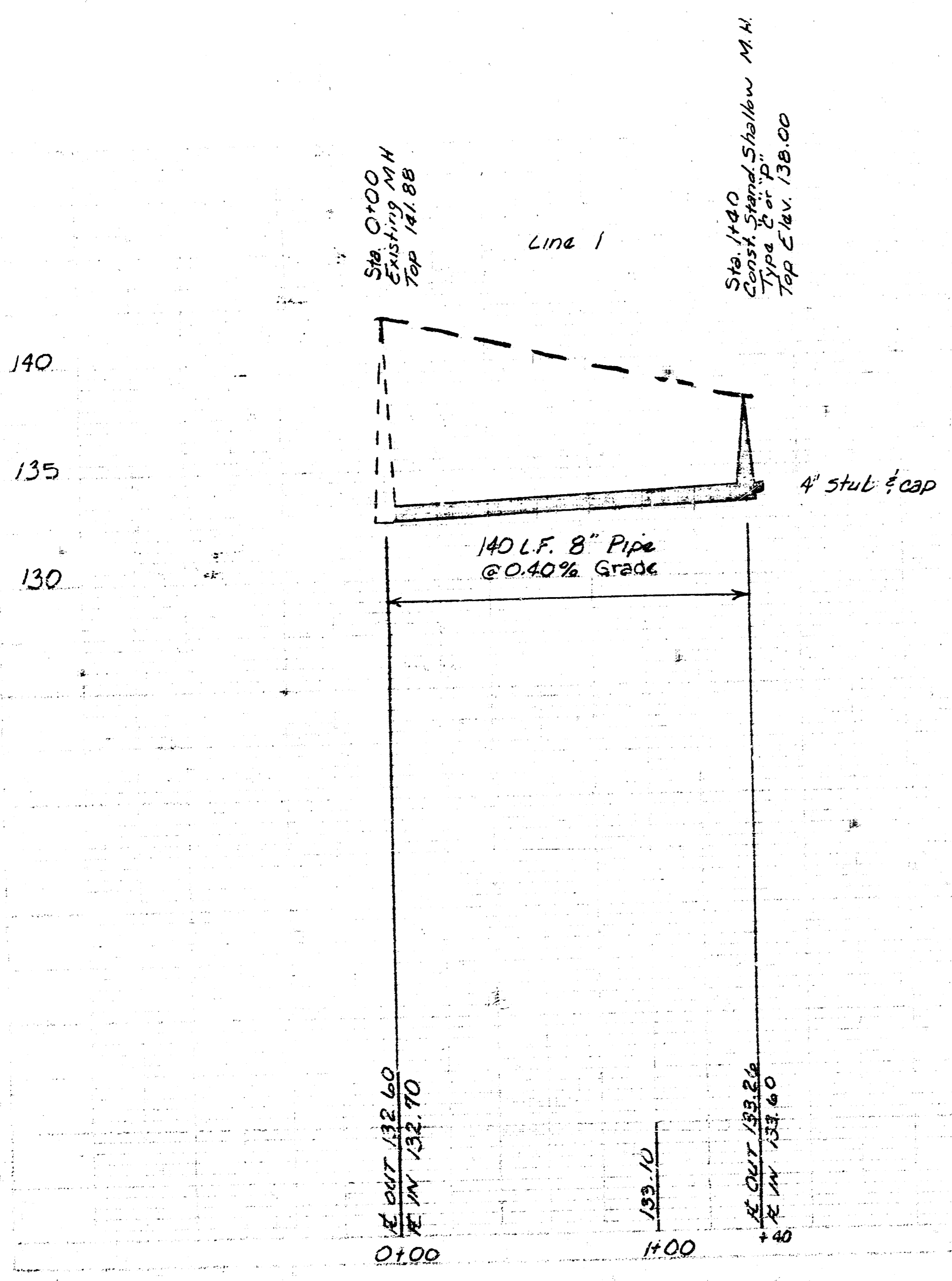

WICHITA, KANSAS			
SANITARY SEWER EXTENSIONS			
PLAN AND PROFILE			
PROJECT NO. 468-76-245-8001-000-000-074			
STA. 0+00 TO STA. 1+40			
	DSG/JMK DR/JMK CH APP	DWG FILE NO. 8641-D-80,067	
	DATE: July 1986	SHEET NO. / OF. /	

FILMED FROM THE BEST AVAILABLE COPY