

PLAN SURVEYED BY
 PLOTTED BY
 NOTE BOOK ALTIMETER CHECKED BY
 No. OF WAY CHECKED

BEUCH MARK: CITY DISC, 34 WEST
 AND 10 SOUTH OF THE CENTERLINES
 OF WEST ST. AND 2ND ST.
 ELEVATION = 118.87

NOTE: SANITARY SEWER TO BE
 CONSTRUCTED AS PER
 CITY OF WICHITA STANDARDS

SCALE: 1" = 20' HORIZ.
 1" = 10' VERT.

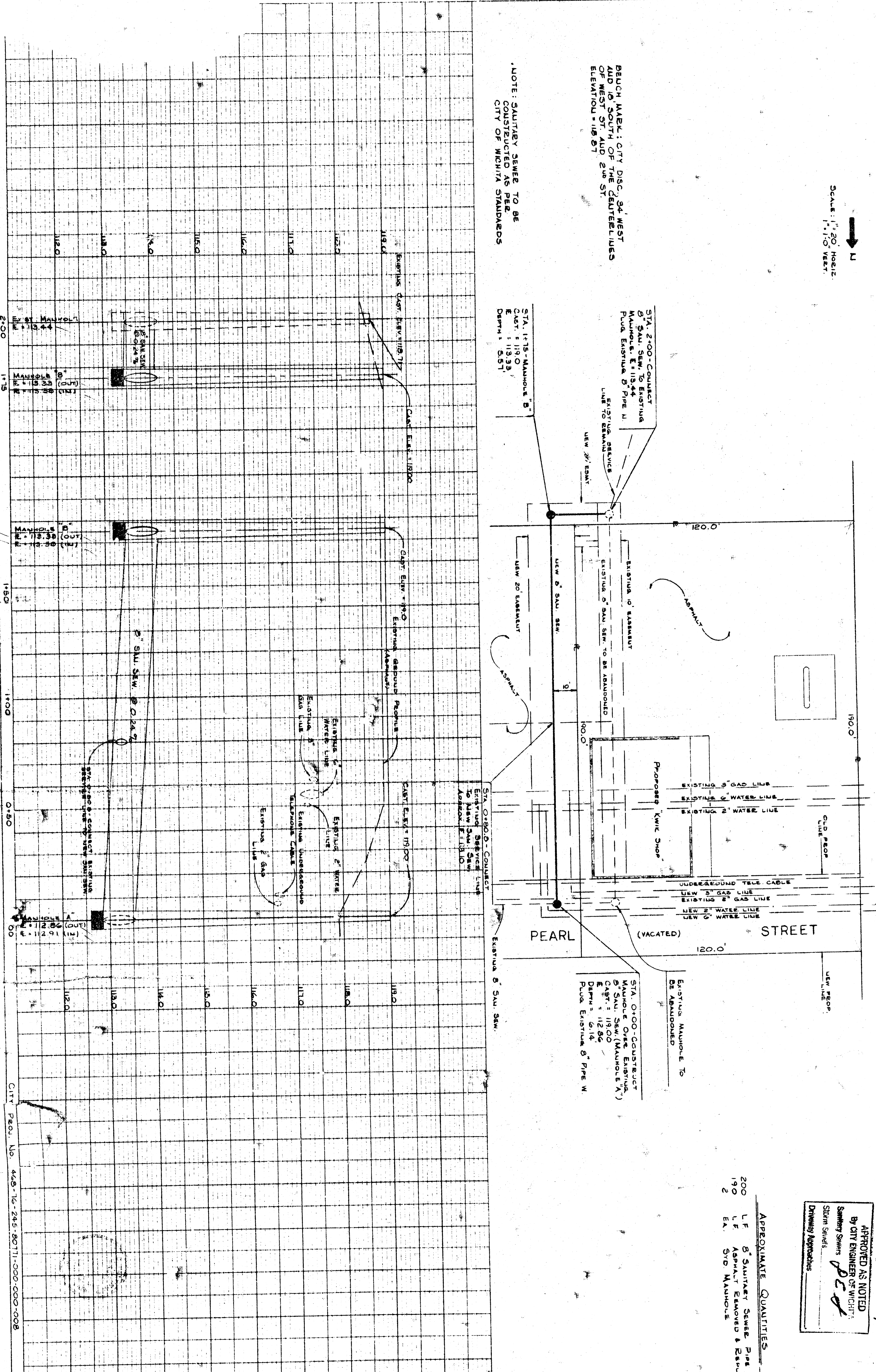

WEST ST

PEARL STREET

STA. 2+00 - CONSTRUCT
 8" SAN. SEW. TO EXISTING
 MANHOLE E. 118.87
 EXISTING 8" PIPE W.
 LINE TO EXISTING SERVICE
 NEW 20' EXHUMATION
 NEW 8" SAN. SEW.

EXISTING 10" SANITARY
 EXISTING 8" SAN. SEW. TO BE ABANDONED
 NEW 8" SAN. SEW.
 NEW 20' EXHUMATION

STA. 0+20.0 - CONSTRUCT
 EXISTING SERVICE LINE
 TO NEW SAN. SEW.
 APPROX. E. 118.10
 EXISTING 8" SAN. SEW.

STA. 0+00.0 - CONSTRUCT
 MANHOLE OVER EXISTING
 8" SAN. SEW. (MANHOLE 'A')
 CAST: E. 112.86
 ELEV.: 112.86
 DEPTH: 6.14
 PLUS EXISTING 8" PIPE W.

EXISTING MANHOLE TO
 BE ABANDONED

NOTE TO CONTRACTOR

This project will be constructed under
 the supervision of the CITY ENGINEER
 and conforming to the SPECIFICATIONS
 of the CITY OF WICHITA. THE CITY
 TRACTOR will furnish the City of
 Wichita for all cost of engineering, plans
 and inspection.

6-14-79

APPROVED AS NOTED
 BY CITY ENGINEER OF WICHITA
 S. J. [Signature]
 S. J. [Signature]
 S. J. [Signature]

APPROXIMATE QUANTITIES
 200 LF 8" Sanitary Sewer Pipe (PVC)
 190 LF Asphalt Removed & Replaced
 2 EA. STD Manhole

SAN. SEW. RELOCATION FOR
 KWIK SHOP BUILDING NO. 736
 DOUGLAS & WEST - WICHITA, KANSAS

Kwik Shop CONVENIENCE FOOD STORES
 ARCHITECTURAL & ENGINEERING DEPARTMENT
 2700 EAST FOURTH STREET
 HUTCHINSON, KANSAS 67501 1-316-685-5511

PLATE NUMBER PLAN AND PROFILE PLAN