

SANITARY SEWER PROFILE
 VERTICAL CURVE: 150.75' (VERTICAL IN 110)

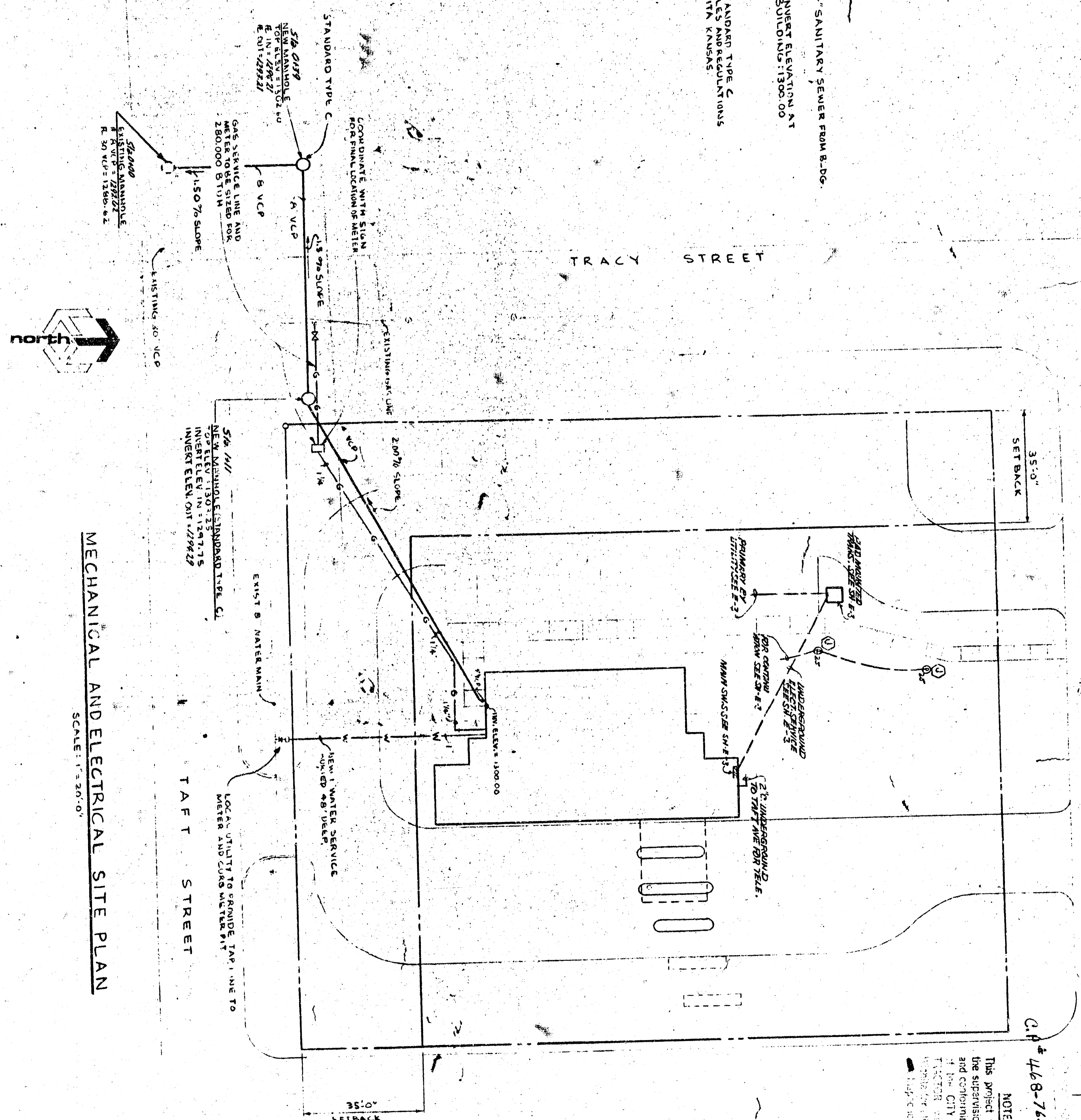

MECHANICAL AND ELECTRICAL SITE PLAN
 SCALE: 1/320' = 1"

NOTE TO CONTRACTOR
 This project will be constructed under the supervision of the CITY ENGINEER and conforming to the SPECIFICATIONS of the CITY OF WICHITA, KANSAS. THE CITY ENGINEER'S OFFICE IS LOCATED AT 1130 S. HAMPTON AVENUE, ST. LOUIS, MISSOURI 63130. AREA CODE 314 647-3800.

APPROVED AS INSTRUMENT OF SERVICE
 3-18-80
 [Signature]

Do Not Reproduce
 This document contains confidential information, is an instrument of service and the property of the architect. It shall not be used on other projects or for extension of this project without the architect's written approval.

Charles P. Guariglia Architect
 1130 Hampton Avenue St. Louis, Missouri 63130 Area Code 314 647-3800

Consultant Bank Building
 1130 Hampton Avenue St. Louis, Missouri 63130 (314) 647-3800
 Affiliate of Bank Building & Equipment Corporation of America

Job no. 6636 THE MECH. & ELECT. SITE PLAN PA BIGELOW Drawn by D. CALLAHAN Date 3/1/80

THE SOUTHWEST NATIONAL BANK OF WICHITA
 WICHITA, KANSAS
 468-76-245-80942-000-000-008