

PLAN
 SURVEYED BY
 MOHRING & ASSOCIATES CONSULTING ENGINEERS
 1015 W. 10TH ST. WICHITA, KANSAS 67202

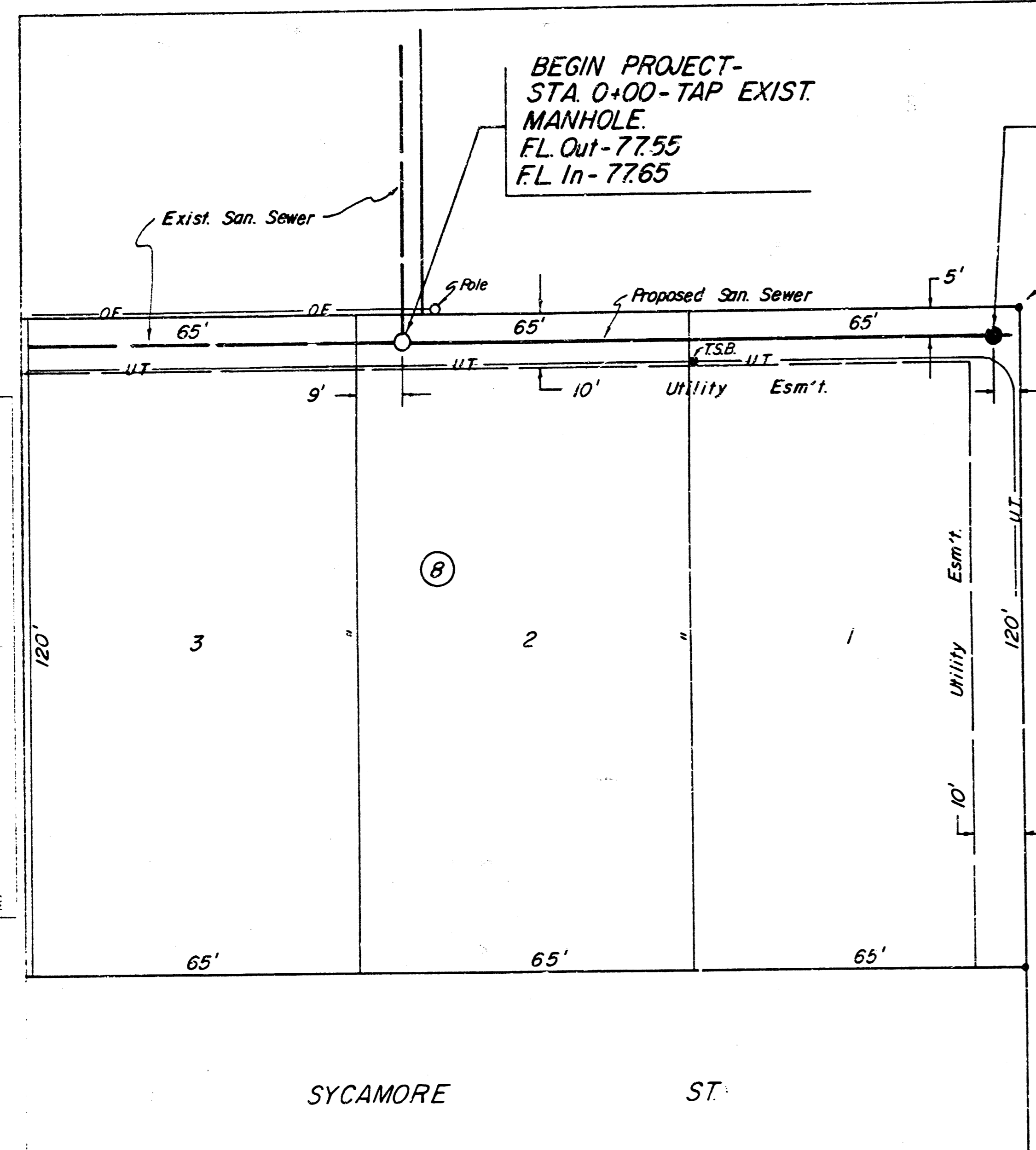

BEGIN PROJECT-
 STA. 0+00- TAP EXIST.
 MANHOLE
 FL. Out-77.55
 FL. In-77.65

END PROJECT-
 STA. 1+16- CONSTRUCT TYPE "A" SHALLOW
 MANHOLE WITH 8" STUB N.
 FL. = 78.00.

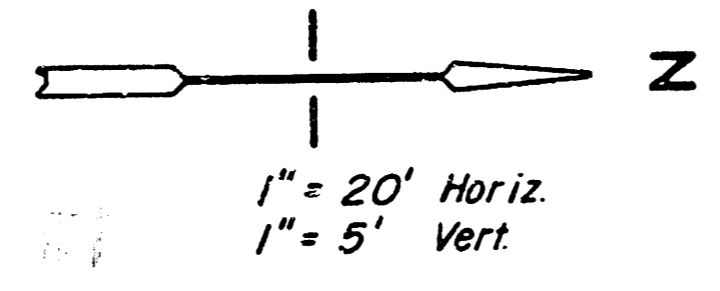

U.T. = Underground Telephone
 O.E. = Overhead Electric
 T.S.S. = Telephone Splice Box

BENCHMARK-

1. Top of Rim of M.H. STA. 0+00.
Elev. 82.44 City Datum.
2. Top of P.C. Iron on N. Side of
Lot 11, Blk. 8. Elev. 81.35. City
Datum.

THE CONTRACTOR SHALL BE RESPONSIBLE FOR PRESERVING PROPERTY IRONS. THE CONTRACTOR SHALL BE REQUIRED TO RE-ESTABLISH ANY PROPERTY IRONS WHICH ARE DAMAGED OR DESTROYED BY HIS CONSTRUCTION OPERATIONS. SUCH IRONS SHALL BE RE-ESTABLISHED BY A LICENSED LAND SURVEYOR OR A LICENSED PROFESSIONAL ENGINEER IN ACCORDANCE WITH STATE LAWS.

**SANITARY SEWER EXTENSION
 SERVING**

Lot 1, Block 8, South Seneca
 Gardens 4th Addition, Wichita, Ks.

Private Project No. 468-76-245-80001-000-000-039

M.E. LINDEBAK CITY ENGINEER

NOTIFY THE FOLLOWING COMPANIES PRIOR TO ANY TRENCHING.

ARKLA GAS CO.	942-8350
BELL TELEPHONE	268-3087
CABLEVISION	266-6817
KPL GAS SERVICE	263-7511
KANSAS GAS & ELEC.	261-6248
KANSAS ONE-CALL	1-800-DIG-SAFE
CALL BEFORE YOU DIG	1-800-571-2115

NOTE -
 Contractor to make arrangements with Southwestern Bell for relocation or protection of underground telephone cable. Call 267-2889.

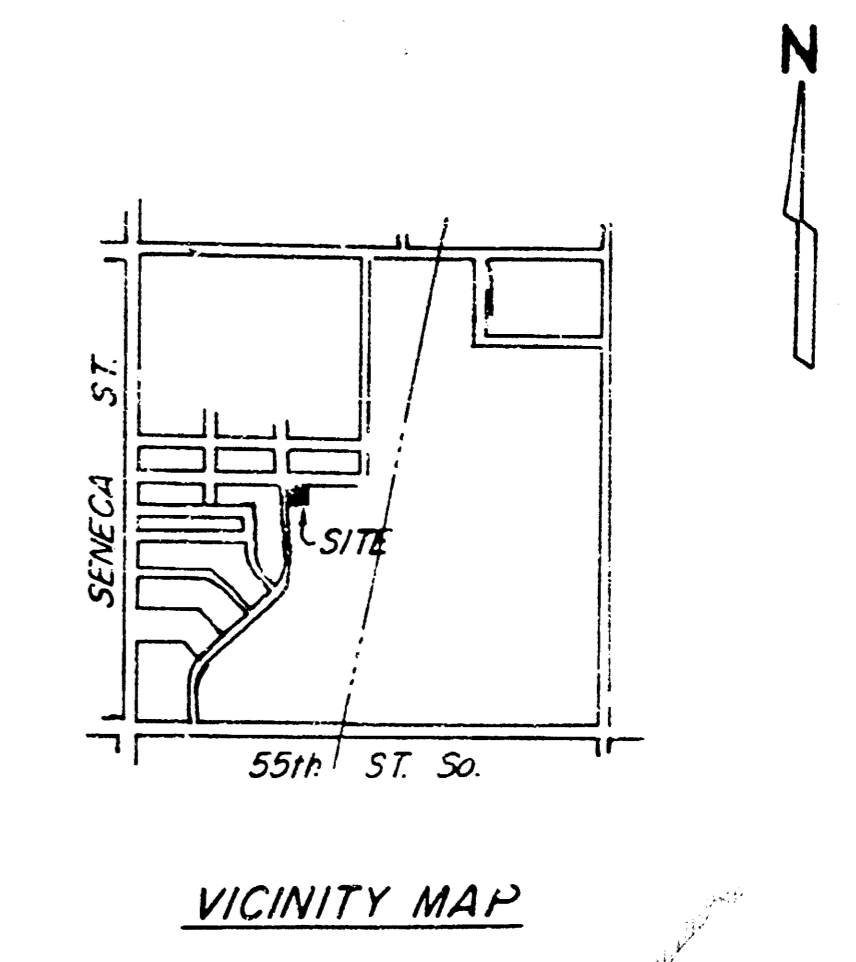

Moehring & Associates
 Consulting Engineers
 Wichita
 Sept. 30, 1985

NOTE TO CONTRACTOR

This project will be constructed under the supervision of the CITY ENGINEER and conforming to the SPECIFICATIONS of the CITY OF WICHITA. THE CONTRACTOR will pay the City of Wichita for an estimate of plan review, inspection and booking per contract.

PROFILE
 SURVEYED BY
 MOHRING & ASSOCIATES CONSULTING ENGINEERS
 1015 W. 10TH ST. WICHITA, KANSAS 67202

