

Scale: 1" = 40'

**GENERAL NOTES**

- Contractor shall insure that entrance to Drive-in Theatre is left open to traffic after 6:00 P.M. This shall be accomplished by either completing excavation, laying of pipe and back-filling by this time or by phasing construction to insure that one-half of pavement will be left open to traffic. Contractor shall notify manager of theatre prior to beginning construction. Min. Pymt thickness = 5"
- Contractor shall be responsible for verifying location of underground power lines and water line prior to excavating the trench. Care shall be exercised so that these lines are not disturbed.
- Contractor shall install a 5' stub and plug pipe on the North side of manhole at Sta. 3+00. This point is the end of Phase I construction.

APPROVED AS NOTED  
By CITY ENGINEER OF MICHIGAN  
Sanitary Sewers 5-16-74 SRS  
Storm Sewers  
Driveway Approaches

**NOTE TO CONTRACTOR**  
This project will be constructed under the supervision of the CITY ENGINEER and conforming to the SPECIFICATIONS of the CITY OF MICHIGAN. The CONTRACTOR will reimburse the City of Michigan for all cost of Engineering and inspection.

**ESTIMATE OF QUANTITIES**

Item	Phase I	Phase II
8" VCP Lin Ft.	305	240
Type "A" Manhole Ea.	1	1
Connect to Exist Manhole Ea.	1	0
Remove & Replace Conc. Pymt 5 Y.	8	0
Remove & Replace Asphalt Pymt 5 Y.	24	0
Remove & Replace Integral Curb L.F.	5	0
Flushed Sand Fill in Place Tons	188	133
Trees Removed Ea.	2	0
Remove & Replace Wood Fence L.S.	1.5	1.5

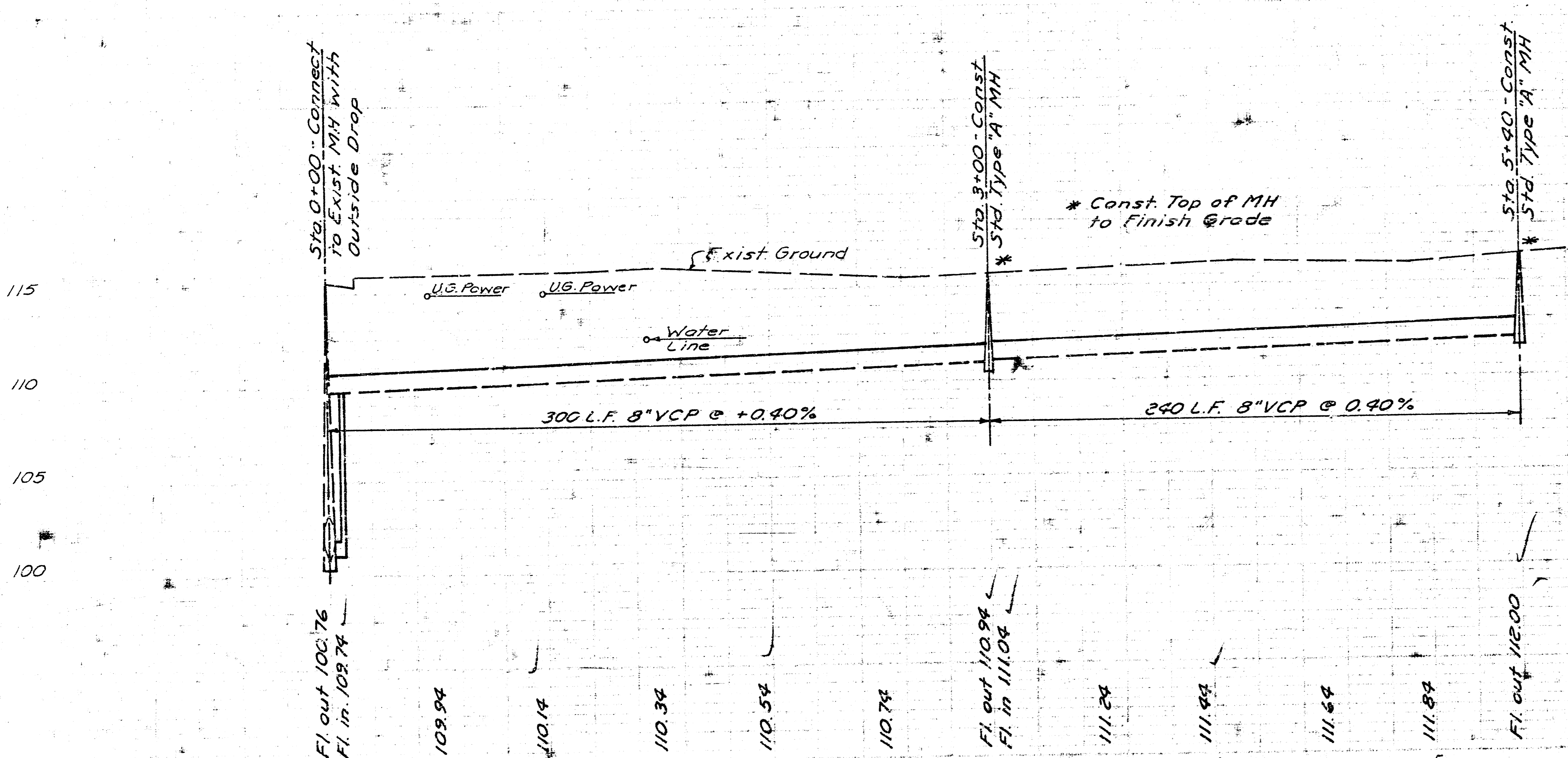

PLAN PROFILE  
SANITARY SEWER

DBLW 704028