

B.M. #6:  
Chicised Square on NW  
Corner Traffic Signal  
Pole Base at SW Corner,  
Hillside & Murdock.  
Elev. = 150.04

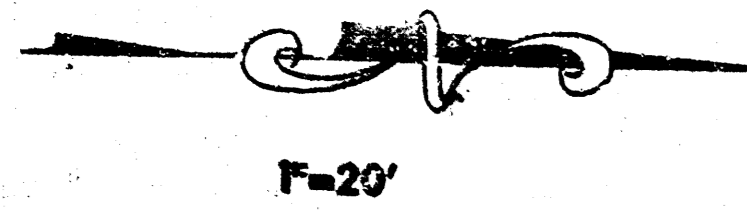

Note: Cleanout &  
Bldg. connection to be  
Construct & Inspected  
by others.

Note: 10 LF exist.  
San. Sewer pipe east  
of M.H. 0+00 removed.  
Remaining San. Sewer  
pipe east of M.H. 0+00  
to be abandoned in place.

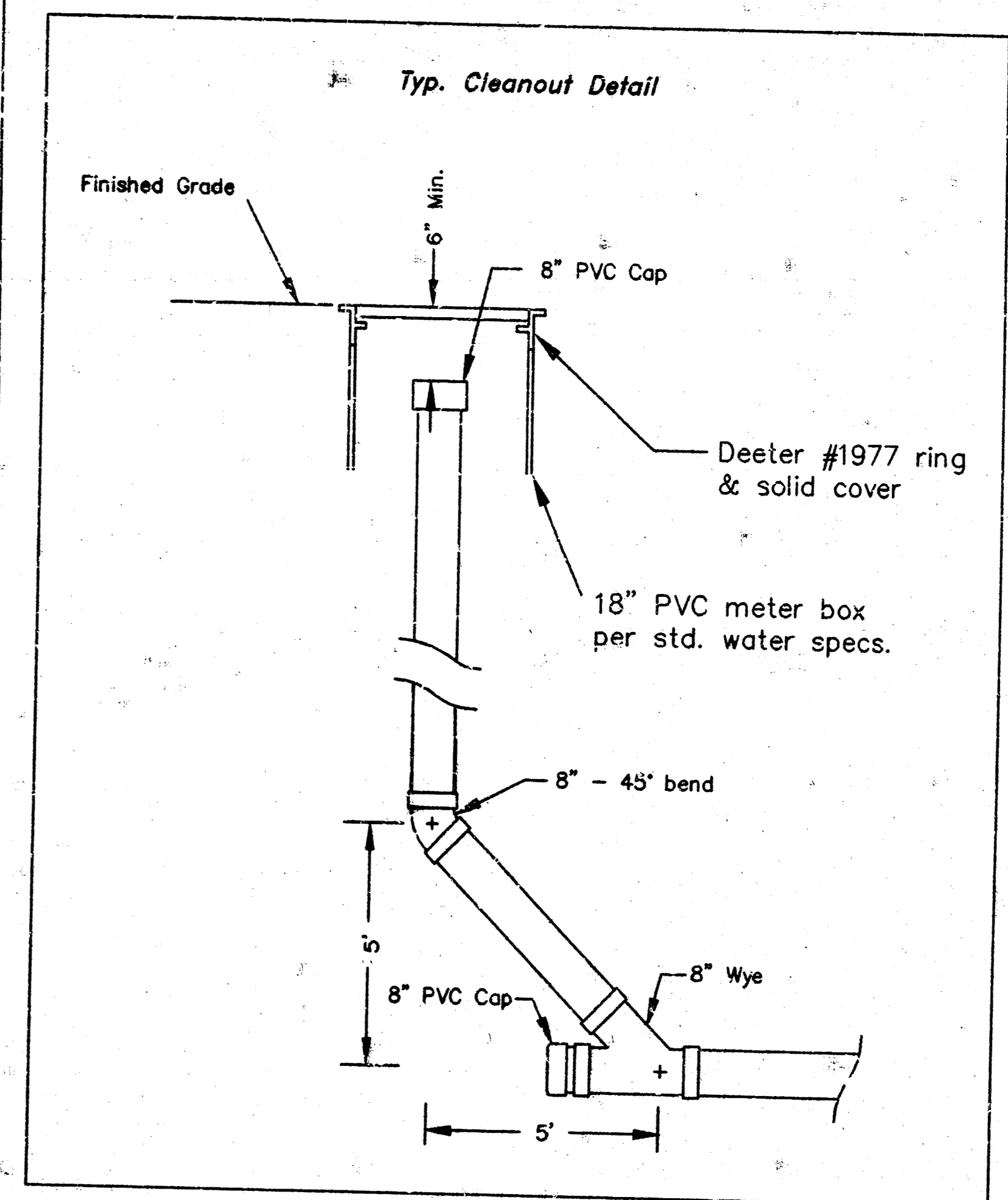
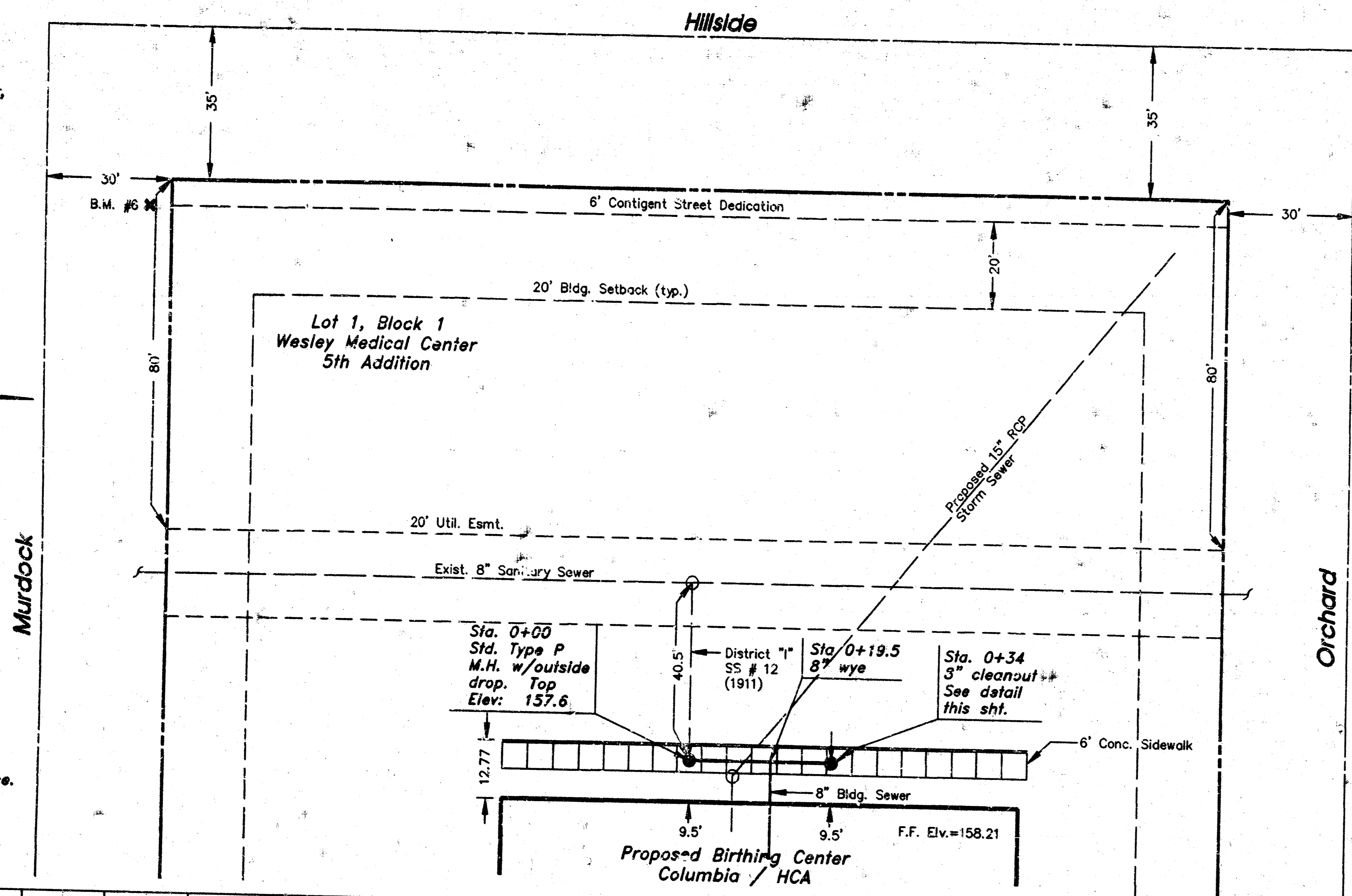

Private 8" Sanitary Sewer Extension  
to serve  
Proposed Birthing Center  
Columbia/HCA Healthcare Corp.  
Lot 1, Block 1  
Wesley Medical Center 5th Addition  
Wichita, Ks  
February, 1996

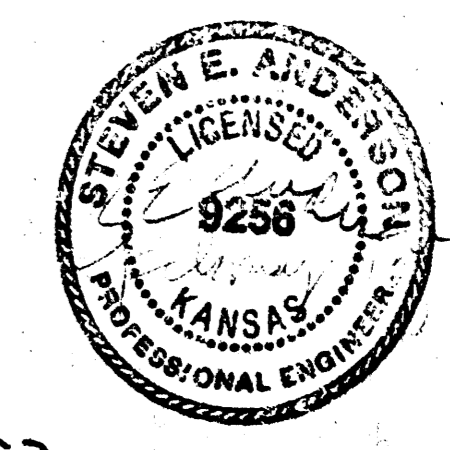

Booked  
4-26-96  
ckb  
From As Bolts

AS BUILT PLAN

598 PPS (607861)  
S.E. Anderson PE/LS  
Consulting Engineer  
Whitewater, Ks

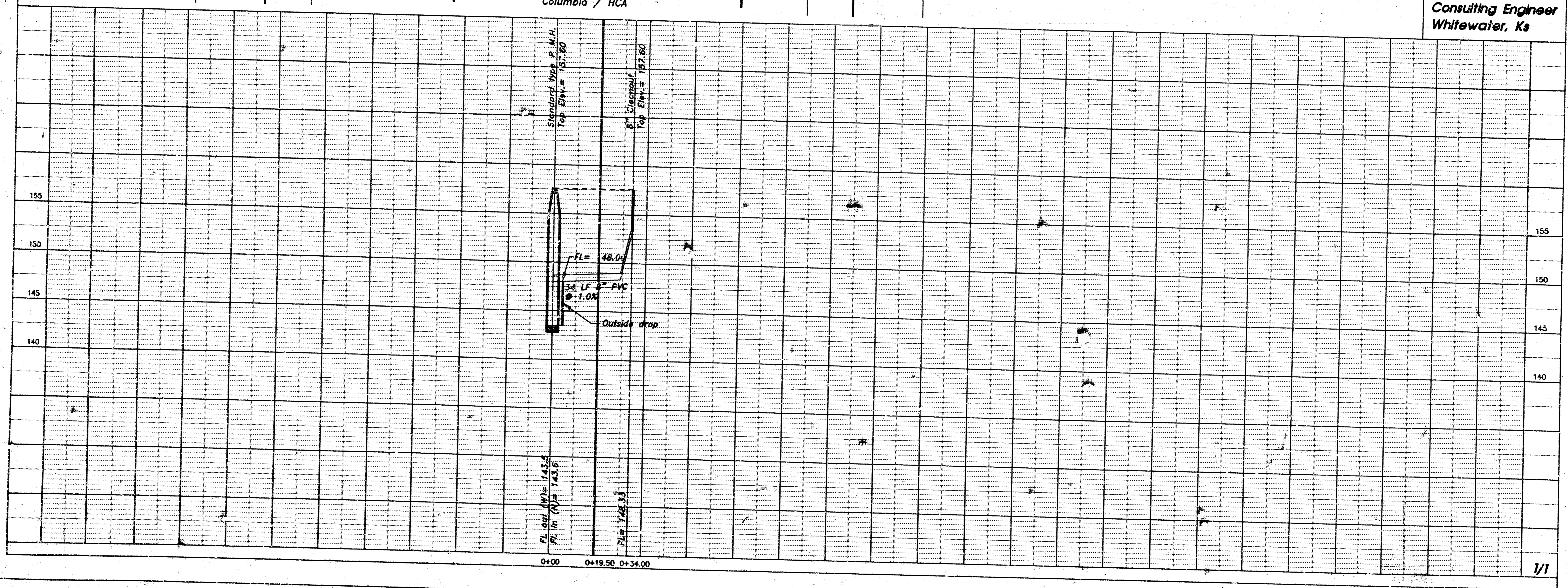

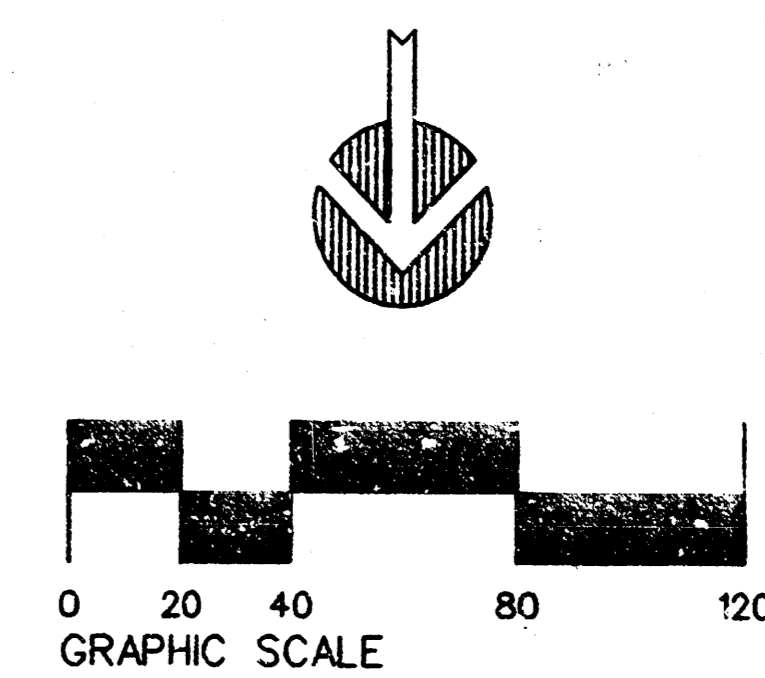
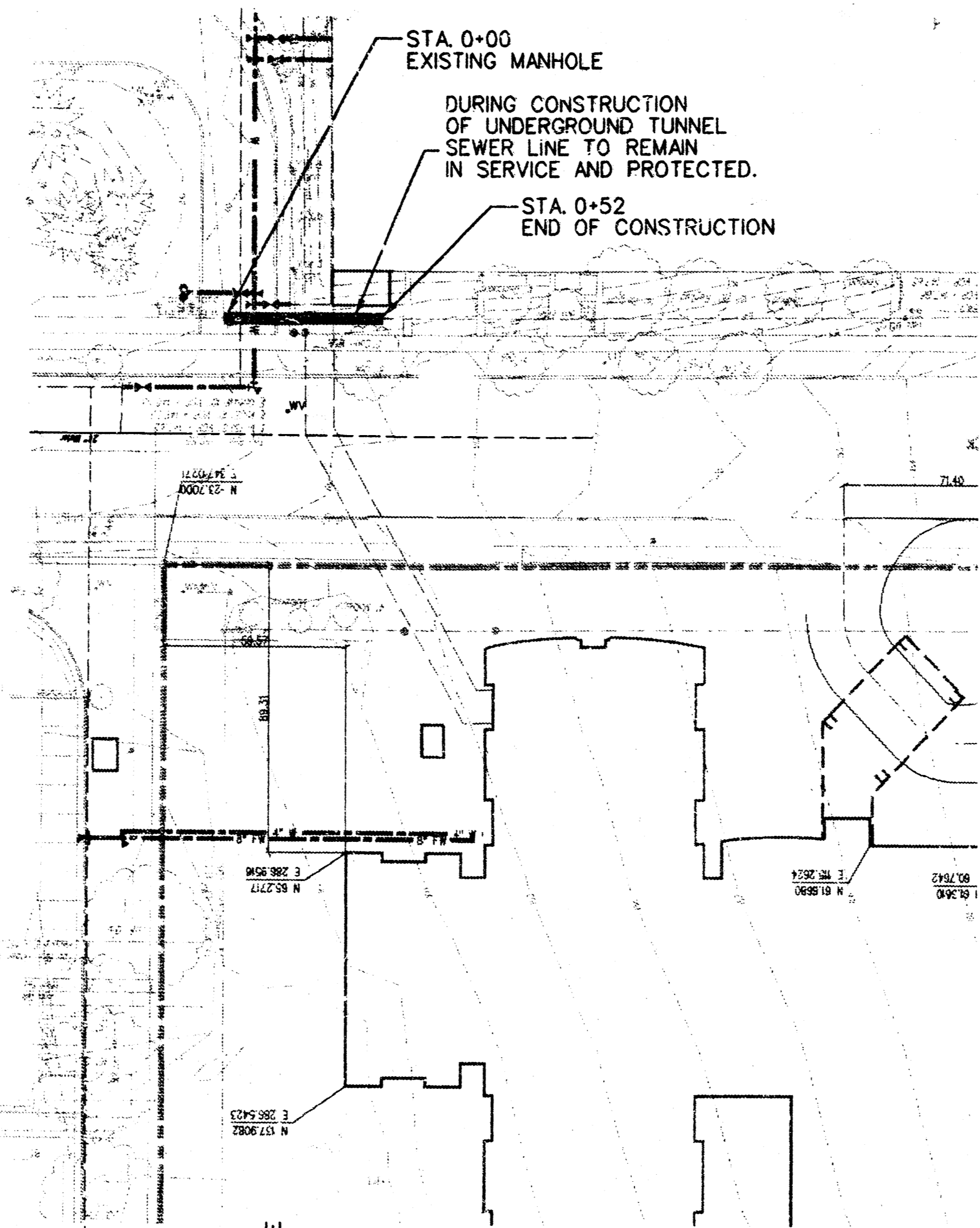
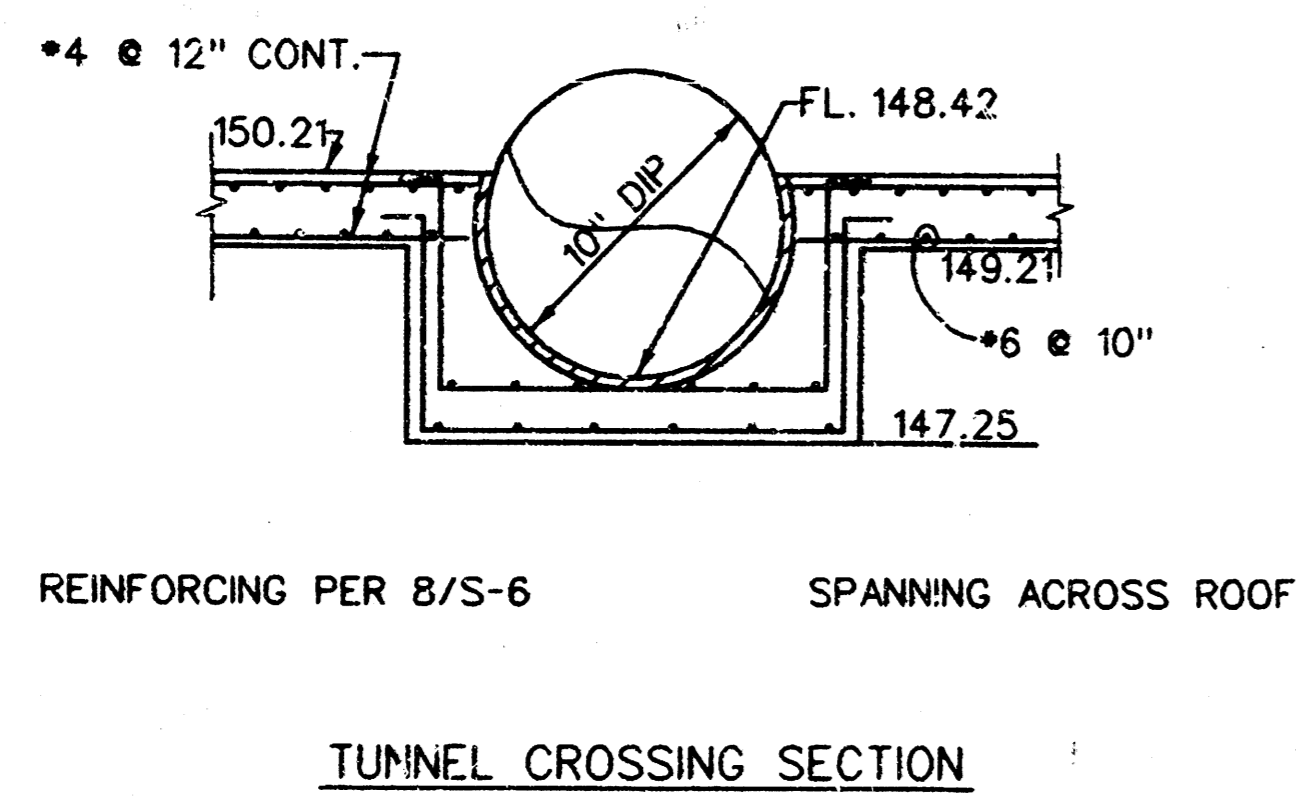

PROFILE: VERT. = 1"-5'  
HORIZ. = 1"-40'

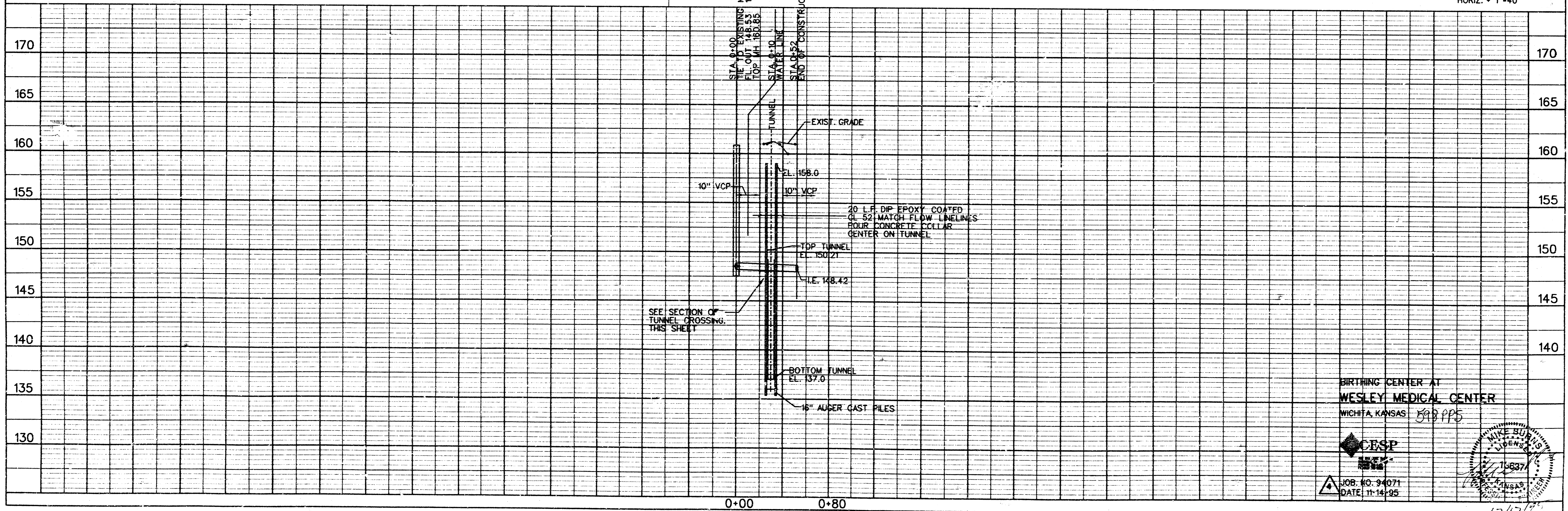

BIRTHING CENTER AT  
WESLEY MEDICAL CENTER  
WICHITA, KANSAS

CESP  
JOB. NO. 94071  
DATE: 11-14-95

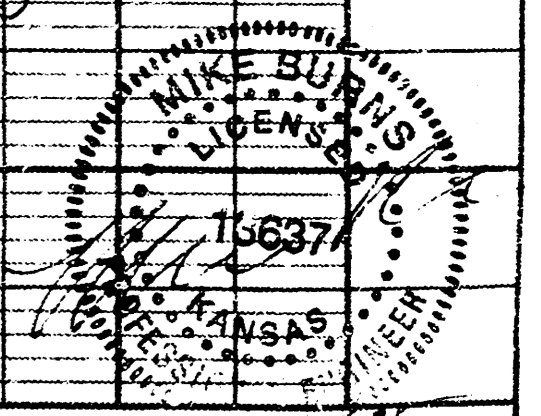

△ SANITARY SEWER PLAN AND PROFILE

△ C5.09

- BM \* 2 CHISELED SQUARE ON TOP OF RETAINING WALL NE CORNER OF VASSAR & MURDOCK ELEV. = 163.70
- BM \* 3 CHISELED SQUARE ON TOP OF CURB SW FLUME AT HOLYOKE & MURDOCK ELEV. = 160.84
- BM \* 4 CHISELED SQUARE ON TOP OF CURB SW CORNER WHEEL CHAIR RAMP AT NE CORNER OF ORCARD & HILLSIDE ELEV. = 151.12
- BM \* 5 CHISELED SQUARE ON TOP OF CURB NE CORNER WHEEL CHAIR RAMP AT SW CORNER OF HOLYOKE & ORCARD ELEV. = 163.00
- BM \* 6 CHISELED SQUARE ON NW CORNER TRAFFIC SIGNAL POLE BASE AT SW CORNER OF HILLSIDE & MURDOCK ELEV. = 150.04

NOTE:  
SEE STANDARD DROP INLET DETAIL  
FURNISHED BY THE CITY ENGINEER  
OF WICHITA, KANSAS.

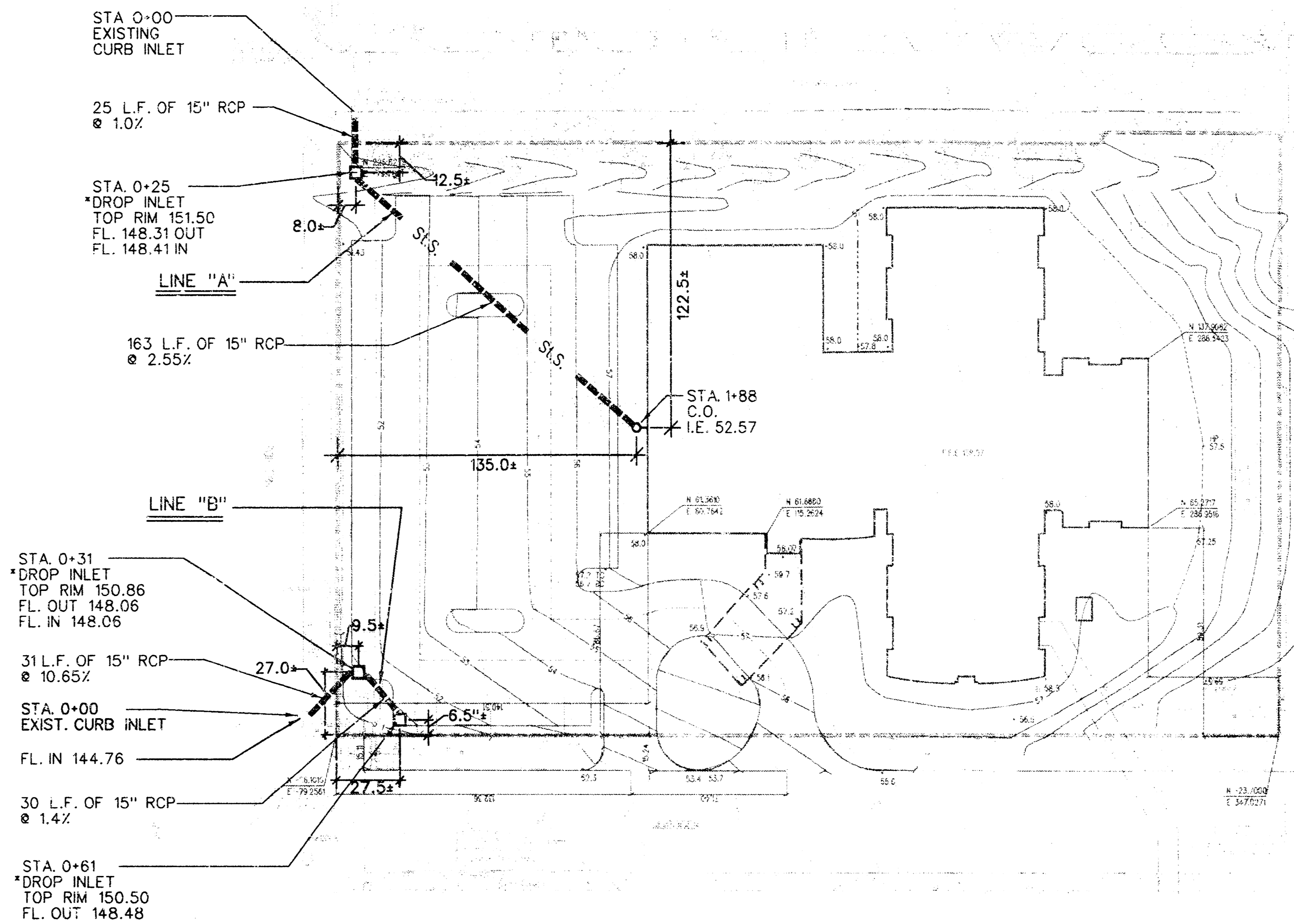

**NOTE TO CONTRACTOR**  
 INSPECTION AND TESTING FOR THIS PROJECT IS TO BE PROVIDED BY A LICENSED CONSULTING ENGINEERING FIRM UNDER CONTRACT WITH THE OWNER/DEVELOPER. SAID INSPECTION TO BE IN ACCORDANCE WITH THE CITY OF WICHITA STANDARD CONSTRUCTION ENGINEERING PRACTICES AND CERTIFIED BY A LICENSED PROFESSIONAL ENGINEER. NO WORK SHALL BE PERFORMED IN DEDICATED EASEMENTS OR THE PUBLIC RIGHT-OF-WAY BY THE CONTRACTOR WITHOUT SUCH INSPECTION NOR SHALL ANY WORK BE COMMENCED IN DEDICATED EASEMENTS OR PUBLIC RIGHT-OF-WAY WITHOUT WRITTEN AUTHORIZATION BY THE CITY ENGINEER.

APPROVED AS NOTED  
 By CITY ENGINEER OF WICHITA  
 Sanitary Sewers VRH 12/13/95  
 Storm Sewers VRH 12/13/95  
 Driveway Approaches \_\_\_\_\_  
 Water Mains \_\_\_\_\_  
 Paving \_\_\_\_\_

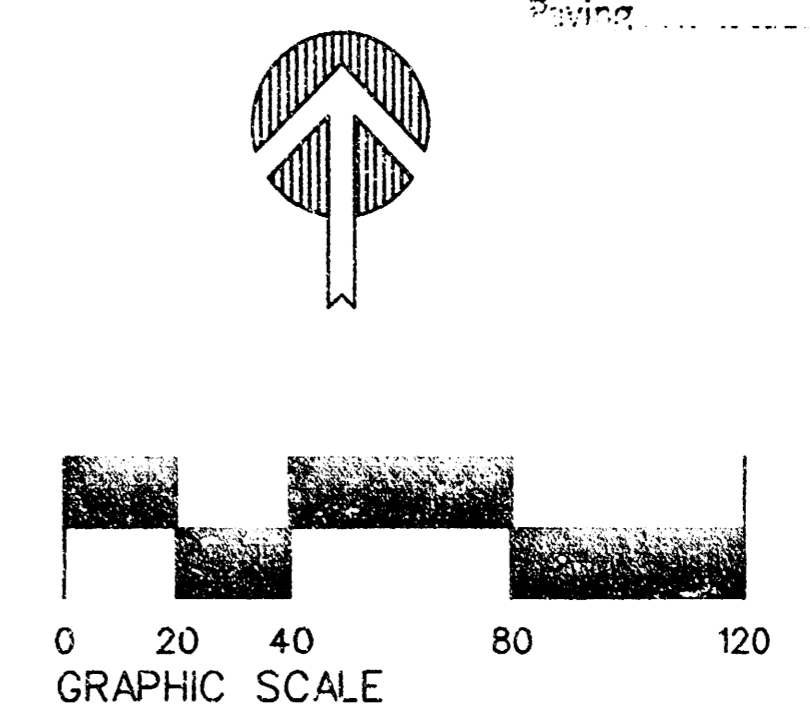

PROFILE: VERT. 1"=5'  
 HORIZ. 1"=40'

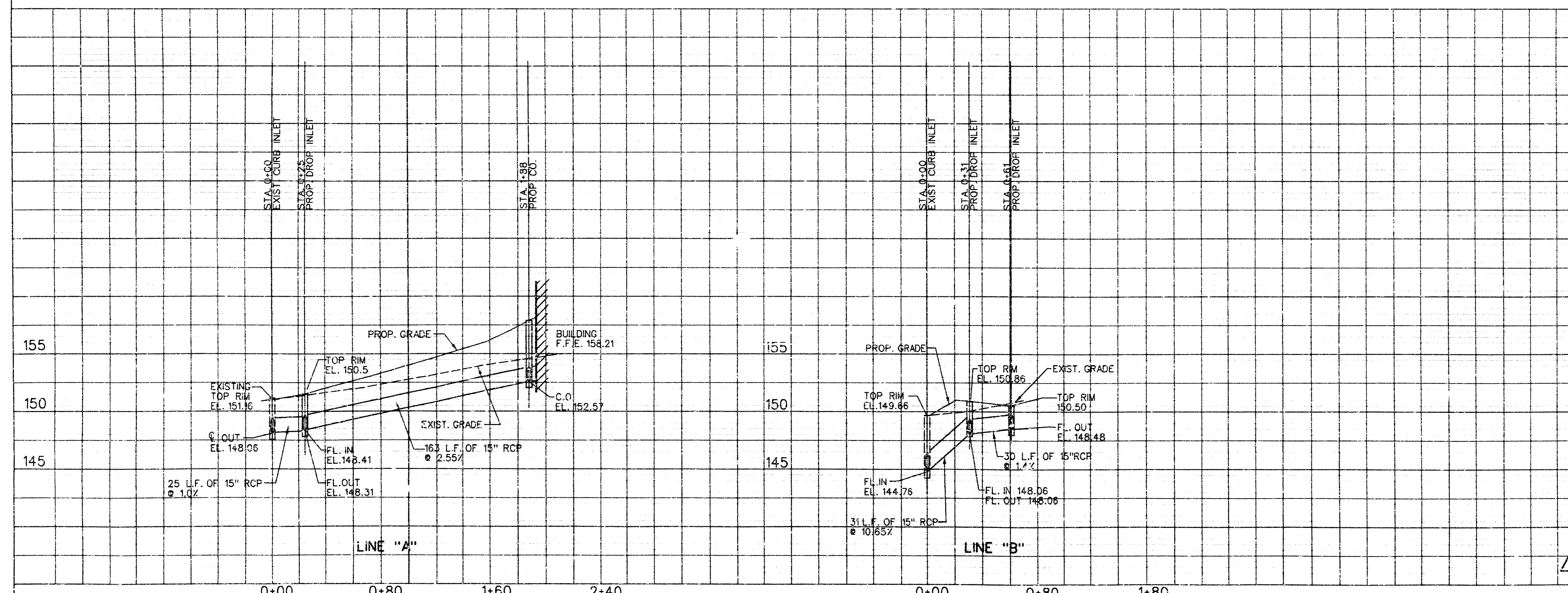

CITY OF WICHITA PRIVATE  
 PROJECT NO. = 398PPS(607861)  
 MICHAEL E. LINDERBAK, P.E., CITY ENGINEER

BIRTHING CENTER AT  
 WESLEY MEDICAL CENTER  
 WICHITA, KANSAS

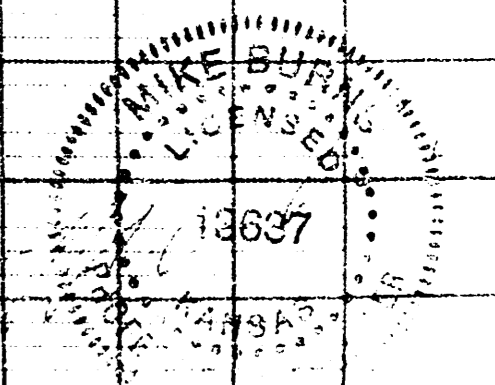
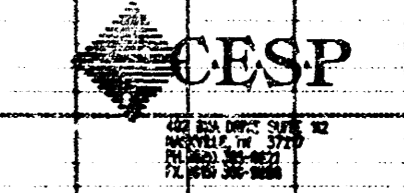

JOB NO. 94071  
 DATE: 11-14-93

STORM DRAINAGE PLAN AND PROFILE 598 PPS C5.10