

Benchmark

Water Main Replacement Project to Serve Arkansas Avenue From 16th Street North to 20th Street North

BM #1 - Small Rail Road Spike in Face of Light Pole Located at the SW Corner of the Intersection of 16th Street & Arkansas Ave. Elev. 1306.95

BM #2 - Brass Rod in Concrete Post in Water Meter Box Located at the NE Corner of the Intersection of 17th Street & Arkansas Ave. Elev. 1306.45

BM #3 - City of Wichita Disc Located at the SW Corner of Bridge at Little Arkansas River & 18th Street at West End of Handrail. Elev. 1311.59

BM #4 - City of Wichita Disc Located at the SE Corner of Bridge at Little Arkansas River & 18th Street at East End of Handrail. Elev. 1311.59

BM #5 - "□" Top of Curb Located 21± feet South of the Center Line 19th Street at SW Corner of the Intersection of 19th Street & Arkansas Ave. Elev. 1308.46

BM #6 - "□" Back of walk Located at the SW Corner of the Intersection of 20th Street & Arkansas Ave. Elev. 1309.76

Index

Title Sheet	1
Keysheet	2
General Notes	3
Water Details	4 - 6
Water Plans & Profile	7-17
Erosion Control	18-19

Project No. 448-90119
O.C.A. No. 633721

CITY OF WICHITA, KANSAS

James L. Armour, P.E. City Engineer
March, 2006

BM #4

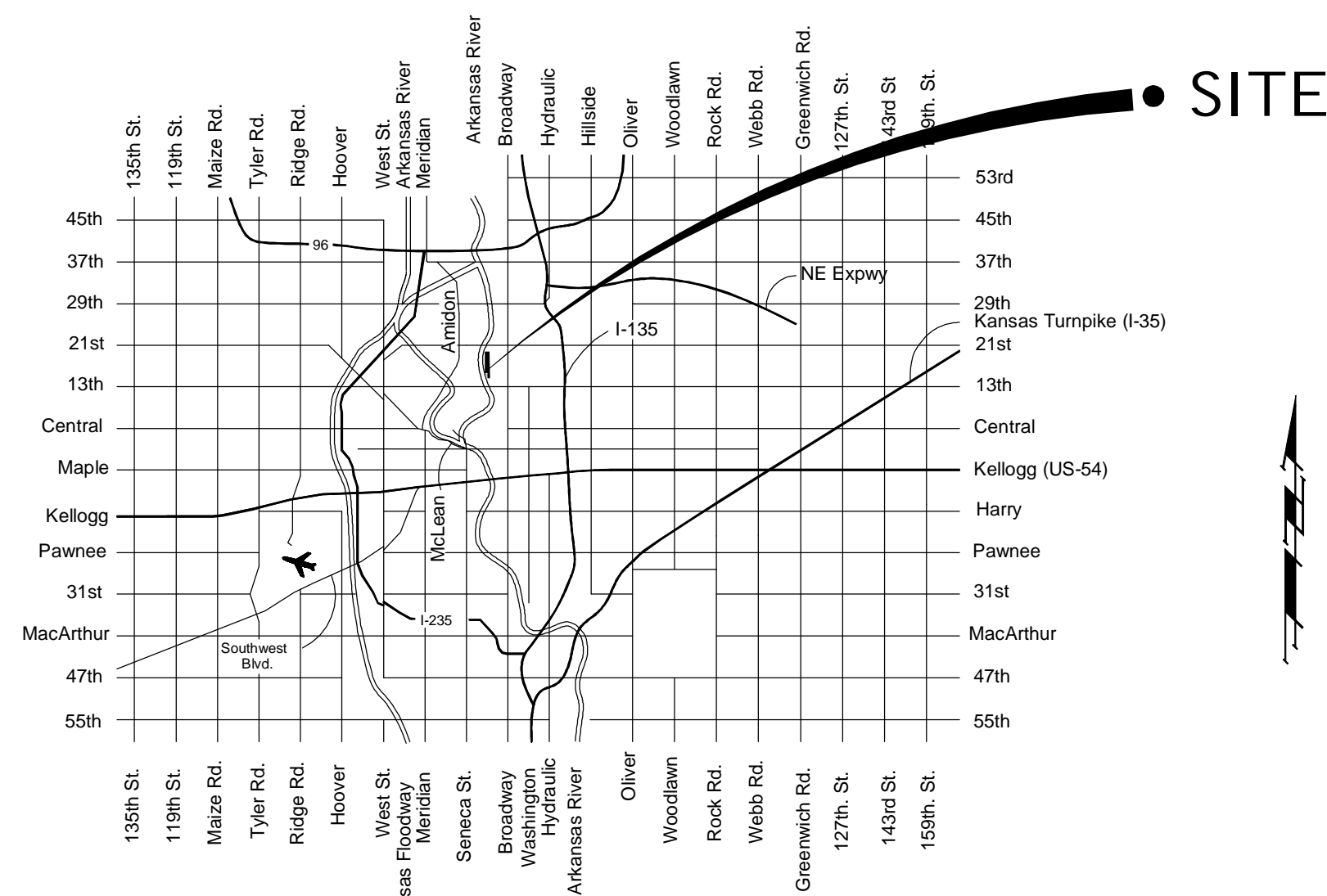
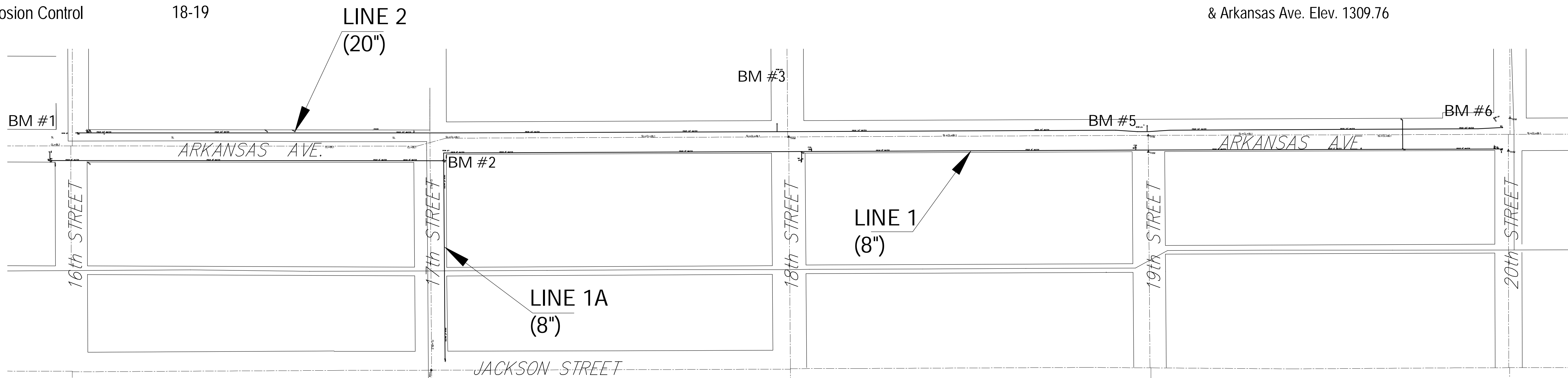

SCALE: 1" = 100'

VICINITY MAP