

# KEYSHEET

## Horizontal Control Points

Number	Northing	Easting	Raw Desc	Full Desc
2	5000.0000	7000.0000	IRON (BM 6)	SWPC of 20th & Arkansas
3	3639.3200	7000.0000	CP	SW of 18th & Arkansas
4	4362.3564	7032.0196	THIM	INTERSECT of 19th & Arkansas
5	4362.5947	7062.0395	THIM	E of 19th & Arkansas
6	5027.0001	7060.1084	THIM	E of 20th & Arkansas
7	5029.9451	6999.9136	THIM	W of 20th & Arkansas
69	3698.9785	7034.7771	THIM	INTERSECT of 18th & Arkansas
77	3067.1416	7067.1396	IRON	NEPC of 17th & Arkansas
97	3007.2006	7022.1977	PIN	SWPC of 17th & Arkansas
278	2434.4040	7030.4710	N	NNW of 16th & Arkansas
311	2407.0639	7021.3846	IRON	NWPC of 16th & Arkansas
312	2404.2193	7080.7810	IRON	NEPC of 16th & Arkansas
313	2345.2923	7081.2784	IRON	SEPC of 16th & Arkansas
1052	4352.9236	7013.9061	N	SW of 19th & Arkansas
3088	3039.3804	7465.0461	THIM	INTERSECT of 17th & Jackson



0 50 100

SCALE: 1" = 100'

BM #3

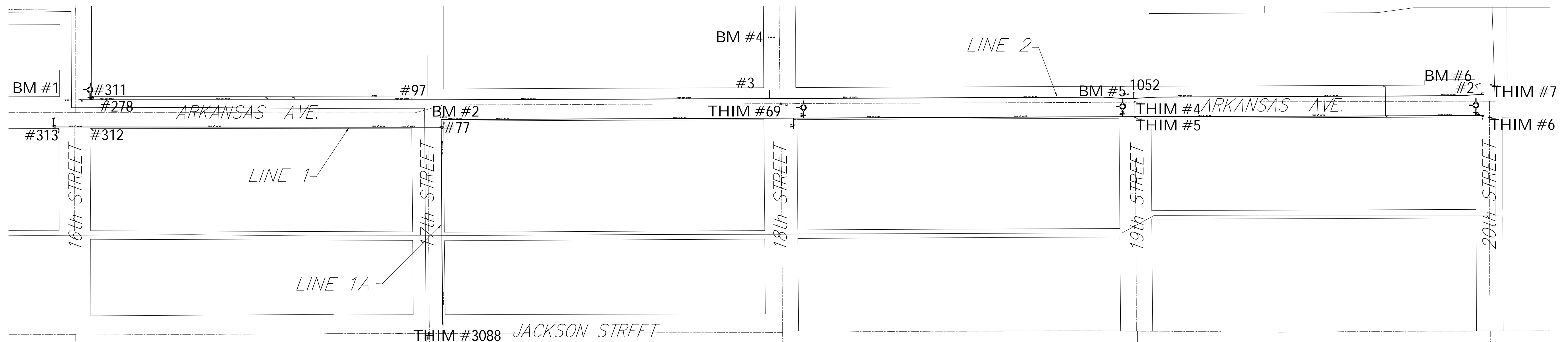

Drawing File: F:\Arkansas Ave Water Lines\Land\Dig\Bse Key Sheet.dwg

Design: ENGINEER  
Drawn: STAFF  
Approved: ENGINEER  
Scale: NOTED

Project No. 0510E592 CAPITAL IMPROVEMENT PROJECT

ARKANSAS AVE.  
WATER MAIN REPLACEMENT  
KEYSHEET



**Baughman Company, P.A.**  
315 Ellis St. Wichita, KS 67211 P 316-262-7271 F 316-262-0149  
ENGINEERING | SURVEYING | PLANNING | LANDSCAPE ARCHITECTURE

March, 2006

SHEET  
OF  
2  
19