

BM. 98.53 Head 60° spike E.S. Cotton wood
24' NE. of SW cor. Baulah Park N.E. Greenway Blvd.

Date 9-18-52
Drawn by J. Smith
Checked by L.K. White
Book No. 436

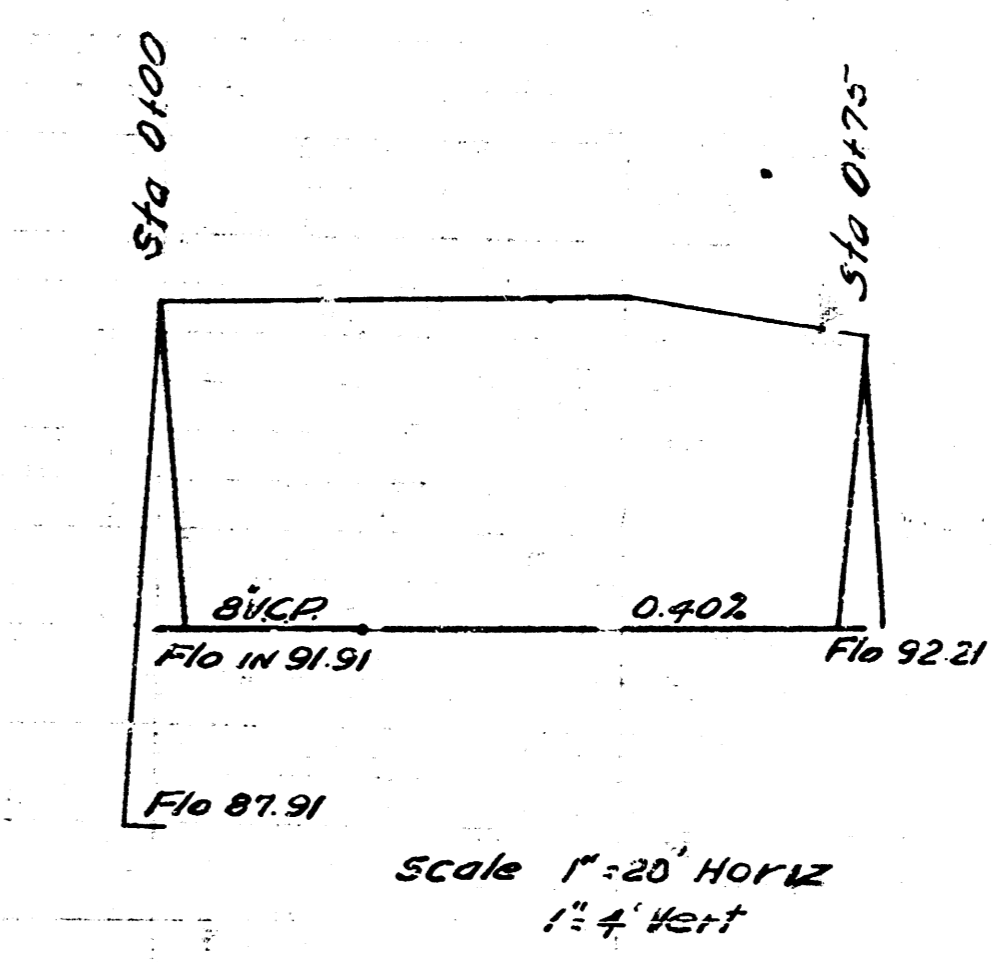

Scale 1" = 20' Horiz
1/2" = 4' Vert

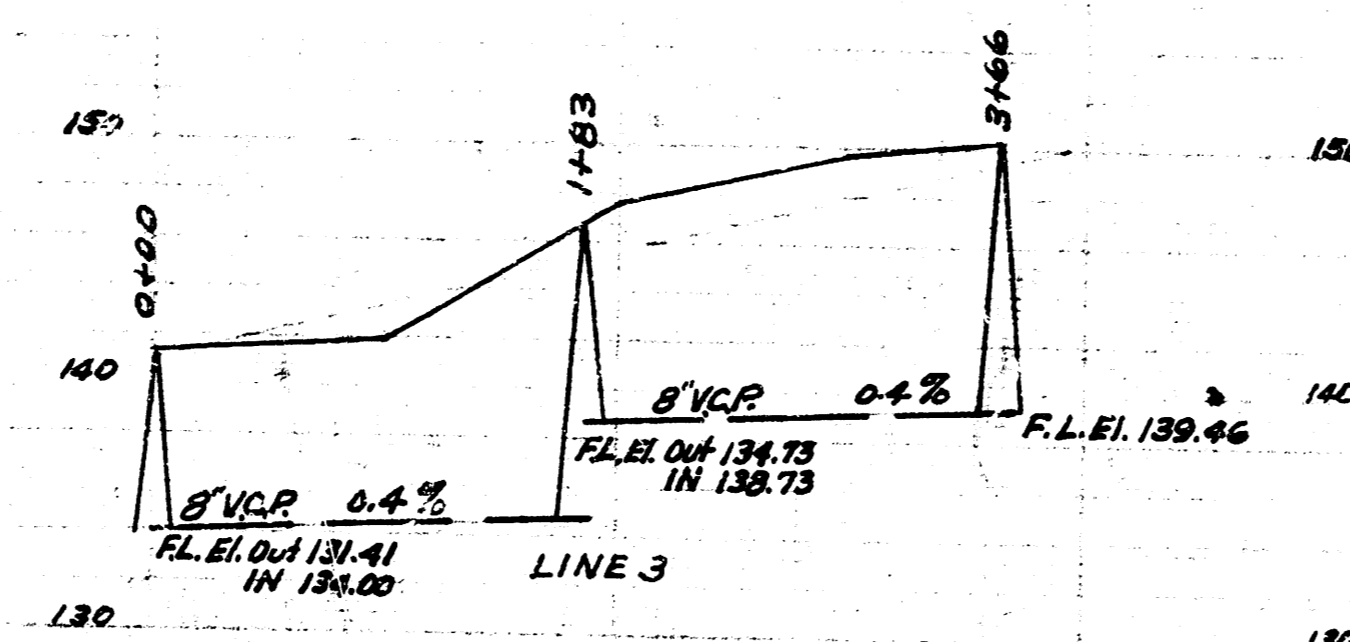
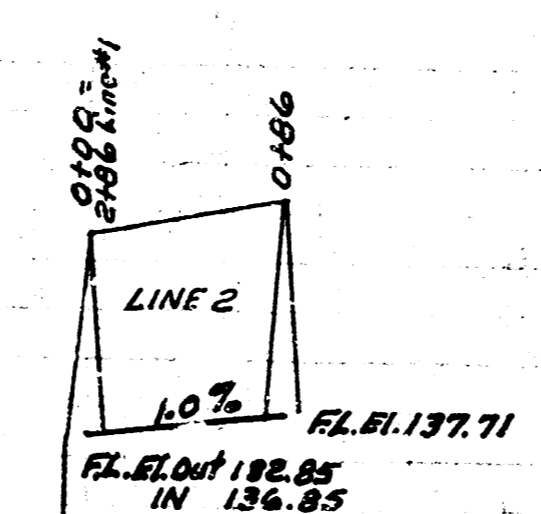
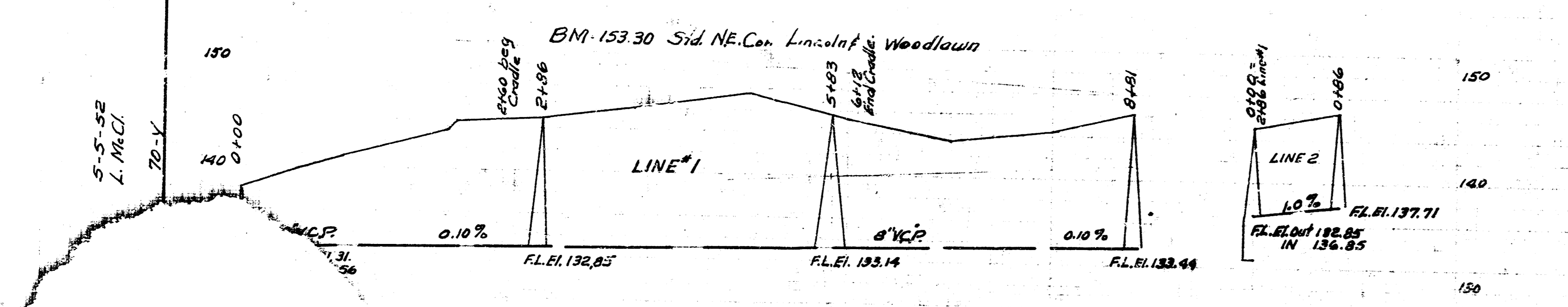

LAT. 8, SUB. 3, WIS.
CITY OF WICHITA KANSAS
L.K. WHITE CITY ENGINEER
Plan No. C-22-15

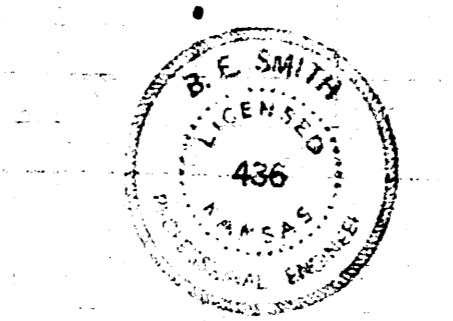
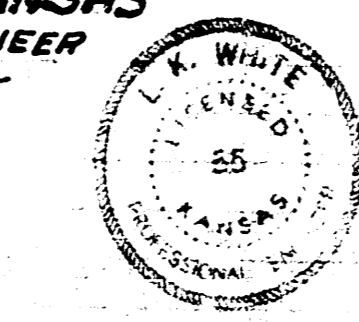

J.O. SMITH PRIVATE SENIOR
CITY OF WICHITA KANSAS
L.K. WHITE CITY ENGINEER